

NEW MEXICO OIL CONSERVATION COMMISSION
Santa Fe, New Mexico

Form C-101
Revised (12/1/55)

NOTICE OF INTENTION TO DRILL

Notice must be given to the District Office of the Oil Conservation Commission and approval obtained before drilling or recompletion begins. If changes in the proposed plan are considered advisable, a copy of this notice showing such changes will be returned to the sender. Submit this notice in QUINTUPPLICATE. One copy will be returned following approval. See additional instructions in Rules and Regulations of the Commission. If State Land submit 6 Copies Attach Form C- 128 in triplicate to first 3 copies of form C-101

902 South Coast Building, Houston 2, Texas

September 26, 1960

(Place)

(Date)

OIL CONSERVATION COMMISSION
SANTA FE, NEW MEXICO

Gentlemen:

You are hereby notified that it is our intention to commence the Drilling of a well to be known as
Texas National Petroleum Company - **Material NO. 1 State 16-26-11**

(Company or Operator)

State **1**, Well No. **320 acre** The well is
(Lease) **790** in **320 acre** (Unit)
located **East** **790** feet from the **East** line and **790** feet from the
South line of Section **16**, T. **26 N**, R. **11 W**, NMPM.
(GIVE LOCATION FROM SECTION LINE) **Wildcat** **San Juan** County
Pool, **SW 15-4 & 15-5**

R 11 W

D	C	B	A
E	F	G	H
L	K	J	I
M	N	O	Op

**T
26
N**

If State Land the Oil and Gas Lease is No. **--**

If patented land the owner is **--**

Address **--**

We propose to drill well with drilling equipment as follows: **Rotary rig. Mud in**
hole from surface to T-D at 6300 ft.

The status of plugging bond is **in force.**

Drilling Contractor **Unknown**

We intend to complete this well in the **Dakota**
6130 formation at an approximate depth of **6130** feet.

CASING PROGRAM

We propose to use the following strings of Casing and to cement them as indicated:

Size of Hole	Size of Casing	Weight per Foot	New or Second Hand	Depth	Sacks Cement
13-3/4"	10-3/4"	32.75	Used	130'	Circ. to surface
7-7/8"	4-1/2"	11.60	New	6300'	800' fillup

If changes in the above plans become advisable we will notify you immediately.

ADDITIONAL INFORMATION (If recompletion give full details of proposed plan of work)
Revised Program

(Voids Initial Notice of Intent to Drill dated August 10, 1960). **SEP 28 1960**

Approved **10-5**, 19 **60**
Except as follows:

Sincerely yours,
Texas National Petroleum Company

By **Harry S. McThumall**
District Manager

Position **Send Communications regarding well to**
Texas National Petroleum Company
Name **1607 Tower Building**
Address **Denver 2, Colorado**

OIL CONSERVATION COMMISSION

By **Emory C. Green**

NEW MEXICO OIL CONSERVATION COMMISSION
Well Location and Acreage Dedication Plat

Section A.

Date September 30 1960

Operator Texas National Petroleum Co. Lease State No. 886 15-4 & 15-5
Well No. 1 Unit Letter A Section 16 Township 20N Range 44N NMFM
Located 170 Feet From East Line, 170 Feet From State Line
County San Juan G. L. Elevation 6254 Dedicated Acreage 320 Acres
Name of Producing Formation Dalena Pool Wildcat

1. Is the Operator the only owner* in the dedicated acreage outlined on the plat below?
Yes No A.
2. If the answer to question one is "no," have the interests of all the owners been consolidated by communitization agreement or otherwise? Yes A No . If answer is "yes," Type of Consolidation
3. If the answer to question two is "no," list all the owners and their respective interests below:

Owner

Land Description

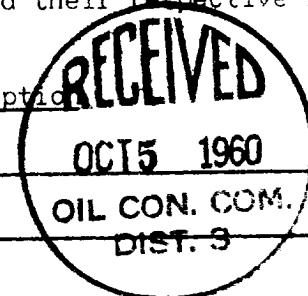

Section B

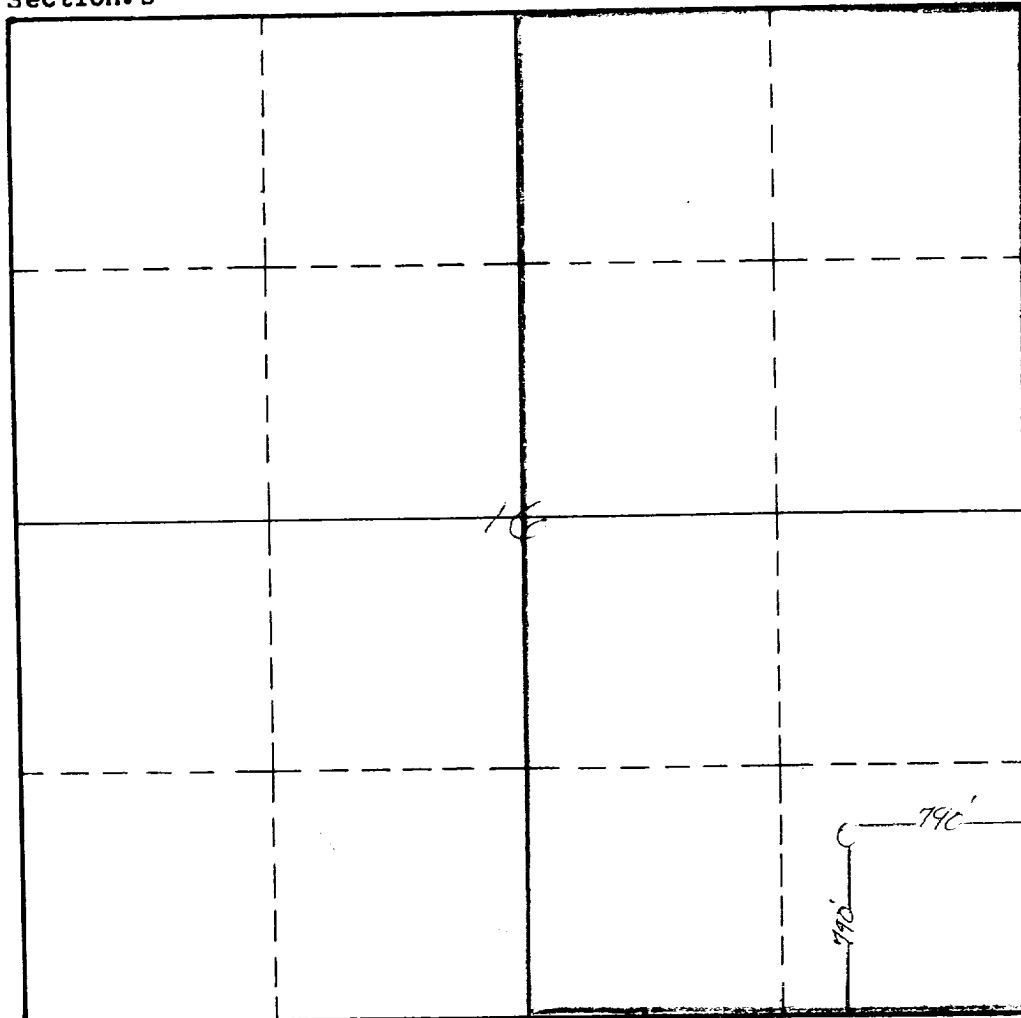

**Certified location plat
previously submitted.**

This is to certify that the information in Section A above is true and complete to the best of my knowledge and belief.

Texas National Petroleum Co.

(Operator)

Harry S. McFarland
(Representative)

1607 Tower Bldg, Denver, Colo.

Address

This is to certify that the well location shown on the plat in Section B was plotted from field notes of actual surveys made by me or under my supervision and that the same is true and correct to the best of my knowledge and belief.

Date Surveyed August 9, 1960

James P. Lease

Registered Professional
Engineer and/or Land Surveyor.

Certificate No. 1403

INSTRUCTIONS FOR COMPLETION:

1. Operator shall furnish and certify to the information called for in Section A.
2. Operator shall outline the dedicated acreage for both oil and gas wells on the plat in Section B.
3. A registered professional engineer or land surveyor registered in the State of New Mexico or approved by the Commission shall show on the plat the location of the well and certify this information in the space provided.
4. All distances shown on the plat must be from the outer boundaries of Section.
5. If additional space is needed for listing owners and their respective interests as required in question 3, Section A, please use space below

* "Owner" means the person who has the right to drill into and to produce from any pool and to appropriate the production either for himself or for himself and another. (65-3-29 (e) NMSA 1953 Comp.)