

(SUBMIT IN TRIPLICATE)

UNITED STATES  
DEPARTMENT OF THE INTERIOR  
GEOLOGICAL SURVEY

Land Office New Mexico  
Lease No. 0319  
Unit NW/4

SUNDRY NOTICES AND REPORTS ON WELLS

NOTICE OF INTENTION TO DRILL	<input checked="" type="checkbox"/>	SUBSEQUENT REPORT OF WATER SHUT-OFF	<input type="checkbox"/>
NOTICE OF INTENTION TO CHANGE PLANS	<input type="checkbox"/>	SUBSEQUENT REPORT OF SHOOTING OR ACIDIZING	<input type="checkbox"/>
NOTICE OF INTENTION TO TEST WATER SHUT-OFF	<input type="checkbox"/>	SUBSEQUENT REPORT OF ALTERING CASING	<input type="checkbox"/>
NOTICE OF INTENTION TO RE-DRILL OR REPAIR WELL	<input type="checkbox"/>	SUBSEQUENT REPORT OF RE-DRILLING OR REPAIR	<input type="checkbox"/>
NOTICE OF INTENTION TO SHOOT OR ACIDIZE	<input type="checkbox"/>	SUBSEQUENT REPORT OF ABANDONMENT	<input type="checkbox"/>
NOTICE OF INTENTION TO PULL OR ALTER CASING	<input type="checkbox"/>	SUPPLEMENTARY WELL HISTORY	<input type="checkbox"/>
NOTICE OF INTENTION TO ABANDON WELL	<input type="checkbox"/>		

(INDICATE ABOVE BY CHECK MARK NATURE OF REPORT, NOTICE, OR OTHER DATA)

June 2, 1954, 19

Turner-Ballard-Federal

Well No. 2-14 is located 1,650 ft. from N line and 990 ft. from W line of sec. 14

NW/4 Sec. 14  
(1/4 Sec. and Sec. No.)

T 26 N  
(Twp.)

R 9 W  
(Range)

N. M. P. M.  
(Meridian)

East Kutz Extension  
(Field)

San Juan County  
(County or Subdivision)

New Mexico.  
(State or Territory)

The elevation ~~of the derrick floor~~ above sea level is 6,313 ft. - ungraded ground.

DETAILS OF WORK

(State names of and expected depths to objective sands; show sizes, weights, and lengths of proposed casings; indicate mudding jobs, cementing points, and all other important proposed work)

Propose to drill with rotary tools to the top of the Pictured Cliff Formation - expected between 1,800 feet and 2,100 feet below surface - then drill 4-3/4" rat hole through Pictured Cliff formation. Completion with cable tools - and shooting with solidified nitro glycerin or sand oil fracturing.

Casing program: 100 feet of 3-5/8" new 8 wd. thd. 32# casing. Circulate cement to surface.

5-1/2" O.D. 17# seamless casing to be set on top of Pictured Cliffs formation, cemented with 150 sacks regular cement.

1" tubing to be set within 50 feet of total depth for production.

I understand that this plan of work must receive approval in writing by the Geological Survey before operations may be commenced.

Company Glenn Turner

Address Box 723 - Farmington, New Mexico.

Home Office: 1711 Mercantile Bank Building

Dallas 1, Texas.

By

Title

C. Beeson Neal

Agent in Farmington

THE UNITED STATES OF AMERICA  
DO NOT  
WARRANT

# UNITED STATES OF AMERICA

THE UNITED STATES OF AMERICA  
DO NOT  
WARRANT

THE UNITED STATES OF AMERICA  
DO NOT  
WARRANT

THE UNITED STATES OF AMERICA  
DO NOT  
WARRANT

THE UNITED STATES OF AMERICA  
DO NOT  
WARRANT

THE UNITED STATES OF AMERICA  
DO NOT  
WARRANT

THE UNITED STATES OF AMERICA  
DO NOT  
WARRANT

THE UNITED STATES OF AMERICA  
DO NOT  
WARRANT

THE UNITED STATES OF AMERICA  
DO NOT  
WARRANT

THE UNITED STATES OF AMERICA  
DO NOT  
WARRANT

THE UNITED STATES OF AMERICA  
DO NOT  
WARRANT

THE UNITED STATES OF AMERICA  
DO NOT  
WARRANT

THE UNITED STATES OF AMERICA  
DO NOT  
WARRANT

Company **J. OLSON TURNER**  
**NEW MEXICO OIL CO.**

Lease **Ballard-Federal** Well No. **2-14**

Sec. **14**, T. **26 N**, R. **9 W.**, **N.M.P.M.**

Location **1650' from the North line and 990' from the West line.**

Elevation **6313 Ungraded ground.**

RECEIVED  
JUN 2 1954  
U. S. GEOLOGICAL SURVEY  
WASHINGTON, D. C.

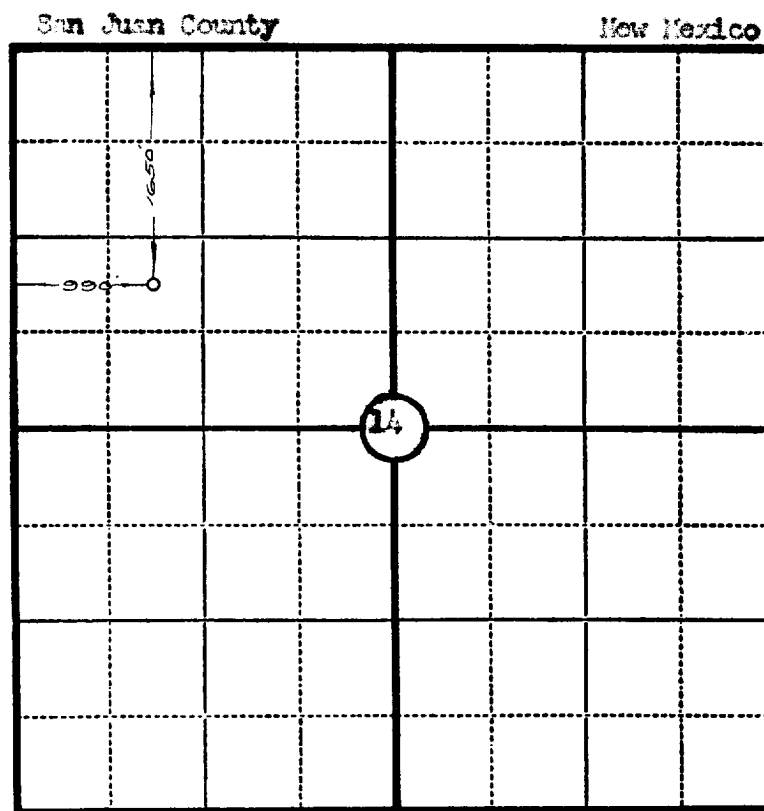

This is to certify that the above plat was prepared from field notes of actual surveys made by me or under my supervision and that the same are true and correct to the best of my knowledge and belief.

Seal:

Registered Professional Charles J. Finkles  
Engineer and Land Surveyor. N. Mex. Reg. No. 1302

Surveyed **11 May**, 19**54**

