

(SUBMIT IN TRIPLICATE)

UNITED STATES
DEPARTMENT OF THE INTERIOR
GEOLOGICAL SURVEY

Land Office New Mexico
Lease No. Q3154
Unit S/2

SUNDRY NOTICES AND REPORTS ON WELLS

NOTICE OF INTENTION TO DRILL	XXXX	SUBSEQUENT REPORT OF WATER SHUT-OFF
NOTICE OF INTENTION TO CHANGE PLANS		SUBSEQUENT REPORT OF SHOOTING OR ACIDIZING
NOTICE OF INTENTION TO TEST WATER SHUT-OFF		SUBSEQUENT REPORT OF ALTERING CASING
NOTICE OF INTENTION TO RE-DRILL OR REPAIR WELL		SUBSEQUENT REPORT OF RE-DRILLING OR REPAIR
NOTICE OF INTENTION TO SHOOT OR ACIDIZE		SUBSEQUENT REPORT OF ABANDONMENT
NOTICE OF INTENTION TO PULL OR ALTER CASING		SUPPLEMENTARY WELL HISTORY
NOTICE OF INTENTION TO ABANDON WELL		

RECEIVED
NOV 21 1961
U. S. GEOLOGICAL SURVEY
FARMINGTON, NEW MEXICO

(INDICATE ABOVE BY CHECK MARK NATURE OF REPORT, NOTICE, OR OTHER DATA)

November 21, 1961, 19

Well No. 14-14 is located 1,850 ft. from S line and 790 ft. from W line of sec. 14

SW/4 Section 14 Township 26-North, Range 9-West N.M.P.M.
(1/4 Sec. and Sec. No.) (Twp.) (Range) (Meridian)
Basin Dakota San Juan County New Mexico
(Field) (County or Subdivision) (State or Territory)

RECEIVED
NOV 22 1961
OIL & GAS COM.

The elevation of the derrick floor above sea level is 6,336 ft.

DETAILS OF WORK

(State names of and expected depths to objective sands; show sizes, weights, and lengths of proposed casings; indicate mudding jobs, cementing points, and all other important proposed work)

Dakota Test. South half of Section 14 (320 Acres) is dedicated to this well.

Casing program: Set 8-5/8" at 300 feet with 200 sacks of cement - circulated to surface.

Set 5-1/2" on bottom - expected at 6800 feet - cement with 200 sacks - more if needed.

Pictured Cliffs zone will be protected by setting D. V. tool and cementing.

If commercial production indicated - well will be perforated, sand fractured, and tubing set for production.

I understand that this plan of work must receive approval in writing by the Geological Survey before operations may be commenced.

Company J. Glenn Turner

Address P. O. Box 728

Farmington, New Mexico

By C. Beeson Neal
C. Beeson Neal, Agent in Farmington
Title _____

NEW MEXICO OIL CONSERVATION COMMISSION

Well Location and Acreage Dedication Plat

Section A.

Date November 21, 1961

Operator J. GLENN TURNER Lease BALLARD
 Well No. 14-14 Unit Letter L Section 14 Township 26 NORTH Range 9 WEST, NMPM
 Located 1850 Feet From the SOUTH Line, 790 Feet From the WEST Line
 County SAN JUAN G. L. Elevation 6326.0 Dedicated Acreage 320 Acres
 Name of Producing Formation Dakota Pool Basin Dakota

1. Is the Operator the only owner in the dedicated acreage outlined on the plat below?
 Yes X No _____
2. If the answer to question one is "no", have the interests of all the owners been consolidated by communitization agreement or otherwise? Yes _____ No _____. If answer is "yes", Type of Consolidation.
3. If the answer to question two is "no", list all the owners and their respective interests below:

Owner

Land Description

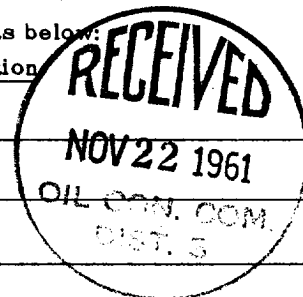

Section B.

Note: All distances must be from outer boundaries of section.

This is to certify that the information
 in Section A above is true and complete
 to the best of my knowledge and belief.

J. GLENN TURNER
 (Operator)
 (Representative)

C. Beeson Neal, Agent in Farmington
 (Address)

P. O. Box 728

Farmington, New Mexico

Ref: GLO plat dated 10 May 1949

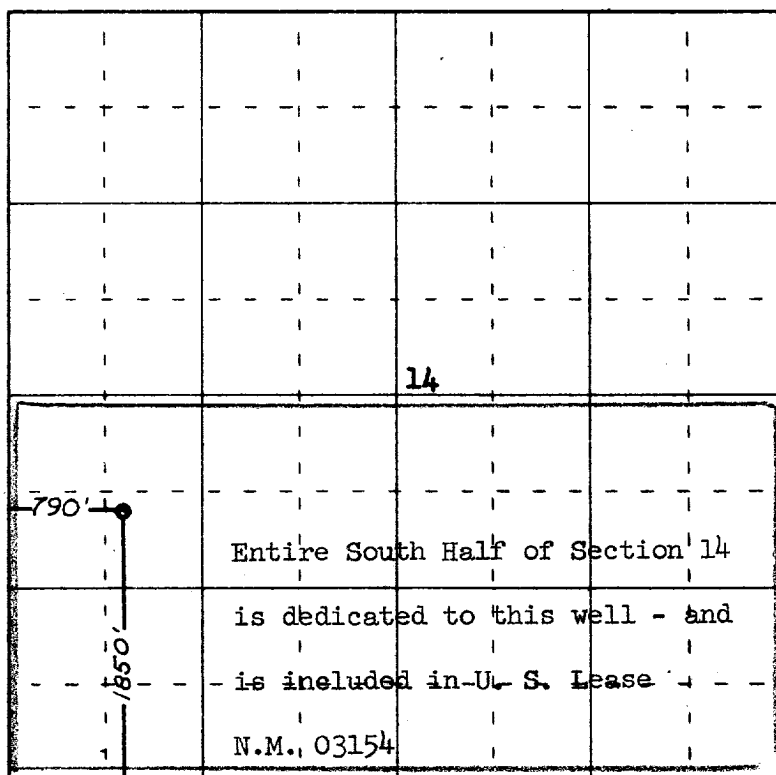

0 330 660 990 1320 1650 1980 2310 2640 2000 1800 1600 1400 1200 1000 800 600 400 200 0

Scale 4 inches equal 1 mile

This is to certify that the above plat was prepared from field notes of actual surveys made by me or under my supervision and that the same are true and correct to the best of my knowledge and belief.

Date Surveyed 16 November 1961

James P. Leese
 Registered Professional Engineer and/or Land Surveyor
 James P. Leese N. Mex. Reg. No. 1463
 San Juan Engineering Company

(Seal)
 Farmington, New Mexico