

(SUBMIT IN TRIPLICATE)

UNITED STATES  
DEPARTMENT OF THE INTERIOR  
GEOLOGICAL SURVEY

Land Office **San Juan Co.**

Lease No. **27**

Unit **27/4 Sec. 17, T4N, 10E, R1E, S.1.E.P.M., San Juan Co., New Mexico**

SUNDRY NOTICES AND REPORTS ON WELLS

NOTICE OF INTENTION TO DRILL.....	<input checked="" type="checkbox"/>	SUBSEQUENT REPORT OF WATER SHUT-OFF.....	
NOTICE OF INTENTION TO CHANGE PLANS.....		SUBSEQUENT REPORT OF SHOOTING OR ACIDIZING.....	
NOTICE OF INTENTION TO TEST WATER SHUT-OFF.....		SUBSEQUENT REPORT OF ALTERING CASING.....	
NOTICE OF INTENTION TO RE-DRILL OR REPAIR WELL.....		SUBSEQUENT REPORT OF RE-DRILLING OR REPAIR.....	
NOTICE OF INTENTION TO SHOOT OR ACIDIZE.....		SUBSEQUENT REPORT OF ABANDONMENT.....	
NOTICE OF INTENTION TO PULL OR ALTER CASING.....		SUPPLEMENTARY WELL HISTORY.....	
NOTICE OF INTENTION TO ABANDON WELL.....			

(INDICATE ABOVE BY CHECK MARK NATURE OF REPORT, NOTICE, OR OTHER DATA)

**July 27, 1958**

Well No. **2-2** is located **1450** ft. from **N** line and **1450** ft. from **E** line of sec. **17**

**27/4 Sec. 17**

(1/4 Sec. and Sec. No.)

**24N**

(Twp.)

**2E**

(Range)

**S.1.E.P.M.**

(Meridian)

**Ballard Pictured Cliffs**

(Field)

**San Juan County**

(County or Subdivision)

**New Mexico**

(State or Territory)

The elevation of the derrick floor above sea level is \_\_\_\_\_ ft. **to be determined.**

DETAILS OF WORK

(State names of and expected depths to objective sands; show sizes, weights, and lengths of proposed casings; indicate mudding jobs, cementing points, and all other important proposed work)

**The objective sand is the Pictured Cliffs Sandstone anticipated at approximately 2200'.**

**Proposed Casing Program: 100' 3-4/8" 2-55 cemented to surface  
2200' 3-4/8" 2-55 cemented with 100 sacks**

**Rotary Tools will be employed from surface to estimated 22 of 2200'.**

**The well will be sand fraced in an effort to stimulate production.**

RECEIVED

JUL 28 1958

U. S. GEOLOGICAL SURVEY  
FARMINGTON, NEW MEXICO

I understand that this plan of work must receive approval in writing by the Geological Survey before operations may be commenced.

Company **SEVEN UNION GAS COMPANY**

Address **1004 WEST BUILDING**

**DALLAS 1, TEXAS**

By **L. S. Mendenhall**

Title **Exploration Engineer**

NEW MEXICO OIL CONSERVATION COMMISSION  
Well Location and Acreage Dedication Plat

Section A.

Date July 24, 1958

Operator SOUTHERN UNION GAS COMPANY Lease NEWSON 3-B  
Well No. \_\_\_\_\_ Unit Letter G Section 17 Township 26 NORTH Range 8 WEST NMPM  
Located 1650 Feet From THE NORTH Line, 1650 Feet From THE EAST Line  
County SAN JUAN G. L. Elevation \_\_\_\_\_ Dedicated Acreage 160 Acres  
Name of Producing Formation Pictured Cliffs Pool Millard Pictured Cliffs

1. Is the Operator the only owner\* in the dedicated acreage outlined on the plat below?  
Yes XI No \_\_\_\_\_.
2. If the answer to question one is "no," have the interests of all the owners been consolidated by communitization agreement or otherwise? Yes \_\_\_\_\_ No \_\_\_\_\_. If answer is "yes," Type of Consolidation \_\_\_\_\_
3. If the answer to question two is "no," list all the owners and their respective interests below:  
REF. GLO Plat dated: 4 November 1882

Owner

Land Description

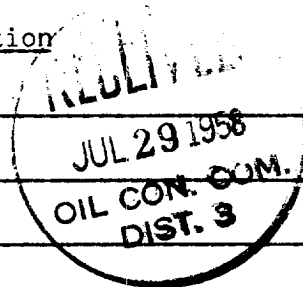

Section B

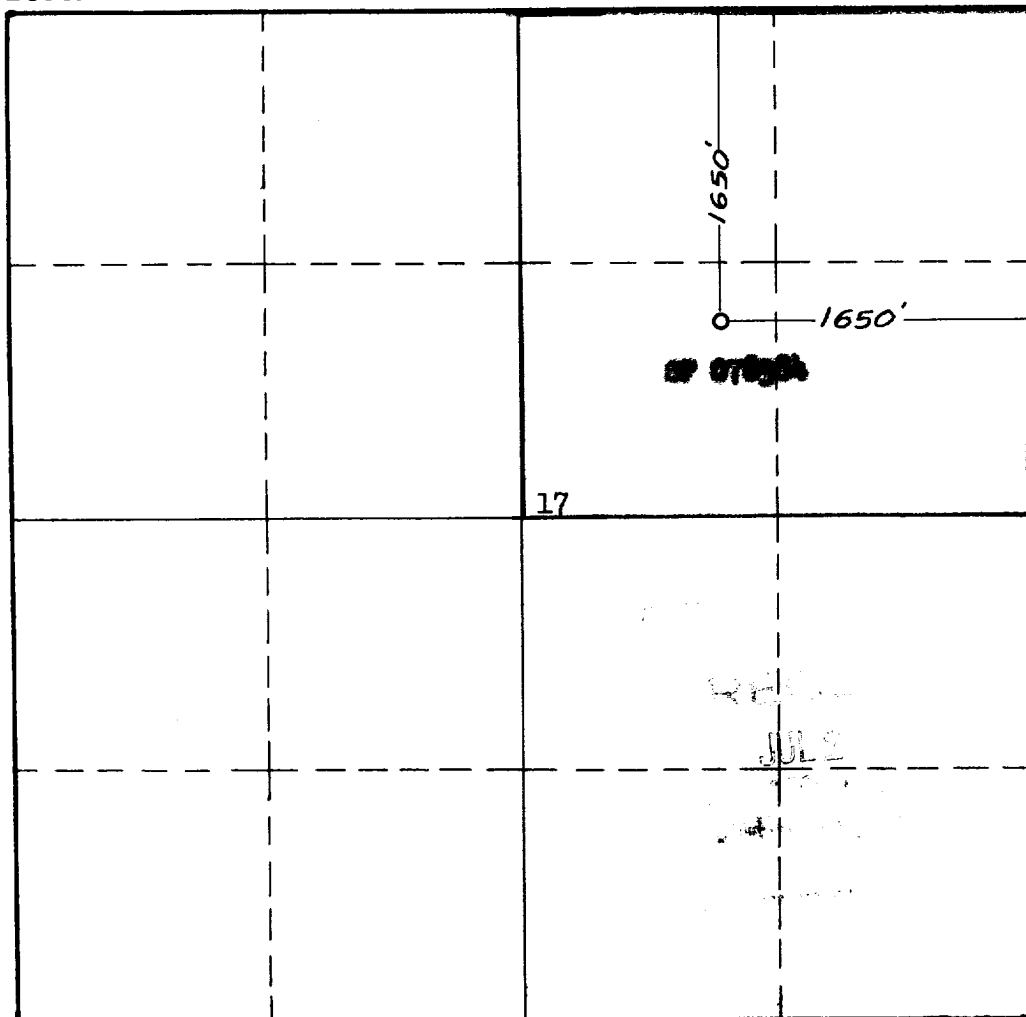

This is to certify that the information in Section A above is true and complete to the best of my knowledge and belief.

SOUTHERN UNION GAS COMPANY

(Operator)

J. L. McManis  
(Representative)

Dart Bldg., Dallas, Texas

Address

This is to certify that the well location shown on the plat in Section B was plotted from field notes of actual surveys made by me or under my supervision and that the same is true and correct to the best of my knowledge and belief.

Date Surveyed 26 FEBRUARY 1956

Charles J. Finklea  
Registered Professional  
Engineer and/or Land Surveyor.  
CHARLES J. FINKLEA

Certificate No. 1302

INSTRUCTIONS FOR COMPLETION:

1. Operator shall furnish and certify to the information called for in Section A.
2. Operator shall outline the dedicated acreage for both oil and gas wells on the plat in Section B.
3. A registered professional engineer or land surveyor registered in the State of New Mexico or approved by the Commission shall show on the plat the location of the well and certify this information in the space provided.
4. All distances shown on the plat must be from the outer boundaries of Section.
5. If additional space is needed for listing owners and their respective interests as required in question 3, Section A, please use space below

\* "Owner" means the person who has the right to drill into and to produce from any pool and to appropriate the production either for himself or for himself and another. (65-3-29 (e) NMSA 1953 Comp.)