

OK

*Dennis A. Faust*  
**EL PASO FIELD SERVICES**  
**PIT CLOSURE REPORT**  
**DEPUTY OIL & GAS INSPECTOR**

AUG 09 1999

**BOND FED #2**  
**Meter/Line ID - 73180**

*Approved*

**SITE DETAILS**

Legals - Twn: 26      Rng: 8  
NMOCD Hazard Ranking: 30  
Operator: Great Western Drilling Company

Sec: 13      Unit: D  
Land Type: BLM

**PREVIOUS ACTIVITIES**

Site Assessment: Sep-94

Test Excavation: Sep-94

A test excavation was conducted on Pit #2 and a soil sample was collected at 12 feet beneath ground surface (bgs). The headspace soil reading from the excavation bottom was 6 ppm. Soil analytical results were as follows: TPH (418.1) 77mg/kg.

**CONCLUSIONS**

The primary source, discharge to the pit, has been removed and the pit has been closed for over four years.

Groundwater was not encountered and an analytical soil sample, collected from below the pit, was below New Mexico Oil Conservation Division (NMOCD) standards for a pit with a hazard ranking of 30. Impact to groundwater is unlikely and no excavation of soils from the pit was required to meet closure standards. The pit was filled with clean fill dirt during final pit closure activities.

**RECOMMENDATIONS**

- EPFS requests closure at this site.

**ATTACHMENT**

Field Pit Assessment Form  
Field Pit Remediation/Closure Form  
Laboratory Analytical Results  
Chain of Custody

RECEIVED  
JUN 22 1999  
OIL CON. DIV.  
DIST. 3

# FIELD PIT SITE ASSESSMENT FORM

GENERAL	<p>Meter: <u>73180</u> <sup>WHL</sup> <u>10/10/94</u> Location: <u>Bond Fed #2</u> <sup>PC</sup> (Pit 2)          Operator #: <u>N/A</u> Operator Name: <u>N/A</u> P/L District: <u>Ballard</u>          Coordinates: Letter: <u>X</u> Section <u>13</u> Township: <u>26</u> Range: <u>8</u>          Or Latitude <u>10/10/94</u> Longitude _____          Pit Type: Dehydrator _____ Location Drip: <u>X</u> Line Drip: _____ Other: _____          Site Assessment Date: <u>9/27/94</u> Area: <u>07</u> Run: <u>51</u></p>
SITE ASSESSMENT	<p><b>NMOCD Zone:</b>          (From NMOCD Maps) Inside <input type="checkbox"/> (1) Outside <input checked="" type="checkbox"/> (2)</p> <p><b>Land Type:</b> BLM <input checked="" type="checkbox"/> (1) State <input type="checkbox"/> (2) Fee <input type="checkbox"/> (3) Indian _____</p> <p><b>Depth to Groundwater</b>          Less Than 50 Feet (20 points) <input checked="" type="checkbox"/> (1)          50 Ft to 99 Ft (10 points) <input type="checkbox"/> (2)          Greater Than 100 Ft (0 points) <input type="checkbox"/> (3)</p> <p><b>Wellhead Protection Area :</b>          Is it less than 1000 ft from wells, springs, or other sources of fresh water extraction? , or ; Is it less than 200 ft from a private domestic water source? <input type="checkbox"/> (1) YES (20 points) <input checked="" type="checkbox"/> (2) NO (0 points)</p> <p><b>Horizontal Distance to Surface Water Body</b>          Less Than 200 Ft (20 points) <input type="checkbox"/> (1)          200 Ft to 1000 Ft (10 points) <input checked="" type="checkbox"/> (2)          Greater Than 1000 Ft (0 points) <input type="checkbox"/> (3)</p> <p>Name of Surface Water Body <u>Big Rincon</u>          (Surface Water Body : Perennial Rivers, Major Wash, Streams, Creeks, Irrigation Canals, Ditches, Lakes, Ponds)          Distance to Nearest Ephemeral Stream <input type="checkbox"/> (1) &lt; 100' (Navajo Pits Only) <input type="checkbox"/> (2) &gt; 100'</p> <p><b>TOTAL HAZARD RANKING SCORE:</b> <u>30</u> POINTS</p>
REMARKS	<p>Remarks : <u>Redline Book - Inside Vulnerable Zone - Outside</u>  <u>Two pits, pit #2 is dry. Will close one pit.</u>  <u>PUSH IN</u></p>

## ORIGINAL PIT LOCATION

## ORIGINAL PIT LOCATION

Original Pit : a) Degrees from North 68° Footage from Wellhead 209'  
 b) Length : 15' Width : 13' Depth : 1'

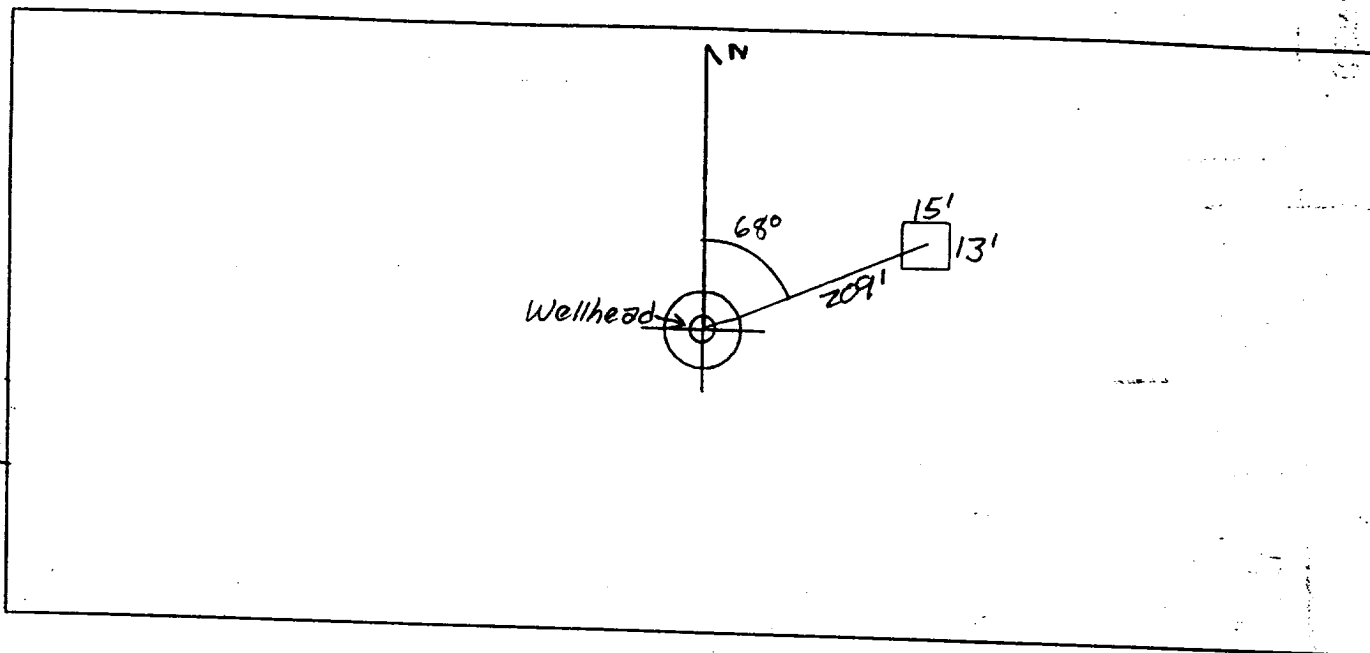

## REMARKS

## Remarks :

Pictures @ 1405, (13-16, Roll 2)

Dump Truck

Well is abandoned and meters are removed. There is no location sign. Redline book shows meter #'s: 93-128 & 93-129 at this site. Dual Completion.

73179 and 73180

KDK  
10/10/94

93128 and 93129 are in location C/13 | 28/8

with the names Jones ALS #SA PL

Jones ALS #SA MV

KDK 10/10/94

Completed By:

Sarah Kelly  
Signature

9/27/94  
Date

# FIELD PIT REMEDIATION/CLOSURE FORM

GENERAL	<p>73180 <sup>KDK</sup> 10/10/94          Meter: <u>HA</u> Location: <u>Bond Fed #2 PC Pit 2</u> <sup>work 10/10/94</sup>          Coordinates: Letter: <u>C</u> Section <u>13</u> Township: <u>26</u> Range: <u>8</u>          Or Latitude _____ Longitude _____          Date Started : <u>9-30-94</u> Run: <u>07</u> <u>51</u></p>
FIELD OBSERVATIONS	<p>Sample Number(s): <u>VW369</u>          Sample Depth: <u>12'</u> Feet          Final PID Reading <u>6</u> PID Reading Depth <u>12'</u> Feet          Yes No          Groundwater Encountered <input type="checkbox"/> <input checked="" type="checkbox"/> Approximate Depth _____ Feet</p>
CLOSURE	<p>Remediation Method :          Excavation <input type="checkbox"/> Approx. Cubic Yards _____          Onsite Bioremediation <input type="checkbox"/>          Backfill Pit Without Excavation <input checked="" type="checkbox"/>          Soil Disposition:          Envirotech <input type="checkbox"/> <input type="checkbox"/> Tierra          Other Facility <input type="checkbox"/> Name: _____          Pit Closure Date: <u>9-30-94</u> Pit Closed By: <u>BEI</u></p>
REMARKS	<p>Remarks : _____          _____          _____</p>
SIGNATURE	<p>Signature of Specialist: <u>Vale Wilson</u></p>



## FIELD SERVICES LABORATORY

### ANALYTICAL REPORT

#### PIT CLOSURE PROJECT - Soil Samples Outside the GWV Zone

#### SAMPLE IDENTIFICATION

	Field ID	Lab ID
SAMPLE NUMBER:	vw 369	946296
MTR CODE   SITE NAME:	<del>Bandied #2</del> P.F. 2 73180	N/A
SAMPLE DATE   TIME (Hrs):	9-30-94	1530
SAMPLED BY:	N/A	
DATE OF TPH EXT.   ANAL.:	10-3-94	
DATE OF BTEX EXT.   ANAL.:	N/A	N/A
TYPE   DESCRIPTION:	VG	Brown/Gray Sand stone.

REMARKS:

#### RESULTS

PARAMETER	RESULT	UNITS	QUALIFIERS			
			DF	Q	M(g)	V(ml)
TPH (418.1)	77	MG/KG			2.04	28
HEADSPACE PID	6	PPM				
PERCENT SOLIDS	91.7	%				

-- TPH is by EPA Method 418.1 --

Narrative:

DF = Dilution Factor Used

Approved By: 

Date: 10/6/94