

(SUBMIT IN TRIPLICATE)

UNITED STATES
DEPARTMENT OF THE INTERIOR
GEOLOGICAL SURVEY

Land Office Santa Fe

Lease No. SF 078430

Unit N/2, Sec. 14, T-26N,
R-6W, San Juan County,
New Mexico

SUNDRY NOTICES AND REPORTS ON WELLS

NOTICE OF INTENTION TO DRILL.....	<input checked="" type="checkbox"/>	SUBSEQUENT REPORT OF WATER SHUT-OFF.....	
NOTICE OF INTENTION TO CHANGE PLANS.....		SUBSEQUENT REPORT OF SHOOTING OR ACIDIZING.....	
NOTICE OF INTENTION TO TEST WATER SHUT-OFF.....		SUBSEQUENT REPORT OF ALTERING CASING.....	
NOTICE OF INTENTION TO RE-DRILL OR REPAIR WELL.....		SUBSEQUENT REPORT OF RE-DRILLING OR REPAIR.....	
NOTICE OF INTENTION TO SHOOT OR ACIDIZE.....		SUBSEQUENT REPORT OF ABANDONMENT.....	
NOTICE OF INTENTION TO PULL OR ALTER CASING.....		SUPPLEMENTARY WELL HISTORY.....	
NOTICE OF INTENTION TO ABANDON WELL.....			

(INDICATE ABOVE BY CHECK MARK NATURE OF REPORT, NOTICE, OR OTHER DATA)

Well No. 9 Nickson

July 15, 1963

Well No. 9 is located 830 ft. from N line and 815 ft. from W line of sec. 14

NW/4, NW/4, Sec. 14 26-N 8-W N.M.P.M.
(Sec. and Sec. No.) (Twp.) (Range) (Meridian)
Basin Dakota San Juan New Mexico
(Field) (County or Subdivision) (State or Territory)

The elevation of the derrick floor above sea level is 7040 ft. Undrilled G.L.

DETAILS OF WORK

(State names of and expected depths to objective sands; show sizes, weights, and lengths of proposed casings; indicate mudding jobs, cementing points, and all other important proposed work)

To drill a well to the Dakota formation. Total depth 7550 ft.
Casing Program: Surface: 10-3/4", 32.75#, H-40 at 250 ft. Cemented to surface.
Production: 4-1/2", 10.50#, J-55 at 7550 w/250 sx.
Tubing: 1-1/2", EUE, 2.90#, JOW at approx. 7400 ft.
Baker stage collar will be set at approx. 1100 ft. under Pictured Cliffs formation and Cement circulated to surface.

Rotary tools will be employed from surface to total depth.

Well will be sand water fraced to stimulate production.

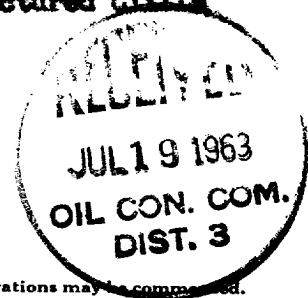

I understand that this plan of work must receive approval in writing by the Geological Survey before operations may be commenced.

Company SOUTHERN UNION PRODUCTION COMPANY

Address P. O. Box 608
Farmington, New Mexico

By Gilbert D. Noland, Jr.

Title Drilling Superintendent

NEW MEXICO OIL CONSERVATION COMMISSION

Well Location and Acreage Dedication Plat

Section A.

Date **July 15, 1963**

Operator **SOUTHERN UNION PRODUCTION COMPANY** Lease **NICKSON**
 Well No. **9** Unit Letter **D** Section **14** Township **26 NORTH** Range **8 WEST** NMPM
 Located **830** Feet From **the NORTH** Line, **815** Feet From **the WEST** Line
 County **SAN JUAN** G. L. Elevation **7040'** Dedicated Acreage _____ Acres
 Name of Producing Formation **DAKOTA** Pool **BASIN DAKOTA**

1. Is the Operator the only owner in the dedicated acreage outlined on the plat below?
 Yes ☒ No ☐
2. If the answer to question one is "no", have the interests of all the owners been consolidated by communization agreement or otherwise? Yes _____ No _____. If answer is "yes", Type of Consolidation.
3. If the answer to question two is "no", list all the owners and their respective interests below:

Owner

Land Description

RECEIVED**JUL 19 1963****OIL CON. COM.
DIST. 3****RECEIVED****JUL 15 1963**U. S. GEOLOGICAL SURVEY
FARMINGTON, NEW MEXICO

Section B.

Note: All distances must be from outer boundaries of section.

This is to certify that the information
 in Section A above is true and complete
 to the best of my knowledge and belief.

SOUTHERN UNION PRODUCTION CO.

Gilbert D. Holand Jr.
 (Operator)
Gilbert D. Holand Jr.
 (Representative)

Drilling Superintendent
 (Address)

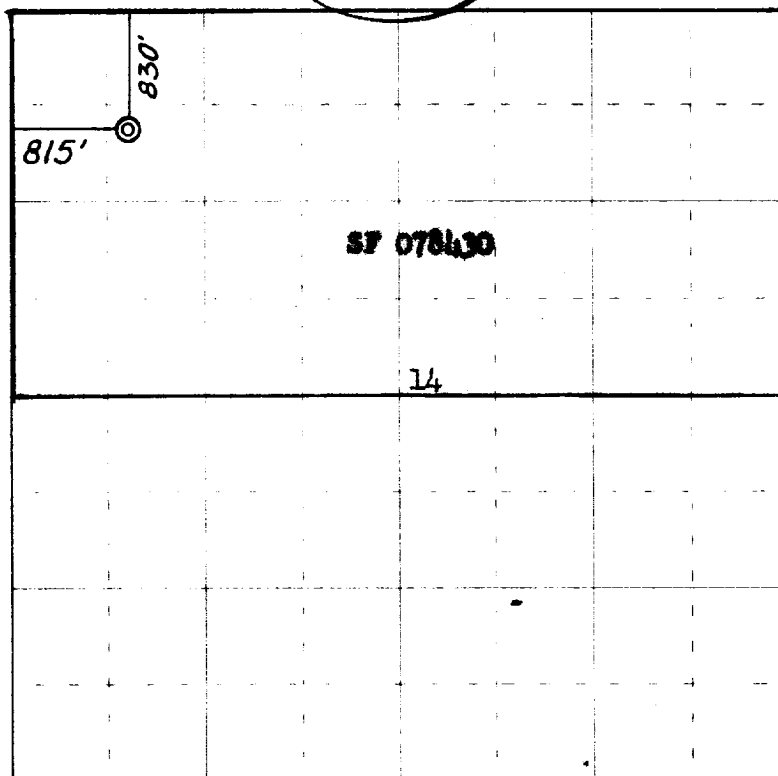
P. O. Box 808**Farmington, New Mexico**

0 330 660 990 1320 1650 1980 2310 2640 2000 1500 1000 500 0

Scale 4 inches equal 1 mile

Ref: GLO plat dated 1 June 1959

This is to certify that the above plat was prepared from field notes of actual surveys
 made by me or under my supervision and that the same are true and correct to the best
 of my knowledge and belief.

Date Surveyed **10 July 1963**

James P. Leese
 Registered Professional Engineer and/or Land Surveyor
James P. Leese, N. Mex. Reg. No. 1463
 San Juan Engineering Company

Farmington, New Mexico