

UNITED STATES  
DEPARTMENT OF THE INTERIOR  
GEOLOGICAL SURVEY

APPLICATION FOR PERMIT TO DRILL, DEEPEN, OR PLUG BACK

1a. TYPE OF WORK  
 DRILL  DEEPEN  PLUG BACK   
 b. TYPE OF WELL  
 OIL WELL  GAS WELL  OTHER   
 SINGLE ZONE  MULTIPLE ZONE

2. NAME OF OPERATOR  
**PAN AMERICAN PETROLEUM CORPORATION**

3. ADDRESS OF OPERATOR  
**P. O. Box 480, Farmington, New Mexico**

4. LOCATION OF WELL (Report location clearly and in accordance with any State requirements.\*)  
 At surface **660' FNL and 2130' FNL**  
 At proposed prod. zone **same**

14. DISTANCE IN MILES AND DIRECTION FROM NEAREST TOWN OR POST OFFICE\*  
**22 miles south of Shiprock, New Mexico**

15. DISTANCE FROM PROPOSED\* LOCATION TO NEAREST PROPERTY OR LEASE LINE, FT. (Also to nearest drig. unit line, if any) **660'**

16. NO. OF ACRES IN LEASE  
**2544.50**

18. DISTANCE FROM PROPOSED LOCATION\* TO NEAREST WELL, DRILLING, COMPLETED, OR APPLIED FOR, ON THIS LEASE, FT. **1500'**

19. PROPOSED DEPTH  
**6500'**

21. ELEVATIONS (Show whether DF, RT, GR, etc.)  
**Will report later.**

22. APPROX. DATE WORK WILL START\*  
**9-1-65**

23. PROPOSED CASING AND CEMENTING PROGRAM

SIZE OF HOLE	SIZE OF CASING	WEIGHT PER FOOT	SETTING DEPTH	QUANTITY OF CEMENT
17-1/4"	13-3/8"	48#	100'	100 sacks
11"	8-5/8"	24#	1500'	500 sacks
7-7/8"	4-1/2"	10.5#	6500'	1000 sacks (2 stage tool set 100' above DeChelly)

5. LEASE DESIGNATION AND SERIAL NO.  
**14-20-603-5035**

6. IF INDIAN, ALLOTTEE OR TRIBE NAME  
**Navajo Tribe**

7. UNIT AGREEMENT NAME

8. FARM OR LEASE NAME  
**Navajo Tribal "N"**

9. WELL NO.  
**8**

10. FIELD AND POOL, OR WILDCAT  
**Tocito Dome Pennsylvanian "D"**

11. SEC., T., R., M., OR BLK. AND SURVEY OR AREA  
**NW/4 NE/4 Section 17, T-26-N, R-18-W**

12. COUNTY OR PARISH  
**San Juan**

13. STATE  
**New Mexico**

Location Plat is attached.

Any logs run on well will be submitted upon completion of well.

Verbally approved August 31, 1965, M. L. Seelinger to F. H. Hollingsworth

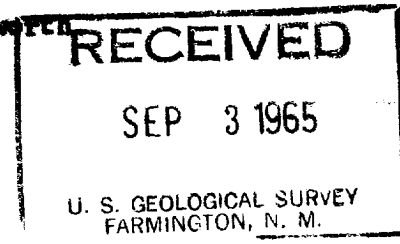

IN ABOVE SPACE DESCRIBE PROPOSED PROGRAM: If proposal is to deepen or plug back, give data on present productive zone and proposed new productive zone. If proposal is to drill or deepen directionally, give pertinent data on subsurface locations and measured and true vertical depths. Give blowout preventer program, if any.

24. ORIGINAL SIGNED BY G. W. Eaton, Jr. TITLE Area Engineer DATE September 1, 1965  
 SIGNED G. W. Eaton, Jr.  
 (This space for Federal or State office use)

PERMIT NO. \_\_\_\_\_ APPROVAL DATE \_\_\_\_\_  
 APPROVED BY GW TITLE \_\_\_\_\_  
 CONDITIONS OF APPROVAL, IF ANY:



## Instructions

**General:** This form is designed for submitting proposals to perform certain well operations, as indicated, on all types of lands and leases for appropriate action by either a Federal or a State agency, or both, pursuant to applicable Federal and/or State laws and regulations. Any necessary special instructions concerning the use of this form and the number of copies to be submitted, particularly with regard to local, area, or regional procedures and practices, either are shown below or will be issued by, or may be obtained from, the local Federal and/or State office.

**Item 1:** If the proposal is to redrill to the same reservoir at a different subsurface location or to a new reservoir, use this form with appropriate notations. Consult applicable State or Federal regulations concerning subsequent work proposals or reports on the well.

**Item 4:** If there are no applicable State requirements, locations on Federal or Indian land should be described in accordance with Federal requirements. Consult local State or Federal office for specific instructions.

**Item 14:** Needed only when location of well cannot readily be found by road from the land or lease description. A plat, or plats, separate or on this reverse side, showing the roads to, and the surveyed location of, the well, and any other required information, should be furnished when required by Federal or State agency offices.

**Items 15 and 18:** If well is to be, or has been directionally drilled, give distances for subsurface location of hole in any present or objective production zone.

**Item 22:** Consult applicable Federal or State regulations, or appropriate officials, concerning approval of the proposal before operations are started.

NEW MEXICO OIL CONSERVATION COMMISSION  
WELL LOCATION AND ACREAGE DEDICATION PLAT

Form O-152  
Supersede O-126  
Effective 1-1-61

All distances are in feet or fractions of the Section.				
Operator <b>Pan American Petroleum Corporation</b>				Well No. <b>8</b>
Section <b>B</b>	Block <b>17</b>	Township <b>26 North</b>	Range <b>18 West</b>	County <b>San Juan</b>
Well Name <b>660</b>				
Direction of Flow <b>Report Later</b>		Planning Position <b>Pennsylvanian "D"</b>		Dedicated Acreage <b>160</b>
Distance from the North <b>2130</b>		Distance from the East <b>660</b>		
Geologic Formation <b>Coals: Dome Pennsylvanian "D"</b>				

1. Outline the acreage dedicated to the subject well, by colored pencil or hachure marks on the plat below.
2. If more than one lease is dedicated to the well outline each and identify the ownership thereof (both as to working interest and royalty).
3. If more than one lease of different ownership is dedicated to the well, have the interests of all owners been consolidated by communitization, unitization, force-pooling, etc.?

Yes  No If answer is "yes," type of consolidation \_\_\_\_\_

If answer is "no," list the owners and tract descriptions which have actually been consolidated. (Use reverse side of this form if necessary.) \_\_\_\_\_

If all possible will be assigned to the well and the interests have been consolidated (by communitization, unitization, force-pooling, or otherwise) or until a non-prod. land unit, unitizing such interests, has been approved by the Commission.

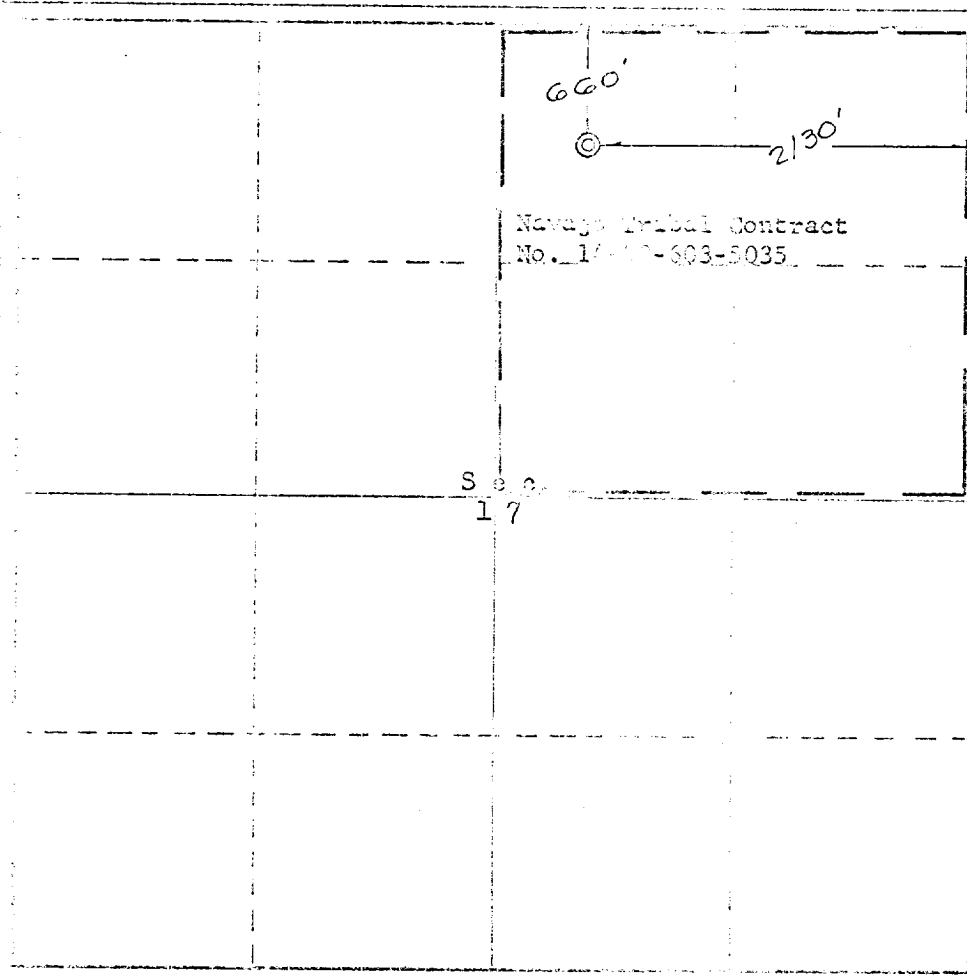

**CERTIFICATION**

I hereby certify that the information contained herein is true and complete to the best of my knowledge and belief.

Name G. W. Eaton, Jr.  
 Position Area Engineer  
 Company Pan American Petr. Corp.  
 Date September 1, 1965

Date Surveyed August 31, 1965  
 Registered Professional Engineer and/or Land Surveyor  
Ernest V. ECHOHA  
 Certificate No. 2600