

**NEW MEXICO OIL CONSERVATION COMMISSION
WELL LOCATION AND ACREAGE DEDICATION PLAT**

Form C-102
Supersedes C-128
Effective 1-1-65

All distances must be from the outer boundaries of the Section.

Operator AMOCO PRODUCTION COMPANY			Lease Navajo Tribal "N"		Well No. 8
Unit Letter B	Section 17	Township 26-N	Range 18-W	County San Juan	
Actual Footage Location of Well: 660 feet from the North line and 2130 feet from the East line					
Ground Level Elev. 5809'	Producing Formation Pennsylvanian "D"		Pool Tocito Dome Pennsylvanian "D"	Dedicated Acreage: 160 Acres	

1. Outline the acreage dedicated to the subject well by colored pencil or hachure marks on the plat below.
2. If more than one lease is dedicated to the well, outline each and identify the ownership thereof (both as to working interest and royalty).
3. If more than one lease of different ownership is dedicated to the well, have the interests of all owners been consolidated by communitization, unitization, force-pooling, etc?

☐ Yes ☐ No If answer is "yes," type of consolidation _____

If answer is "no," list the owners and tract descriptions which have actually been consolidated. (See reverse side of this form if necessary.) _____

No allowable will be assigned to the well until all interests have been consolidated (by communitization, unitization, forced-pooling, or otherwise) or until a non-standard unit, eliminating such interests, has been approved by the Commission.

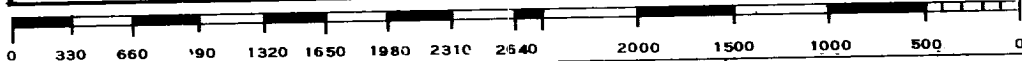
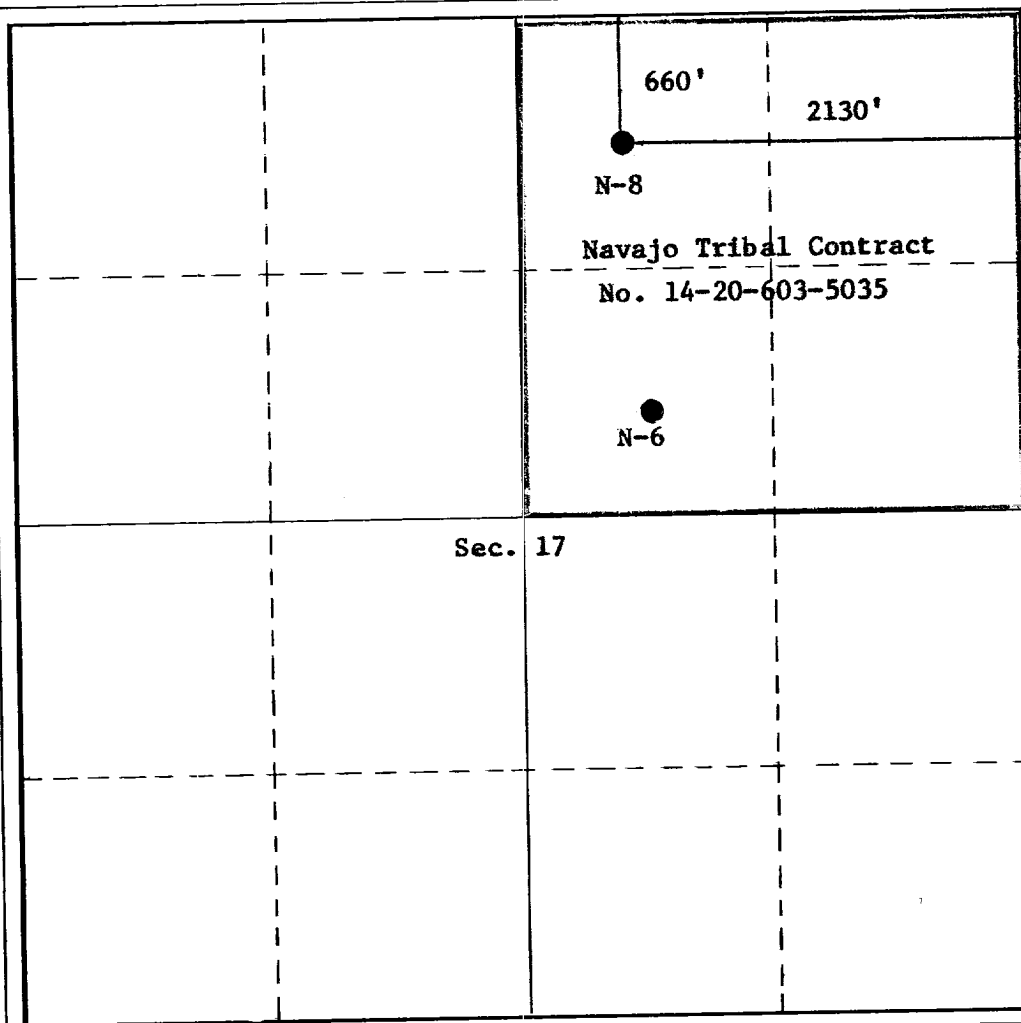
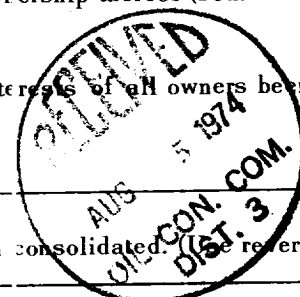

CERTIFICATION

I hereby certify that the information contained herein is true and complete to the best of my knowledge and belief.

G. L. Hamilton

Name
G. L. Hamilton
Position
Area Administrative Supervisor
Company
AMOCO PRODUCTION COMPANY
Date
August 1, 1974

I hereby certify that the well location shown on this plat was plotted from field notes of actual surveys made by me or under my supervision, and that the same is true and correct to the best of my knowledge and belief.

Date Surveyed
August 31, 1965
Registered Professional Engineer and/or Land Surveyor
Original Signed By:
E. V. Echohawk

Certificate No.
3602