

(SUBMIT IN TRIPLICATE)

UNITED STATES  
DEPARTMENT OF THE INTERIOR  
GEOLOGICAL SURVEY

Land Office **SP**  
Lease No. **SP-078899-A**  
Unit **Western Pool Unit**

**SUNDRY NOTICES AND REPORTS ON WELLS**

NOTICE OF INTENTION TO DRILL	<input checked="" type="checkbox"/>	SUBSEQUENT REPORT OF WATER SHUT-OFF	
NOTICE OF INTENTION TO CHANGE PLANS		SUBSEQUENT REPORT OF SHOOTING OR ACIDIZING	
NOTICE OF INTENTION TO TEST WATER SHUT-OFF		SUBSEQUENT REPORT OF ALTERING CASING	
NOTICE OF INTENTION TO RE-DRILL OR REPAIR WELL		SUBSEQUENT REPORT OF RE-DRILLING OR REPAIR	
NOTICE OF INTENTION TO SHOOT OR ACIDIZE		SUBSEQUENT REPORT OF ABANDONMENT	
NOTICE OF INTENTION TO PULL OR ALTER CASING		SUPPLEMENTARY WELL HISTORY	
NOTICE OF INTENTION TO ABANDON WELL			

(INDICATE ABOVE BY CHECK MARK NATURE OF REPORT, NOTICE, OR OTHER DATA)

**VERBAL APPROVAL RECEIVED USGS 4-25-61**

**April 25**, 19 **61**

Well No. **2-B** is located **890** ft. from **NE** line and **1750** ft. from **EW** line of sec. **8**  
**SE/4 SW/4 Section 8** **26N** **11W** **NMPM**  
(Sec. and Sec. No.) (Twp.) (Range) (Meridian)  
**Basin Dakota** **San Juan** **New Mexico**  
(Field) (County or Subdivision) (State or Territory)

The elevation of the derrick floor above sea level is **6179** ft.

**DETAILS OF WORK**

(State names of and expected depths to objective sands; show sizes, weights, and lengths of proposed casings; indicate mudding jobs, cementing points, and all other important proposed work)

**It is intended to drill a well through the Dakota Formation using rotary tools and mud circulation. Possible productive intervals will be perforated and sandoil fractured.**

**Estimated Total Depth 6290'.**

**Casing Program:**

**9-5/8" at 160' with 150 sacks cement circulated to surface**

**5-1/2" at 6290' with 250 sacks cement.**

**The W/2 of Section 8 is dedicated to this well.**

**NW/4 & E/2 SW/4 Section 8 SP-078899-A**  
**W/2 SW/4 Section 8 SP-078899**

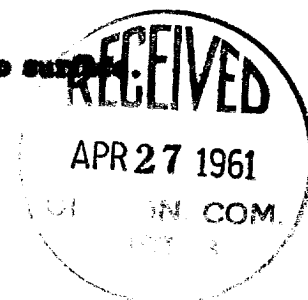

I understand that this plan of work must receive approval in writing by the Geological Survey before operations may be commenced.

Company **El Paso Natural Gas Products Company**

Address **Post Office Box 1560**

**Farmington, New Mexico**

ORIGINAL SIGNED BY: **JOHN J. STROJEK**  
By

Title **Petroleum Engineer**

## NEW MEXICO OIL CONSERVATION COMMISSION

## Well Location and Acreage Dedication Plat

## SECTION A.

Date **April 25, 1961**

Operator **EL PASO NATURAL GAS PRODUCTS CO.** Lease **Western Pool Unit SF-070099-A**  
 Well No. **3-5** Unit Letter **N** Section **8** Township **26 NORTH** Range **11 WEST** NMPM  
 Located **890** Feet From **THE SOUTH** Line, **1750** Feet From **THE WEST** Line  
 County **SAN JUAN** G. L. Elevation **6167** Dedicated Acreage **330** Acres  
 Name of Producing Formation **Delaware** Pool **Santa Barbara**

1. Is the Operator the only owner\* in the dedicated acreage outlined on the plat below? Yes ☐ No ☒
2. If the answer to question One is "No," have the interests of all the owners been consolidated by communization agreement or otherwise? Yes ☒ No ☐ If answer is "Yes," Type of Consolidation **Communization Agreement**
3. If the answer to question Two is "No," list all the owners and their respective interests below:

OWNER

LAND DESCRIPTION

SECTION 8. N 87° 02' W

N 89° 25' W

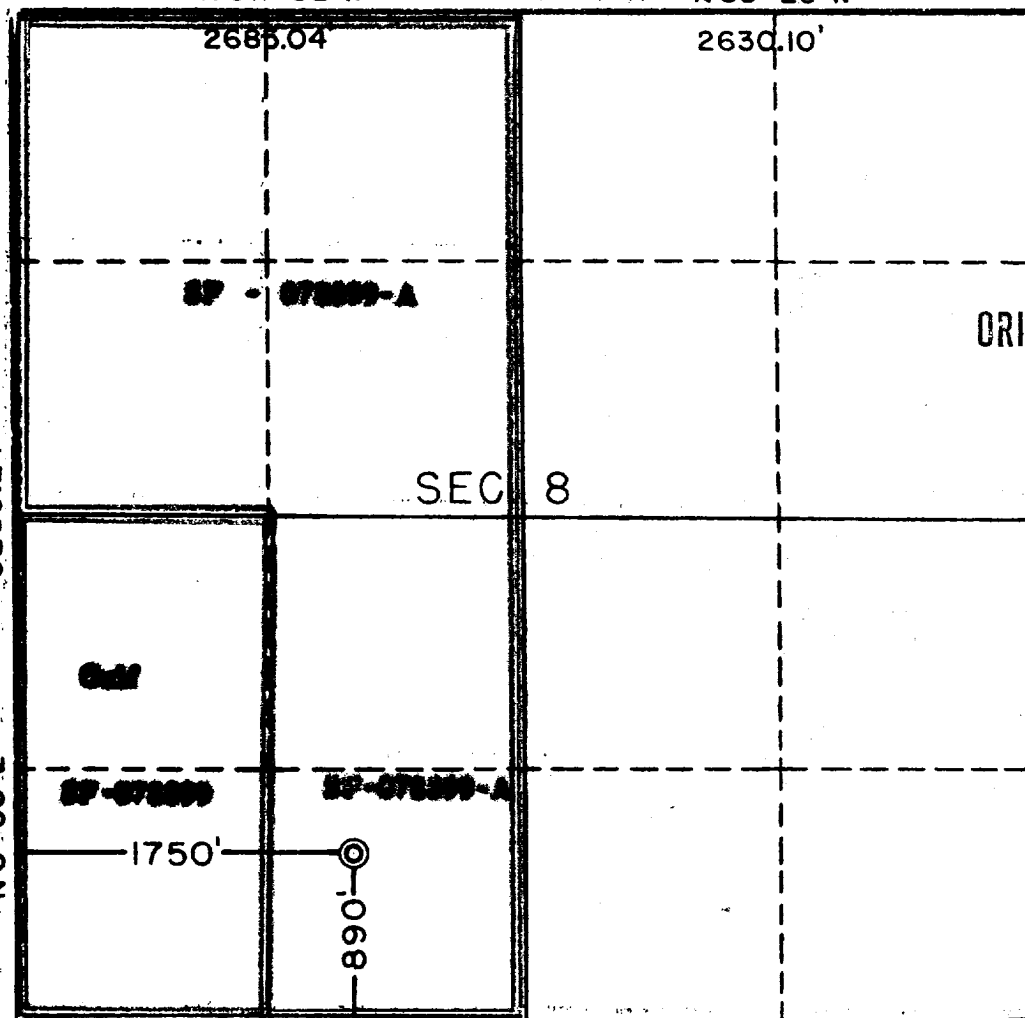

This is to certify that the information in Section A above is true and complete to the best of my knowledge and belief.

**El Paso Natural Gas Products Co.**  
(OPERATOR)

ORIGINAL SIGNED BY: **JOHN J. STROJEK**  
(REPRESENTATIVE)

**Box 1842, Farmington, N. M.**  
(ADDRESS)

This is to certify that the information shown on the plat was plotted from the actual survey and to the best of my knowledge and belief is true and complete.

Date Surveyed **APRIL 25, 1961**

**Four States Engineering Co.**  
FARMINGTON, NEW MEXICO

*C. L. Poter*  
REGISTERED ENGINEER OR  
LAND SURVEYOR

Certificate No. **3084 N.M.**