

COPY TO

		X	

(SUBMIT IN TRIPLICATE)

UNITED STATES
DEPARTMENT OF THE INTERIOR
GEOLOGICAL SURVEY

Land Office Santa Fe
Lease No. 078368
Unit SE/4
McFarfanto Unit
I. Sec. 943

SUNDRY NOTICES AND REPORTS ON WELLS

NOTICE OF INTENTION TO DRILL.....	XX	SUBSEQUENT REPORT OF WATER SHUT-OFF.....	
NOTICE OF INTENTION TO CHANGE PLANS.....		SUBSEQUENT REPORT OF SHOOTING OR ACIDIZING.....	
NOTICE OF INTENTION TO TEST WATER SHUT-OFF.....		SUBSEQUENT REPORT OF ALTERING CASING.....	
NOTICE OF INTENTION TO RE-DRILL OR REPAIR WELL.....		SUBSEQUENT REPORT OF RE-DRILLING OR REPAIR.....	
NOTICE OF INTENTION TO SHOOT OR ACIDIZE.....		SUBSEQUENT REPORT OF ABANDONMENT.....	12
NOTICE OF INTENTION TO PULL OR ALTER CASING.....		SUPPLEMENTARY WELL HISTORY.....	
NOTICE OF INTENTION TO ABANDON WELL.....			

(INDICATE ABOVE BY CHECK MARK NATURE OF REPORT, NOTICE, OR OTHER DATA)

NOV 18 1954

~~November 3, 1954~~

19

Ballard Federal
Well No. 4-12 is located 990 ft. from SB line and 1,550 ft. from E line of sec. 12
SE 1/4 Sec. 12 T 26 N R 9 W N. M. P. M.
(1/4 Sec. and Sec. No.) (Twp.) (Range) (Meridian)
Wildcat San Juan County New Mexico
(Field) (County or Subdivision) (State or Territory)

The elevation ~~of the derrick floor~~ above sea level is 6,231 ft. - Ungraded ground.

DETAILS OF WORK

(State names of and expected depths to objective sands; show sizes, weights, and lengths of proposed casings; indicate mudding jobs, cementing points, and all other important proposed work)

Propose to drill with rotary tools to the top of the Pictured Cliff Formation - Expected between 1,900 feet and 2,170 feet below surface - then drill 4-3/4" rat hole through Pictured Cliff formation. Completion with cable tools - and shooting with solidified nitro glycerin or sand oil fracturing.

Casing program: 100 feet of 3-5/8" new 5 rd. thd. 32# casing. Circulate cement to surface.

5-4-68 O.D. 11 1/2 J-55 seamless casing to be set on top of Pictured Cliff's Form-
lin. Cemented with 250 sacks regular cement.

1" tubing to be set within 50 feet of total hole for monitoring.

I understand that this plan of work must receive approval in writing by the Geological Survey before operations may be commenced.

Company J. Glenn Turner (Sub-Operator)

Address Box 780 • Farmington, New Mexico

Home Office: 2711 Kensington Park Rd

By [Signature]

Title U. S. JEROME ROSS
Letter to President

COMPANY J. Glenn Turner

Well Name & No. Ballard-Federal No. 4-12 Lease No. 57-078388

Location 990' from the South line and 1550' from the East line.

Being in the SW $\frac{1}{4}$ of the SE $\frac{1}{4}$.

Sec. 12, T²⁶ N., R⁹ W., N.M.P.M., San Juan County, New Mexico.

Ground Elevation 6231, ungraded ground.

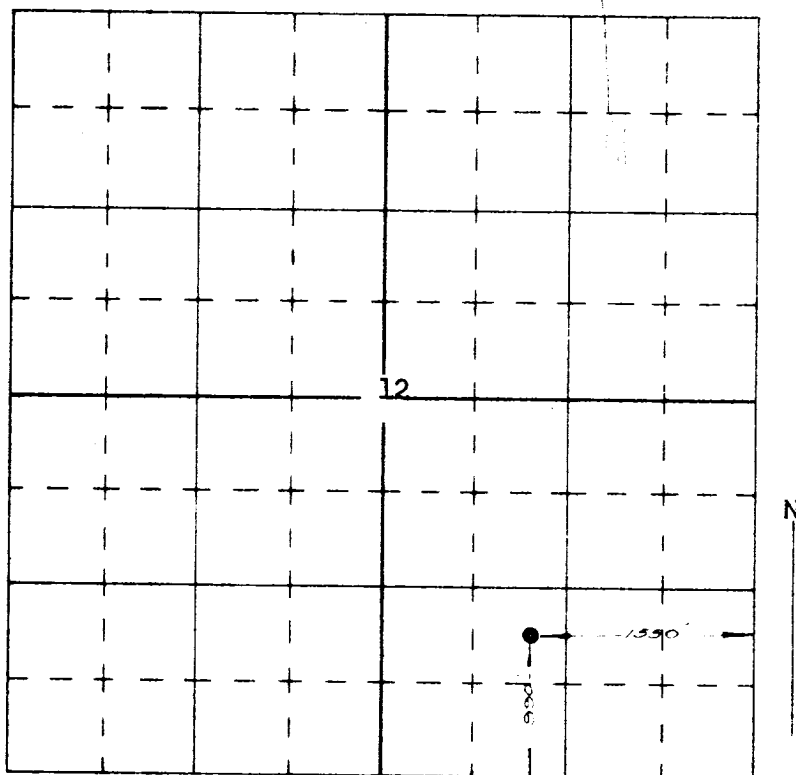

Scale -- 4 inches equals 1 mile

Surveyed November 4, 1954, 1954

This is to certify that the above plat was prepared from field notes of actual surveys made by me or under my supervision and that the same are true and correct to the best of my knowledge and belief.

Ernest V. Echohawk

Registered Professional
Engineer and Land Surveyor.
Ernest V. Echohawk
N. Mex. Reg. No. 1545

