

(SUBMIT IN TRIPLICATE)

UNITED STATES  
DEPARTMENT OF THE INTERIOR  
GEOLOGICAL SURVEY

Budget Bureau No. 42-R358.4.  
Form Approved.

Land Office **Santa Fe, N. Mexico**

Lease No. **ST 078388-A**

Unit \_\_\_\_\_

SUNDRY NOTICES AND REPORTS ON WELLS

NOTICE OF INTENTION TO DRILL	<input checked="" type="checkbox"/>	SUBSEQUENT REPORT OF WATER SHUT-OFF	
NOTICE OF INTENTION TO CHANGE PLANS		SUBSEQUENT REPORT OF SHOOTING OR ACIDIZING	
NOTICE OF INTENTION TO TEST WATER SHUT-OFF		SUBSEQUENT REPORT OF ALTERING CASING	
NOTICE OF INTENTION TO RE-DRILL OR REPAIR WELL		SUBSEQUENT REPORT OF RE-DRILLING OR REPAIR	
NOTICE OF INTENTION TO SHOOT OR ACIDIZE		SUBSEQUENT REPORT OF ABANDONMENT	
NOTICE OF INTENTION TO PULL OR ALTER CASING		SUPPLEMENTARY WELL HISTORY	
NOTICE OF INTENTION TO ABANDON WELL			

(INDICATE ABOVE BY CHECK MARK NATURE OF REPORT, NOTICE, OR OTHER DATA)

Well No. **5-10** is located **1190** ft. from **N** line and **1450** ft. from **E** line of sec. **10**  
 SW 1/4 of Sec. 10 **26 N** **19 W** **NMPM**  
 (1/4 Sec. and Sec. No.) (Twp.) (Range) (Meridian)  
**Basin Dakota** **San Juan** **New Mexico**  
 (Field) (County or Subdivision) (State or Territory)

The elevation of the derrick floor above sea level is \_\_\_\_\_ ft. Ground elevation **6326**

DETAILS OF WORK

(State names of and expected depths to objective sands; show sizes, weights, and lengths of proposed casings; indicate mudding jobs, cementing points, and all other important proposed work)

This well is to be known as **Auerfanito (6213) #5-10** and is to be drilled to **7000** feet. This will be a **Dakota** gas test. The surface casing is to be **8-5/8" O.D.** and set at **325** feet and cemented full length with approximately **225** sacks cement. Production casing will be **4-1/2" O.D.** and set through the lower most productive sand with quantity of cement used to be determined from depth of sands to be protected. A stage cementing tool will be set **50'** below the base of the **Pictured Cliff** formation and adequate cement will be used to bring cement up at least **50'** above the top of the **Pictured Cliff** formation. The well will be drilled with water to about **4000'** after which mud will be used to total depth.

I understand that this plan of work must receive approval in writing by the Geological Survey before operations may be commenced.

Company **Austral Oil Company Incorporated**

Address **300 San Jacinto Building**

**Houston, Texas, 77002**

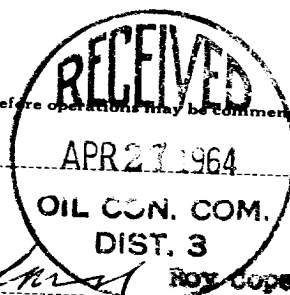

By **[Signature]** Roy Copeland

Title **Drilling & Production Superintendent**

NEW MEXICO OIL CONSERVATION COMMISSION

Well Location and Acreage Dedication Plat

Section A.

Date April 20, 1964

Operator AUSTRAL OIL CO. Lease HUERFANO (6012)  
Well No. 2-10 Unit Letter N Section 10 Township 26 North Range 9 West NMPN  
Located 1100 Feet From South Line, 1150 Feet From West Line  
County San Juan G. L. Elevation 6000 Dedicated Acreage South 1/2 (320) Acres  
Name of Producing Formation Tankita Pool Basin

1. Is the Operator the only owner\* in the dedicated acreage outlined on the plat below?  
Yes X No       .
2. If the answer to question one is "no," have the interests of all the owners been consolidated by communitization agreement or otherwise? Yes        No       . If answer is "yes," Type of Consolidation
3. If the answer to question two is "no," list all the owners and their respective interests below:

Owner

Land Description



Section B

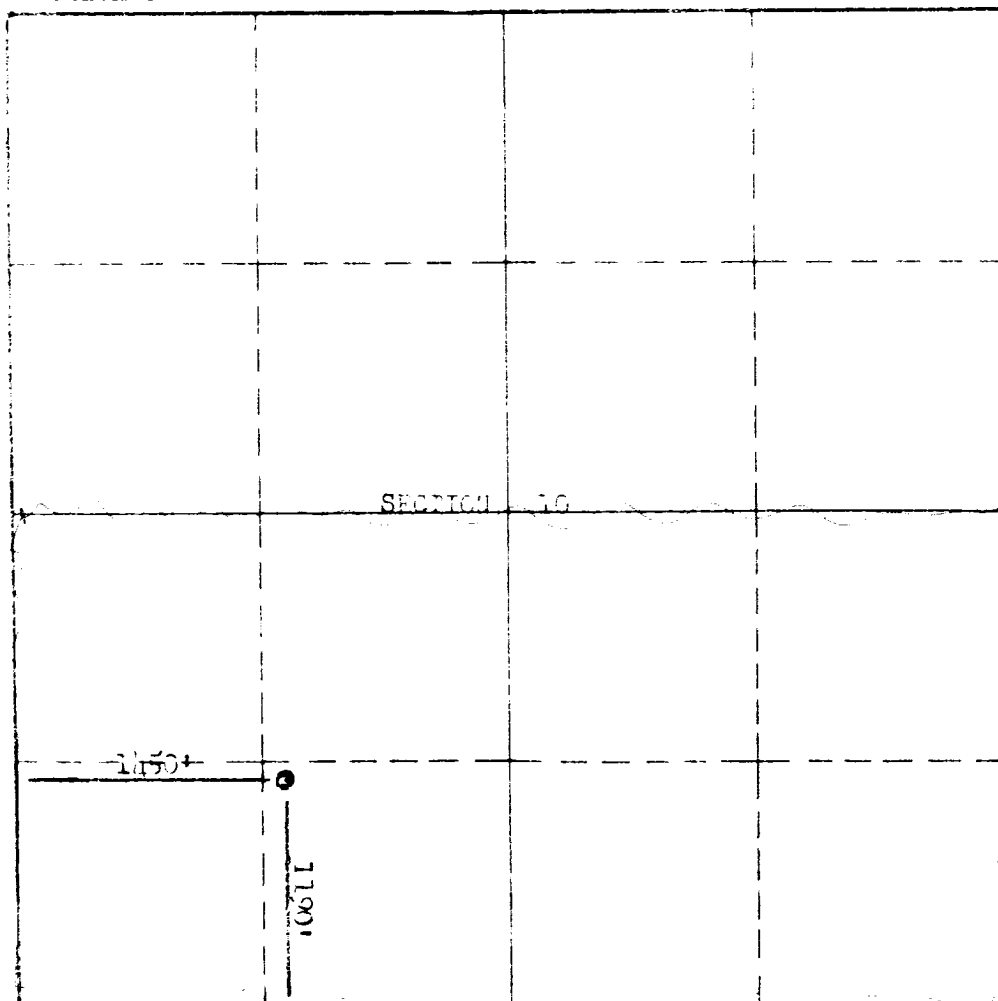

This is to certify that the information in Section A above is true and complete to the best of my knowledge and belief.

Austral Oil Co.

[Signature]  
Dir. & Prod. Superintendent

(Representative)  
300 San Jacinto Bldg.  
Houston 2, Texas.

Address

This is to certify that the well location shown on the plat in Section B was plotted from field notes of actual surveys made by me or under my supervision and that the same is true and correct to the best of my knowledge and belief.

Date Surveyed April 20, 1964

[Signature]  
STEPHEN H. KINNEY

Registered Professional  
Engineer and/or Land Surveyor.

Certificate No. 803