

(SUBMIT IN TRIPLICATE)

UNITED STATES
DEPARTMENT OF THE INTERIOR
GEOLOGICAL SURVEY

Land Office Santa Fe
Lease No. 070944
Unit Sullivan

SUNDRY NOTICES AND REPORTS ON WELLS

NOTICE OF INTENTION TO DRILL.....	<input checked="" type="checkbox"/>	SUBSEQUENT REPORT OF WATER SHUT-OFF.....	
NOTICE OF INTENTION TO CHANGE PLANS.....		SUBSEQUENT REPORT OF SHOOTING OR ACIDIZING.....	
NOTICE OF INTENTION TO TEST WATER SHUT-OFF.....		SUBSEQUENT REPORT OF ALTERING CASING.....	
NOTICE OF INTENTION TO RE-DRILL OR REPAIR WELL.....		SUBSEQUENT REPORT OF RE-DRILLING OR REPAIR.....	
NOTICE OF INTENTION TO SHOOT OR ACIDIZE.....		SUBSEQUENT REPORT OF ABANDONMENT.....	
NOTICE OF INTENTION TO PULL OR ALTER CASING.....		SUPPLEMENTARY WELL HISTORY.....	
NOTICE OF INTENTION TO ABANDON WELL.....			

(INDICATE ABOVE BY CHECK MARK NATURE OF REPORT, NOTICE, OR OTHER DATA)

January 3, 1957

Well No. 1-E is located 1900 ft. from S line and 650 ft. from E line of sec. 9
SE 1/4 Section 9 20N 12W NMNM
 (1/4 Sec. and Sec. No.) (Twp.) (Range) (Meridian)
Wildcat S. A. Juan New Mexico
 (Field) (County or Subdivision) (State or Territory)

The elevation of the derrick floor above sea level is 6001 ft.

DETAILS OF WORK

(State names of and expected depths to objective sands; show sizes, weights, and lengths of proposed casings; indicate mudding jobs, cementing points, and all other important proposed work)

It is intended to drill a well thru the Gallup formation using rotary tools and to perforate and water fracture possible producing zones. Estimated T.D. 5175'.

Casing Program:

9 5/8" at 120' with 125 sacks regular cement circulated to surface.
 5 1/2" at 5175' with 75 sacks regular cement, 75 sacks foamix.

The SE/4 of Section 9 is dedicated to this well.
 SE/4 SP 070944.

I understand that this plan of work must receive approval in writing by the Geological Survey before operations may be commenced.

Company El Paso Natural Gas Company

Address Box 997

Farmington, New Mexico

By Original Signed EWELL N. WAISH

Title Petroleum Engineer

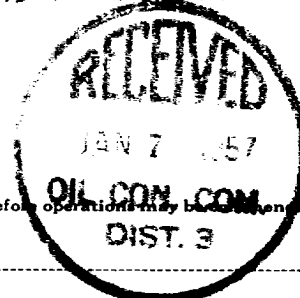



NEW MEXICO
OIL CONSERVATION COMMISSION

WELL LOCATION AND/OR GAS PRODUCTION PLAT

JANUARY 3, 1957

EL PASO NATURAL GAS COMPANY

SULLIVAN "E"

SF 078944

1

9

26-N

12-W

1980

SOUTH

659

EAST

SAN JUAN

6051

GALLUP

WILDCAT

160 ACRES

(1915 PLAT)

NOTE: All distances are in feet, unless otherwise indicated.

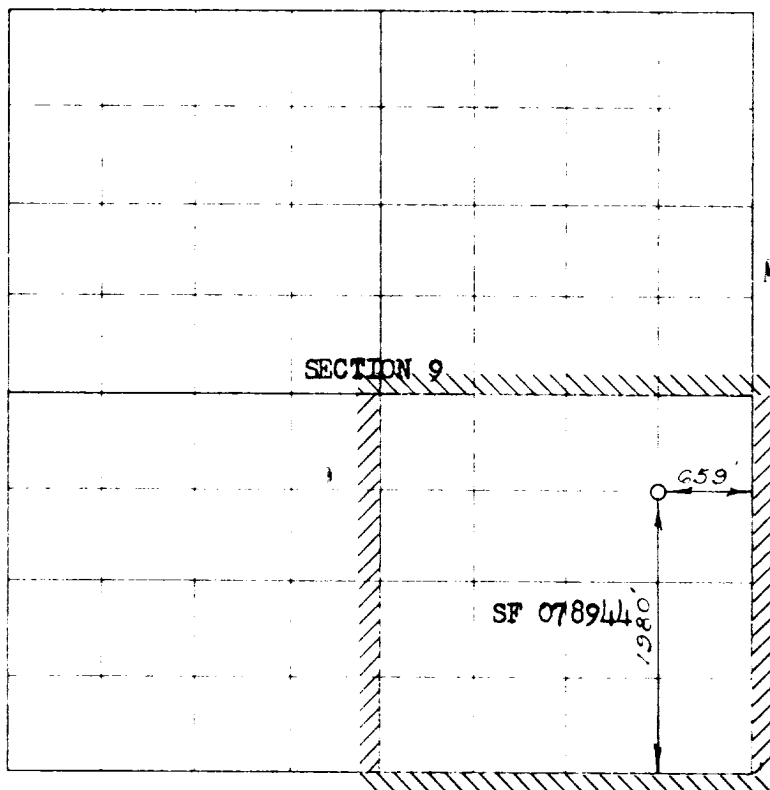

Scale: 1 inch = 400 feet

RECEIVED
JAN 4 1957
U. S. GEOLOGICAL SURVEY
FARMINGTON, NEW MEXICO

NOTE:
This section of
the plat is to be used
only
RECEIVED
JAN 7 1957
OIL CON. COM.
DIST. 3

I hereby certify that the above plat was prepared from a true and correct copy of the original survey made by me or under my supervision and that the same are true and correct to the best of my knowledge and belief.

Date Surveyed DECEMBER 20, 1956

Russell H. McNease
Registered ~~Professional Engineer~~ Land Surveyor

1. Is this well a Dual Comp.?
Yes No X
2. If the answer to Question 1 is yes, are there any other badly completed wells within the delineated acreage?
Yes No

Original Signed EWELL N. WAISH
Name

Position Petroleum Engineer

Representing El Paso Natural Gas Co.

Address Box 997, Farmington, N.M.