

(SUBMIT IN TRIPLICATE)

UNITED STATES  
DEPARTMENT OF THE INTERIOR  
GEOLOGICAL SURVEY

Indian Agency \_\_\_\_\_  
WINDY RIVER  
TRIBAL  
Allottee \_\_\_\_\_  
Lease No. ~~10-20-603-5019~~

SUNDRY NOTICES AND REPORTS ON WELLS

NOTICE OF INTENTION TO DRILL	<input checked="" type="checkbox"/>	SUBSEQUENT REPORT OF WATER SHUT-OFF
NOTICE OF INTENTION TO CHANGE PLANS	<input type="checkbox"/>	SUBSEQUENT REPORT OF SHOOTING OR ACIDIZING
NOTICE OF INTENTION TO TEST WATER SHUT-OFF	<input type="checkbox"/>	SUBSEQUENT REPORT OF ALTERING CASING
NOTICE OF INTENTION TO REDRILL OR REPAIR WELL	<input type="checkbox"/>	SUBSEQUENT REPORT OF REDRILLING OR REPAIR
NOTICE OF INTENTION TO SHOOT OR ACIDIZE	<input type="checkbox"/>	SUBSEQUENT REPORT OF ABANDONMENT
NOTICE OF INTENTION TO PULL OR ALTER CASING	<input type="checkbox"/>	SUPPLEMENTARY WELL HISTORY
NOTICE OF INTENTION TO ABANDON WELL	<input type="checkbox"/>	

RECEIVED  
OCT 23 1961  
U. S. GEOLOGICAL SURVEY  
FARMINGTON, NEW MEXICO

(INDICATE ABOVE BY CHECK MARK NATURE OF REPORT, NOTICE, OR OTHER DATA)

EPROC ASSOCIATES #1 Tertiary Dome

10-20, 19 61

Well No. 1 is located 2266 ft. from N line and 330 ft. from W line of sec. 9  
N 9 T26N R 10W N.M.P.M.  
(1/4 Sec. and Sec. No.) (Twp.) (Range) (Meridian)  
WILCOAT SAN JUAN NEW MEXICO  
(Field) (County or Subdivision) (State or Territory)

The elevation of the derrick floor above sea level is 9730 ft.

DETAILS OF WORK

(State names of and expected depths to objective sands; show sizes, weights, and lengths of proposed casings; indicate cementing jobs, cementing points, and all other important proposed work)

DRILL 8 3/4" HOLE TO 100'

RUN 7" 20# SURFACE CASING TO 100', CIRCULATING W/50 BAGS CEMENT

DRILL 4 3/4" HOLE TO TOTAL DEPTH, APPROXIMATELY 950'

IF PRODUCTIVE, RUN TO 6 1/4", RUN 4 1/2" CASING SURFACE TO TOTAL DEPTH, CEMENTING W/75 BAGS.

SANDY SANDSTONE TOP APPROXIMATELY 825'



I understand that this plan of work must receive approval in writing by the Geological Survey before operations may be commenced.

Company EPROC ASSOCIATES  
Address Box 1710  
DURANGO, COLORADO  
By W. E. Carr  
Title PARTNER

0187121267

100 10 100

100 10 100

NUMBER OF COPIES RECEIVED	
DISTRIBUTION	
SANTA FE	
FILE	
U.S.G.S.	
LAND OFFICE	
TRANSPORTER	OIL GAS
PRODUCTION OFFICE	
OPERATOR	

**NEW MEXICO OIL CONSERVATION COMMISSION**  
**WELL LOCATION AND ACREAGE DEDICATION PLAT**  
 SEE INSTRUCTIONS FOR COMPLETING THIS FORM ON THE REVERSE SIDE

FORM C-128  
 Revised 5/1/57

**SECTION A**

Operator <b>EPAC ASSOCIATES</b>		Lease <b>Tecate 2000</b>		Well No. <b>1</b>
Unit Letter <b>E</b>	Section <b>9</b>	Township <b>20N</b>	Range <b>12W</b>	County <b>San Juan</b>
Actual Footage Location of Well: <b>2266</b> feet from the <b>North</b> line and <b>330</b> feet from the <b>West</b> line				
Ground Level Elev. <b>5729</b>	Producing Formation <b>SANJOA TEST</b>	Pool <b>WILCOAT</b>	Dedicated Acreage: <b>40</b> Acres	

- Is the Operator the only owner in the dedicated acreage outlined on the plat below? YES ☒ NO ☐ ("Owner" means the person who has the right to drill into and to produce from any pool and to appropriate the production either for himself or for himself and another. (65-3-29 (e) NMSA 1935 Comp.)
- If the answer to question one is "no," have the interests of all the owners been consolidated by communitization agreement or otherwise? YES ☐ NO ☐ If answer is "yes," Type of Consolidation \_\_\_\_\_
- If the answer to question two is "no," list all the owners and their respective interests below:

Owner <b>EPAC ASSOCIATES</b>	Land Description <b>SW 1/4 of NW 1/4</b>
<b>P. O. Box 7700, Durango, Colorado</b>	<b>(40 acres)</b>

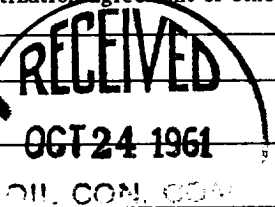

**SECTION B**

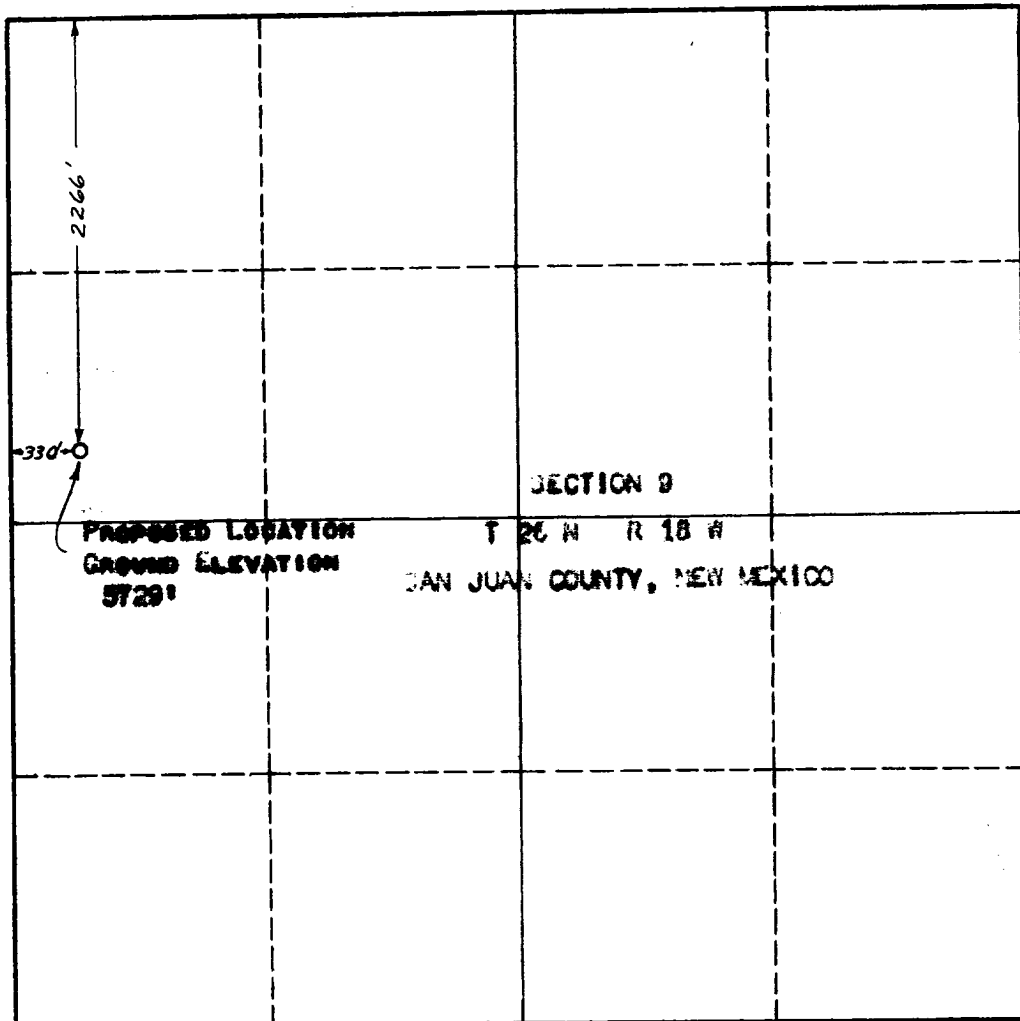

**CERTIFICATION**

I hereby certify that the information in SECTION A above is true and complete to the best of my knowledge and belief.

Name <b>R. E. Lauth</b>
Position <b>PARTNER</b>
Company <b>EPAC ASSOCIATES</b>
Date <b>OCT. 16, 1961</b>

I hereby certify that the well location shown on the plat in SECTION B was plotted from field notes of actual surveys made by me or under my supervision, and that the same is true and correct to the best of my knowledge and belief.

Date Surveyed <b>OCTOBER 13, 1961</b>
Registered Professional Engineer and/or Land Surveyor <b>Edwin M. Clark</b>
Certificate No. <b>NEW MEXICO 3189</b>

### INSTRUCTIONS FOR COMPLETION OF FORM C-128

1. Operator shall furnish and certify to the information called for in Section A.
2. Operator shall outline the dedicated acreage for *both* oil and gas wells on the plat in Section B.
3. A registered professional engineer or land surveyor registered in the State of New Mexico or approved by the Commission shall show on the plat the location of the well and certify this information in the space provided.
4. All distances shown on the plat must be from the outer boundaries of the Section.
5. If additional space is needed for listing owners and their respective interests as required in question 3 of Section A, please use space below.