

(SUBMIT IN TRIPLICATE)

UNITED STATES
DEPARTMENT OF THE INTERIOR
GEOLOGICAL SURVEY

Land Office NEW MEXICO
Lease No. 0433
Unit SURFMAN

SUNDRY NOTICES AND REPORTS ON WELLS

| | |
|---|---|
| NOTICE OF INTENTION TO DRILL..... | SUBSEQUENT REPORT OF WATER SHUT-OFF..... |
| NOTICE OF INTENTION TO CHANGE PLANS..... | SUBSEQUENT REPORT OF SHOOTING OR ACIDIZING..... |
| NOTICE OF INTENTION TO TEST WATER SHUT-OFF..... | SUBSEQUENT REPORT OF ALTERING CASING..... |
| NOTICE OF INTENTION TO RE-DRILL OR REPAIR WELL..... | SUBSEQUENT REPORT OF RE-DRILLING OR REPAIR..... |
| NOTICE OF INTENTION TO SHOOT OR ACIDIZE..... | SUBSEQUENT REPORT OF ABANDONMENT..... |
| NOTICE OF INTENTION TO PULL OR ALTER CASING..... | SUPPLEMENTARY WELL HISTORY..... |
| NOTICE OF INTENTION TO ABANDON WELL..... | |

RECEIVED
OCT 31 1956

(INDICATE ABOVE BY CHECK MARK NATURE OF REPORT, NOTICE, OR OTHER DATA)

U. S. GEOLOGICAL SURVEY
FARMINGTON, NEW MEXICO

October 31, 1956

Well No. 71 is located 1030 ft. from N line and 1040 ft. from E line of sec. 7
Section 7 20N 10W 104N
 (1/4 Sec. and Sec. No.) (Twp.) (Range) (Meridian)
0.012 San Juan New Mexico
 (Field) (County or Subdivision) (State or Territory)

The elevation of the derrick floor above sea level is 6077 ft.

DETAILS OF WORK

(State names of and expected depths to objective sands; show sizes, weights, and lengths of proposed casings; indicate mudding jobs, cementing points, and all other important proposed work)

It is intended to drill a well thru the Pictured Cliff formation using rotary tools and to perforate and water fracture possible producing zones. Estimated I.P. 2500'.

Casing Program.

5 5/8" at 120' with 125 sacks regular cement circulated to surface.
 5 1/2" at 2500' with 75 sacks regular cement, 75 sacks local.

The No. 4 of Section 7 is dedicated to this well.
 It is No. 0433.

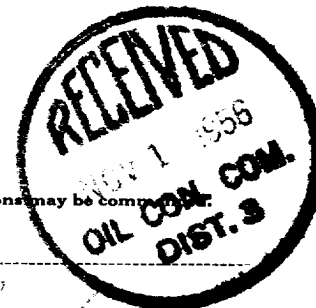

I understand that this plan of work must receive approval in writing by the Geological Survey before operations may be commenced.

Company El Paso Natural Gas Company

Address Box 397

Farmington, New Mexico

By S. Schuler

Title Introleum Engineer

NEW MEXICO
OIL CONSERVATION COMMISSION

Form 1924

WELL LOCATION AND OR GAS PRODUCTION PLAT

OCTOBER 24, 1956

EL PASO NATURAL GAS COMPANY HUERFANO NM 0433
71 9 26 N 10 W
1650 NORTH 1840 WEST
SAN JUAN 6649.18

PICTURED CLIFF

WEST KUTZ

160 AC.
(1935 PLAT)

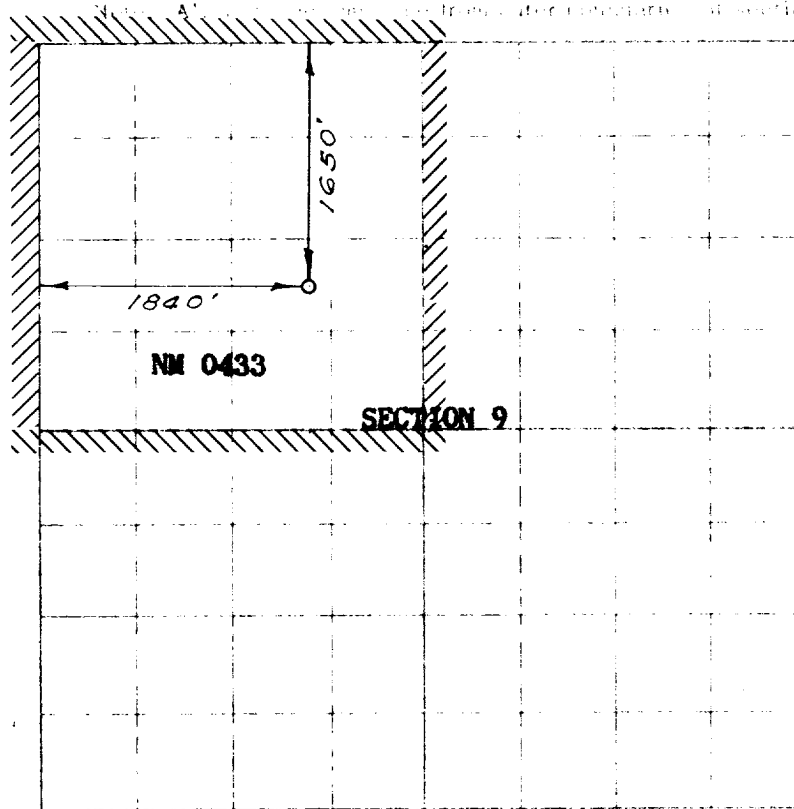

Scale 1 inch equals 1 mile

NOTE

This section of
form is to be used
for gas wells only

This is to certify that the above plat was prepared from
field notes of actual surveys made by me or under my
supervision and that the same are true and correct to the
best of my knowledge and belief.

Date Surveyed **OCTOBER 4, 1956**

S. O. Walker
Registered Professional Engineer and/or Land Surveyor



1. Is this well a Dual Comp.
Yes _____ No ☒
2. If the answer to Question 1
is yes, are there any other dually
completed wells within the
indicated acreage.

S. Schuler
Petroleum Engineer
Representing **El Paso Natural Gas Co.**
Address **Box 997, Farmington, N.M.**