

STATE OF NEW MEXICO  
ENERGY, MINERALS AND NATURAL RESOURCES DEPARTMENT  
OIL CONSERVATION DIVISION

GARREY CARRUTHERS  
GOVERNOR

POST OFFICE BOX 2088  
STATE LAND OFFICE BUILDING  
SANTA FE, NEW MEXICO 87504  
(505) 827-5800

July 5, 1990

**RECEIVED**  
JUL 10 1990  
OIL CON. DIV.,  
DIST. 3

Meridian Oil, Inc.  
P.O. Box 4289  
Farmington, NM 87499-4289

Attention: Peggy Bradfield

*Administrative Order NSL-2825*

Dear Ms. Bradfield:

Reference is made to your application dated June 5, 1990 for a non-standard Basin-Fruitland coal gas well location for your existing Huerfano Unit Well No. 70 which was drilled in 1956 and completed in the West Kutz-Pictured Cliffs Pool at a standard gas well location 890 feet from the North line and 1600 feet from the West 1600 line (Unit C) of Section 8, Township 26 North, Range 10 West, NMPM, San Juan County, New Mexico.

It is my understanding that the Pictured Cliffs zone will be properly plugged back and said well will be recompleted to the Basin-Fruitland Coal Gas Pool, which pursuant to the Special Rules and Regulations for the Basin-Fruitland Coal Gas Pool as promulgated by Division Order No. R-8768, is unorthodox. Further, the N/2 of said Section 8 shall be dedicated to the well forming a standard 320-acre gas spacing and proration unit for said pool.

By the authority granted me under the provisions of Rule 8 of said Division Order No. R-8768, the above-described unorthodox coal gas well location is hereby approved.

Sincerely,

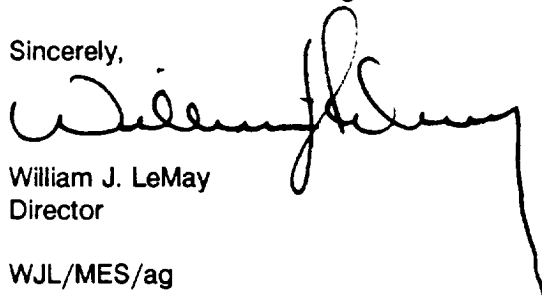

William J. LeMay  
Director

WJL/MES/ag

cc: Oil Conservation Division - Aztec  
US Bureau of Land Management - Farmington



STATE OF NEW MEXICO  
ENERGY AND MINERALS DEPARTMENT  
OIL CONSERVATION DIVISION  
AZTEC DISTRICT OFFICE

ARREY CARRUTHERS  
GOVERNOR

1000 RIO BRAZOS ROAD  
AZTEC, NEW MEXICO 87410  
(505) 334-6178

Date: 6-15-90

Oil Conservation Division  
P.O. Box 2088  
Santa Fe, NM 87504-2088

Re: Proposed MC \_\_\_\_\_  
Proposed DHC \_\_\_\_\_  
Proposed NSL X \_\_\_\_\_  
Proposed SWD \_\_\_\_\_  
Proposed WFX \_\_\_\_\_  
Proposed PMX \_\_\_\_\_

Gentlemen:

I have examined the application dated 6-7-90  
for the Mission Oil Inc. Guernsey Unit #70  
Operator Lease & Well No.

C-8-26N-10W and my recommendations are as follows:  
Unit, S-T-R

Approved

Yours truly,

Ernie Bruch

# MERIDIAN OIL

June 5, 1990

Certified Mail

Mr. William LeMay  
New Mexico Oil Conservation Division  
Post Office Box 2088  
Santa Fe, New Mexico 87503

**RECEIVED**

JUN 7 1990

**OIL CON. DIV.]**  
**DIST. 3**

RE: Huerfano Unit #70  
890'FNL, 1600'FWL  
Section 08, T-26-N, R-10-W  
San Juan County, New Mexico

Dear Mr. LeMay:

This is a request for administrative approval for a non-standard gas well location in the Basin Fruitland Pool.

Meridian Oil intends to plugback and recomplete the Huerfano Unit #70 well from the Pictured Cliffs pool to the Basin Fruitland Coal Pool. The current location of this well is 890'FNL, 1600'FWL, Section 08, T-26-N, R-10-W, San Juan County, New Mexico. The well is considered non-standard due to the NE-SW dedicated pattern established for the Basin Fruitland Coal Pool. To comply with the New Mexico Oil Conservation Division rules, Meridian is submitting the following for your approval of this non-standard location:

1. C-102 plat showing location of the well;
2. Plat showing offset owners/operators;
3. Copy of Well Completion Log for original completion.

All surrounding lands are located within the Huerfano Unit boundaries - El Paso Natural Gas Company is the operator of this unit.

Sincerely yours,



Peggy Bradfield  
encl.

DISTRICT I  
P.O. Box 1980, Hobbs, NM 88240

**OIL CONSERVATION DIVISION**  
P.O. Box 2088  
Santa Fe, New Mexico 87504-2088

**DISTRICT II**  
P.O. Drawer DD, Artesia, NM 88210

**DISTRICT III**  
1000 Rio Brazos Rd., Aztec, NM 87410

## WELL LOCATION AND ACREAGE DEDICATION PLAT

**All Distances must be from the outer boundaries of the section**

Operator El Paso Natural Gas		Lease Huerfano (NM-0433)		Well No. 70
Unit Letter C	Section 8	Township 26 North	Range 10 West	County San Juan
Actual Footage Location of Well: 890 feet from the North line and 1600 feet from the West line				
Gross level Elev. 6563'	Producing Formation Fruitland Coal		Foot Basin	Dedicated Acreage: 320 Acres

1. Outline the acreage dedicated to the subject well by colored pencil or colored ink.

- |               |       |     |
|---------------|-------|-----|
| Frutland Coal | Basin | 320 |
|---------------|-------|-----|
1. Outline the acreage dedicated to the subject well by colored pencil or machine marks on the plan below.
  2. If more than one lease is dedicated to the well, outline each and identify the ownership thereof (both as to working interest and royalty).
  3. If more than one lease of different ownership is dedicated to the well, have the interest of all owners been consolidated by communitization, unitization, force-pooling, etc.?

If answer is "no" list the owners and tract descriptions which have actually been consolidated. (Use reverse side of this form if necessary.) unitization

No allowable will be assigned to the web until all interests have been considered (by communication, auction, forced-pooling, or otherwise) or until a non-standard unit, eliminating such interest, has been approved by the Division.

Prepared from a plat  
dated 10-2-56 by  
C. O. Walker.

890'

1600'

8

RECEIVED

JUN 7 1990

OIL CON. DIV.

DIST. 3

### OPERATOR CERTIFICATION

I hereby certify that the information contained herein is true and complete to the best of my knowledge and belief.

Signature  
Peggy Bradfield

Printed Name  
Regulatory Affairs

**Position:**  
El Paso Natural Gas

---

**Company**

Date \_\_\_\_\_

### SURVEYOR CERTIFICATION

I hereby certify that the well location shown on this plan was plotted from field notes of actual surveys made by me or under my supervision, and that the same is true and correct to the best of my knowledge and belief.

5-23-90

**Data Supplied**

Signature \_\_\_\_\_  
 Professor \_\_\_\_\_

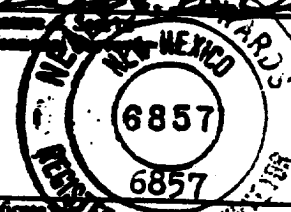

Certificates 10/2/45

Neale C. Edwards

MERIDIAN OIL INC

Well Name Huerfano #70

Footage 890' ENL; 1600 FWL

APPLICATION FOR NON-STANDARD PRORATION UNIT

County San Juan State New Mexico Section 8 Township 26N Range 10W

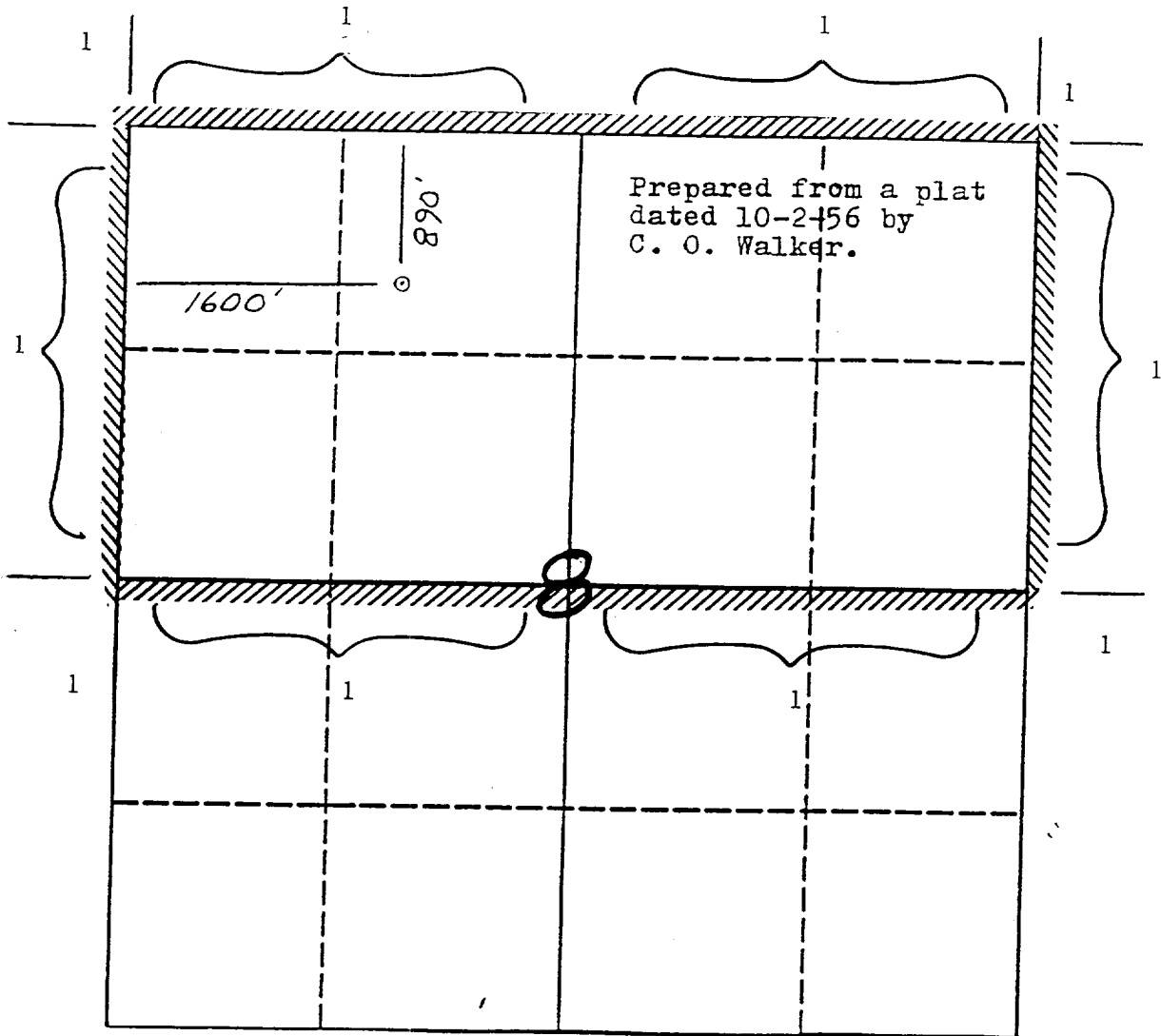

Remarks 1) El Paso Natural Gas Company

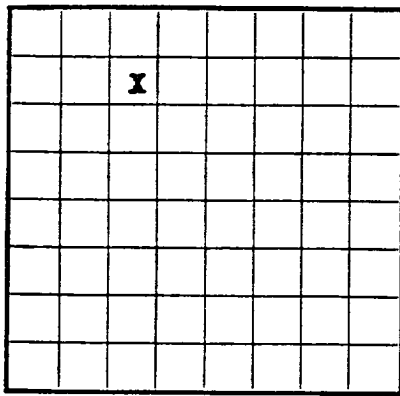

LOCATE WELL CORRECTLY

U. S. LAND OFFICE New Mexico  
 SERIAL NUMBER 0433  
 LEASE OR PERMIT TO PROSPECT \_\_\_\_\_

UNITED STATES  
 DEPARTMENT OF THE INTERIOR  
 GEOLOGICAL SURVEY

## LOG OF OIL OR GAS WELL

Company El Paso Natural Gas Company Address Box 997, Farmington, New Mexico  
 Lessor or Tract Huerfano Unit Field W. Kutz State New Mexico  
 Well No. 70 Sec. 8 T. 26N R. 10W Meridian NMPM County San Juan  
 Location 890 ft. N of N Line and 1600 ft. E of W Line of Section 8 Elevation 6573'  
 (Derrick base relative to sea level)

The information given herewith is a complete and correct record of the well and all work done thereon so far as can be determined from all available records.

Signed ORIGINAL SIGNED F. W. BOYDDate December 7, 1956Title Petroleum Engineer

The summary on this page is for the condition of the well at above date.

Commenced drilling 11-4-56, 19..... Finished drilling 11-8-56, 19.....

## OIL OR GAS SANDS OR ZONES

(Denote gas by G)

No. 1, from 2110 to 2210 (G) No. 4, from \_\_\_\_\_ to \_\_\_\_\_  
 No. 2, from \_\_\_\_\_ to \_\_\_\_\_ No. 5, from \_\_\_\_\_ to \_\_\_\_\_  
 No. 3, from \_\_\_\_\_ to \_\_\_\_\_ No. 6, from \_\_\_\_\_ to \_\_\_\_\_

## IMPORTANT WATER SANDS

No. 1, from \_\_\_\_\_ to \_\_\_\_\_ No. 3, from \_\_\_\_\_ to \_\_\_\_\_  
 No. 2, from \_\_\_\_\_ to \_\_\_\_\_ No. 4, from \_\_\_\_\_ to \_\_\_\_\_

## CASING RECORD

Size of casing	Weight per foot	Threads per inch	Make	Amount	Kind of shoe	Cut and pulled from	Perforated	Purpose
8 5/8"	28.50	8 RD	J-55	125'	Howco			Surface
5 1/2"								
1 1/2"								

## MUDDING AND CEMENTING RECORD

Size casing	Where set	Number sacks of cement	Method used	Mud gravity	Amount of mud used
8 5/8"	135'	100	Circulated		
5 1/2"	2215'	150	Single Stage		

## PLUGS AND ADAPTERS

Heaving plug—Material \_\_\_\_\_ Length \_\_\_\_\_ Depth set \_\_\_\_\_  
 Adapters—Material \_\_\_\_\_ Size \_\_\_\_\_

## SHOOTING RECORD

Size	Shell used	Explosive used	Quantity	Date	Depth shot	Depth cleaned out
------	------------	----------------	----------	------	------------	-------------------

FOLD | MARK