

UNITED STATES
DEPARTMENT OF THE INTERIOR
BUREAU OF LAND MANAGEMENT

SUBMIT IN TRIPLICATE
(Other instructions on reverse side)

Form approved.
Budget Bureau No. 1004-0135
Expires August 31, 1985

SUNDRY NOTICES AND REPORTS ON WELLS

(Do not use this form for proposals to drill or to deepen or plug back to a different reservoir.
Use "APPLICATION FOR PERMIT—" for such proposals.)

1. OIL WELL <input type="checkbox"/> GAS WELL <input checked="" type="checkbox"/> OTHER <input type="checkbox"/>		3. LEASE DESIGNATION AND SERIAL NO. SF-078622
2. NAME OF OPERATOR Meridian Oil Inc.		6. IF INDIAN, ALLOTTEE OR TRIBE NAME
3. ADDRESS OF OPERATOR Post Office Box 4289, Farmington, NM 87499		7. UNIT AGREEMENT NAME
4. LOCATION OF WELL (Report location clearly and in accordance with any State requirements. See also space 17 below.) At surface 790'S, 990'E		8. FARM OR LEASE NAME Luthy
14. PERMIT NO.		9. WELL NO. 1
15. ELEVATIONS (Show whether DF, RT, GR, etc.) 6090' GL		10. FIELD AND POOL, OR WILDCAT Undes. Fruitland Coal
		11. SEC., T., R., M., OR B.L. AND SURVEY OR AREA Sec. 1, T-26-N, R- 8-W N.M.P.M.
		12. COUNTY OR PARISH San Juan
		13. STATE NM

16. Check Appropriate Box To Indicate Nature of Notice, Report, or Other Data

NOTICE OF INTENTION TO:

TEST WATER SHUT-OFF ☐
FRACTURE TREAT ☐
SHOOT OR ACIDIZE ☐
REPAIR WELL ☐
(Other) ☐

PULL OR ALTER CASING ☐
MULTIPLE COMPLETE ☐
ABANDON* ☐
CHANGE PLANS ☐

SUBSEQUENT REPORT OF:

WATER SHUT-OFF ☐
FRACTURE TREATMENT ☐
SHOOTING OR ACIDIZING ☐
(Other) ☐

REPAIRING WELL ☐
ALTERING CASING ☐
ABANDONMENT* ☐

(NOTE: Report results of multiple completion on Well Completion or Recompletion Report and Log form.)

17. DESCRIBE PROPOSED OR COMPLETED OPERATIONS (Clearly state all pertinent details, and give pertinent dates, including estimated date of starting any proposed work. If well is directionally drilled, give subsurface locations and measured and true vertical depths for all markers and zones pertinent to this work.)

Attached is a copy of the C-102 plat showing the revised pool change for the plugback of this well to the Fruitland Coal formation.

18. I hereby certify that the foregoing is true and correct.

SIGNED [Signature] TITLE Regulatory Affairs () DATE 10-10-88

(This space for Federal or State office use)

APPROVED BY _____
CONDITIONS OF APPROVAL, IF ANY:

TITLE _____
NMOCC

ACCEPTED FOR RECORD

OCT 11 1988

FARMINGTON RESOURCE AREA

*See Instructions on Reverse Side

All distances must be from the outer boundaries of the Section.

Operator Meridian Oil Inc.			Lease Luthy (SF-078622)		Well No. 1
Unit Letter P	Section 1	Township 26 North	Range 8 West	County San Juan	
Actual Footage Location of Well: 790 feet from the South line and 990 feet from the East line					
Ground Level Elev. 6090 +	Producing Formation Fruitland Coal		Pool Undesignated		Dedicated Acreage: 160 Acres

1. Outline the acreage dedicated to the subject well by colored pencil or hatchure marks on the plat below.
2. If more than one lease is dedicated to the well, outline each and identify the ownership thereof (both as to working interest and royalty).
3. If more than one lease of different ownership is dedicated to the well, have the interests of all owners been consolidated by communitization, unitization, force-pooling, etc?

☐ Yes ☐ No If answer is "yes," type of consolidation _____

If answer is "no," list the owners and tract descriptions which have actually been consolidated. (Use reverse side of this form if necessary.) _____

No allowable will be assigned to the well until all interests have been consolidated (by communitization, unitization, forced-pooling, or otherwise) or until a non-standard unit, eliminating such interests, has been approved by the Division
Reissued to show pool change

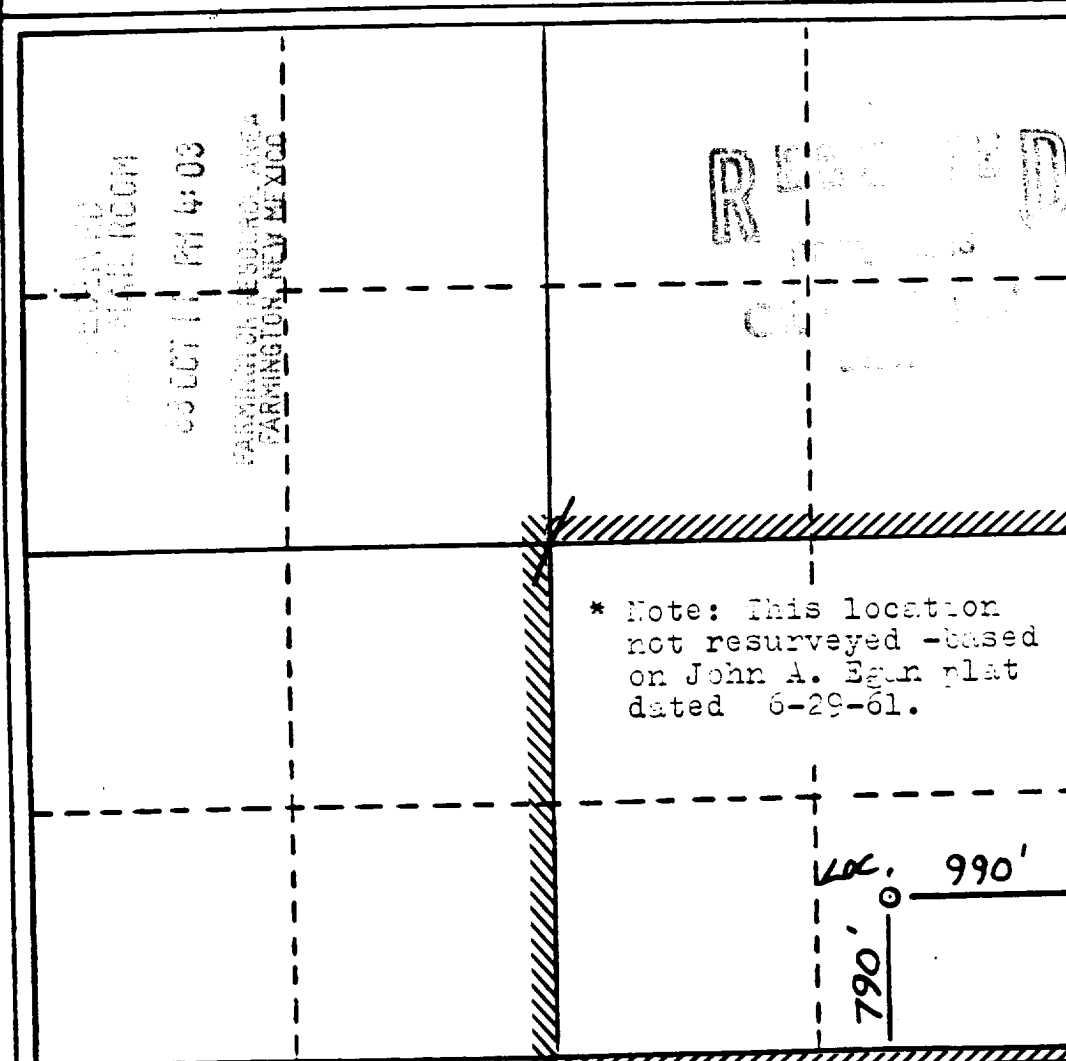

CERTIFICATION

I hereby certify that the information contained herein is true and complete to the best of my knowledge and belief.

Name
Regulatory Affairs

Position
Meridian Oil Inc.

Company
10-10-88

Date

I hereby certify that the location shown on this plat was determined from field notes of section 6857 made by me or under my supervision, and that the same is true and correct to the best of my knowledge and belief.

Neale C. Edwards

Date **10-10-88**

Registered Professional Engineer and/or Land Surveyor

Neale C. Edwards

Certificate No.

6857