

### FIELD PIT SITE ASSESSMENT FORM

GENERAL	<p>Meter: <u>747SS</u> Location: <u>TURNER B COM H #13</u></p> <p>Operator #: <u>2999</u> Operator Name: <u>MERIDIAN</u> P/L District: <u>BALLARD</u></p> <p>Coordinates: Letter: <u>N</u> Section <u>2</u> Township: <u>26</u> Range: <u>8</u></p> <p>Or Latitude _____ Longitude _____</p> <p>Pit Type: Dehydrator _____ Location Drip: <u>X</u> Line Drip: _____ Other: _____</p> <p>Site Assessment Date: <u>6-15-94</u> Area: <u>07</u> Run: <u>SL</u></p>
SITE ASSESSMENT	<div style="display: flex; justify-content: space-between;"> <div style="width: 45%;"> <p><b>NMOCD Zone:</b> (From NMOCD Maps)</p> <p>Inside <input checked="" type="checkbox"/> (1) Outside <input type="checkbox"/> (2)</p> </div> <div style="width: 45%;"> <p><b>Land Type:</b> BLM <input checked="" type="checkbox"/> (1) State <input type="checkbox"/> (2) Fee <input checked="" type="checkbox"/> (3)</p> <p><i>Dennis E. [Signature]</i> <b>DEPUTY OIL &amp; GAS INSPECTOR</b></p> <p><b>SEP 10 1996</b></p> <p><i>Approved</i></p> </div> </div> <p><b>Depth to Groundwater</b></p> <p>Less Than 50 Feet (20 points) <input checked="" type="checkbox"/> (1) <small>6-15-94 RT</small>  50 Ft to 99 Ft (10 points) <input checked="" type="checkbox"/> (2)  Greater Than 100 Ft (0 points) <input type="checkbox"/> (3)</p> <p><b>Wellhead Protection Area :</b></p> <p>Is it less than 1000 ft from wells, springs, or other sources of fresh water extraction? , or ; Is it less than 200 ft from a private domestic water source? <input type="checkbox"/> (1) YES (20 points) <input checked="" type="checkbox"/> (2) NO (0 points)</p> <p><b>Horizontal Distance to Surface Water Body</b></p> <p>Less Than 200 Ft (20 points) <input type="checkbox"/> (1)  200 Ft to 1000 Ft (10 points) <input type="checkbox"/> (2)  Greater Than 1000 Ft (0 points) <input checked="" type="checkbox"/> (3)</p> <p>Name of Surface Water Body _____</p> <p>(Surface Water Body : Perennial Rivers, Major Wash, Streams, Creeks, Irrigation Canals, Ditches, Lakes, Ponds)</p> <p>Distance to Nearest Ephemeral Stream <input type="checkbox"/> (1) &lt; 100' (Navajo Pits Only)  <input type="checkbox"/> (2) &gt; 100'</p> <p><b>TOTAL HAZARD RANKING SCORE: <u>10</u> POINTS</b></p>
REMARKS	<p>Remarks : <u>ONLY PIT ON LOCATION. PIT IS DRY. LOCATION IS IN HEIFER CANYON AT THE BASE OF SOME CLIFFS. REDLINE AND TOPO CONFIRMED LOCATION IS INSIDE V.Z.</u></p> <p style="text-align: right;"><i>Dennis E. [Signature]</i></p>

### ORIGINAL PIT LOCATION

Original Pit : a) Degrees from North 107° Footage from Wellhead 125'

b) Length : 20' Width : 16' Depth : 2'

ORIGINAL PIT LOCATION

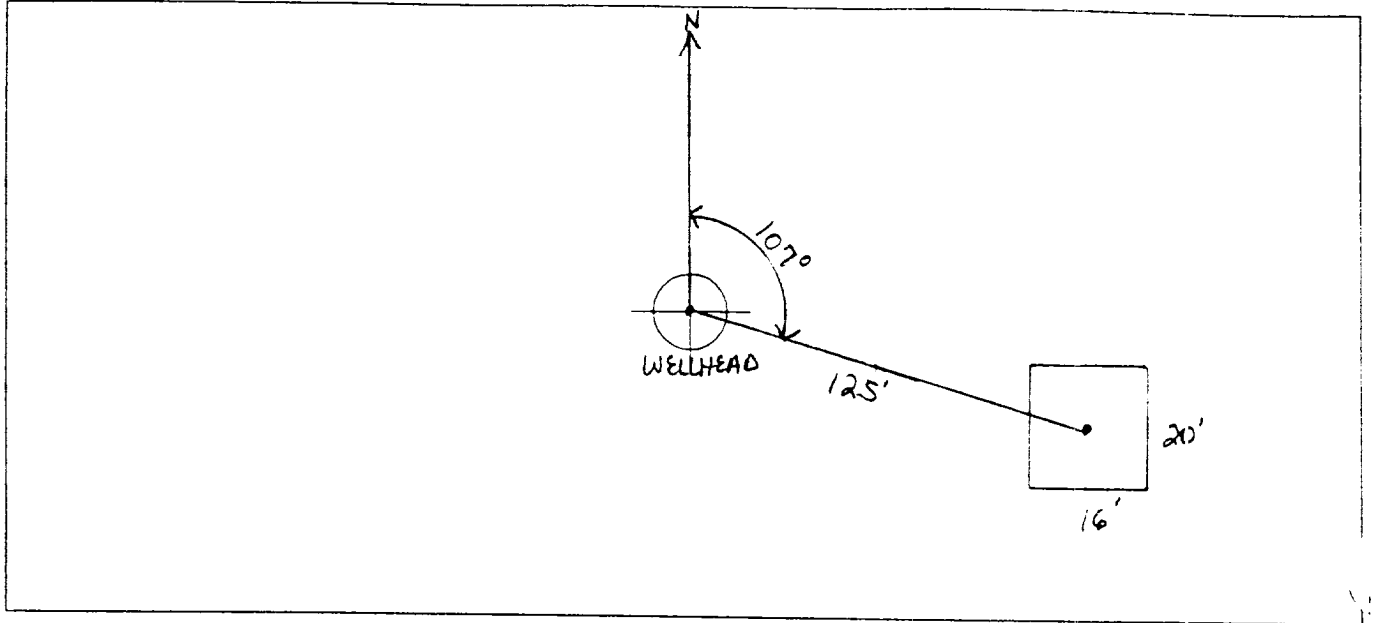

### Remarks :

TOOK PICTURES AT 10:31 A.M.

END DUMP

REMARKS

Completed By:

Robert Thompson

Signature

6-15-94

Date

# FIELD PIT REMEDIATION/CLOSURE FORM

<b>GENERAL</b>	<p>Meter: <u>74755</u> Location: <u>TURNER B Com H #13</u></p> <p>Coordinates: Letter: <u>N</u> Section <u>2</u> Township: <u>26</u> Range: <u>8</u></p> <p>Or Latitude _____ Longitude _____</p> <p>Date Started : <u>7-26-94</u> Run: <u>07</u> <u>51</u></p>
<b>FIELD OBSERVATIONS</b>	<p>Sample Number(s): <u>KP152</u></p> <p>Sample Depth: <u>12'</u> Feet</p> <p>Final PID Reading <u>002</u> PID Reading Depth <u>12'</u> Feet</p> <p style="text-align: center;">Yes      No</p> <p>Groundwater Encountered <input type="checkbox"/> <input checked="" type="checkbox"/> Approximate Depth _____ Feet</p>
<b>CLOSURE</b>	<p>Remediation Method :</p> <div style="display: flex; justify-content: space-between;"> <div> <p>Excavation <input type="checkbox"/></p> <p>Onsite Bioremediation <input type="checkbox"/></p> <p>Backfill Pit Without Excavation <input checked="" type="checkbox"/></p> </div> <div> <p>Approx. Cubic Yards <u>0</u></p> <p><input type="checkbox"/></p> <p><input checked="" type="checkbox"/> Tierra</p> </div> </div> <p>Soil Disposition:</p> <div style="display: flex; justify-content: space-between;"> <div> <p>Envirotech <input checked="" type="checkbox"/> <u>7/27/94</u></p> <p>Other Facility <input type="checkbox"/> Name: _____</p> </div> <div> <p><input type="checkbox"/></p> </div> </div> <p>Pit Closure Date: <u>7-26-94</u> Pit Closed By: <u>B.E.I</u></p>
<b>REMARKS</b>	<p>Remarks : <u>Some LINE markers. Pit looked dug At</u>  <u>SAME test hole to 12' Pd 002 closed pit</u></p>
	<p>Signature of Specialist: <u>Kelly Badillo</u></p>



## FIELD SERVICES LABORATORY

### ANALYTICAL REPORT

#### PIT CLOSURE PROJECT - Soil

#### SAMPLE IDENTIFICATION

SAMPLE NUMBER:

Field ID

Lab ID

MTR CODE | SITE NAME:

SAMPLE DATE | TIME (Hrs):

SAMPLED BY:

DATE OF TPH EXT. | ANAL.:

DATE OF BTEX EXT. | ANAL.:

TYPE | DESCRIPTION:

KP152

74755

7-26-94

N/A

7.28.94

7/29/94

VG

945764

N/A

1045

7.28.94

7/30/94

Fine Brown Sand

REMARKS:

#### RESULTS

PARAMETER	RESULT	UNITS	QUALIFIERS			
			DF	Q	M(g)	V(ml)
BENZENE	< 0.025	MG/KG	1			
TOLUENE	< 0.025	MG/KG	1			
ETHYL BENZENE	< 0.025	MG/KG	1			
TOTAL XYLENES	< 0.025	MG/KG	1			
TOTAL BTEX	< 0.10	MG/KG				
TPH (418.1)	< 10	MG/KG			2.06	28
HEADSPACE PID	2	PPM				
PERCENT SOLIDS	96.3	%				

- TPH is by EPA Method 418.1 and BTEX is by EPA Method 8020 -

The Surrogate Recovery was at

80

% for this sample All QA/QC was acceptable.

Narrative:

ATI results attached.

DF = Dilution Factor Used

Date:

8/2/94



2709-D Pan American Freeway, NE Albuquerque, NM 87107  
Phone (505) 344-3777 FAX (505) 344-4413

ATI I.D. 407422

August 3, 1994

El Paso Natural Gas Co.  
P.O. Box 4990  
Farmington, NM 87499

Project Name/Number: PIT CLOSURE 24324

Attention: John Lambdin

On 07/29/94, Analytical Technologies, Inc., (ADHS License No. AZ0015), received a request to analyze **non-aqueous** samples. The samples were analyzed with EPA methodology or equivalent methods. The results of these analyses and the quality control data, which follow each set of analyses, are enclosed.

If you have any questions or comments, please do not hesitate to contact us at (505) 344-3777.

Letitia Krakowski, Ph.D.  
Project Manager

H. Mitchell Rubenstein, Ph.D.  
Laboratory Manager

MR:jt

Enclosure

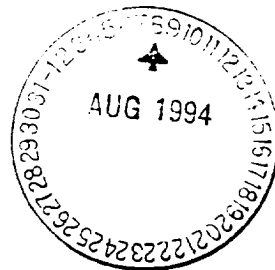

# GAS CHROMATOGRAPHY RESULTS

TEST : BTEX (EPA 8020)  
 CLIENT : EL PASO NATURAL GAS CO. ATI I.D.: 407422  
 PROJECT # : 24324  
 PROJECT NAME : PIT CLOSURE

SAMPLE ID. #	CLIENT I.D.	MATRIX	DATE SAMPLED	DATE EXTRACTED	DATE ANALYZED	DIL. FACTOR
04	945762	NON-AQ	07/26/94	07/29/94	07/29/94	1
05	945763	NON-AQ	07/26/94	07/29/94	07/29/94	1
06	945764	NON-AQ	07/26/94	07/29/94	07/30/94	1
PARAMETER			UNITS	04	05	06
BENZENE			MG/KG	<0.025	<0.025	<0.025
TOLUENE			MG/KG	<0.025	<0.025	<0.025
ETHYLBENZENE			MG/KG	<0.025	<0.025	<0.025
TOTAL XYLENES			MG/KG	<0.025	<0.025	<0.025

## SURROGATE:

BROMOFLUOROBENZENE (%) 85 90 80