

(SUBMIT IN TRIPLICATE)

Indian Agency **Navajo Tribal**
30-045-05994
Allottee _____
Lease No. **I-149-BID-9198**

X		

UNITED STATES
DEPARTMENT OF THE INTERIOR
GEOLOGICAL SURVEY

SUNDRY NOTICES AND REPORTS ON WELLS

NOTICE OF INTENTION TO DRILL	<input checked="" type="checkbox"/>	SUBSEQUENT REPORT OF WATER SHUT-OFF	
NOTICE OF INTENTION TO CHANGE PLANS		SUBSEQUENT REPORT OF SHOOTING OR ACIDIZING	
NOTICE OF INTENTION TO TEST WATER SHUT-OFF		SUBSEQUENT REPORT OF ALTERING CASING	
NOTICE OF INTENTION TO REDRILL OR REPAIR WELL		SUBSEQUENT REPORT OF REDRILLING OR REPAIR	
NOTICE OF INTENTION TO SHOOT OR ACIDIZE		SUBSEQUENT REPORT OF ABANDONMENT	
NOTICE OF INTENTION TO PULL OR ALTER CASING		SUPPLEMENTARY WELL HISTORY	
NOTICE OF INTENTION TO ABANDON WELL			

(INDICATE ABOVE BY CHECK MARK NATURE OF REPORT, NOTICE, OR OTHER DATA)

February 13, 1959

Dellit-Taylor Pool Unit

Well No. **I-D** is located **790** ft. from **S** line and **790** ft. from **W** line of sec. **8**

SW SW/4 Sec. 8 (1/4 Sec. and Sec. No.)	20N (Twp.)	11W (Range)	NMSPM (Meridian)
Undesignated Dakota (Field)	San Juan (County or Subdivision)	New Mexico (State or Territory)	

The elevation of the derrick floor above sea level is **6572** ft.



DETAILS OF WORK

(State names of and expected depths to objective sands; show sizes, weights, and lengths of proposed casings; indicate mudding jobs, cementing points, and all other important proposed work)

It is intended to drill a well through the Dakota Formation using rotary tools and mud circulation. Possible productive intervals will be perforated and sand fractured. Estimated Total Depth 6400'.

Casing Program:

- 10-1/4" at 175' with 150 sacks cement circulated to surface.**
- 7" at 6400' with 300 sacks cement, 1st stage.**
- 3-stage collar at 2100' with 150 sacks cement 2nd stage.**

The W/2 of Section 8 is dedicated to this well.
SW/4 Section 8 Navajo Tribal Contract I-149-BID-9198
The NW/4 of Section 8 -- SP 67841-A **Communication Agreement will follow.**

I understand that this plan of work must receive approval in writing by the Geological Survey before operations may be commenced.

Company **El Paso Natural Gas Products Company**

Address **Post Office Box 1846**
Farmington, New Mexico

Original Signed **EWELL N. WALSH**
By _____
Title **Petroleum Engineer**

NEW MEXICO OIL CONSERVATION COMMISSION
Well Location and Acreage Dedication Plat

Section A.

Date February 9 1959

Operator EL PASO NATURAL GAS PRODUCTS Lease DELHI TAYLOR POOL UNIT Navajo Tribal Contract
I-149-BND-9108
Well No. 1-D Unit Letter M Section 3 Township 26 N Range 11 W NMPM
Located 790 Feet From South Line, 790 Feet From West Line
County San Juan G. L. Elevation 6362 Dedicated Acreage 300 1/2 3200 Acres
Name of Producing Formation Dakota Pool Undesignated

1. Is the Operator the only owner* in the dedicated acreage outlined on the plat below?
Yes No
2. If the answer to question one is "no," have the interests of all the owners been consolidated by communitization agreement or otherwise? Yes No . If answer is "yes," Type of Consolidation _____
3. If the answer to question two is "no," list all the owners and their respective interests below:

Owner

Land Description

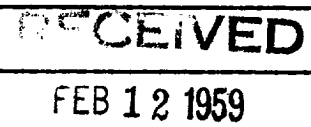

Section B

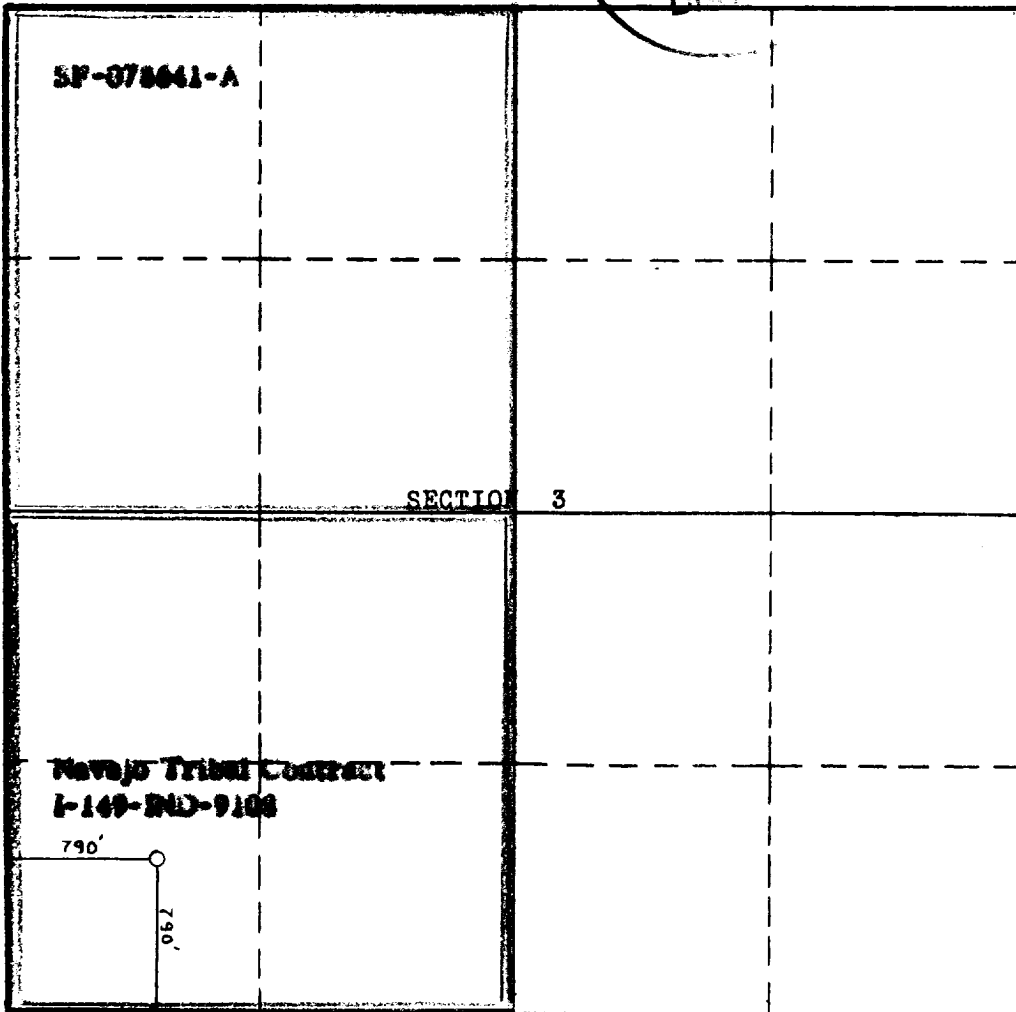

GEOLOGICAL SURVEY
FARMINGTON, NEW MEXICO

This is to certify that the information in Section A above is true and complete to the best of my knowledge and belief.

El Paso Natural Gas Products Co.

(Operator)

Original Signed EWELL N. WALSH

(Representative)

Box 1565, Farmington, N. M.

Address

This is to certify that the well location shown on the plat in Section B was plotted from field notes of actual surveys made by me or under my supervision and that the same is true and correct to the best of my knowledge and belief.

Date Surveyed Feb 29 1959

Stephen H. Kinney
STEPHEN H. KINNEY

Registered Professional Engineer and/or Land Surveyor.

Certificate No. 803

3-25-68

EL PASO PRODUCTS COMPANY

WELLS REQUIRING FILE CORRECTIONS ONLY

<u>LEASE NAME & WELL NUMBER</u>	<u>LOCATION</u>	<u>POOL</u>	<u>PRESENT ACREAGE</u>	<u>CORRECT ACREAGE</u>
Delhi Taylor D #1	M-3-26N-11W	Basin Dakota	W 320	W 320.01 ✓
Delhi Taylor E #1	G-4-26N-11W	Basin Dakota	E 320	E 320.32 ✓
Delhi Taylor C #1	M-4-26N-11W	Basin Dakota	W 320	W 320.56 ✓
Frontier B #3	E-4-27N-11W	Basin Dakota	W 320	W 320.70 ✓
Frontier E #1	O-4-27N-11W	Basin Dakota	E 320	E 321.06 ✓
Frontier D #1	E-5-27N-11W	Basin Dakota	W 320	W 320.58 ✓
Frontier C #2	I-5-27N-11W	Basin Dakota	E 320	E 320.54 ✓