



RY TO O.C.C.

UNITED STATES
DEPARTMENT OF THE INTERIOR
GEOLOGICAL SURVEY
P. O. Box 965
Farmington, New Mexico



May 23, 1955

J. Glenn Turner
Box 728
Farmington, New Mexico

Re: Santa Fe 078135

Gentlemen:

Receipt is acknowledged of your "Notice of Intention to Drill" dated May 23, 1955 covering your well No. 13-1 Huerfano Unit in SW 1/4 sec. 1, T. 26 N., R. 9 W., N. M. P. M., San Juan County, New Mexico, Ballard Pictured Cliffs pool.

Your proposed work is hereby approved subject to compliance with the provisions of the "Oil and Gas Operating Regulations" revised May 25, 1942, a copy of which will be sent to you on request, and subject to the following conditions:

1. Drilling operations so authorized are subject to the attached sheet for general conditions of approval.
2. Furnish copies of all logs.

Very truly yours,

P. T. McGrath
District Engineer

PTMcGrath:ac

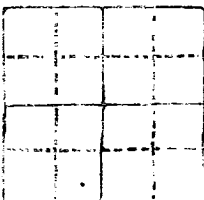



STATE BANK
OF NEW YORK
AND TRUST COMPANY

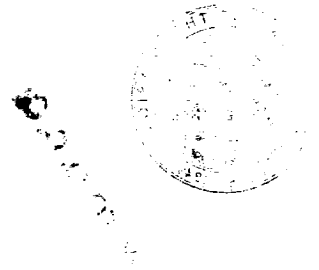

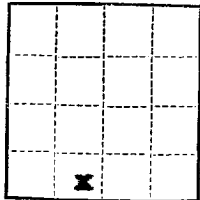

(SUBMIT IN TRIPLICATE)

UNITED STATES
DEPARTMENT OF THE INTERIOR
GEOLOGICAL SURVEY

Land Office Santa Fe
Lease No. 078135
Unit SW/4

SUNDRY NOTICES AND REPORTS ON WELLS

NOTICE OF INTENTION TO DRILL	<input checked="" type="checkbox"/>	SUBSEQUENT REPORT OF WATER SHUT-OFF	
NOTICE OF INTENTION TO CHANGE PLANS		SUBSEQUENT REPORT OF SHOOTING OR ACIDIZING	
NOTICE OF INTENTION TO TEST WATER SHUT-OFF		SUBSEQUENT REPORT OF ALTERING CASING	
NOTICE OF INTENTION TO RE-DRILL OR REPAIR WELL		SUBSEQUENT REPORT OF RE-DRILLING OR REPAIR	
NOTICE OF INTENTION TO SHOOT OR ACIDIZE		SUBSEQUENT REPORT OF ABANDONMENT	
NOTICE OF INTENTION TO PULL OR ALTER CASING		SUPPLEMENTARY WELL HISTORY	
NOTICE OF INTENTION TO ABANDON WELL			

(INDICATE ABOVE BY CHECK MARK NATURE OF REPORT, NOTICE, OR OTHER DATA)

May 23, 1955, 19

Huerfano Unit

Well No. 13-1 is located 990 ft. from N line and 1650 ft. from E line of sec. 1

SW/4 Sec. 1
(1/4 Sec. and Sec. No.)

T. 26 N
(Twp.)

R. 9 W
(Range)

N.M.P.M.
(Meridian)

Ballard Pictured Cliffs
(Field)

San Juan County
(County or Subdivision)

New Mexico
(State or Territory)

The elevation of the derrick floor above sea level is 6167 ft. (Ungraded ground)

DETAILS OF WORK

(State names of and expected depths to objective sands; show sizes, weights, and lengths of proposed casings; indicate mudding jobs, cementing points, and all other important proposed work)

1. To be drilled with 4 1/2 inch diameter bit to a depth of 100 feet below the surface of the ground. The casing to be run to a depth of 100 feet below the surface of the ground. The casing to be run to a depth of 100 feet below the surface of the ground. The casing to be run to a depth of 100 feet below the surface of the ground.

2. To be drilled with 4 1/2 inch diameter bit to a depth of 100 feet below the surface of the ground. The casing to be run to a depth of 100 feet below the surface of the ground. The casing to be run to a depth of 100 feet below the surface of the ground. The casing to be run to a depth of 100 feet below the surface of the ground.

3. To be drilled with 4 1/2 inch diameter bit to a depth of 100 feet below the surface of the ground. The casing to be run to a depth of 100 feet below the surface of the ground. The casing to be run to a depth of 100 feet below the surface of the ground. The casing to be run to a depth of 100 feet below the surface of the ground.

4. To be drilled with 4 1/2 inch diameter bit to a depth of 100 feet below the surface of the ground. The casing to be run to a depth of 100 feet below the surface of the ground. The casing to be run to a depth of 100 feet below the surface of the ground. The casing to be run to a depth of 100 feet below the surface of the ground.

I understand that this plan of work must receive approval in writing by the Geological Survey before operations may be commenced.

Company Union Pacific

Address 1000 17th Street, Santa Fe, New Mexico

By

Title

Company J. Glenn Turner

HUERFANITO UNIT

Lease

~~CRANFORD OIL FIELD~~

Well No. ~~101~~ 13-1

Sec. 1

T. 26 N

R. 9 W

N.M.P.M.

Location 990 feet from South line;
1650 feet from West line

Elevation: 6167 GL

San Juan County

New Mexico

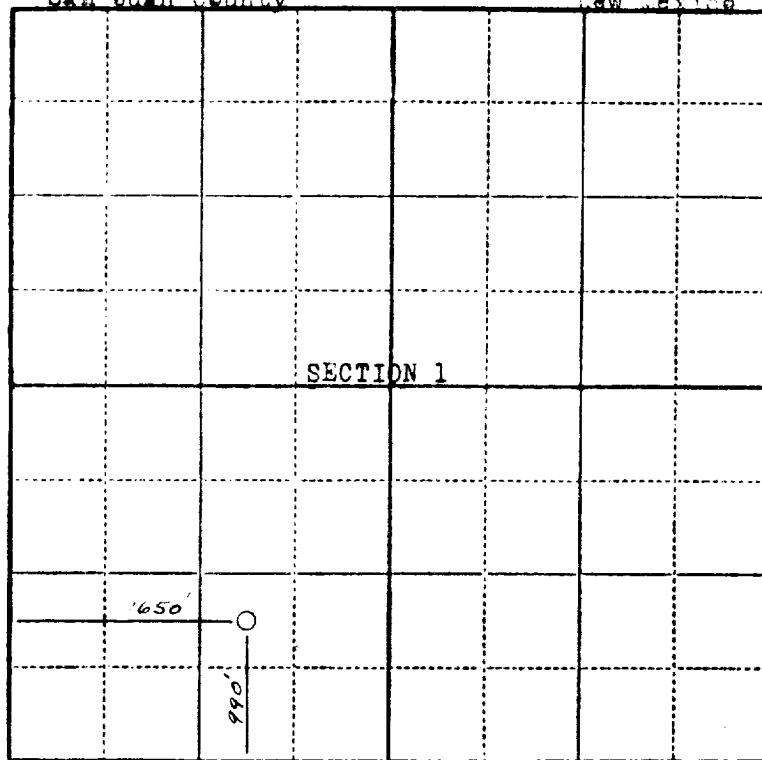

Scale--4 inches equal 1 mile.

This is to certify that the above plat was prepared from field notes of actual surveys made by me or under my supervision and that the same are true and correct to the best of my knowledge and belief.

Stephen H. Kinney

STEPHEN H. KINNEY
Registered Professional
Engineer and Land Surveyor

Surveyed

May 11

19 55

Seal:

RECEIVED
MAY 11 1955
U. S. GEOLOGICAL SURVEY
FARMINGTON, NEW MEXICO