

(SUBMIT IN TRIPLICATE)

UNITED STATES  
DEPARTMENT OF THE INTERIOR  
GEOLOGICAL SURVEY

Land Office Santa Fe  
Lease No. 000000  
Unit American Unit

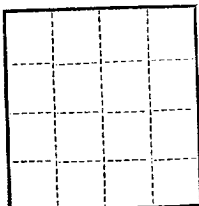

SUNDRY NOTICES AND REPORTS ON WELLS

NOTICE OF INTENTION TO DRILL.....	<input checked="" type="checkbox"/>	SUBSEQUENT REPORT OF WATER SHUT-OFF.....	
NOTICE OF INTENTION TO CHANGE PLANS.....		SUBSEQUENT REPORT OF SHOOTING OR ACIDIZING.....	
NOTICE OF INTENTION TO TEST WATER SHUT-OFF.....		SUBSEQUENT REPORT OF ALTERING CASING.....	
NOTICE OF INTENTION TO RE-DRILL OR REPAIR WELL.....		SUBSEQUENT REPORT OF RE-DRILLING OR REPAIR.....	
NOTICE OF INTENTION TO SHOOT OR ACIDIZE.....		SUBSEQUENT REPORT OF ABANDONMENT.....	
NOTICE OF INTENTION TO PULL OR ALTER CASING.....		SUPPLEMENTARY WELL HISTORY.....	
NOTICE OF INTENTION TO ABANDON WELL.....			

(INDICATE ABOVE BY CHECK MARK NATURE OF REPORT, NOTICE, OR OTHER DATA)

October 25, 1956

Well No. 98 is located 690 ft. from N line and 1150 ft. from E line of sec. 5  
10 (Range) 30PM (Meridian)  
10 (Twp.) San Juan (County or Subdivision) New Mexico (State or Territory)  
West Natl. (Field)

The elevation of the derrick floor above sea level is 6639 ft.

DETAILS OF WORK

(State names of and expected depths to objective sands; show sizes, weights, and lengths of proposed casings; indicate mudding jobs, cementing points, and all other important proposed work)

It is intended to drill a well thru the Pictured Cliff formation using rotary tools and to perforate and water fracture possible producing zones. Estimated Total Depth 2290'.

Casing Program:

9 5/8" at 120' with 125 sacks regular cement circulated to surface.  
5 1/2" at 2290' with 75 sacks regular cement and 75 sacks Portland Cement.

The NE 1/4 of Section 5 is dedicated to this well.  
NE 1/4 of 000095.

I understand that this plan of work must receive approval in writing by the Geological Survey before operations may be commenced.

Company El Paso Natural Gas Company

Address Box 977  
Paradagon, New Mexico

ORIGINAL SIGNED E. J. COEL

By Petroleum Engineer  
Title

NEW MEXICO  
OIL CONSERVATION COMMISSION

Form 10-120

WELL LOCATION AND/OR GAS PRODUCTION PLAT

DATE OCTOBER 22, 1956

OPERATOR EL PASO NATURAL GAS COMPANY COUNTY HUERFANO SF 080895

SECTION 64 TOWNSHIP 5 RANGE 26-N COUNTY 10-W N.M.P.V.

LOCATED 890 FEET FROM SOUTH LINE 1750 FEET FROM EAST LINE

SAN JUAN COUNTY, NEW MEXICO SURVEY LOCATION 662822

NAME OF LANDMINING COMPANY PICTURED CLIFF WEST KUTZ ACRES 160 ACRES  
(1935 PLAT)

Note: All distances must be from outer boundaries of section.

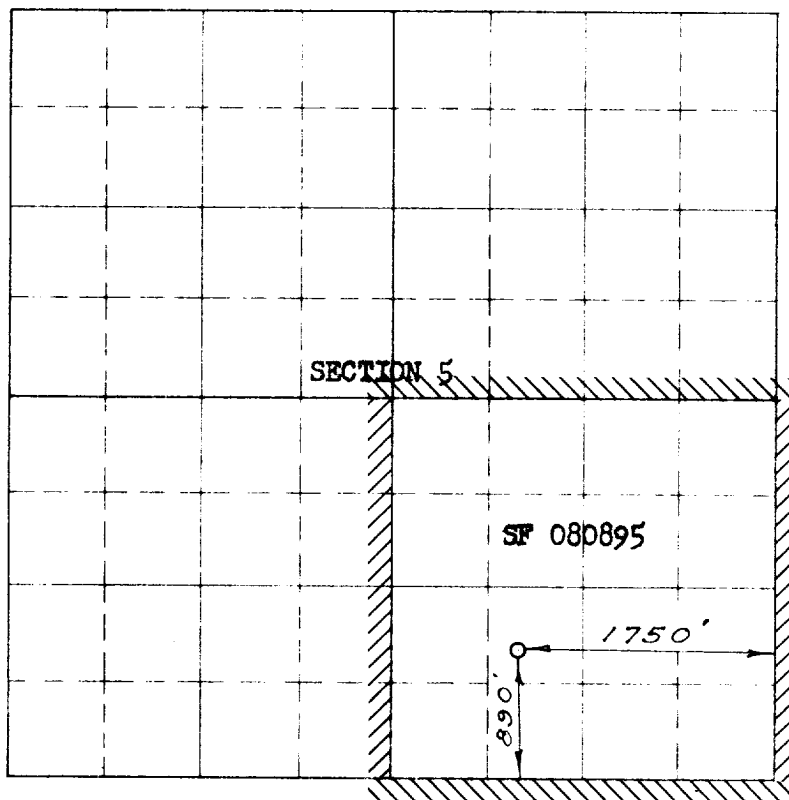

Scale: 1 inches equal 1 mile

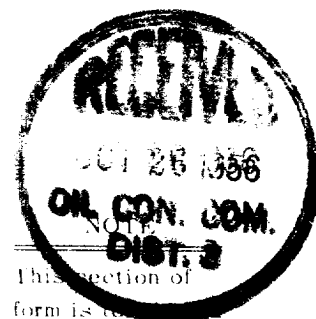

This section of  
form is to be  
used for gas wells only

This is to certify that the above plat was prepared from  
field notes of actual surveys made by me or under my  
supervision and that the same are true and correct to the  
best of my knowledge and belief.

Date Surveyed SEPTEMBER 21, 1956

E. O. Walker  
Registered Professional Engineer and/or Land Surveyor

1. Is this well a Dual Comp.

Yes \_\_\_\_\_ No X

2. If the answer to Question 1  
is yes, are there any other dually  
completed wells within the  
dedicated acreage.

Yes \_\_\_\_\_ No \_\_\_\_\_

ORIGINAL SIGNED E. J. COEL  
Name \_\_\_\_\_

Position Petroleum Engineer

Representing El Paso Natural Gas Co.

Address Box 997, Farmington, N.M.

(Seal)

Farmington, New Mexico