



STATE OF NEW MEXICO
ENERGY, MINERALS AND NATURAL RESOURCES DEPARTMENT
OIL CONSERVATION DIVISION

OK
P

GARREY CARRUTHERS
GOVERNOR

July 5, 1990

POST OFFICE BOX 2088
STATE LAND OFFICE BUILDING
SANTA FE, NEW MEXICO 87504
(505) 827-5800

Meridian Oil, Inc.
P.O. Box 4289
Farmington, NM 87499-4289

Attention: Peggy Bradfield

RECEIVED
JUL 10 1990
OIL CON. DIV.
DIST. 3

Administrative Order NSL-2826

Dear Ms. Bradfield:

Reference is made to your application dated June 5, 1990 for a non-standard coal gas well location for your existing Huerfano Unit Well No. 66 which was drilled in 1956 and completed in the West Kutz Pictured Cliffs Pool at a standard gas well location 1650 feet from the South line and 990 feet from the East line (Unit I) of Section 6, Township 26 North, Range 10 West, NMPM, San Juan County, New Mexico.

It is my understanding that the Pictured Cliffs zone will be properly plugged back and said well will be recompleted to the Basin-Fruitland Coal Gas Pool, which pursuant to the Special Rules and Regulations for the Basin-Fruitland Coal Gas Pool as promulgated by Division Order R-8768, is unorthodox. Further, Lots 1 and 2, the S/2 NE/4 and the SE/4 of said Section 6 shall be dedicated to the well forming a standard 320.24-acre gas spacing and proration unit for said pool.

By the authority granted me under the provisions of Rule 8 Division Order No. R-8768, the above-described unorthodox coal gas well location is hereby approved.

Sincerely,

William J. LeMay
Director

WJL/MES/ag

cc: Oil Conservation Division - Aztec
US Bureau of Land Management - Farmington



STATE OF NEW MEXICO
ENERGY AND MINERALS DEPARTMENT
OIL CONSERVATION DIVISION
AZTEC DISTRICT OFFICE

1000 RIO BRAZOS ROAD
AZTEC, NEW MEXICO 87410
(505) 334-0178

REY CARRUTHERS
GOVERNOR

Date: 6-15-90

Oil Conservation Division
P.O. Box 2088
Santa Fe, NM 87504-2088

Re: Proposed MC _____
Proposed DHC _____
Proposed NSL X _____
Proposed SWD _____
Proposed WFX _____
Proposed PMX _____

Gentlemen:

I have examined the application dated 6-7-90
for the Mention Oil Inc. Huerfano Unit #66
Operator Lease & Well No.

I-6-26M-10W and my recommendations are as follows:
Unit, S-T-R

Approve

Yours truly,

Eric Bunch

MERIDIAN OIL

June 5, 1990

Certified Mail

Mr. William LeMay
New Mexico Oil Conservation Division
Post Office Box 2088
Santa Fe, New Mexico 87503

RECEIVED

JUN 7 1990

**OIL CON. DIV.
DIST. 3**

RE: Huerfano Unit #66
1650'FSL, 990'FEL
Section 06, T-26-N, R-10-W
San Juan County, New Mexico

Dear Mr. LeMay:

This is a request for administrative approval for a non-standard gas well location in the Basin Fruitland Pool.

Meridian Oil intends to plugback and recomplete the Huerfano Unit #66 well from the Pictured Cliffs pool to the Basin Fruitland Coal Pool. The current location of this well is 1650'FSL, 990'FEL, Section 06, T-26-N, R-10-W, San Juan County, New Mexico. The well is considered non-standard due to the NE-SW dedicated pattern established for the Basin Fruitland Coal Pool. To comply with the New Mexico Oil Conservation Division rules, Meridian is submitting the following for your approval of this non-standard location:

1. C-102 plat showing location of the well;
2. Plat showing offset owners/operators;
3. Copy of Well Completion Log for original completion.

All surrounding lands are located within the Huerfano Unit boundaries - El Paso Natural Gas Company is the operator of this unit.

Sincerely yours,



Peggy Bradfield
encl.

1933

1933

1933

1933

Submit to Appropriate
District Office
State Lease - 4 copies
Fee Lease - 3 copies

State of New Mexico
Energy, Minerals and Natural Resources Department

Form C-102
Revised 1-1-89

OIL CONSERVATION DIVISION

DISTRICT I
P.O. Box 1980, Hobbs, NM 88240

P.O. Box 2088
Santa Fe, New Mexico 87504-2088

DISTRICT II
P.O. Drawer DD, Artesia, NM 88210

DISTRICT III
1000 Rio Brazos Rd., Aztec, NM 87410

WELL LOCATION AND ACREAGE DEDICATION PLAT

All Distances must be from the outer boundaries of the section

Operator <u>El Paso Natural Gas</u>		Lease <u>Huerfano Unit (SF-077936)</u>		Well No. <u>66</u>
Unit Letter <u>I</u>	Section <u>6</u>	Township <u>26 North</u>	Range <u>10 West</u>	County <u>NMPM San Juan</u>
Actual Footage Location of Well: <u>1650</u> feet from the <u>South</u> line and <u>990</u> feet from the <u>East</u> line				
Ground level Elev. <u>6562' GL</u>	Producing Formation <u>Fruitland Coal</u>		Pool <u>Basin</u>	Dedicated Acreage: <u>320.24</u> Acres

1. Outline the acreage dedicated to the subject well by colored pencil or hatchure marks on the plat below.
2. If more than one lease is dedicated to the well, outline each and identify the ownership thereof (both as to working interest and royalty).
3. If more than one lease of different ownership is dedicated to the well, have the interest of all owners been consolidated by communitization, unitization, force-pooling, etc.?
☒ Yes ☐ No If answer is "yes" type of consolidation unitization

If answer is "no" list the owners and tract descriptions which have actually been consolidated. (Use reverse side of this form if necessary.)

No allowable will be assigned to the well until all interests have been consolidated (by communitization, unitization, forced-pooling, or otherwise) or until a non-standard unit, eliminating such interest, has been approved by the Division.

Prepared from a plat
dated: June 16, 1956
by: C. O. Walker

RECEIVED
JUN 7 1990

OIL CON. DIV.
DIST. 3

OPERATOR CERTIFICATION

I hereby certify that the information contained herein is true and complete to the best of my knowledge and belief.

Signature
Peggy Bradfield

Printed Name
Regulatory Affairs

Position
El Paso Natural Gas

Company

Date

SURVEYOR CERTIFICATION

I hereby certify that the well location shown on this plat was plotted from field notes of actual surveys made by me or under my supervision, and that the same is true and correct to the best of my knowledge and belief.

Date Surveyed

Signature
Neale C. Edwards

Professional Surveyor

Certificate No.
Neale C. Edwards

0 330 660 990 1320 1650 1980 2310 2640 2000 1500 1000 500 0

MERIDIAN OIL INC

Well Name Huerfano Unit #66

Footage 1650' FSL; 990' FEL

APPLICATION FOR NON-STANDARD PRORATION UNIT

County San Juan State New Mexico Section 6 Township 26N Range 10W

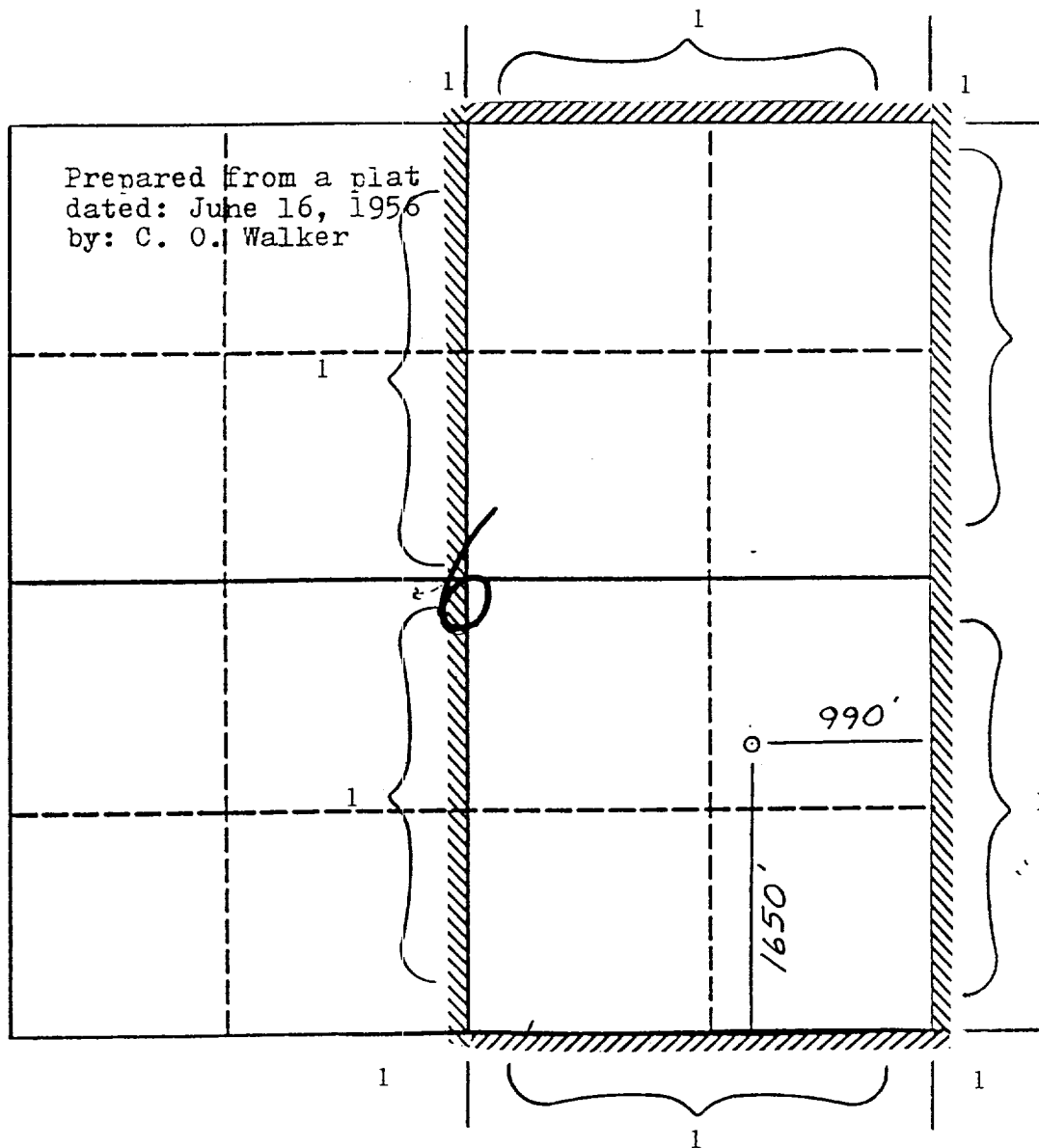

Remarks 1) El Paso Natural Gas Company

EL PASO NATURAL GAS COMPANY

WELL COMPLETION LOG

Well Huerfano Unit #66
Name No.

I-Sec. 713

Land Office Santa FeLease Number 077936Leasor El Paso Natural Gas Company Area W. Kutz P.C. County San Juan State New MexicoSec. 6 Twp. 26N Rge. 10W North 1650 South 990 East West N.M.P.M.Elevation Gr. 6562 DF 6572

CASING RECORD

Date	Size	Depth	Cement
7-9-56	9 5/8"	131'	100
7-12-56	5 1/2"	2230'	150

Total Depth 2230Clean Out Depth 2170

TUBING RECORD

Date	Size	Depth
8-4-56	1 1/4"	2162'

PACKER

Date
Type
Depth

FORMATION

TOPS

Ojo Alamo	1095
Kirtland	1210
Fruitland	1818
Pictured Cliffs	2120
Lewis	
Cliff House	
Menefee	
Point Lookout	
Mancos	
1st Dakota	
2nd Dakota	
Morrison	
Shinarump	
Coconino	
Rico	
Pennsylvanian	
Hermosa	
Paradox	
Molas	
Mississippian	
Devonian	

DRILL STEM TESTS:

From To Time Gage Recovery
 From To Time Gage Recovery
 From To Time Gage Recovery
 From To Time Gage Recovery

CORE:

From To Recovery
 From To
 From To

SHOOTING OR ACIDIZING:

From See remarks To Quantity or Type Shot Gage Before
 From To Quantity or Type Shot Gage Before

PERFORATIONS:

From 2120 To 2149 ; From To ; From To

SURVEYS:

ELECTRIC LOGS ES 132-2225, ML 132-2218.TEMPERATURE SURVEYS B&R @ 1510'.INITIAL POTENTIAL: Ch. Volume - 380 MCF/D.

Gage 382 MCF/D Hours Tested Three Type Test Calculated A.O.F.
 FPC FPT 17 SIPC 388 SIPT 388

SEE BACK FOR REMARKS.

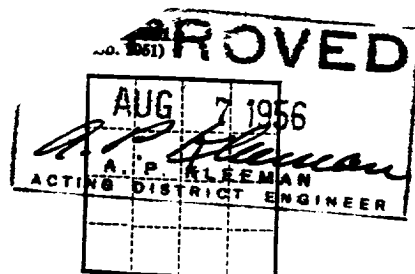

(SUBMIT IN TRIPLICATE)
UNITED STATES
DEPARTMENT OF THE INTERIOR
GEOLOGICAL SURVEY

Budget Bureau No. 42-R338.4
Approval expires 12-31-60.

Ind Office Santa Fe
Lease No. 077936
Unit Barstow Unit
(I-See. 713)

SUNDRY NOTICES AND REPORTS ON WELLS RECEIVED

NOTICE OF INTENTION TO DRILL	SUBSEQUENT REPORT OF WATER SHUT-OFF
NOTICE OF INTENTION TO CHANGE PLANS	SUBSEQUENT REPORT OF SHOOTING OR ACIDIZING
NOTICE OF INTENTION TO TEST WATER SHUT-OFF	SUBSEQUENT REPORT OF ALTERING CASING
NOTICE OF INTENTION TO RE-DRILL OR REPAIR WELL	SUBSEQUENT REPORT OF RE-DRILLING OR REPAIR
NOTICE OF INTENTION TO SHOOT OR ACIDIZE	SUBSEQUENT REPORT OF ABANDONMENT
NOTICE OF INTENTION TO PULL OR ALTER CASING	SUPPLEMENTARY WELL HISTORY
NOTICE OF INTENTION TO ABANDON WELL	<u>Water Fracture</u>

(INDICATE ABOVE BY CHECK MARK NATURE OF REPORT, NOTICE, OR OTHER DATA)

August 3, 1956

Well No. 66 is located 1630 ft. from N line and 990 ft. from E line of sec. 6
SE Section 6 26S 10W Range
(1/4 Sec. and Sec. No.) (Twp.) (Range) (Meridian)
E. State Santa Fe New Mexico
(Field) (County or Subdivision) (State or Territory)

The elevation of the derrick floor above sea level is 6572 ft.

DETAILS OF WORK

(State names of and expected depths to objective sands; show sizes, weights, and lengths of proposed casings; indicate mudding jobs, cementing points, and all other important proposed work)

8-1-56 Total Depth 2230'. Cleanout to 2170'.
Water fractured Pictured Cliffs perforated intervals 2120-2149 with
44,000 gallons water and 40,000# sand. Breakdown pressure 2100#, maximum
pressure 2100#, average treating pressure 1600#. Injection rate 60.2
bbls./min. Flow 3700 gallons. Natural gas none.

I understand that this plan of work must receive approval in writing by the Geological Survey before operations may be commenced.

Company El Paso Natural Gas Company

Address Box 297,

Farmington, New Mexico

By [Signature]

Title Petroleum Engineer