

NEW MEXICO OIL CONSERVATION COMMISSION  
Well Location and Acreage Dedication Plat

Section A.

Date April 3, 1969

Operator EL PASO XXXXXXXX PRODUCTS CO. Lease HICKMAN "A"  
Well No. 2 Unit Letter L Section 3 Township 26 N Range 12 W 125TH  
Located 1880 Feet From South Line, 660 Feet From West Line  
County San Juan G. L. Elevation 6039 Dedicated Acreage 80 Acres  
Name of Producing Formation Gallup Pool Gallegos Gallup

1. Is the Operator the only owner\* in the dedicated acreage outlined on the plat below?  
Yes x No       .
2. If the answer to question one is "no," have the interests of all the owners been consolidated by communitization agreement or otherwise? Yes        No       . If answer is "yes," Type of Consolidation
3. If the answer to question two is "no," list all the owners and their respective interests below:

Owner

Land Description

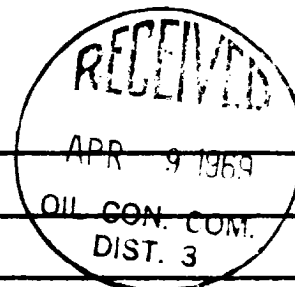

Section B

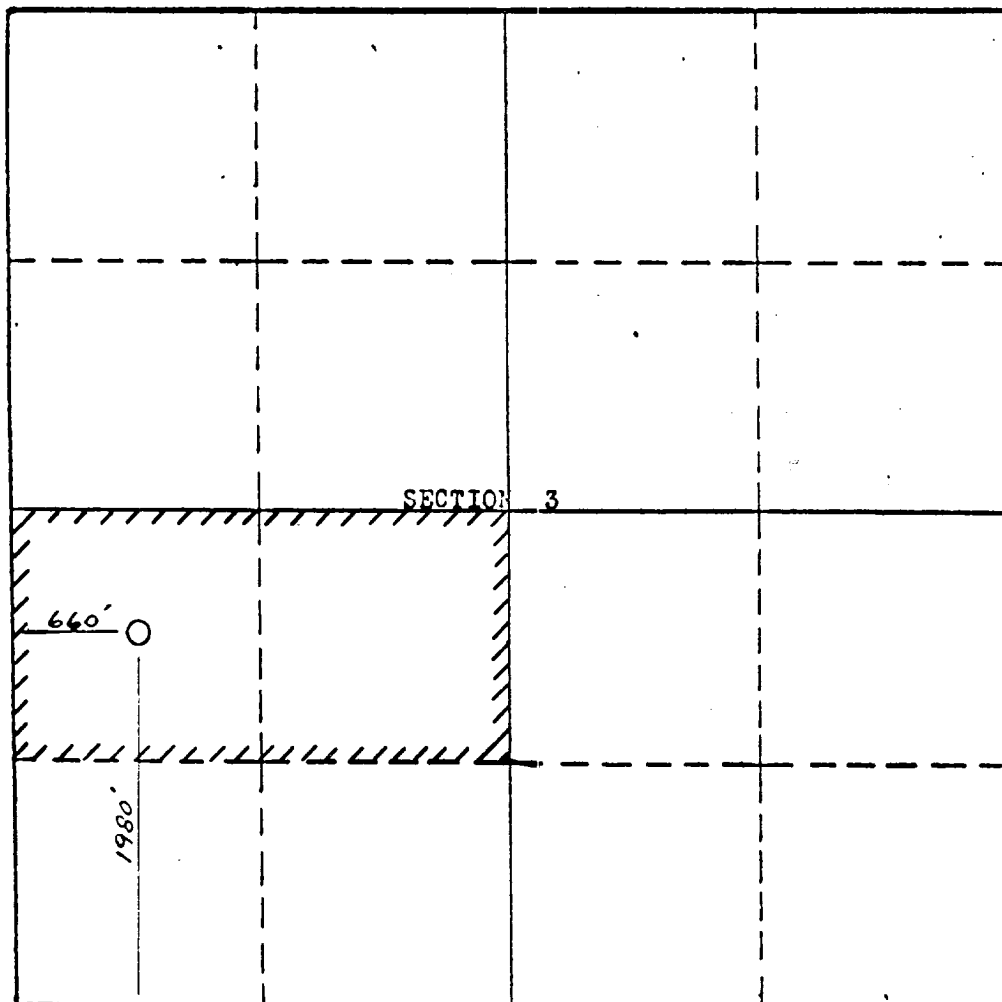

This is to certify that the information in Section A above is true and complete to the best of my knowledge and belief.

El Paso Products Company

(Operator)

W R Speer  
(Representative)

Box 1560, Farmington, N.M.

Address

This is to certify that the well location shown on the plat in Section B was plotted from field notes of actual surveys made by me or under my supervision and that the same is true and correct to the best of my knowledge and belief.

Date Surveyed Dec. 12, 1957

Stephen H. Kinney  
STEPHEN H. KINNEY,

Registered Professional  
Engineer and/or Land Surveyor.

Certificate No. 803

(See instructions for completing this form on the reverse side)