

(SUBMIT IN TRIPLICATE)

UNITED STATES
DEPARTMENT OF THE INTERIOR
GEOLOGICAL SURVEY

Budget Bureau No. 42-R358.4.
Approval expires 12-31-60.

Land Office

Lease No. **SF 078286**

Unit

SUNDRY NOTICES AND REPORTS ON WELLS

NOTICE OF INTENTION TO DRILL	<input checked="" type="checkbox"/>	SUBSEQUENT REPORT OF WATER SHUT-OFF	
NOTICE OF INTENTION TO CHANGE PLANS		SUBSEQUENT REPORT OF SHOOTING OR ACIDIZING	
NOTICE OF INTENTION TO TEST WATER SHUT-OFF		SUBSEQUENT REPORT OF ALTERING CASING	
NOTICE OF INTENTION TO RE-DRILL OR REPAIR WELL		SUBSEQUENT REPORT OF RE-DRILLING OR REPAIR	
NOTICE OF INTENTION TO SHOOT OR ACIDIZE		SUBSEQUENT REPORT OF ABANDONMENT	
NOTICE OF INTENTION TO PULL OR ALTER CASING		SUPPLEMENTARY WELL HISTORY	
NOTICE OF INTENTION TO ABANDON WELL			

(INDICATE ABOVE BY CHECK MARK NATURE OF REPORT, NOTICE, OR OTHER DATA)

Well No. Walker 1-A is located 1980 ft. from [N] line and 660 ft. from [E] line of sec. 4
NE/4 Sec. 4 26N 12W NM
 (Sec. and Sec. No.) (Twp.) (Range) (Meridian)

Undesignated San Juan New Mexico
 (Field) (County or Subdivision) (State or Territory)

The elevation of the derrick floor above sea level is 6005.0 ft. Ground Level, Ungraded

DETAILS OF WORK

(State names of and expected depths to objective sands; show sizes, weights, and lengths of proposed casings; indicate mudding jobs, cementing points, and all other important proposed work)

Objective Horizon, Lower Gallup Sand, @ about 5200'.
 Surface String, 8 5/8", 24#, J 55, @ 200'.
 Oil String, 5 1/2", 15.50#, J 55, @ 5300'.
 Mud Program, wt. 9.5#, Vis. 40-60, Filt. 10, Begin @ 500'.
 Cementing Intervals, 0-200', Estimate, 3700 to 5400'.
 Coring Program, None Anticipated.

I understand that this plan of work must receive approval in writing by the Geological Survey before operations may be commenced.

Company Petro-Atlas Inc.

Address 729 East Main
Farrington, New Mexico

By Leon E. Kizer
 Title Superintendent

NEW MEXICO OIL CONSERVATION COMMISSION
Well Location and Acreage Dedication Plat

Section A.

Date _____

Operator PETRO - ATLAS, INC. Lease WALKER NO. 1-A
Well No. 1988 Unit Letter H Section 4 Township 26 NORTH Range 12 WEST NMFM
Located the North Feet From 660 Line the EAST Line
County SAN JUAN G. L. Elevation 6005.0 Dedicated Acreage 40 Acres
Name of Producing Formation GALLUP Pool GALLUP

1. Is the Operator the only owner* in the dedicated acreage outlined on the plat below?
Yes ☒ No ☐
2. If the answer to question one is "no," have the interests of all the owners been consolidated by communitization agreement or otherwise? Yes ☐ No ☐. If answer is "yes," Type of Consolidation _____
3. If the answer to question two is "no," list all the owners and their respective interests below:
Ref: GLO plat dated 19 July 1915

Owner

Land Description

RECEIVED

JUL 2 1958

U. S. GEOLOGICAL SURVEY
FARMINGTON, NEW MEXICO

Section B

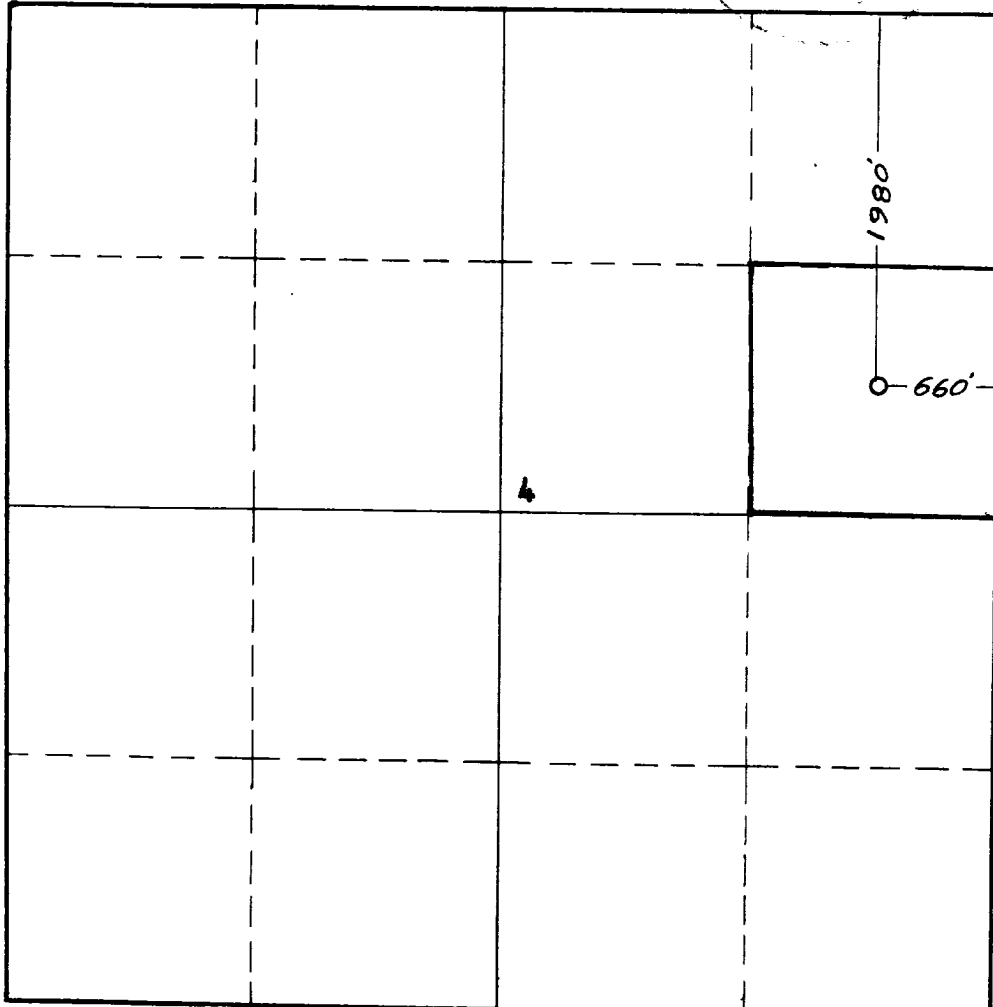

This is to certify that the information in Section A above is true and complete to the best of my knowledge and belief.

Petro-Atlas Inc.
(Operator)

James P. Leese
(Representative)

Address _____

This is to certify that the well location shown on the plat in Section B was plotted from field notes of actual surveys made by me or under my supervision and that the same is true and correct to the best of my knowledge and belief.

Date Surveyed 20 June 1958

James P. Leese
Registered Professional
Engineer and/or Land Surveyor.
James P. Leese

Certificate No. 1463

(See instructions for completion of plat)

INSTRUCTIONS FOR COMPLETION:

1. Operator shall furnish and certify to the information called for in Section A.
2. Operator shall outline the dedicated acreage for both oil and gas wells on the plat in Section B.
3. A registered professional engineer or land surveyor registered in the State of New Mexico or approved by the Commission shall show on the plat the location of the well and certify this information in the space provided.
4. All distances shown on the plat must be from the outer boundaries of Section.
5. If additional space is needed for listing owners and their respective interests as required in question 3, Section A, please use space below

* "Owner" means the person who has the right to drill into and to produce from any pool and to appropriate the production either for himself or for himself and another. (65-3-29 (e) NMSA 1953 Comp.)