

(SUBMIT IN TRIPLICATE)

UNITED STATES
DEPARTMENT OF THE INTERIOR
GEOLOGICAL SURVEY

Land Office Santa Fe
Lease No. 078207
Unit Meridian Unit

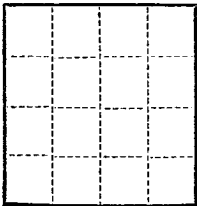

SUNDRY NOTICES AND REPORTS ON WELLS

NOTICE OF INTENTION TO DRILL	<input checked="" type="checkbox"/>	SUBSEQUENT REPORT OF WATER SHUT-OFF	
NOTICE OF INTENTION TO CHANGE PLANS		SUBSEQUENT REPORT OF SHOOTING OR ACIDIZING	
NOTICE OF INTENTION TO TEST WATER SHUT-OFF		SUBSEQUENT REPORT OF ALTERING CASING	
NOTICE OF INTENTION TO RE-DRILL OR REPAIR WELL		SUBSEQUENT REPORT OF RE-DRILLING OR REPAIR	
NOTICE OF INTENTION TO SHOOT OR ACIDIZE		SUBSEQUENT REPORT OF ABANDONMENT	
NOTICE OF INTENTION TO PULL OR ALTER CASING		SUPPLEMENTARY WELL HISTORY	
NOTICE OF INTENTION TO ABANDON WELL			

(MARK NATURE OF REPORT, NOTICE, OR OTHER DATA)

ILLEGIBLE

October 25, 1955

Well No. 01 is located 1550 ft. from [N] line and 1950 ft. from [E] line of sec. 3
SW Section 3 25N 10W 1912
(1/4 Sec. and Sec. No.) (Twp.) (Range) (Meridian)
West Ariz. P.O. Ext. San Juan New Mexico
(Field) (County or Subdivision) (State or Territory)

The elevation of the derrick floor above sea level is 6743 ft.

DETAILS OF WORK

(State names of and expected depths to objective sands; show sizes, weights, and lengths of proposed casings; indicate mudding jobs, cementing points, and all other important proposed work)

It is intended to drill a well thru the Pictured Cliff formation using rotary tools and to perforate and water fracture possible producing zones. Estimated Total Depth 2450'.

Casing Program:

3 7/8" at 120' with 125 sacks regular cement circulated to surface.
5 1/2" at 2400' with 75 sacks regular cement, 75 sacks Portland.

The SW 1/4 of Section 3 is dedicated to this well.
NW 1/4 of 078207.

I understand that this plan of work must receive approval in writing by the Geological Survey before operations may be commenced.

Company El Paso Natural Gas Company

Address Box 997
Farmington, New Mexico

ORIGINAL SIGNED E. J. COEL

By _____

Title Petroleum Engineer

NEW MEXICO
OIL CONSERVATION COMMISSION

Form 10-10-54

WELL LOCATION AND/OR GAS PRORATION PLAT

DATE OCTOBER 22, 1956

OPERATOR EL PASO NATURAL GAS COMPANY LEASE HUERFANO SF 078267

WELL NO. 61 SECTION 3 RANGE 26-N TOWNSHIP 10-W NMPM

LOCATED 1650 FEET FROM NORTH LINE 1550 FEET FROM WEST LINE

SAN JUAN COUNTY, NEW MEXICO WEST KUTZ ELEVATION 673322

NAME OF EXISTING FORMATION PICTURED CLIFF FORM P.C. EXT. TOTAL ACRES 160 ACRES
(1935 PLAT)

Note: All distances must be from outer boundaries of section.

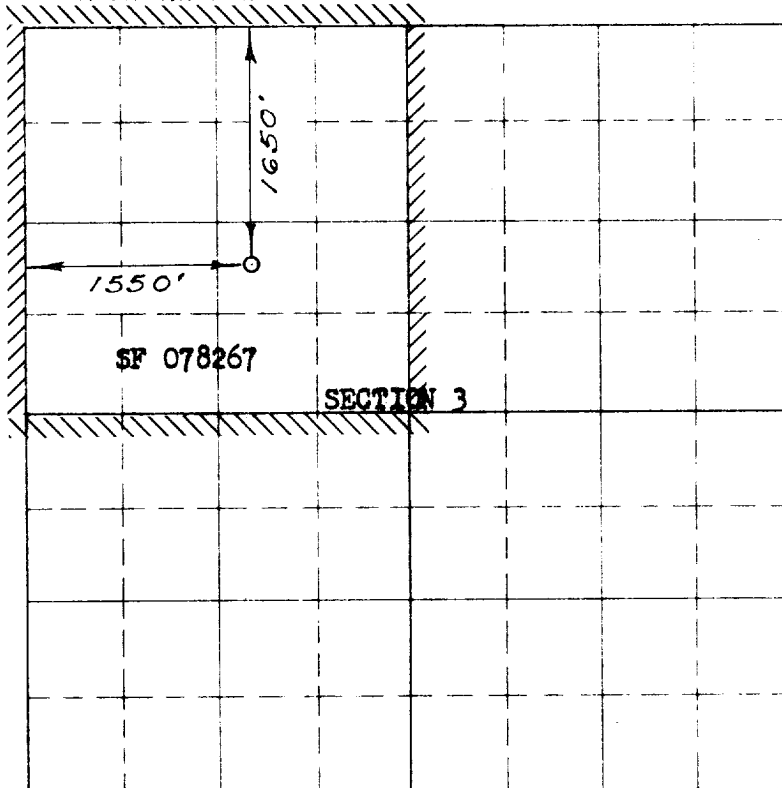

Scale 4 inches equal 1 mile

N

NOTE

This section of
form is to be used
for wells only



This is to certify that the above plat was prepared from
field notes of actual surveys made by me or under my
supervision and that the same are true and correct to the
best of my knowledge and belief.

Date Surveyed SEPTEMBER 21, 1956

E. O. Walker
Registered Professional Engineer and/or Land Surveyor

1. Is this well a Dual Comp.

Yes _____ No _____

2. If the answer to Question 1
is yes, are there any otherdually
completed wells within the
dedicated acreage.

Yes _____ No _____

ORIGINAL SIGNED E. J. COEL
Name _____

Position Petroleum Engineer

Representing El Paso Natural Gas Co.

Address Box 997, Farmington, N.M.

(Seal)

Farmington, New Mexico