

(SUBMIT IN TRIPLICATE)

UNITED STATES
DEPARTMENT OF THE INTERIOR
GEOLOGICAL SURVEY

Land Office _____
Lease No. **SP 078286**
Unit **W. K.**

SUNDRY NOTICES AND REPORTS ON WELLS

NOTICE OF INTENTION TO DRILL	<input checked="" type="checkbox"/>	SUBSEQUENT REPORT OF WATER SHUT-OFF
NOTICE OF INTENTION TO CHANGE PLANS		SUBSEQUENT REPORT OF SHOOTING OR ACIDIZING
NOTICE OF INTENTION TO TEST WATER SHUT-OFF		SUBSEQUENT REPORT OF ALTERING CASING
NOTICE OF INTENTION TO RE-DRILL OR REPAIR WELL		SUBSEQUENT REPORT OF RE-DRILLING OR REPAIR
NOTICE OF INTENTION TO SHOOT OR ACIDIZE		SUBSEQUENT REPORT OF ABANDONMENT
NOTICE OF INTENTION TO PULL OR ALTER CASING		SUPPLEMENTARY WELL HISTORY
NOTICE OF INTENTION TO ABANDON WELL		

(INDICATE ABOVE BY CHECK MARK NATURE OF REPORT, NOTICE, OR OTHER DATA)

March 25, 1957

Well No. **1** is located **790** ft. from **N** line and **1850** ft. from **W** line of sec.

14 **5** **26N** **12W** **New Mexico**
(1/4 Sec. and Sec. No.) (Twp.) (Range) (Meridian)
Hal **San Juan** **New Mexico**
(Field) (County or Subdivision) (State or Territory)

The elevation of the derrick floor above sea level is **5873** ft. **Ground level, ungraded.**

DETAILS OF WORK

(State names of and expected depths to objective sands; show sizes, weights, and lengths of proposed casings; indicate mudding jobs, cementing points, and all other important proposed work)

Objective Horizon: Second Gallup sand, expected at about 4950'

Surface String: 8 5/8", 240, J-55 at 170'

Oil String: 5 1/2", 15.5#, J-55 at RTD (Estimate 5050')

Mud Program: Wt. 9.5, Visc. 40-50, Filtr. 10 (Begin at 170')

Cementing Intervals: 0' to 170', Estimate 3300' to 3050'

Coring Program: Anticipate approximately 100' beginning at about 4950'

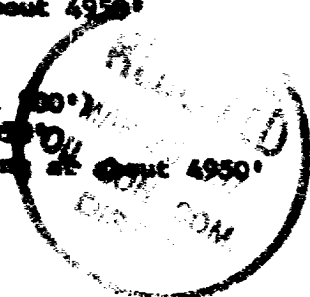

I understand that this plan of work must receive approval in writing by the Geological Survey before operations may be commenced.

Company **The El Dorado Refining Company**

Address **1020 Central Building**

Wichita, Kansas

By **Max S. Houston**

Title **Mgr. of Exploration**

NEW MEXICO
OIL CONSERVATION COMMISSION

Form C-128

Well Location and/or Gas Proration Plat

Date _____

Operator EL DORADO REFINING COMPANY Lease _____

Well No. _____ Section 5 Township 26 NORTH Range 12 WEST, NMPM

Located 790 Feet From the NORTH Line, 1850 Feet From the WEST Line,

SAN JUAN County, New Mexico. G. L. Elevation 5873.0 UNGRADED.

Name of Producing Formation _____ Pool _____ Dedicated Acreage 34.54

(Note: All distances must be from outer boundaries of Section)

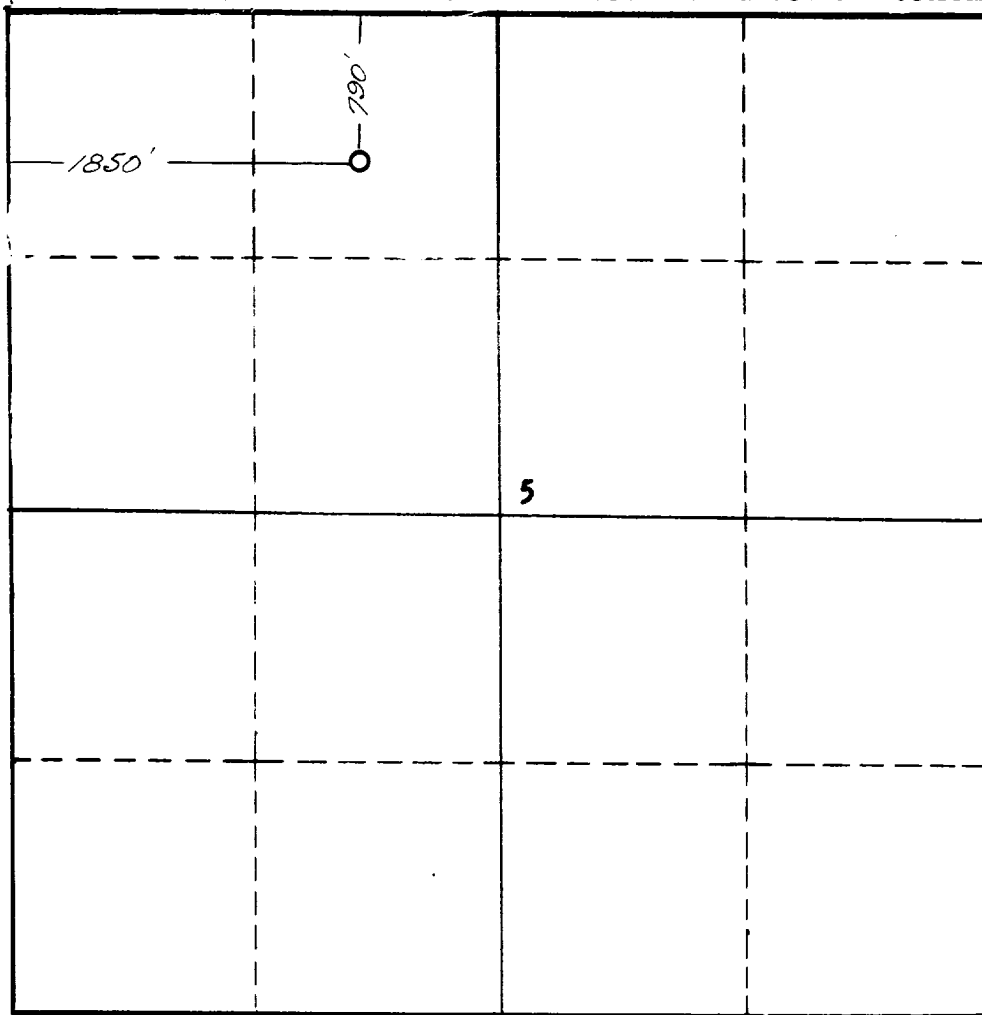

NOTE

This section of
form is to be
used for gas
wells only.



SCALE: 1"=1000'

1. Is this Well a Dual Comp. ? Yes ___ No ___.
2. If the answer to Question 1 is yes, are there any other dually completed wells within the dedicated acreage ? Yes ___ No ___.

Name _____
Position _____
Representing _____
Address _____

This is to certify that the above plat was prepared from field notes of actual surveys made by me or under my supervision and that the same are true and correct to the best of my knowledge and belief.

Date Surveyed 16 MARCH 1957
James P. Leese
Registered Professional Engineer and/or
Land Surveyor James P. Leese