



IN REPLY REFER TO:

UNITED STATES  
DEPARTMENT OF THE INTERIOR  
GEOLOGICAL SURVEY  
Farmington, New Mexico

August 16, 1956

Western Natural Gas Company  
823 Midland Tower  
Midland, Texas

Re: New Mexico 05791

Gentlemen:

Receipt is acknowledged of your "Notice of Intention to Drill" dated August 15, 1956 covering your well No. 2 Graham in NE 1/4 SE 1/4 sec. 9, T. 27 N., R. 8 W., N. M. P. M., San Juan County, New Mexico, South Blanco PG pool.

Your proposed work is hereby approved subject to compliance with the provisions of the "Oil and Gas Operating Regulations" revised May 25, 1942, a copy of which will be sent to you on request, and subject to the following conditions:

1. Drilling operations so authorized are subject to the attached sheet for general conditions of approval.
2. Furnish copies of all logs.

Very truly yours,

Orig. Sgd. P. T. McGrath

P. T. McGrath  
District Engineer

PTMcGrath:al

COPY TO O. C. G.



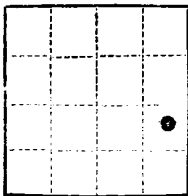

(SUBMIT IN TRIPPLICATE)

UNITED STATES  
DEPARTMENT OF THE INTERIOR  
GEOLOGICAL SURVEY

Land Office Santa Fe  
Lease No. NM-05791  
Unit Graham

SUNDRY NOTICES AND REPORTS ON WELLS

NOTICE OF INTENTION TO DRILL.....	<input checked="" type="checkbox"/>	SUBSEQUENT REPORT OF WATER SHUT-OFF.....	
NOTICE OF INTENTION TO CHANGE PLANS.....		SUBSEQUENT REPORT OF SHOOTING OR ACIDIZING.....	
NOTICE OF INTENTION TO TEST WATER SHUT-OFF.....		SUBSEQUENT REPORT OF ALTERING CASING.....	
NOTICE OF INTENTION TO RE-DRILL OR REPAIR WELL.....		SUBSEQUENT REPORT OF RE-DRILLING OR REPAIR.....	
NOTICE OF INTENTION TO SHOOT OR ACIDIZE.....		SUBSEQUENT REPORT OF ABANDONMENT.....	
NOTICE OF INTENTION TO PULL OR ALTER CASING.....		SUPPLEMENTARY WELL HISTORY.....	
NOTICE OF INTENTION TO ABANDON WELL.....			

(INDICATE ABOVE BY CHECK MARK NATURE OF REPORT, NOTICE, OR OTHER DATA)

August 15, 1956

Well No. 2 is located 1844 ft. from N line and 256 ft. from E line of sec. 9  
NE/4 SE/4 Sec. 9 27-N 8-W NMPM  
(1/4 Sec. and Sec. No.) (Twp.) (Range) (Meridian)  
South Elanco PC San Juan New Mexico  
(Field) (County or Subdivision) (State or Territory)

The elevation of the derrick floor above sea level is 5913 ft. G.L.

DETAILS OF WORK

(State names of and expected depths to objective sands; show sizes, weights, and lengths of proposed casings; indicate mudding jobs, cementing points, and all other important proposed work)

Plan to drill well through Pictured Cliff formation. Will cement now 8 5/8" 24# J-55 Seamless casing at 300' with 250 sacks and now 5 1/2" 15.5# J-55 Electric Weld at approximately 2200 with 150 sacks.

RECEIVED

AUG 16 1956

U. S. GEOLOGICAL SURVEY  
FARMINGTON, NEW MEXICO

I understand that this plan of work must receive approval in writing by the Geological Survey before operations are commenced.

Company WESTERN NATURAL GAS COMPANY

Address 623 Midland Tower

Midland, Texas

By

Title

John B. Thomas  
Office Manager

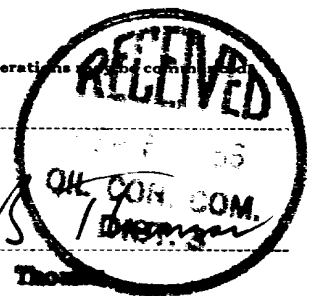

NEW MEXICO  
OIL CONSERVATION COMMISSION  
WELL LOCATION AND PRODUCTION PLAT

JUNE 25, 1956

WESTERN NATURAL GAS COMPANY

GRAHAM

NM 05791

2

9

27-N

8-W

1844

SOUTH

256

EAST

SAN JUAN

5913.28

PICTURED CLIFF

SO. BLANCO

160 ACRES  
(1882 PLAT)

Note: A - 1/4 section of land containing the well.

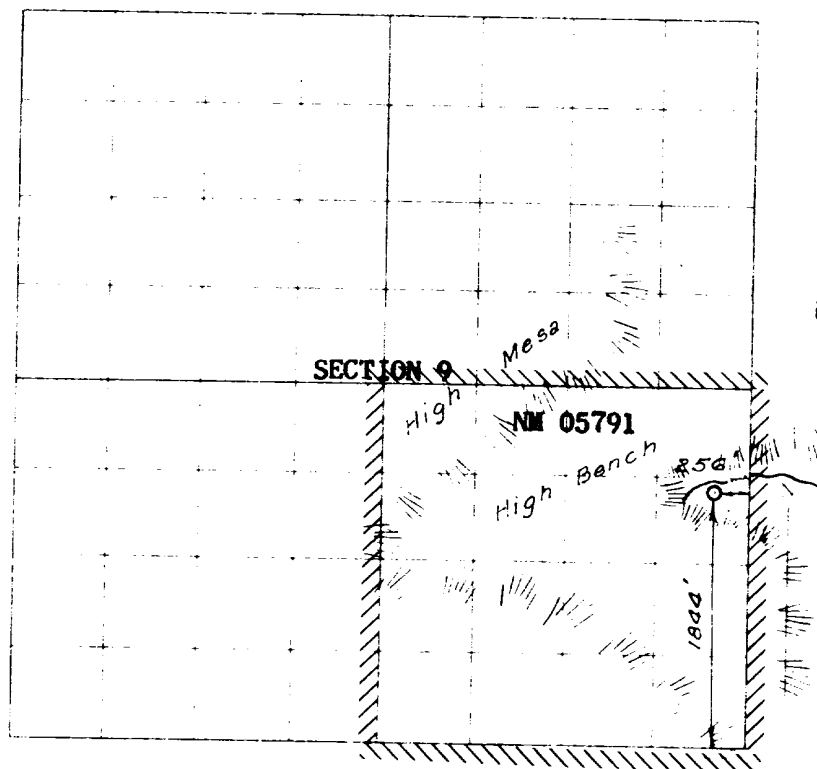

Scale: 1 inch = 1/4 mile

RECEIVED

AUG 16 1956

U. S. GEOLOGICAL SURVEY  
FARMINGTON, NEW MEXICO

NOTE:

This section of  
form is to be used  
for all wells only.



I, the undersigned, being a duly qualified and sworn geologist, do hereby certify that the above described well is located within the boundaries of the land owned by the Western Natural Gas Company, and that the same is a gas well.

DATE: JUNE 24, 1956

*C. O. Parker*  
Geological Professor, Farmington, and of Land Surveyor

1. Is this well a gas well?  
Yes \_\_\_\_\_ No \_\_\_\_\_
2. If the answer to question 1  
is Yes, are there any other wells  
completed within the  
section of land on  
which this well is located?  
Yes \_\_\_\_\_

Name \_\_\_\_\_

Position \_\_\_\_\_

Representing \_\_\_\_\_

Address \_\_\_\_\_



GOVERNOR JOHN F. SIMMS  
CHAIRMAN

**New Mexico**  
**OIL CONSERVATION COMMISSION**

LAND COMMISSIONER E. S. WALKER  
MEMBER

STATE GEOLOGIST A. L. PORTER, JR.  
SECRETARY-DIRECTOR



P. O. Box 68  
SANTA FE, NEW MEXICO

August 9, 1956

RECEIVED

AUG 10 1956

U. S. GEOLOGICAL SURVEY  
FARMINGTON, NEW MEXICO

Western Natural Gas Company  
1006 Main Street  
Houston 2, Texas

Attention: Mr. R. H. McKoy

Administrative Order NSL-57

Gentlemen:

Reference is made to your application for approval of an unorthodox well location for your Hugh J. Graham Well No. 2 to be located 18 1/4 feet from the South line and 256 feet from the East line and in the NE 1/4 SE 1/4 of Section 9, Township 27 North, Range 8 West, South Blanco Pictured Cliffs Gas Pool, San Juan County, New Mexico.

It is our understanding that this unorthodox well location is based upon extreme topographic conditions in the SE 1/4 of said section.

Inasmuch as you furnished waivers from the offset operators, it is possible for immediate approval to be granted. Therefore, by authority granted me under provisions of Rule 4 of the Special Rules and Regulations of the South Blanco Pictured Cliffs Gas Pool, as set forth in Order R-565-C, you are hereby granted an exception to Rule 3 of Order R-565-C for the above described unorthodox well location. You must also obtain like approval from the U. S. Geological Survey.

Very truly yours,

A. L. PORTER, JR.  
Secretary-Director

ALP:nc  
cc: OCC, Astec  
USGS, Farmington