

Form 9-331a
(Feb. 1951)

(SUBMIT IN TRIPLICATE)

UNITED STATES
DEPARTMENT OF THE INTERIOR
GEOLOGICAL SURVEY

Land Office Santa Fe
Lease No. 05750
Unit Graham

SUNDRY NOTICES AND REPORTS ON WELLS

NOTICE OF INTENTION TO DRILL.....	<input checked="" type="checkbox"/>	SUBSEQUENT REPORT OF WATER SHUT-OFF.....	
NOTICE OF INTENTION TO CHANGE PLANS.....		SUBSEQUENT REPORT OF SHOOTING OR ACIDIZING.....	
NOTICE OF INTENTION TO TEST WATER SHUT-OFF.....		SUBSEQUENT REPORT OF ALTERING CASING.....	
NOTICE OF INTENTION TO RE-DRILL OR REPAIR WELL.....		SUBSEQUENT REPORT OF REDRILLING OR REPAIR.....	
NOTICE OF INTENTION TO SHOOT OR ACIDIZE.....		SUBSEQUENT REPORT OF ABANDONMENT.....	
NOTICE OF INTENTION TO PULL OR ALTER CASING.....		SUPPLEMENTARY WELL HISTORY.....	
NOTICE OF INTENTION TO ABANDON WELL.....			

(INDICATE ABOVE BY CHECK MARK NATURE OF REPORT, NOTICE, OR OTHER DATA)

November 28, 1952

Well No. 1 is located 1050 ft. from N line and 1165 ft. from E line of sec. 9

36/4 Sec. 9 27N 5E N. 10. P. 14
(1/4 Sec. and Sec. No.) (Twp.) (Range) (Meridian)

Blanca San Juan New Mexico
(Field) (County or Subdivision) (State or Territory)

The elevation of the ground ~~surface~~ above sea level is 5931.38.

DETAILS OF WORK

(State names of and expected depths to objective sands; show sizes, weights, and lengths of proposed casings; indicate mudding jobs, cementing points, and all other important proposed work)

Plan to drill well thru Mesa Verde formation. Will set 9-5/8" casing at 250' with 200 sacks cement and 5-1/2" casing at approximately 4350' with 150 sacks cement.

I understand that this plan of work must receive approval in writing by the Geological Survey before operations may be commenced.

Company Eastern Natural Gas Company

Address 211 1/2 N. Main

Harrison, New Mexico

By [Signature]

Title District Superintendent

COMPANY WESTERN NATURAL GAS COMPANY

Well Name & No. GRAHAM NO. 1 Lease No. NM 05750

Location 1850 Feet from the North Line 1165 Feet from the East Line

Being in the SE $\frac{1}{4}$ of the NE $\frac{1}{4}$

Sec. 9, T 27 N., R 8 W., N.M.P.M., San Juan County, New Mexico

Ground Elevation 5931.33

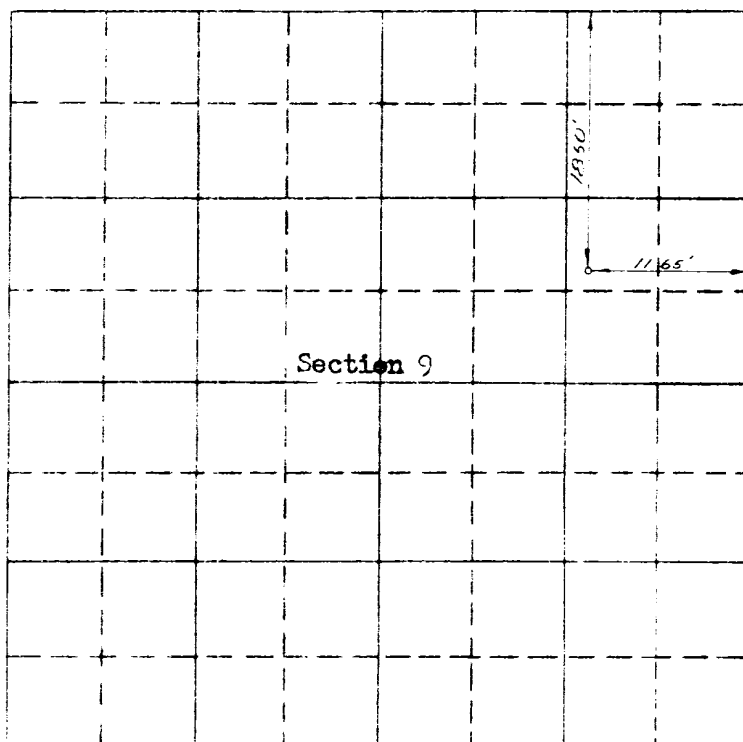

N

Scale -- 4 inches equals 1 mile

Surveyed October 5, , 19 52

This is to certify that the above plat was prepared from field notes of actual surveys made by me or under my supervision and that the same are true and correct to the best of my knowledge and belief.

C. O. Walker
Registered Professional
Engineer and Land Surveyor.

Seal:

Farmington, New Mexico