

UNITED STATES
DEPARTMENT OF THE INTERIOR
BUREAU OF LAND MANAGEMENT

APPLICATION FOR PERMIT TO DRILL, DEEPEN, OR PLUG BACK

1a. TYPE OF WORK PLUG BACK	5. LEASE NUMBER USA-NM-019401
1b. TYPE OF WELL GAS	6. IF INDIAN, ALL. OR TRIBE NAME
2. OPERATOR MERIDIAN OIL INC.	7. UNIT AGREEMENT NAME
3. ADDRESS & PHONE NO. OF OPERATOR P. O. BOX 4289 FARMINGTON, NM 87499 (505) 326-9700	8. FARM OR LEASE NAME SAN JUAN 27-8 8 C
4. LOCATION OF WELL 1650' FNL; 990' FWL	9. WELL NO. 6 4
14. DISTANCE IN MILES FROM NEAREST TOWN	10. FIELD, POOL, OR WILDCAT BASIN FRUITLAND COAL
15. DISTANCE FROM PROPOSED LOCATION TO NEAREST PROPERTY OR LEASE LINE.	11. SEC. T. R. M OR BLK. SEC. 11, 20N , 10SW 1
16. ACRES IN LEASE	12. COUNTY SAN JUAN
17. ACRES ASSIGNED TO WELL 320.00	13. STATE NM
18. DISTANCE FROM PROPOSED LOCATION TO NEAREST WELL DR. COMPL., OR APPLIED FOR ON THIS LEASE.	20. ROTARY OR CABLE TOOLS
21. ELEVATIONS (DF, FT, GR, ETC.) 6654' GL	22. APPROX. DATE WORK WILL START 04/26/90
23. PROPOSED CASING AND CEMENTING PROGRAM ----- *SEE OPERATIONS PLAN	
24. AUTHORIZED BY: <i>[Signature]</i> (ROS) REGULATORY AFFAIRS	RECEIVED APR 18 1990 OIL CON. DIV. DIST. 3 4-4-90 DATE

PERMIT NO. _____ APPROVAL DATE _____

APPROVED BY _____ TITLE _____ DATE _____

NOTE: THIS FORMAT IS ISSUED IN LIEU OF US BLM FORM 3160-3.

*Requires NMCCD approval for the
unorthodox location.*

*Held C-164 For N.S.L.
(C) NMCCD*

APPROVED
APR 13 1990
Ken Townsend
AREA MANAGER

1944-1945

1944-1945

1944-1945

1944-1945

1944-1945

Submit to Appropriate -
District Office
State Lease - 4 copies
Fee Lease - 3 copies

State of New Mexico
Energy, Minerals and Natural Resources Department

Form C-102
Revised 1-1-88

OIL CONSERVATION DIVISION

DISTRICT I
P.O. Box 1980, Hobbs, NM 88240

P.O. Box 2088

Santa Fe, New Mexico 87504-2088

DISTRICT II
P.O. Drawer 00, Aztec, NM 88210

DISTRICT III
1000 Rio Bravo Rd., Aztec, NM 87410

WELL LOCATION AND ACREAGE DEDICATION PLAT

All Distances must be from the outer boundaries of the section

Operator Meridian Oil Inc.			Lease San Juan 27-8 (NM-019401)		Well No. 6- 11
Unit Letter E	Section 11	Township 27 North	Range 8 West	County San Juan	
Actual Footage Location of Well: 1650 feet from the North line and 990 feet from the West line					
Ground level elev. 6654'	Producing Formation Fruitland Coal		Pool Basin	Dedicated Acreage: 320 Acres	

1. Outline the acreage dedicated to the subject well by colored pencil or ink on the plat below.
2. If more than one lease is dedicated to the well, outline each and identify the ownership thereof (both as to working interest and royalty).
3. If more than one lease of different ownership is dedicated to the well, have the interest of all owners been consolidated by commutation, unitization, force-pooling, etc.?

☐ Yes ☐ No If answer is "yes" type of consolidation

If answer is "no" list the owners and tract descriptions which have actually been consolidated. (Use reverse side of this form if necessary.)

No allowable will be assigned to the well until all interests have been consolidated (by commutation, unitization, force-pooling, or otherwise) or until a non-unitized unit, eliminating such interest, has been approved by the Division.

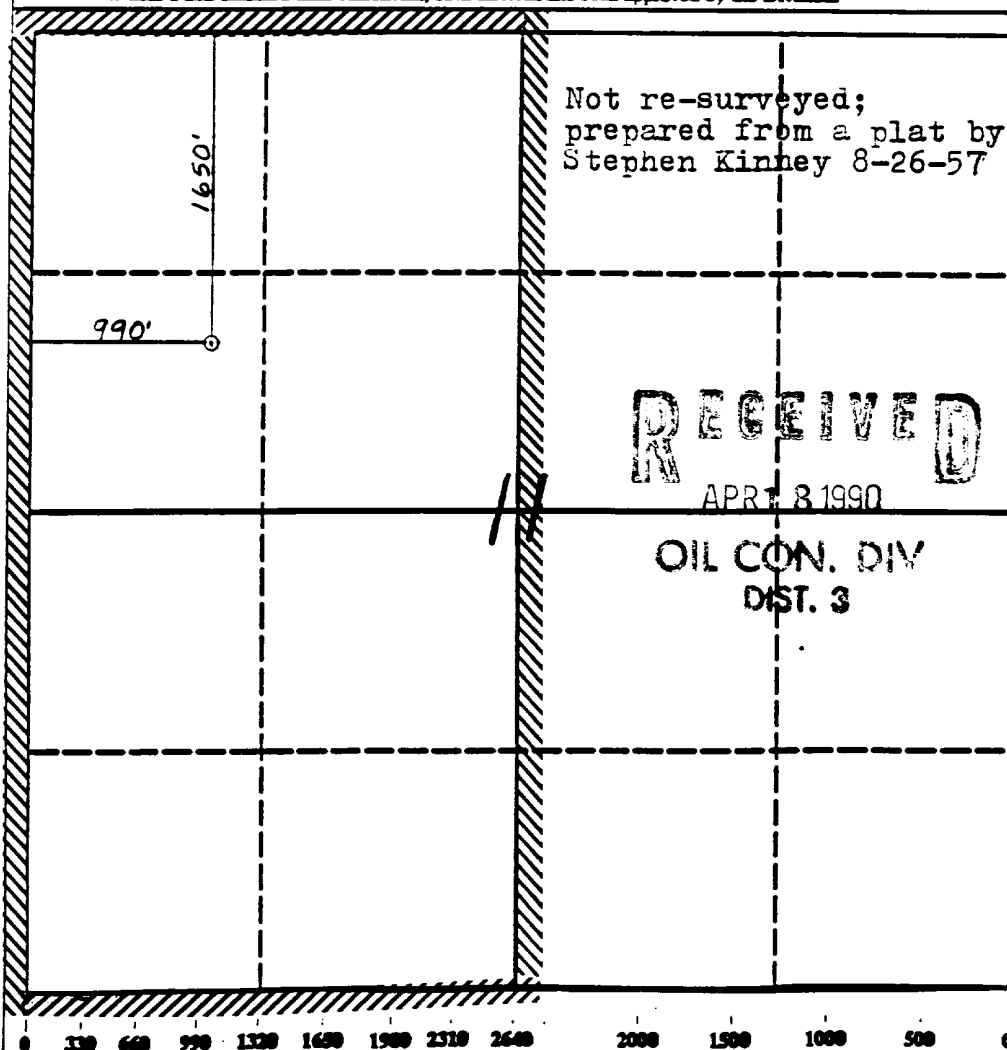

OPERATOR CERTIFICATION

I hereby certify that the information contained herein is true and complete to the best of my knowledge and belief.

Peggy Bradfield
Signature

Peggy Bradfield

Printed Name

Regulatory Affairs

Position

Meridian Oil Inc.

Company

4-4-90

Date

SURVEYOR CERTIFICATION

I hereby certify that the well location shown on this plat was plotted from field notes of actual surveys made by me or under my supervision, and that the same is true and correct to the best of my knowledge and belief.

4-3-90

Date Surveyed

Neale C. Edwards
Signature

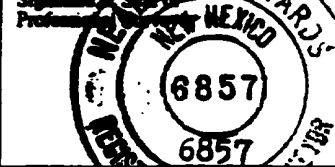

Candidate

Neale C. Edwards

Recompletion Procedure
San Juan 27-8 C #6

1. Prepare location for workover. Install / replace anchors as necessary.
2. MOL with workover rig, hold safety meeting, install safety signs and proper fire equipment at strategic points. Comply with all BLM, NMOCD, and MOI regulations.
3. Rig up blow lines, record tubing and casing pressures and blow well down. Kill well as necessary with water. ND tree and NU 6" 3000 psi BOP and stripping head.
4. TOOH and lay down 92 joints of 1 1/4" (1.660") 2.3# J-55 10rd tubing set @ 2936'.
5. PU 2 3/8" 4.7# J-55 EUE tubing and TIH with 5 1/2" casing scraper. CO to PBSD. TOOH.
6. RU wireline unit and set a 5 1/2" bridge plug @ 2925'. Run a tension set packer to isolate wellhead. Pressure test casing to 3000 psi for 15 minutes. If casing fails, isolate casing leak(s) with a test packer. A squeeze procedure will be provided if the casing is determined to be repairable.
7. Run GR-CCL-CNL. Pick perforations off of log and perforate.
8. Breakdown perforations and flow test well. If necessary, fracture stimulate.
9. TIH w/ 2 3/8" tubing and clean out to PBSD.
10. When well is clean, land 2 3/8" tubing with a common pump seating nipple one joint off bottom. Land tubing near bottom perforation. Swab well in. Record final 30, 45 and 60 minute gauges on morning report. ND BOP. NU tree. Rig down and release rig.
11. Shut well in for pressure build up. Obtain gas and water sample for analysis.

San Juan 27-8 C #6
NW/4 Section 11, T-27-N, R-8-W
San Juan County, New Mexico

Wellbore Schematics

CURRENT

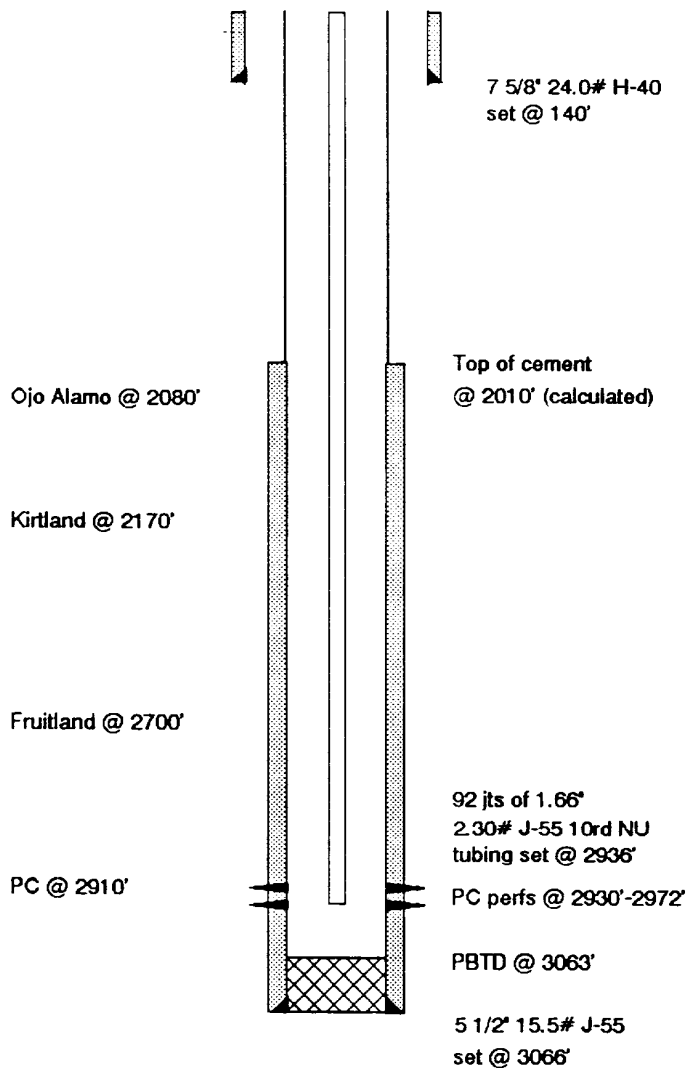

PROPOSED

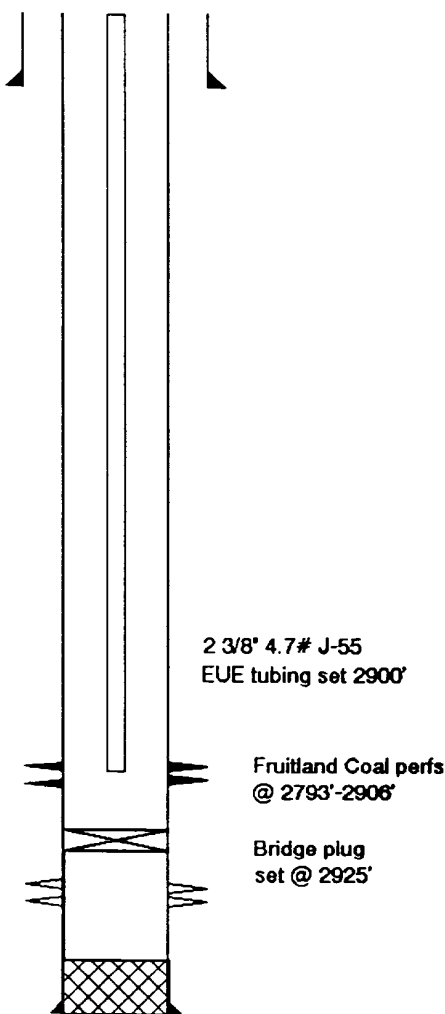

WORKOVER / RECOMPLETION B.O.P. SCHEMATIC

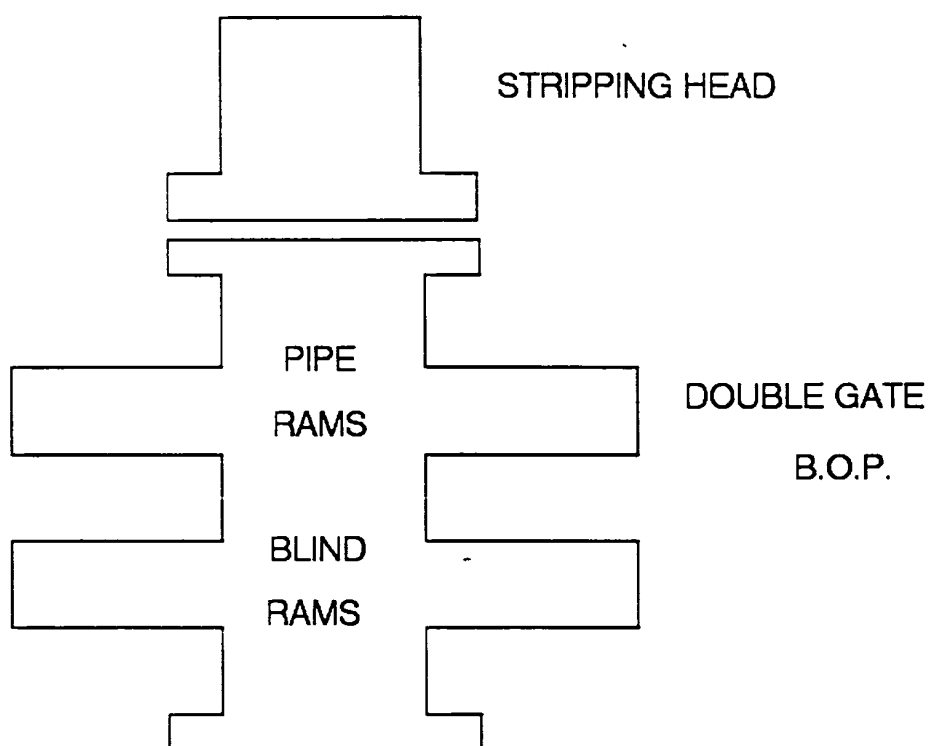

MINIMUM: 6" 2000 PSI DOUBLE GATE B.O.P.
MAXIMUM ANTICIPATED SHUT-IN WELLHEAD
PRESSURE IS LESS THAN 2000 PSI