

(SUBMIT IN TRIPLICATE)

UNITED STATES
DEPARTMENT OF THE INTERIOR
GEOLOGICAL SURVEY

Land Office Santa Fe
Lease No. C79421-1
Unit _____

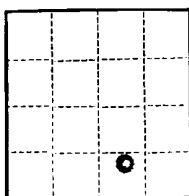

SUNDRY NOTICES AND REPORTS ON WELLS

| | | | |
|--|-------------------------------------|--|--|
| NOTICE OF INTENTION TO DRILL | <input checked="" type="checkbox"/> | SUBSEQUENT REPORT OF WATER SHUT-OFF | |
| NOTICE OF INTENTION TO CHANGE PLANS | | SUBSEQUENT REPORT OF SHOOTING OR ACIDIZING | |
| NOTICE OF INTENTION TO TEST WATER SHUT-OFF | | SUBSEQUENT REPORT OF ALTERING CASING | |
| NOTICE OF INTENTION TO RE-DRILL OR REPAIR WELL | | SUBSEQUENT REPORT OF RE-DRILLING OR REPAIR | |
| NOTICE OF INTENTION TO SHOOT OR ACIDIZE | | SUBSEQUENT REPORT OF ABANDONMENT | |
| NOTICE OF INTENTION TO PULL OR ALTER CASING | | SUPPLEMENTARY WELL HISTORY | |
| NOTICE OF INTENTION TO ABANDON WELL | | | |

(INDICATE ABOVE BY CHECK MARK NATURE OF REPORT, NOTICE, OR OTHER DATA)

Well No. 35 is located 1125 ft. from S line and 1610 ft. from E line of sec. 3
Sh/4 Ar/4 Sec. 3 T27N R30E N. 10. 1. 1.
 (1/4 Sec. and Sec. No.) (Twp.) (Range) (Meridian)
S. Planco San Juan New Mexico
 (Field) (County or Subdivision) (State or Territory)

The elevation of the derrick floor above sea level is 5000 ft.

DETAILS OF WORK

(State names of and expected depths to objective sands; show sizes, weights, and lengths of proposed casings; indicate mudding jobs, cementing points, and all other important proposed work)

12 3/4" hole to 1.5 ft, set 180 ft of 8 5/8" surface casing with 75 sacks. 7 7/8" hole to 1. B. - 2300 and set 5 1/2" x 1 1/2" casing with 200 sacks. E. T. S. G. - 2150. Complete through 60 ft of perms opposite Pictured Cliff formation. Setay tool to 1. B.



I understand that this plan of work must receive approval in writing by the Geological Survey before operations may be commenced.

Company F & G DRILLING COMPANY, INC.

Address Box 1248

Parlington, N. M.

By William C. Russell, President
Title _____

NEW MEXICO
OIL CONSERVATION COMMISSION

Form C-128

Well Location and/or Gas Proration Plat

Date May 17, 1957

Operator E. & G. DRILLING COMPANY Lease Graham

Well No. 35 Section 3 Township 27 NORTH Range 8 WEST NMPM

Located 1125 Feet From the SOUTH Line, 1610 Feet From the EAST Line,

SAN JUAN County, New Mexico. G. L. Elevation 5895.5 UNGRADED

Name of Producing Formation P. C. Pool S. Blanco Dedicated Acreage 1/60

(Note: All distances must be from outer boundaries of Section)

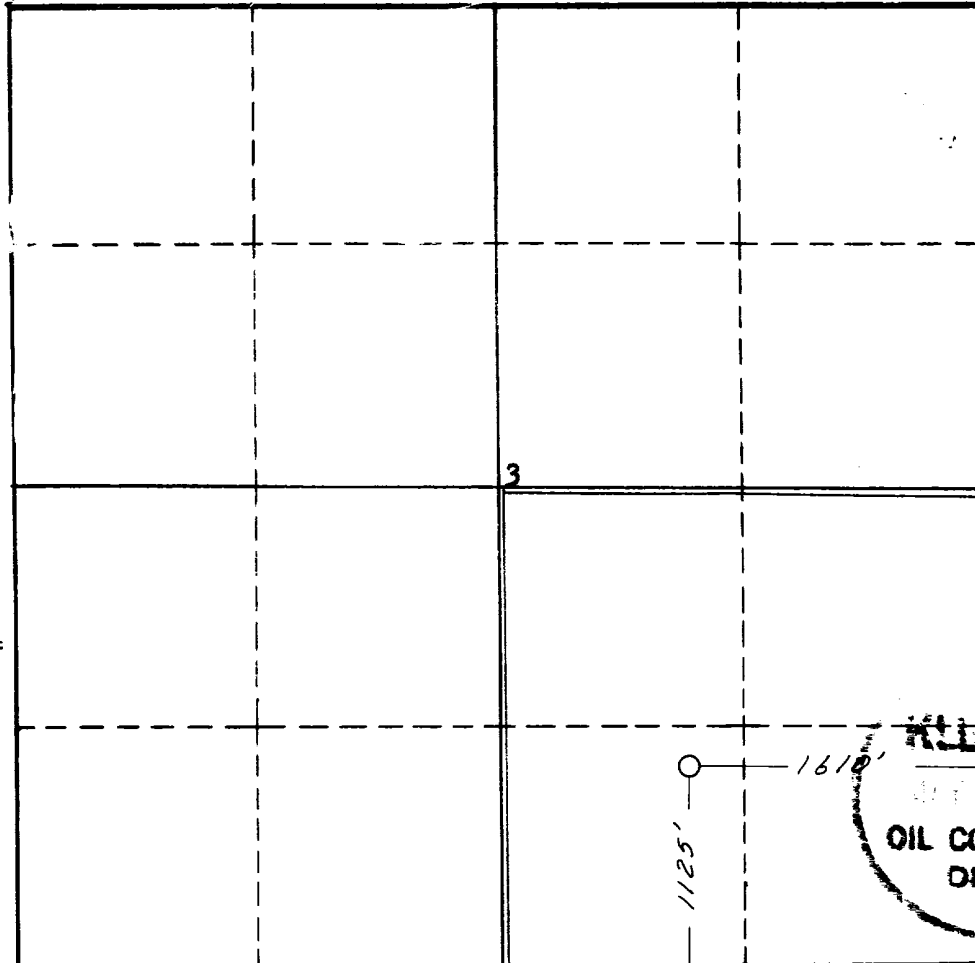

NOTE

This section of
form is to be
used for gas
wells only.



SCALE: 1"=1000'

1. Is this Well a Dual Comp. ? Yes ___ No X.
2. If the answer to Question 1 is yes, are there any other dually completed wells within the dedicated acreage? Yes ___ No ___.

Name William C. Russell,
Position President
Representing R & G DRILLING CO., INC.
Address Fox 1848, Farmington, N. M.

This is to certify that the above plat was prepared from field notes of actual surveys made by me or under my supervision and that the same are true and correct to the best of my knowledge and belief.

Date Surveyed 15 MAY 1957
James P. Leese
Registered Professional Engineer and/or
Land Surveyor James P. Leese
N. Mex. Reg. No. 1463