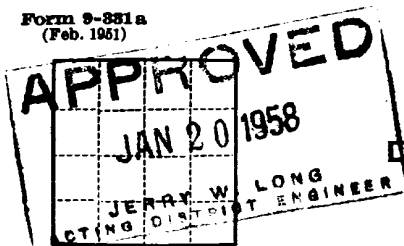

Land Office Santa Fe
Lease No. 079319
Unit Schwerdtfeger

(SUBMIT IN TRIPLICATE)

UNITED STATES
DEPARTMENT OF THE INTERIOR
GEOLOGICAL SURVEY

SUNDRY NOTICES AND REPORTS ON WELLS

NOTICE OF INTENTION TO DRILL	<input checked="" type="checkbox"/>	SUBSEQUENT REPORT OF WATER SHUT-OFF
NOTICE OF INTENTION TO CHANGE PLANS		SUBSEQUENT REPORT OF SHOOTING OR ACIDIZING
NOTICE OF INTENTION TO TEST WATER SHUT-OFF		SUBSEQUENT REPORT OF ALTERING CASING
NOTICE OF INTENTION TO RE-DRILL OR REPAIR WELL		SUBSEQUENT REPORT OF RE-DRILLING OR REPAIR
NOTICE OF INTENTION TO SHOOT OR ACIDIZE		SUBSEQUENT REPORT OF ABANDONMENT
NOTICE OF INTENTION TO PULL OR ALTER CASING		SUPPLEMENTARY WELL HISTORY
NOTICE OF INTENTION TO ABANDON WELL		

(INDICATE ABOVE BY CHECK MARK NATURE OF REPORT, NOTICE, OR OTHER DATA)

January 20, 1958

Well No. 11-A(PM) is located 1710 ft. from N line and 1601 ft. from E line of sec. 6NE Sec. 6

(1/4 Sec. and Sec. No.)

27N

(Twp.)

8W

(Range)

N.M.P.M.

(Meridian)

Blanco Ext. & So. Blanco F. C.

(Field)

San Juan

(County or Subdivision)

New Mexico

(State or Territory)

The elevation of the derrick floor above sea level is 6472 ft.

DETAILS OF WORK

(State names of and expected depths to objective sands; show sizes, weights, and lengths of proposed casings; indicate mudding jobs, cementing points, and all other important proposed work)

It is intended to drill & dual complete a well in the Pictured Cliffs formation & Mesa Verde formation. Mud circulation will be used thru the Pictured Cliffs formation & set intermediate casing. Gas circulation will be used thru the Mesa Verde & a production liner will be set. Possible productive intervals will be perforated & fractured. Estimated Total Depth 5140'.

Casing Program:

10 3/4" at 170' with 125 sacks cement circulated to the surface.

7 5/8" at 4800' with 250 sacks cement.

5 1/2" liner at 5140' with 300 sacks cement.

the E/2 of Section 6 is dedicated to the Mesa Verde.

The NE/4 of Section 6 is dedicated to the Pictured Cliffs

E/2 NE/4: 079319



I understand that this plan of work must receive approval in writing by the Geological Survey before operations may be commenced.

Company El Paso Natural Gas CompanyAddress Box 997Farmington, New MexicoBy ORIGINAL SIGNED F. W. BOYDTitle Petroleum Engineer

NEW MEXICO OIL CONSERVATION COMMISSION

Well Location and Acreage Dedication Plat

Section A.

Date **JANUARY 17, 1958**

Operator **EL PASO NATURAL GAS COMPANY** Lease **SCHWEDTFEGER** SF **079319**
 Well No. **11-A (PM)** Unit Letter **G** Section **6** Township **27-N** Range **8-W** NMPM
 Located **1710** Feet From **NORTH** Line **1601** Feet From **EAST** Line
 County **SAN JUAN** G. L. Elevation **6462** Dedicated Acreage **320.84 & 160.84** Acres
 Name of Producing Formation **MESA VERDE & PICTURED CLIFF** Pool **MV - BLANCO EXT., PC - SO BLANCO PC**

1. Is the Operator the only owner in the dedicated acreage outlined on the plat below?

Yes **X** No

2. If the answer to question one is "no", have the interests of all the owners been consolidated by communitization agreement or otherwise? Yes No If answer is "yes", Type of Consolidation.

3. If the answer to question two is "no", list all the owners and their respective interests below:

Owner

Land Description

Section B.

This is to certify that the information
 in Section A above is true and complete
 to the best of my knowledge and belief.

El Paso Natural Gas Company

J. W. Boyd
 (Representative)

Box 997

(Address)

Farmington, New Mexico

Note: All distances must be from center to center of section.

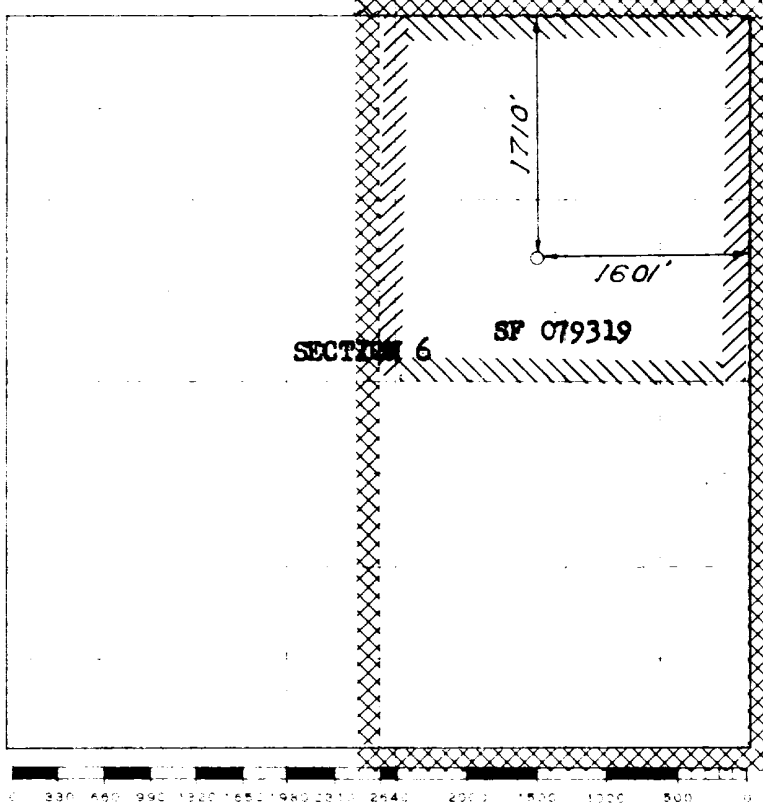

Scale 4 inches equal 1 mile



This is to certify that the above plat was prepared from field notes of actual surveys
 made by me or under my supervision and that the same are true and correct to the best
 of my knowledge and belief.

(Seal)

Date Surveyed **OCTOBER 17, 1957**

David O. Wilson
 Registered Professional Engineer and/or Land Surveyor

Farmington, New Mexico