

(SUBMIT IN TRIPLICATE)

UNITED STATES
DEPARTMENT OF THE INTERIOR
GEOLOGICAL SURVEY

Land Office Santa Fe
Lease No. 078481-A
Unit Graham

SUNDRY NOTICES AND REPORTS ON WELLS

NOTICE OF INTENTION TO DRILL.....	<input checked="" type="checkbox"/>	SUBSEQUENT REPORT OF WATER SHUT-OFF.....	
NOTICE OF INTENTION TO CHANGE PLANS.....		SUBSEQUENT REPORT OF SHOOTING OR ACIDIZING.....	
NOTICE OF INTENTION TO TEST WATER SHUT-OFF.....		SUBSEQUENT REPORT OF ALTERING CASING.....	
NOTICE OF INTENTION TO RE-DRILL OR REPAIR WELL.....		SUBSEQUENT REPORT OF RE-DRILLING OR REPAIR.....	
NOTICE OF INTENTION TO SHOOT OR ACIDIZE.....		SUBSEQUENT REPORT OF ABANDONMENT.....	
NOTICE OF INTENTION TO PULL OR ALTER CASING.....		SUPPLEMENTARY WELL HISTORY.....	
NOTICE OF INTENTION TO ABANDON WELL.....			

(INDICATE ABOVE BY CHECK MARK NATURE OF REPORT, NOTICE, OR OTHER DATA)

March 5, 1957

Well No. ~~8-33~~ #33 located 980 ft. from $\begin{Bmatrix} N \\ S \end{Bmatrix}$ line and 800 ft. from $\begin{Bmatrix} E \\ W \end{Bmatrix}$ line of sec. 4
NE/4 NE/4 Sec. 4 27N 8W N. M. P. M.
(1/4 Sec. and Sec. No.) (Twp.) (Range) (Meridian)
So Planco Pictured Cliffs San Juan New Mexico
(Field) (County or Subdivision) (State or Territory)

The elevation of the derrick floor above sea level is 5897 ft.

DETAILS OF WORK

(State names of and expected depths to objective sands; show sizes, weights, and lengths of proposed casings; indicate mudding jobs, cementing points, and all other important proposed work)

Pictured Cliffs formation to be encountered at approximately 2100'
T. D. of 2200' 150' of 8 5/8" surface with 100 sacks - 2200"
of 5 1/2" with 200 sacks - 7 7/8" hole to T. D. with perf and frac



I understand that this plan of work must receive approval in writing by the Geological Survey before operation may be commenced.

Company R & G DRILLING COMPANY, INC.

Address Box 1848

Farrington, N. M.

By [Signature]
Title President

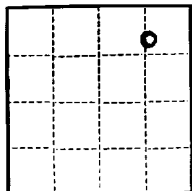

(SUBMIT IN TRIPLICATE)

UNITED STATES
DEPARTMENT OF THE INTERIOR
GEOLOGICAL SURVEY

Land Office Santa Fe
Lease No. 078481-A
Unit Graham

SUNDRY NOTICES AND REPORTS ON WELLS

NOTICE OF INTENTION TO DRILL.....	<input checked="" type="checkbox"/>	SUBSEQUENT REPORT OF WATER SHUT-OFF.....	
NOTICE OF INTENTION TO CHANGE PLANS.....		SUBSEQUENT REPORT OF SHOOTING OR ACIDIZING.....	
NOTICE OF INTENTION TO TEST WATER SHUT-OFF.....		SUBSEQUENT REPORT OF ALTERING CASING.....	
NOTICE OF INTENTION TO RE-DRILL OR REPAIR WELL.....		SUBSEQUENT REPORT OF RE-DRILLING OR REPAIR.....	
NOTICE OF INTENTION TO SHOOT OR ACIDIZE.....		SUBSEQUENT REPORT OF ABANDONMENT.....	
NOTICE OF INTENTION TO PULL OR ALTER CASING.....		SUPPLEMENTARY WELL HISTORY.....	
NOTICE OF INTENTION TO ABANDON WELL.....			

(INDICATE ABOVE BY CHECK MARK NATURE OF REPORT, NOTICE, OR OTHER DATA)

March 5, 1957

Well No. ~~8-33~~ #33 is located 980 ft. from $\left\{ \begin{smallmatrix} N \\ S \end{smallmatrix} \right\}$ line and 800 ft. from $\left\{ \begin{smallmatrix} E \\ W \end{smallmatrix} \right\}$ line of sec. 4

NE 1/4 NE 1/4 Sec. 4 27N 8W N. M. P. M.
(1/4 Sec. and Sec. No.) (Twp.) (Range) (Meridian)

So Blanco Pictured Cliffs San Juan New Mexico
(Field) (County or Subdivision) (State or Territory)

The elevation of the derrick floor above sea level is 5897 ft.

DETAILS OF WORK

(State names of and expected depths to objective sands; show sizes, weights, and lengths of proposed casings; indicate mudding jobs, cementing points, and all other important proposed work)

Pictured Cliffs formation to be encountered at approximately 2100' T. D. of 2200' 150' of 8 5/8" surface with 100 sacks - 2200' of 5 1/2" with 200 sacks - 7 7/8" hole to T. D. with perf and frac

I understand that this plan of work must receive approval in writing by the Geological Survey before operations may be commenced.

Company R & G DRILLING COMPANY, INC.

Address Box 1848

Farmington, N. M.

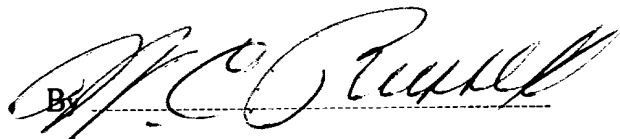
By 

Title President

NEW MEXICO
OIL CONSERVATION COMMISSION

Form C-128

Well Location and/or Gas Proration Plat

Date March 5, 1957

Operator R AND G DRILLING COMPANY

Lease Graham

Well No. ~~144~~ #33 Section 4 Township 27 NORTH Range 8 WEST, NMPM

Located 980 Feet From the NORTH Line, 800 Feet From the EAST Line,

SAN JUAN County, New Mexico. G. L. Elevation 5886.6 UNGRADED.

So Blanco

Name of Producing Formation Pictured Cliffs Pool Pic. Cliffs Dedicated Acreage ~~16.0~~

160.79

(Note: All distances must be from outer boundaries of Section)

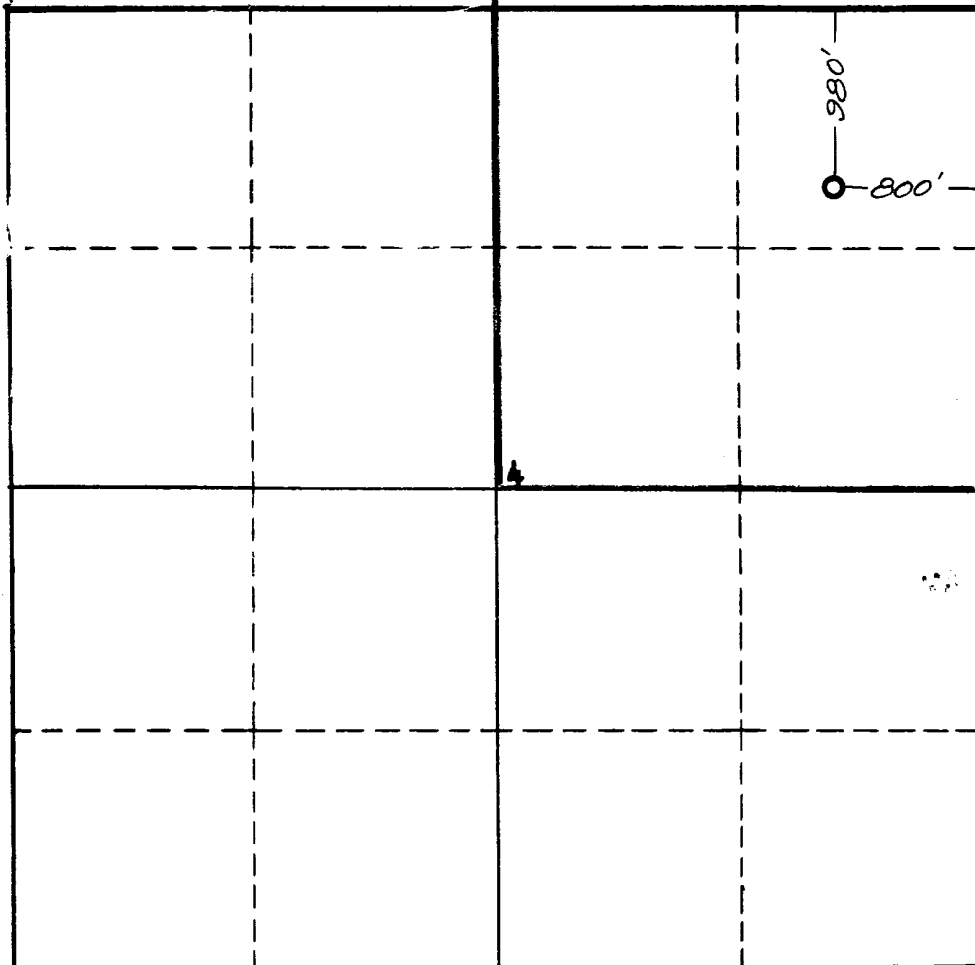

NOTE

This section of
form is to be
used for gas
wells only.



SCALE: 1"=1000'

1. Is this Well a Dual Comp. ? Yes ___ No X.
2. If the answer to Question 1 is yes, are there any other dually completed wells within the dedicated acreage? Yes ___ No ___.

Name [Signature]
Position President
Representing R & G DRILLING CO., INC.
Address Box 1848, Farmington, N. M.

This is to certify that the above plat was prepared from field notes of actual surveys made by me or under my supervision and that the same are true and correct to the best of my knowledge and belief.

Date Surveyed 28 FEBRUARY 1957

[Signature]
Registered Professional Engineer and/or
Land Surveyor James P. Leese
N. Mex. Reg. No. 1463

NEW MEXICO
OIL CONSERVATION COMMISSION

Form C-128

Well Location and/or Gas Proration Plat

Date March 5, 1957

Operator R AND G DRILLING COMPANY Lease Graham

Well No. #33 Section 4 Township 27 NORTH Range 8 WEST, NMPM

Located 980 Feet From the NORTH Line, 800 Feet From the EAST Line,

SAN JUAN County, New Mexico. G. L. Elevation 5886.6 UNGRADED.

So Planco

Name of Producing Formation Pictured Cliffs Pool Pic. Cliffs Dedicated Acreage 16 0

(Note: All distances must be from outer boundaries of Section)

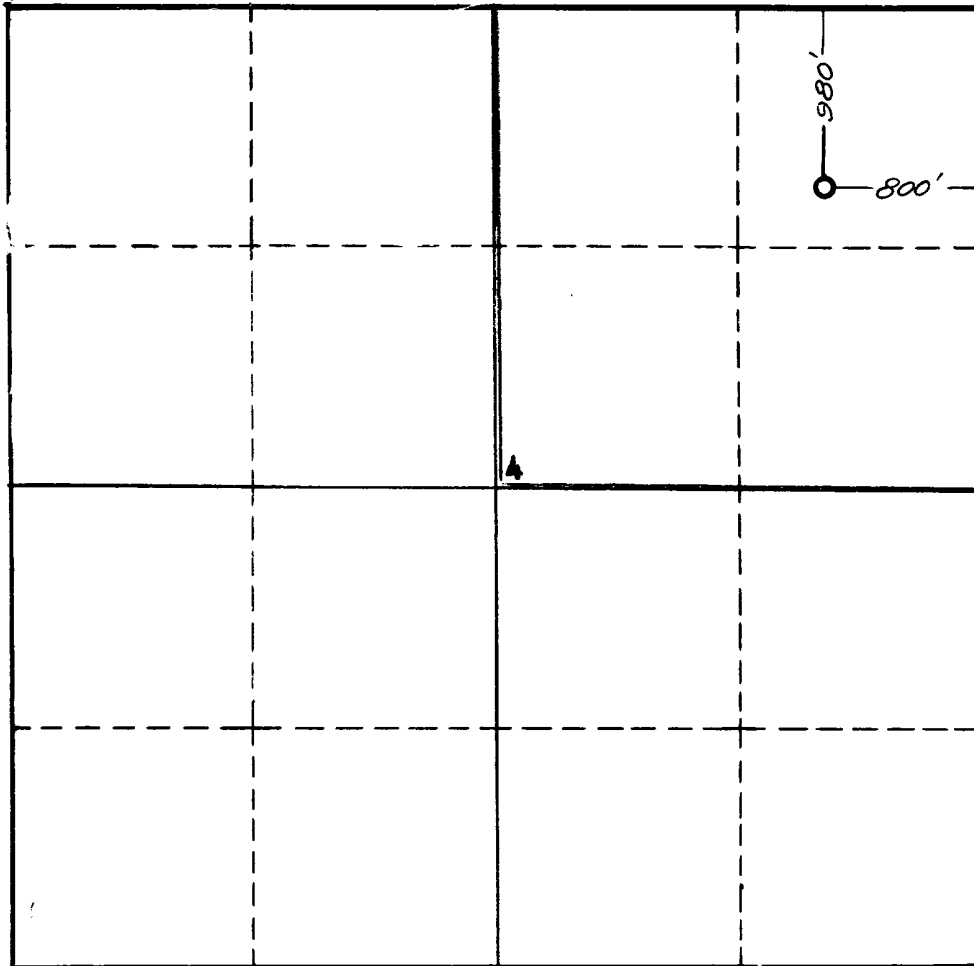

NOTE

This section of
form is to be
used for gas
wells only.



SCALE: 1"=1000'

1. Is this Well a Dual Comp. ? Yes ___ No X.
2. If the answer to Question 1 is yes, are there any other dually completed wells within the dedicated acreage? Yes ___ No ___.

Name [Signature]
Position President
Representing R & G DRILLING CO., INC.
Address Box 1848, Farmington, N. M.

This is to certify that the above plat was prepared from field notes of actual surveys made by me or under my supervision and that the same are true and correct to the best of my knowledge and belief.

Date Surveyed 28 FEBRUARY 1957
[Signature]
Registered Professional Engineer and/or
Land Surveyor James P. Leese
N. Mex. Reg. No. 1463