

(SUBMIT IN TRIPLICATE)

UNITED STATES
DEPARTMENT OF THE INTERIOR
GEOLOGICAL SURVEY

Land Office Santa Fe
Lease No. 079052
Unit Rincon Unit

SUNDRY NOTICES AND REPORTS ON WELLS

NOTICE OF INTENTION TO DRILL.....	<input checked="" type="checkbox"/>	SUBSEQUENT REPORT OF WATER SHUT-OFF.....	
NOTICE OF INTENTION TO CHANGE PLANS.....		SUBSEQUENT REPORT OF SHOOTING OR ACIDIZING.....	
NOTICE OF INTENTION TO TEST WATER SHUT-OFF.....		SUBSEQUENT REPORT OF ALTERING CASING.....	
NOTICE OF INTENTION TO RE-DRILL OR REPAIR WELL.....		SUBSEQUENT REPORT OF RE-DRILLING OR REPAIR.....	
NOTICE OF INTENTION TO SHOOT OR ACIDIZE.....		SUBSEQUENT REPORT OF ABANDONMENT.....	
NOTICE OF INTENTION TO PULL OR ALTER CASING.....		SUPPLEMENTARY WELL HISTORY.....	
NOTICE OF INTENTION TO ABANDON WELL.....			

(INDICATE ABOVE BY CHECK MARK NATURE OF REPORT, NOTICE, OR OTHER DATA)

March 19, 1956

Well No. 106 is located 800 ft. from SW line and 1683 ft. from E line of sec. 10
SE Sec. 18 27N 6W N.M.P.M.
($\frac{1}{4}$ Sec. and Sec. No.) (Twp.) (Range) (Meridian)
So. Blanco Ext. Rio Arriba New Mexico
(Field) (County or Subdivision) (State or Territory)

The elevation of the derrick floor above sea level is 6631 ft.

DETAILS OF WORK

(State names of and expected depths to objective sands; show sizes, weights, and lengths of proposed casings; indicate mudding jobs, cementing points, and all other important proposed work)

It is intended to drill a well thru the Pictured Cliff formation using rotary tools and to perforate and water fracture possible producing zones. E t. T. D. 3307'.

Casing Program:

8 5/8" at 120' with 125 sacks regular cement circulated to surface.
5 1/2" at 3307' with 75 sacks regular cement, 75 sacks Pozmix.

The SE/4 of Section 18 is dedicated to this well.

SE/4: SP 079052

I understand that this plan of work must receive approval in writing by the Geological Survey before operations may be commenced.

Company El Paso Natural Gas Company

Address Box 997

Farmington, New Mexico

By Original Signed D. C. Johnston

Title Petroleum Engineer



NEW MEXICO OIL CONSERVATION COMMISSION

Well Location and Acreage Declaration Form

Section A.

Date **MARCH 17, 1958**

Operator **EL PASO NATURAL GAS COMPANY** Lease **RINCON** SF **079052**
 Well No. **106** Unit Letter **0** Section **18** Township **27-N** Range **6-W** NMPM
 Located **800** Feet From **SOUTH** Line **1683** Town From **EAST** Line
 County **RIO ARriba** G. L. Elevation **6621** Section Acreage **160** Acres
 Name of Producing Formation **PICTURED CLIFF** Part **SOUTH BLANCO PICTURED CLIFF EXT.**

1. Is the Operator the only owner in the dedicated acreage owned in the following?
 Yes ☒ No ☐
2. If the answer to question one is "no", have the interests of all the owners been consolidated by some organization agreement or otherwise? Yes ☐ No ☐ If answer is "No", Type of Consolidation:
3. If the answer to question two is "no", list all the owners and their respective interest in the following:
- | Owner | Land Description |
|-------|------------------|
| | |

Section B.

This is to certify that the information in Section A above is true and complete to the best of my knowledge and belief.

El Paso Natural Gas Company
 (Operator)
Original Signed D. C. Johnston
 (Representative)
Box 997
 (Address)
Farmington, New Mexico

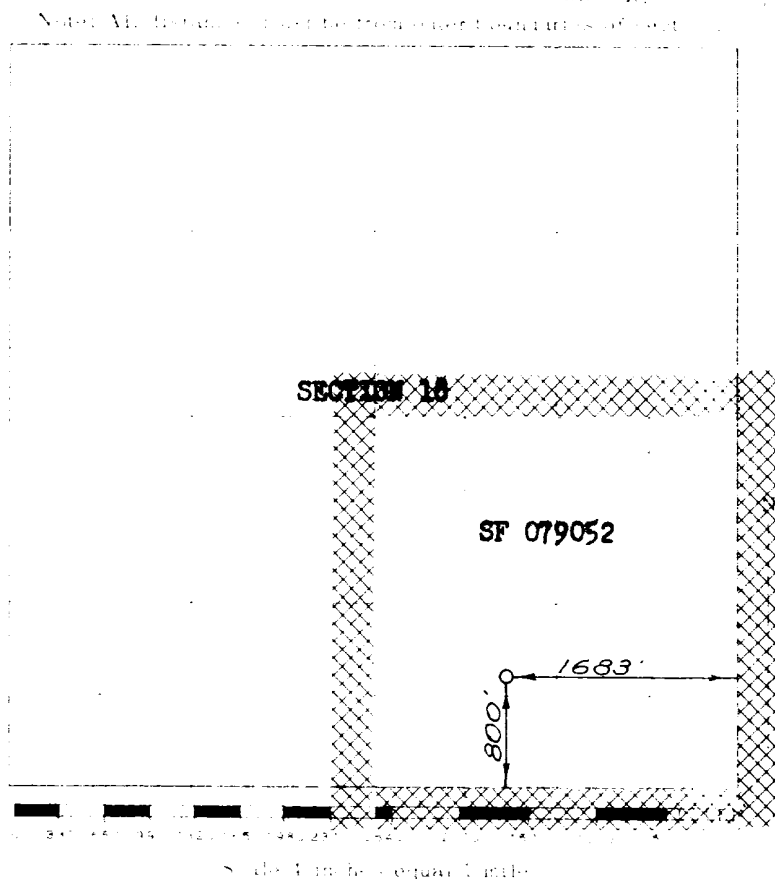

This is to certify that the above information was prepared from field notes and other surveys made by me or under my direct supervision and that the same are true and correct to the best of my knowledge and belief.

(Seal)

Farmington, New Mexico

Date Surveyed **MARCH 7, 1958**

David A. Kilwein
 Registered Professional Engineer and Oil Surveyor