

(SUBMIT IN TRIPLICATE)

UNITED STATES
DEPARTMENT OF THE INTERIOR
GEOLOGICAL SURVEY

Budget Bureau No. 42-R358.4
Approval expires 12-31-60.

Land Office Santa Fe
Lease No. 078569
Unit San Juan 28-7 Unit
14-00-001-459

SUNDRY NOTICES AND REPORTS ON WELLS

NOTICE OF INTENTION TO DRILL	<input checked="" type="checkbox"/>	SUBSEQUENT REPORT OF WATER SHUT-OFF	
NOTICE OF INTENTION TO CHANGE PLANS		SUBSEQUENT REPORT OF SHOOTING OR ACIDIZING	
NOTICE OF INTENTION TO TEST WATER SHUT-OFF		SUBSEQUENT REPORT OF ALTERING CASING	
NOTICE OF INTENTION TO RE-DRILL OR REPAIR WELL		SUBSEQUENT REPORT OF RE-DRILLING OR REPAIR	
NOTICE OF INTENTION TO SHOOT OR ACIDIZE		SUBSEQUENT REPORT OF ABANDONMENT	
NOTICE OF INTENTION TO PULL OR ALTER CASING		SUPPLEMENTARY WELL HISTORY	
NOTICE OF INTENTION TO ABANDON WELL			

(INDICATE ABOVE BY CHECK MARK NATURE OF REPORT, NOTICE, OR OTHER DATA)

May 10, 1950

Well No. 87 is located 1475 ft. from N line and 1190 ft. from W line of sec. 8
SW Sec. 8 (1/4 Sec. and Sec. No.)
Blanco (Field)
27N (Twp.) 7E (Range) N.M.P.M. (Meridian)
Rio Arriba (County or Subdivision) New Mexico (State or Territory)

The elevation of the derrick floor above sea level is 6656 ft.

DETAILS OF WORK

(State names of and expected depths to objective sands; show sizes, weights, and lengths of proposed casings; indicate mudding jobs, cementing points, and all other important proposed work)

It is intended to drill a well with rotary tools thru the Mesa Verde formation. Mud circulation will be used thru the Pictured Cliffs and set intermediate casing. Gas circulation will be used thru the Mesa Verde and production liner will be set. Possible productive intervals will be perforated and fractured. Est. T. D. 5539'.

Casing Program:

10 3/4" at 170' with 150 sacks cement circulated to the surface.
7 5/8" at 3284' with 250 sacks cement.
5 1/2" liner at 5539' with 300 sacks cement.

The W/2 of Section 8 is dedicated to this well.
W/2: SE 078565 (NW/4); SE 078569 (SW/4)

I understand that this plan of work must receive approval in writing by the Geological Survey before operations may be commenced.

Company El Paso Natural Gas Company

Address Box 957

Farmington, New Mexico

By ORIGINAL SIGNED E. S. OBEPLY

Title Petroleum Engineer

Well Location and Acreage Dedication Plat

Section A.

Date **JANUARY 27, 1958**

Operator **EL PASO NATURAL GAS COMPANY** Lease **SAN JUAN 28-7 UNIT** SF **078569**
 Well No. **87** Unit Letter **L** Section **8** Township **27 N** Range **7 W** NMPM
 Located **1475** Feet From **SOUTH** Line **1190** Feet From **WEST** Line
 County **RIO ARriba** G. L. Elevation **6646** Dedicated Acreage **320** Acres
 Name of Producing Formation **MESA VERDE** Pool **BLANCO**

1. Is the Operator the only owner in the dedicated acreage outlined on the plat below?
 Yes ☒ No ☐
2. If the answer to question one is "no", have the interests of all the owners been consolidated by communitization agreement or otherwise? Yes ☐ No ☐ If answer is "yes", Type of Consolidation, _____
3. If the answer to question two is "no", list all the owners and their respective interests below:

Owner

Land Description

RECEIVED**MAY 14 1958**U. S. GEOLOGICAL SURVEY
FARMINGTON, NEW MEXICO

Section B.

This is to certify that the information in Section A above is true and complete to the best of my knowledge and belief.

El Paso Natural Gas Company
ORIGINAL SIGNED E. S. OBERLY

(Representative)

Box 997

(Address)

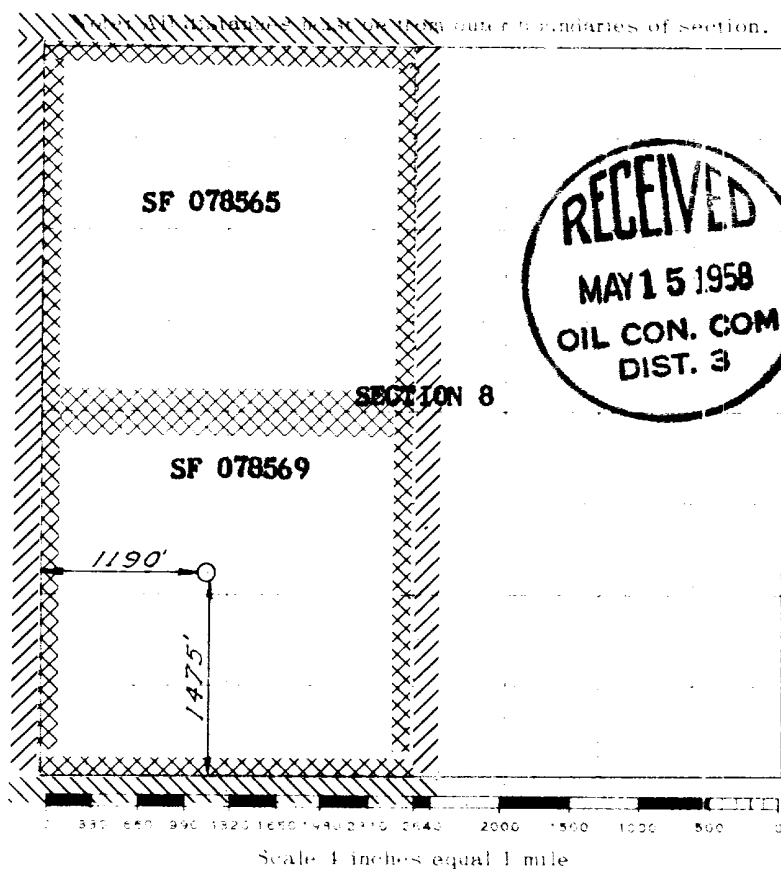
Farmington, New Mexico

Scale: 1 inch equals 1 mile

This is to certify that the above plat was prepared from field notes of actual surveys made by me or under my supervision and that the same are true and correct to the best of my knowledge and belief.

(Seal)

Date Surveyed

OCTOBER 17, 1957

Farmington, New Mexico

David A. Kibben
 Registered Professional Engineer and/or Land Surveyor