

UNITED STATES
DEPARTMENT OF THE INTERIOR
GEOLOGICAL SURVEY

APPLICATION FOR PERMIT TO DRILL, DEEPEN, OR PLUG BACK

1a. TYPE OF WORK

DRILL ☒DEEPEN ☐PLUG BACK ☐

b. TYPE OF WELL

OIL ☐GAS ☐WELL ☒OTHER ☐SINGLE ☐MULTIPLE ☒

2. NAME OF OPERATOR

Sinclair Oil & Gas Company

3. ADDRESS OF OPERATOR

501 Lincoln Tower Bldg., 1860 Lincoln St., Denver, Colorado

4. LOCATION OF WELL (Report location clearly and in accordance with any State requirements.)

At surface

1000' s/ south line and 1790' s/ south line Section 4-27N-8W
At proposed prod. zone

14. DISTANCE IN MILES AND DIRECTION FROM NEAREST TOWN OR POST OFFICE*

15. DISTANCE FROM PROPOSED*

LOCATION TO NEAREST
PROPERTY OR LEASE LINE, FT.
(Also to nearest drilg. unit line, if any.)Approx 350' s/ EL of
orig unit.

18. DISTANCE FROM PROPOSED LOCATION*

TO NEAREST WELL, DRILLING, COMPLETED,
OR APPLIED FOR, ON THIS LEASE, FT.Approx 3675'
N 2/2

21. ELEVATIONS (Show whether D.F., RT., GR., etc.)

Will advise

16. NO. OF ACRES IN LEASE

1120

19. PROPOSED DEPTH

7300'

17. NO. OF ACRES ASSIGNED
TO THIS WELL

380 both formations

20. ROTARY OR CABLE TOOLS

Rotary

22. APPROX. DATE WORK WILL START*

When app'l rec'd.

23. PROPOSED CASING AND CEMENTING PROGRAM

SIZE OF HOLE	SIZE OF CASING	WEIGHT PER FOOT	SETTING DEPTH	QUANTITY OF CEMENT
12-1/4"	8-5/8"	24	350'	300 cu (Out bottoms to top).
7-7/8"	1 1/2 or 5/8"	-	Total depth	900 cu

Drilling Unit - W/2 Section 4.

It is proposed to drill this well with rotary tools to a depth sufficient to test the Dakota formation. 8-5/8" casing will be set at approx. 350' and cemented bottom to top. 7-7/8" hole will be drilled to approx 7300' and well logged. If productive in both Mesaverde and Dakota, 5-1/2" OD casing will be set and cemented with sufficient cement to protect all zones. Productive zones will be perforated, treated if necessary, and completion equipment installed, and well finally completed in the Mesaverde and Dakota.

Anticipated top of Mesaverde - 5175'
" " " Dakota - 7175'

Sinclair Oil & Gas Company is only owner.

New Mexico Oil Conservation Commission, Form C-102, Well location and Acreage
Dedication Plat will be forwarded.

IN ABOVE SPACE DESCRIBE PROPOSED PROGRAM: If proposal is to deepen or plug back, give data on present productive zone and proposed new productive zone. If proposal is to drill or deepen directionally, give pertinent data on subsurface locations and measured and true vertical depths. Give blowout preventer program, if any.

24.

SIGNED

TITLE Chief Office Clerk

DATE March 15, 1966

(This space for Federal or State office use)

PERMIT NO.

APPROVAL DATE

APPROVED BY

TITLE

DATE

CONDITIONS OF APPROVAL, IF ANY:

*See Instructions On Reverse Side

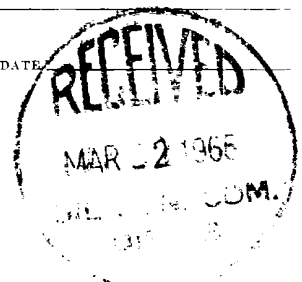

NEW MEXICO OIL CONSERVATION COMMISSION
WELL LOCATION AND ACREAGE DEDICATION PLAT

Form C-102
Supersedes C-128
Effective 1-1-65

All distances must be from the outer boundaries of the Section.

Operator Sinclair Oil & Gas Company			Lease Hugh J. Graham B 101 Redwood		Well No. 5
Unit Letter N	Section 4	Township 27 North	Range 8 West	County San Juan	
Actual Footage Location of Well: 1000 feet from the South line and 1790 feet from the West line					
Ground Level Elev. 6735	Producing Formation Del Norte and Mancos		Pool Del Norte and Mancos	Dedicated Acreage 3.00	Acres

1. Outline the acreage dedicated to the subject well by colored pencil or hachure marks on the plat below.
2. If more than one lease is dedicated to the well, outline each and identify the ownership thereof (both as to working interest and royalty).
3. If more than one lease of different ownership is dedicated to the well, have the interests of all owners been consolidated by communitization, unitization, force-pooling, etc?

☐ Yes ☐ No If answer is "yes," type of consolidation

Sinclair is only owner.

MAR 22 1966

If answer is "no," list the owners and tract descriptions which have actually been consolidated. (Use reverse side of this form if necessary.)

U. S. GEOLOGICAL SURVEY
FARMINGTON, N. M.

No allowable will be assigned to the well until all interests have been consolidated (by communitization, unitization, forced-pooling, or otherwise) or until a non-standard unit, eliminating such interests, has been approved by the Commission.

CERTIFICATION

I hereby certify that the information contained herein is true and complete to the best of my knowledge and belief.

Name
M. E. Brauer
Position
Chief Office Clerk
Company
Sinclair Oil & Gas Company
Date
March 13, 1966

I hereby certify that the well location shown on this plat was plotted from field notes of actual surveys made by me or under my supervision, and that the same is true and correct to the best of my knowledge and belief.

Date Surveyed
March 13, 1966
Registered Professional Engineer
and/or Land Surveyor

C. J. Cochran
Certificate No. **3602**

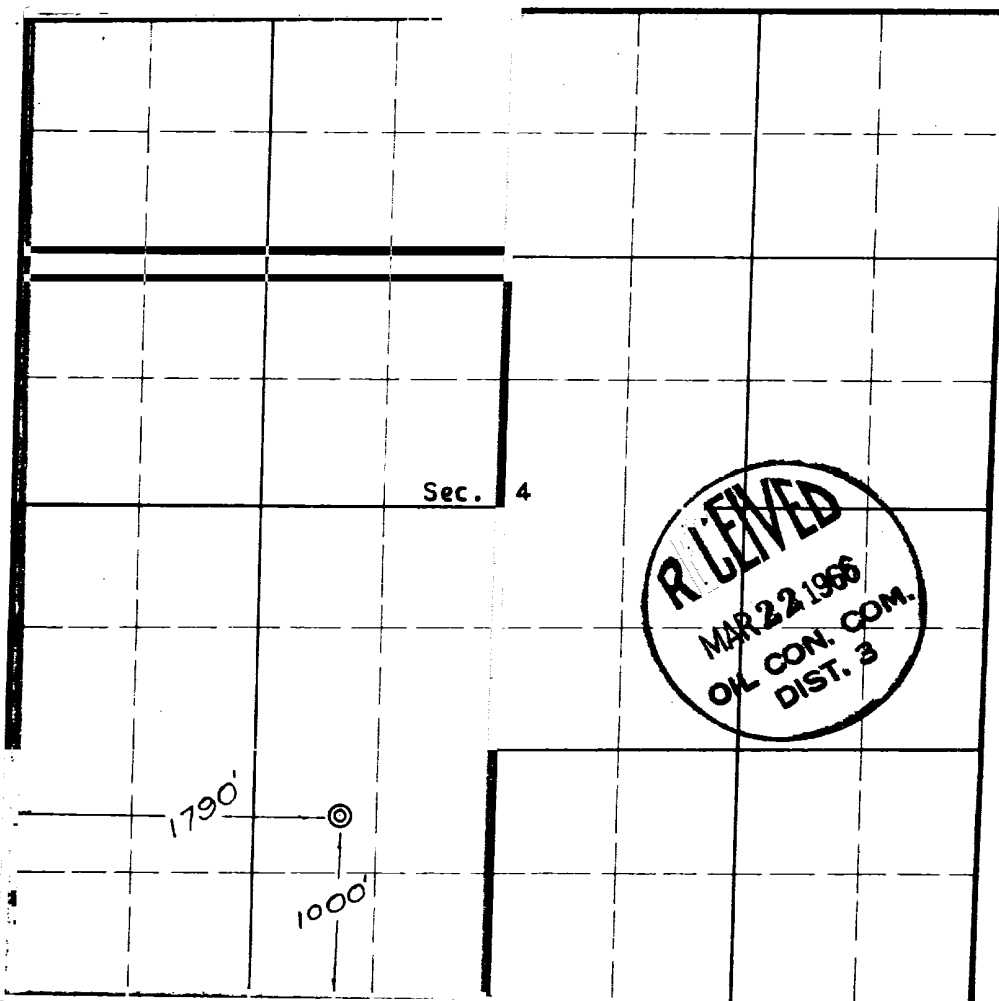

Resurveyed section-USBLM

Scale, 1" = 1000'