

AD-AL
E.



STATE OF NEW MEXICO
ENERGY, MINERALS AND NATURAL RESOURCES DEPARTMENT
OIL CONSERVATION DIVISION
2040 S. PACHECO
SANTA FE, NEW MEXICO 87505
(505) 827-7131

ADMINISTRATIVE ORDER DHC-1116

Amoco Production Company
P.O. Box 800
Denver, Colorado 80201

Attention: Pamela W. Stanley

Schwerdtfeger #1
changed

3M

RECEIVED
APR - 6 1995

OIL CONSERVATION DIVISION

Schwerdtfeger Well No. A-3

*Unit D, Section 6, Township 27 North, Range 8 West, NMPM,
San Juan County, New Mexico.*

Basin Dakota (Prorated Gas) and Blanco Mesaverde (Prorated Gas) Pools

Dear Ms. Stanley:

Reference is made to your recent application for an exception to Rule 303-A of the Division Rules and Regulations to permit the subject well to commingle production from both pools in the wellbore.

It appearing that the subject well qualifies for approval for such exception pursuant to the provisions of Rule 303-C, and that reservoir damage or waste will not result from such downhole commingling, and correlative rights will not be violated thereby, you are hereby authorized to commingle the production as described above and any Division Order which authorized the dual completion and required separation of the two zones is hereby placed in abeyance.

In accordance with the provisions of Rule 303-C-4., total commingled oil production from the subject well shall not exceed 30 barrels per day, and total water production shall not exceed 60 barrels per day. The maximum amount of gas which may be produced daily from the well shall be determined by Division Rules and Regulations or by the gas allowable for each respective prorated pool as printed in the Division's San Juan Basin Gas Proration Schedule.

In accordance with the provisions of Rule 303-C, the supervisor of the Aztec District Office of the Oil Conservation Division shall determine the proper allocation of production from the subject well following its completion.

FURTHER: The operator shall notify the Aztec District Office of the Division upon implementation of the commingling process.

Pursuant to Rule 303-C-5, the commingling authority granted by the order may be rescinded by the Division Director if, in his opinion, conservation is not being best served by such commingling.

Approved at Santa Fe, New Mexico on this 4th day of April, 1995.

STATE OF NEW MEXICO
OIL CONSERVATION DIVISION

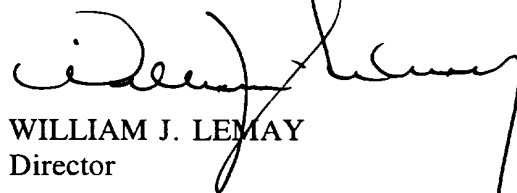

WILLIAM J. LEMAY
Director

S E A L

WJL/BES

cc: Oil Conservation Division - Aztec ✓

Ernie Busch

From: Ernie Busch
To: David Catanach
Subject: AMOCO (DHC)
Date: Tuesday, March 28, 1995 7:08AM
Priority: High

SCHWERDTFEGER A #3

D-06-27N08W

RECOMMEND: SET FOR HEARING OR SUPPLY DATA FOR MESAVERDE EXPECTED RATES. NOT
ENOUGH INFORMATION TO MAKE ADMINISTRATIVE DETERMINATION.



Southern

Rockies

Business

Unit

March 13, 1995

Mr. William J. LeMay, Director
New Mexico Oil Conservation Division
2040 S. Pacheco Street
P. O. Box 6429
Santa Fe, NM 87504

**Application for Exception to Rule 303-A
Downhole Commingling
Schwerdtfeger A 3 Well
815' FWL, 885' FNL, Section 6-T27N-R8W
Blanco Mesaverde and Basin Dakota Pools
San Juan County, New Mexico**

RECEIVED
MAR 16 1995
OIL CON. DIV.
DIST. 3

Amoco Production Company hereby requests administrative approval to downhole commingle production from the Blanco Mesaverde and Basin Dakota Pools in the Schwerdtfeger A 3 well referenced above. The Schwerdtfeger A 3 well was originally completed in the Dakota formation. We plan to recompleate the well to the Mesaverde with both zones open in the wellbore. The two zones are expected to produce at a total commingled rate of about 500 MCFD. The ownership (WI, RI, ORRI) of these pools is identical in this wellbore. Downhole commingling will offer an economical method of production while protecting against reservoir damage, waste of reserves and violation of correlative rights. Offset operators to this well will receive a copy of this application by certified mail.

The allocation method that we plan to use for this commingled well is as follows. We plan to determine the stabilized rate from the Dakota formation prior to the recompletion of the Mesaverde. After recompletion of the Mesaverde formation, we will allow the production to stabilize to a rate from the Mesaverde and Dakota commingled zones. The allocation percentages would then be fixed at the Dakota stabilized rate as a percentage of the total stabilized rate. Once these rates have been establised we will notify your Aztec District.

Should you have questions concerning this matter, please contact me at (303) 830-5344.

Sincerely,

Pamela W. Staley

Enclosures

cc: Wayne Branam
Lara Kwartin

Frank Chavez, Supervisor
Amoco District III
1000 Rio Brazos Road
Aztec, NM 87410

Robert Kent
Bureau of Land Management
435 Montano NE
Albuquerque, NM 87107

13,303,098.40 FT. N
36° 37' 33" N

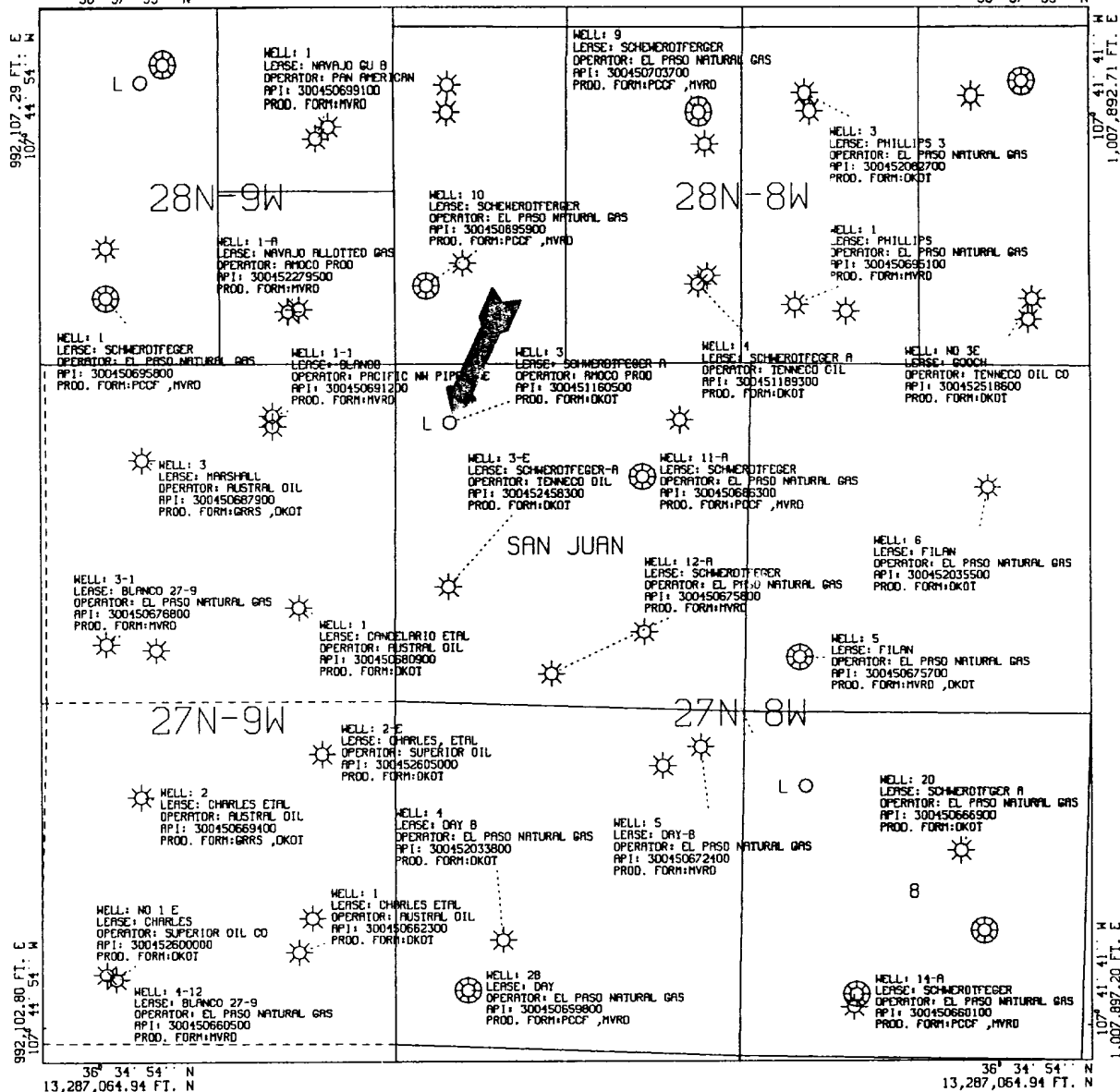

All geological and geophysical data, including the interpretation thereof, appearing on this map is the private and confidential property of Amoco Production Company. The publication or reproduction thereof without the written permission of said Company is strictly prohibited.

AMOCO PRODUCTION COMPANY
PLAT MAP

SCHWERTFEGER A 3 WITH
DK AND MV OFFSETS
SCALE 1 IN. = 2,000 FT. JAN 28, 1995

HORIZONTAL DATUM NAD27

POLYCONIC CENTRAL MERIDIAN - 107° 43' 17" W LON
SPHEROID - 6

RR028AA--RUN#95028154957

OFFSET WELL PRESSURES AND API GRAVITY INFORMATION

WELLNAME	DK PRESSURE	MV PRESSURE	API GRAVITY
Schwerdtfeger A 3	320 TP	----	51.4
Schwerdtfeger A LS 11	----	267 TP	57.4
Schwerdtfeger A LS 12	----	241 TP	59.7

Engr: zr06

SCHWERDTFEGGER A 3

Operator - AMOCO PRODUCTION CO

300451160500DK

D062708-003 DK

APC_WI - 0.50000000

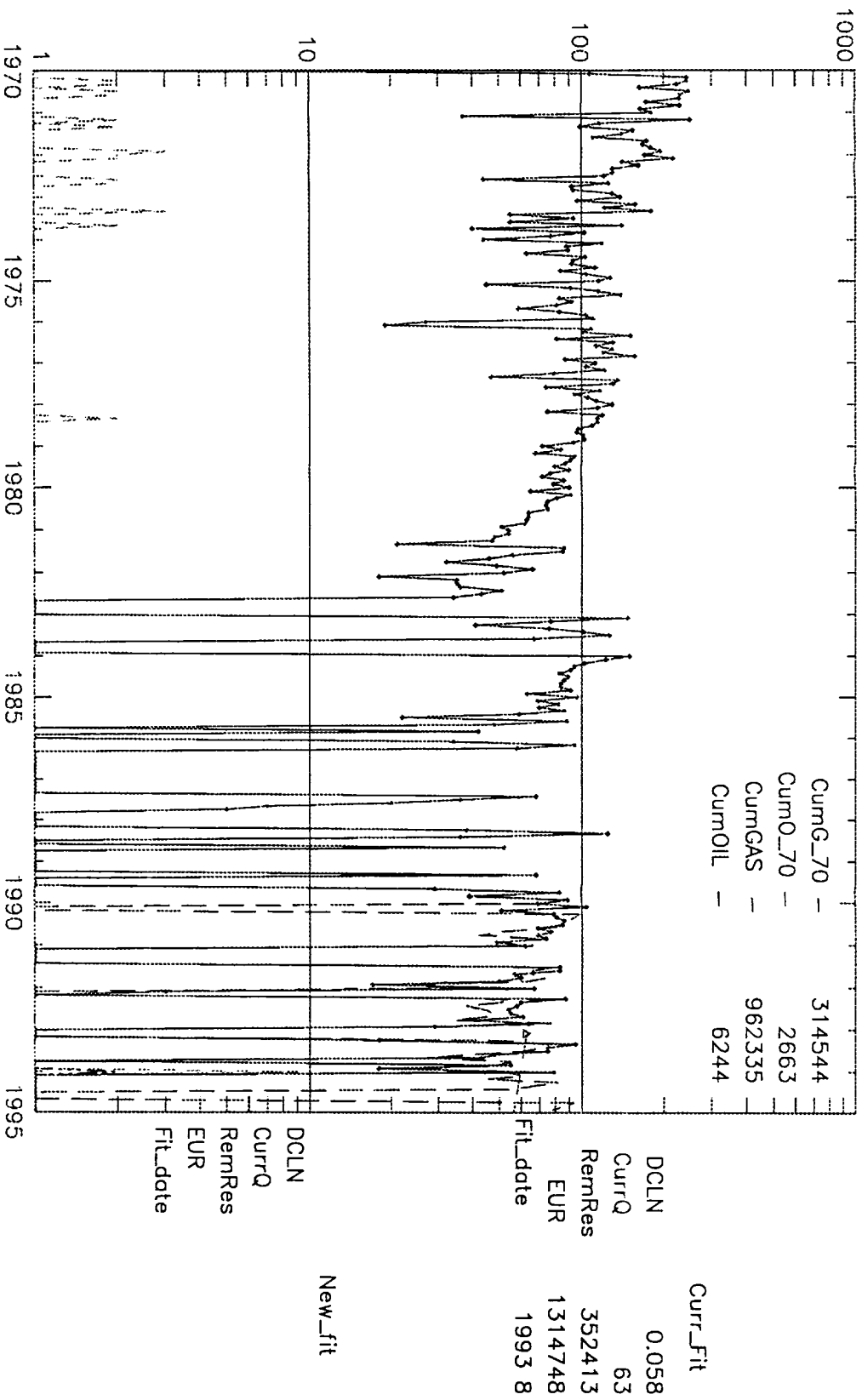

Amoco Production Company
Offset Operator Plat
Schwerdtfeger LS-12
T27N-R8W, Section 6
2350'FWL & 500'FSL
Blanco Mesaverde Formation

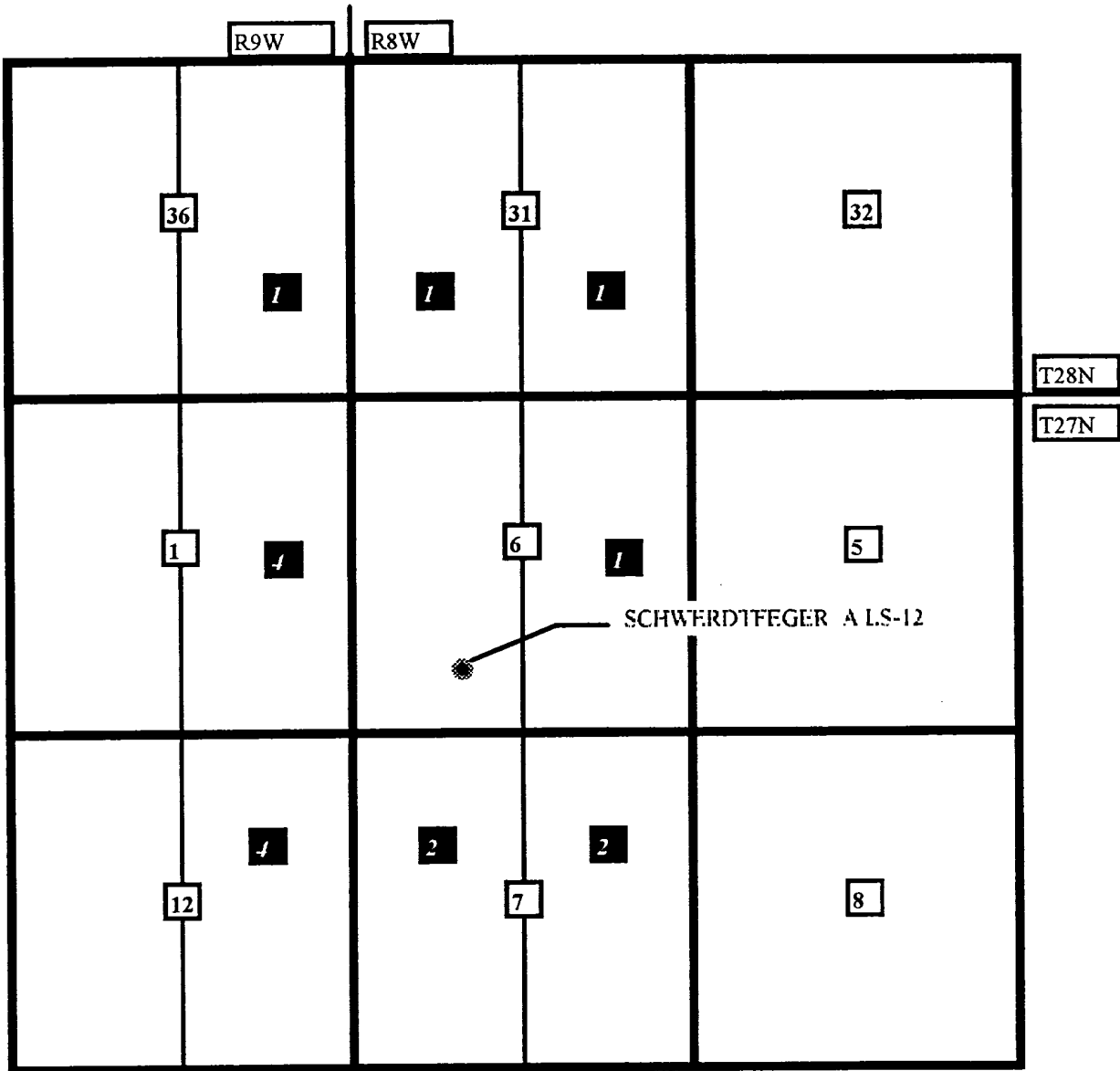

A 3x3 grid map of the Schwerdtfeger A-3 area. The grid is divided into nine 2x2 blocks. The top row is labeled R9W and R8W. The right side is labeled T28N and T27N. The grid contains various numbers in white and black boxes, and a central point labeled SCHWERDTFEGER A-3. The numbers are: Top-left (1, 36), Top-middle (1, 31), Top-right (32), Middle-left (1, 3), Middle-middle (6, 1), Middle-right (5), Bottom-left (12, 3), Bottom-middle (7, 2), Bottom-right (8).

NEW MEXICO OIL CONSERVATION COMMISSION
WELL LOCATION AND ACREAGE DEDICATION PLAT

Form O-112
Supersedes O-128
Effective 1-1-61

All distances must be from the outer boundaries of the Section.

Operator TENNECO OIL COMPANY		Lease SCHWERTFEGER "A"		Well No. 3
Tract Letter D	Section 6	Township 27 North	Range 8 West	County San Juan
Actual Footage Location of Well: 885 feet from the North line and 815 feet from the West line				
Ground Level Elev. 5902' ungraded	Producing Formation Basin Dakota	Pool Dakota	Dedicated Acreage: 30.68 320 Acres	

1. Outline the acreage dedicated to the subject well by colored pencil or hachure marks on the plat below.
2. If more than one lease is dedicated to the well, outline each and identify the ownership thereof (both as to working interest and royalty).
3. If more than one lease of different ownership is dedicated to the well, have the interests of all owners been consolidated by communitization, unitization, force-pooling, etc?

☐ Yes ☐ No If answer is "yes," type of consolidation _____

If answer is "no," list the owners and tract descriptions which have actually been consolidated. (Use reverse side of this form if necessary.) _____

No allowable will be assigned to the well until all interests have been consolidated (by communitization, unitization, forced-pooling, or otherwise) or until a non-standard unit, eliminating such interests, has been approved by the Commission.

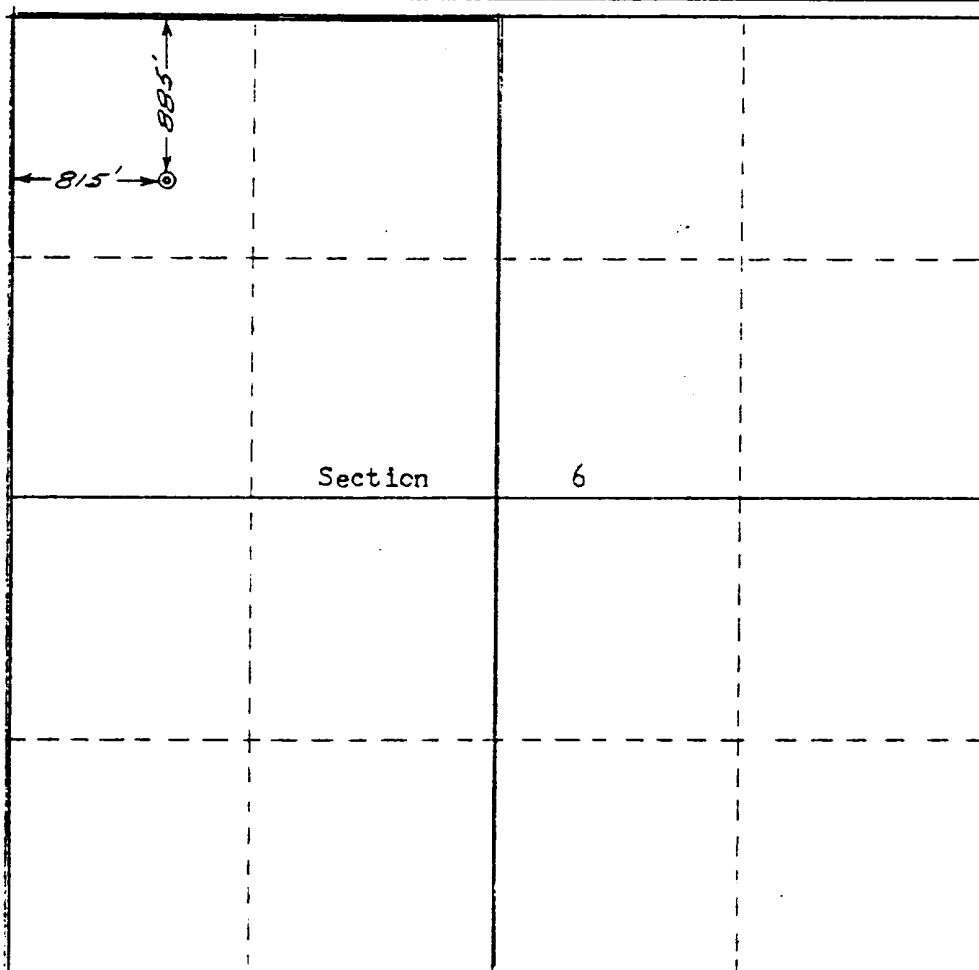

CERTIFICATION

I hereby certify that the information contained herein is true and complete to the best of my knowledge and belief.

Harold C. Nichols

Name **Harold C. Nichols**
Position **Senior Production Clerk**

Company **Tenneco Oil Company**

Date **P. O. Box 1714, Durango, Color**

October 25, 1965

I hereby certify that the well location shown on this plat was plotted from field notes of actual surveys made by me or under my supervision, and that the same is true and correct to the best of my knowledge and belief.

Date Surveyed

8 October 1965

Registered Professional Engineer and/or Land Surveyor

Robert H. Ernst
ROBERT H. ERNST

Certificate No.

N. Mex. PE & LS 2463

100 500 900 1320 1650 1980 2310 2640 2970 3300 3630 3960 4290 4620 4950 5280 5610 5940 6270 6600 6930 7260 7590 7920 8250 8580 8910 9240 9570 9900 10230 10560 10890 11220 11550 11880 12210 12540 12870 13200 13530 13860 14190 14520 14850 15180 15510 15840 16170 16500 16830 17160 17490 17820 18150 18480 18810 19140 19470 19800 20130 20460 20790 21120 21450 21780 22110 22440 22770 23100 23430 23760 24090 24420 24750 25080 25410 25740 26070 26400 26730 27060 27390 27720 28050 28380 28710 29040 29370 29700 30030 30360 30690 31020 31350 31680 32010 32340 32670 33000 33330 33660 33990 34320 34650 34980 35310 35640 35970 36300 36630 36960 37290 37620 37950 38280 38610 38940 39270 39600 39930 40260 40590 40920 41250 41580 41910 42240 42570 42900 43230 43560 43890 44220 44550 44880 45210 45540 45870 46200 46530 46860 47190 47520 47850 48180 48510 48840 49170 49500 49830 50160 50490 50820 51150 51480 51810 52140 52470 52800 53130 53460 53790 54120 54450 54780 55110 55440 55770 56100 56430 56760 57090 57420 57750 58080 58410 58740 59070 59400 59730 60060 60390 60720 61050 61380 61710 62040 62370 62700 63030 63360 63690 64020 64350 64680 65010 65340 65670 66000 66330 66660 66990 67320 67650 67980 68310 68640 68970 69300 69630 69960 70290 70620 70950 71280 71610 71940 72270 72600 72930 73260 73590 73920 74250 74580 74910 75240 75570 75900 76230 76560 76890 77220 77550 77880 78210 78540 78870 79200 79530 79860 80190 80520 80850 81180 81510 81840 82170 82500 82830 83160 83490 83820 84150 84480 84810 85140 85470 85800 86130 86460 86790 87120 87450 87780 88110 88440 88770 89100 89430 89760 90090 90420 90750 91080 91410 91740 92070 92400 92730 93060 93390 93720 94050 94380 94710 95040 95370 95700 96030 96360 96690 97020 97350 97680 98010 98340 98670 99000 99330 99660 99990 100320 100650 100980 101310 101640 101970 102300 102630 102960 103290 103620 103950 104280 104610 104940 105270 105600 105930 106260 106590 106920 107250 107580 107910 108240 108570 108900 109230 109560 109890 110220 110550 110880 111210 111540 111870 112200 112530 112860 113190 113520 113850 114180 114510 114840 115170 115500 115830 116160 116490 116820 117150 117480 117810 118140 118470 118800 119130 119460 119790 120120 120450 120780 121110 121440 121770 122100 122430 122760 123090 123420 123750 124080 124410 124740 125070 125400 125730 126060 126390 126720 127050 127380 127710 128040 128370 128700 129030 129360 129690 130020 130350 130680 131010 131340 131670 132000 132330 132660 132990 133320 133650 133980 134310 134640 134970 135300 135630 135960 136290 136620 136950 137280 137610 137940 138270 138600 138930 139260 139590 139920 140250 140580 140910 141240 141570 141900 142230 142560 142890 143220 143550 143880 144210 144540 144870 145200 145530 145860 146190 146520 146850 147180 147510 147840 148170 148500 148830 149160 149490 149820 150150 150480 150810 151140 151470 151800 152130 152460 152790 153120 153450 153780 154110 154440 154770 155100 155430 155760 156090 156420 156750 157080 157410 157740 158070 158400 158730 159060 159390 159720 160050 160380 160710 161040 161370 161700 162030 162360 162690 163020 163350 163680 164010 164340 164670 165000 165330 165660 165990 166320 166650 166980 167310 167640 167970 168300 168630 168960 169290 169620 169950 170280 170610 170940 171270 171600 171930 172260 172590 172920 173250 173580 173910 174240 174570 174900 175230 175560 175890 176220 176550 176880 177210 177540 177870 178200 178530 178860 179190 179520 179850 180180 180510 180840 181170 181500 181830 182160 182490 182820 183150 183480 183810 184140 184470 184800 185130 185460 185790 186120 186450 186780 187110 187440 187770 188100 188430 188760 189090 189420 189750 190080 190410 190740 191070 191400 191730 192060 192390 192720 193050 193380 193710 194040 194370 194700 195030 195360 195690 196020 196350 196680 197010 197340 197670 198000 198330 198660 198990 199320 199650 199980 200310 200640 200970 201300 201630 201960 202290 202620 202950 203280 203610 203940 204270 204600 204930 205260 205590 205920 206250 206580 206910 207240 207570 207900 208230 208560 208890 209220 209550 209880 210210 210540 210870 211200 211530 211860 212190 212520 212850 213180 213510 213840 214170 214500 214830 215160 215490 215820 216150 216480 216810 217140 217470 217800 218130 218460 218790 219120 219450 219780 220110 220440 220770 221100 221430 221760 222090 222420 222750 223080 223410 223740 224070 224400 224730 225060 225390 225720 226050 226380 226710 227040 227370 227700 228030 228360 228690 229020 229350 229680 230010 230340 230670 231000 231330 231660 231990 232320 232650 232980 233310 233640 233970 234300 234630 234960 235290 235620 235950 236280 236610 236940 237270 237600 237930 238260 238590 238920 239250 239580 239910 240240 240570 240900 241230 241560 241890 242220 242550 242880 243210 243540 243870 244200 244530 244860 245190 245520 245850 246180 246510 246840 247170 247500 247830 248160 248490 248820 249150 249480 249810 250140 250470 250800 251130 251460 251790 252120 252450 252780 253110 253440 253770 254100 254430 254760 255090 255420 255750 256080 256410 256740 257070 257400 257730 258060 258390 258720 259050 259380 259710 260040 260370 260700 261030 261360 261690 262020 262350 262680 263010 263340 263670 264000 264330 264660 264990 265320 265650 265980 266310 266640 266970 267300 267630 267960 268290 268620 268950 269280 269610 269940 270270 270600 270930 271260 271590 271920 272250 272580 272910 273240 273570 273900 274230 274560 274890 275220 275550 275880 276210 276540 276870 277200 277530 277860 278190 278520 278850 279180 279510 279840 280170 280500 280830 281160 281490 281820 282150 282480 282810 283140 283470 283800 284130 284460 284790 285120 285450 285780 286110 286440 286770 287100 287430 287760 288090 288420 288750 289080 289410 289740 290070 290400 290730 291060 291390 291720 292050 292380 292710 293040 293370 293700 294030 294360 294690 295020 295350 295680 296010 296340 296670 297000 297330 297660 297990 298320 298650 298980 299310 299640 299970 300300 300630 300960 301290 301620 301950 302280 302610 302940 303270 303600 303930 304260 304590 304920 305250 305580 305910 306240 306570 306900 307230 307560 307890 308220 308550 308880 309210 309540 309870 310200 310530 310860 311190 311520 311850 312180 312510 312840 313170 313500 313830 314160 314490 314820 315150 315480 315810 316140 316470 316800 317130 317460 317790 318120 318450 318780 319110 319440 319770 320100 320430 320760 321090 321420 321750 322080 322410 322740 323070 323400 323730 324060 324390 324720 325050 325380 325710 326040 326370 326700 327030 327360 327690 328020 328350 328680 329010 329340 329670 330000 330330 330660 330990 331320 331650 331980 332310 332640 332970 333300 333630 333960 334290 334620 334950 335280 335610 335940 336270 336600 336930 337260 337590 337920 338250 338580 338910 339240 339570 339900 340230 340560 340890 341220 341550 341880 342210 342540 342870 343200 343530 343860 344190 344520 344850 345180 345510 345840 346170 346500 346830 347160 347490 347820 348150 348480 348810 349140 349470 349800 350130 350460 350790 351120 351450 351780 352110 352440 352770 353100 353430 353760 354090 354420 354750 355080 355410 355740 356070 356400 356730 357060 357390 357720 358050 358380 358710 359040 359370 359700 360030 360360 360690 361020 361350 361680 362010 362340 362670 363000 363330 363660 363990 364320 364650 364980 365310 365640 365970 366300 366630 366960 367290 367620 367950 368280 368610 368940 369270 369600 369930 370260 370590 370920 371250 371580 371910 372240 372570 372900 373230 373560 373890 374220 374550 374880 375210 375540 375870 376200 376530 376860 377190 377520 377850 378180 378510 378840 379170 379500 379830 380160 380490 380820 381150 381480 381810 382140 382470 382800 383130 383460 383790 384120 384450 384780 385110 385440 385770 386100 386430 386760 387090 387420 387750 388080 388410 388740 389070 389400 389730 390060 390390 390720 391050 391380 391710 392040 392370 392700 393030 393360 393690 394020 394350 394680 395010 395340 395670 396000 396330 396660 396990 397320 397650 397980 398310 398640 398970 399300 399630 399960 400290 400620 400950 401280 401610 401940 402270 402600 402930 403260 403590 403920 404250 404580 404910 405240 405570 405900 406230 406560 406890 407220 407550 407880 408210 408540 408870 409200 409530 409860 410190 410520 410850 411180 411510 411840 412170 412500 412830 413160 413490 413820 414150 414480 414810 415140 415470 415800 416130 416460 416790 417120 417450 417780 418110 418440 418770 419100 419430 419760 420090 420420 420750 421080 421410 421740 422070 422400 422730 423060 423390 423720 424050 424380 424710 425040 425370 425700 426030 426360 426690 427020 427350 427680 428010 428340 428670 429000 429330 429660 429990 430320 430650 430980 431310 431640 431970 432300 432630 432960 433290 433620 433950 434280 434610 434940 435270 435600 435930 436260 436590 436920 437250 437580 437910 438240 438570 438900 439230 439560 439890 440220 440550 440880 441210 441540 441870 442200 442530 442860 443190 443520 443850 444180 444510 444840 445170 445500 445830 446160 446490 446820 447150 447480 447810 448140 448470 448800 449130 449460 449790 450120 450450 450780 451110 451440 451770 452100 452430 452760 453090 453420 453750 454080 454410 454740 455070 455400 455730 456060 456390 456720 457050 457380 457710 458040 458370 458700 459030 459360 459690 460020 460350 460680 461010 461340 461670 462000 462330 462660 462990 463320 463650 463980 464310 464640 464970 465300 465630 465960 466290 466620 466950 467280 467610 467940 468270 468600 468930 469260 469590 469920 470250 470580 470910 471240 471570 471900 472230 472560 472890 473220 473550 473880 474210 474540 474870 475200 475530 475860 476190 476520 476850 477180 477510 477840 478170 478500 478830 479160 479490 479820 480150 480480 480810 481140 481470 481800 482130 482460 482790 483120 483450 483780 484110 484440 484770 485100 485430 485760 486090 486420 486750 487080 487410 487740 488070 488400 488730 489060 489390 489720 490050 490380 490710 491040 491370 491700 492030 492360 492690 493020 493350 493680 494010 494340 494670 495000 495330 495660 495990 496320 496650 496980 497310 497640 497970 498300 498630 498960 499290 499620 499950 500280 500610 500940 501270 501600 501930 502260 502590 502920 503250 503580 503910 504240 504570 504900 505230 505560 505890 506220 506550 506880 507210 507540 507870 508200 508530 508860 509190 509520 509850 510180 510510 510840 511170 511500 511830 512160 512490 512820 513150 513480 513810 514140 514470 514800 515130 515460 515790 516120 516450 516780 517110 517440

District I
PO Box 1980, Hobbs, NM 88241-1980
District II
PO Drawer DD, Artesia, NM 88211-0719
District III
1000 Rio Brazos Rd., Aztec, NM 87410
District IV
PO Box 2088, Santa Fe, NM 87504-2088

State of New Mexico
Energy, Minerals & Natural Resources Department

OIL CONSERVATION DIVISION
PO Box 2088
Santa Fe, NM 87504-2088

Form C-102
Revised February 21, 1989

Instructions on back
Submit to Appropriate District Office
State Lease - 4 Copies
Fee Lease - 3 Copies

☒ AMENDED REPORT
Number change

WELL LOCATION AND ACREAGE DEDICATION PLAT

1 API Number 30-043-24594		1 Pool Code 72319		1 Pool Name Blanco Mesavende		
1 Property Code 001031		1 Property Name Schwerdtfeger A			1 Well Number old # 6E New # 6M	
1 OGRID No. 000778		1 Operator Name AMOCO Production Company			1 Elevation 6134	

10 Surface Location

UL or lot no. D	Section 8	Township 27N	Range 8W	Lot Idn	Feet from the 1120	North/South line FNL	Feet from the 940	East/West line FWL	County SAN JUAN
--------------------	--------------	-----------------	-------------	---------	-----------------------	-------------------------	----------------------	-----------------------	--------------------

11 Bottom Hole Location If Different From Surface

UL or lot no.	Section	Township	Range	Lot Idn	Feet from the	North/South line	Feet from the	East/West line	County
---------------	---------	----------	-------	---------	---------------	------------------	---------------	----------------	--------

12 Dedicated Acres 320	13 Joint or Infill Y	14 Consolidation Code	15 Order No.
---------------------------	-------------------------	-----------------------	--------------

NO ALLOWABLE WILL BE ASSIGNED TO THIS COMPLETION UNTIL ALL INTERESTS HAVE BEEN CONSOLIDATED
OR A NON-STANDARD UNIT HAS BEEN APPROVED BY THE DIVISION

16 1120 940					17 OPERATOR CERTIFICATION I hereby certify that the information contained herein is true and complete to the best of my knowledge and belief. Signature A. WAYNE BRANAM Printed Name BUSINESS ANALYST Title 02 07 95 Date
					18 SURVEYOR CERTIFICATION I hereby certify that the well location shown on this plat was plotted from field notes of actual surveys made by me or under my supervision, and that the same is true and correct to the best of my belief. 08 08 80 Date of Survey Signature and Seal of Professional Surveyer: ON file 3950 Certificate Number

San Juan O.C.
WELL: SCHWERDTFEGER A 003-DK (97892901)
(Downtime excluded)

