

UNITED STATES
DEPARTMENT OF THE INTERIOR
GEOLOGICAL SURVEY

APPLICATION FOR PERMIT TO DRILL, DEEPEN, OR PLUG BACK

1a. TYPE OF WORK DRILL <input checked="" type="checkbox"/> DEEPEN <input type="checkbox"/> PLUG BACK <input type="checkbox"/>		5. LEASE DESIGNATION AND SERIAL NO. SF 078432
b. TYPE OF WELL OIL WELL <input type="checkbox"/> GAS WELL <input checked="" type="checkbox"/> OTHER <input type="checkbox"/> SINGLE ZONE <input checked="" type="checkbox"/> MULTIPLE ZONE <input type="checkbox"/>		6. IF INDIAN, ALLOTTEE OR TRIBE NAME
2. NAME OF OPERATOR SOUTHERN UNION PRODUCTION COMPANY		7. UNIT AGREEMENT NAME 1
3. ADDRESS OF OPERATOR P. O. Box 808, FARMINGTON, NEW MEXICO 87401		8. FARM OR LEASE NAME HODGES
4. LOCATION OF WELL (Report location clearly and in accordance with any State requirements.) At surface 790 FT. FROM NORTH LINE AND 790 FT. FROM WEST LINE At proposed prod. zone SAME AS ABOVE		9. WELL NO. 10
14. DISTANCE IN MILES AND DIRECTION FROM NEAREST TOWN OR POST OFFICE* 29 MILES SOUTH OF BLOOMFIELD, NEW MEXICO		10. FIELD AND POOL, OR WILDCAT BASIN DAKOTA
15. DISTANCE FROM PROPOSED* LOCATION TO NEAREST PROPERTY OR LEASE LINE, FT. (Also to nearest drlg. unit line, if any) 790 FT.		11. SEC., T., R., M., OR BLK. AND SURVEY OR AREA SEC. 28, T-26 N, R-8 W, N.M.P.M.
16. NO. OF ACRES IN LEASE		12. COUNTY OR PARISH SAN JUAN
17. NO. OF ACRES ASSIGNED TO THIS WELL 320		13. STATE NEW MEXICO
18. DISTANCE FROM PROPOSED LOCATION* TO NEAREST WELL, DRILLING, COMPLETED, OR APPLIED FOR, ON THIS LEASE, FT. 2900 FT.		14. DISTANCE FROM PROPOSED LOCATION* TO NEAREST WELL, DRILLING, COMPLETED, OR APPLIED FOR, ON THIS LEASE, FT. 6860 FT.
19. PROPOSED DEPTH 6860 FT.		20. ROTARY OR CABLE TOOLS ROTARY
21. ELEVATIONS (Show whether DF, RT, GR, etc.) 6452 FT. UNGRADED GROUND LEVEL		22. APPROX. DATE WORK WILL START* DECEMBER 12, 1966

23. PROPOSED CASING AND CEMENTING PROGRAM

SIZE OF HOLE	SIZE OF CASING	WEIGHT PER FOOT	SETTING DEPTH	QUANTITY OF CEMENT
12-1/4"	8-5/8"	24.0#	300 FT.	250 SACKS
7-5/8"	4-1/2"	10.5#	6860 FT.	2450 (3 STAGE)

WE PROPOSE TO DRILL A DAKOTA WELL; ANTICIPATED TOTAL DEPTH 6860 FT. R.K.B.

- CASING PROGRAM: SURFACE; 8-5/8", 24.0#, J-55 SET AT 300 FT. CEMENTED W/250 SACKS.
PRODUCTION: 4-1/2", 10.50#, J-55 SET AT T.D. OF 6860 FT. R.K.B.
1ST STAGE CEMENTED W/600 CU. FT. CEMENT; STAGE COLLAR SET AT 4800 FT. UNDER MESAVERDE & CEMENTED W/750 CU. FT. CEMENT; STAGE COLLAR SET AT 2300 FT. UNDER PICTURED CLIFF AND CEMENTED W/1100 CU. FT. CEMENT.
- ROTARY TOOLS WILL BE USED TO MUD DRILL WELL FROM SURFACE TO TOTAL DEPTH.
- WELL WILL BE SAND FRACED TO STIMULATE PRODUCTION.
- 1-1/2" E.U.E., 2.90#, JCW TBG. WILL BE LANDED AT APPROX. 6750 FT. R.K.B.

IN ABOVE SPACE DESCRIBE PROPOSED PROGRAM: If proposal is to deepen or plug back, give data on present productive zone and proposed new productive zone. If proposal is to drill or deepen directionally, give pertinent data on subsurface locations and measured and true vertical depths. Give blowout preventer program, if any.

24. Original signed by
GILBERT D. NOLAND, JR.

SIGNED

TITLE DRILLING SUPERINTENDENT

DATE DECEMBER 9, 1966

GILBERT D. NOLAND, JR.
(This space for Federal or State office use)

PERMIT NO.

APPROVAL DATE

APPROVED BY

TITLE

SUPERVISOR DIST. #3

DATE

CONDITIONS OF APPROVAL, IF ANY:

DEC 12 1966

*See Instructions On Reverse Side

U. S. GEOLOGICAL SURVEY
FARMINGTON, N. M.

Instructions

General: This form is designed for submitting proposals to perform certain well operations, as indicated, on all types of lands and leases for appropriate action by either a Federal or a State agency, or both, pursuant to applicable Federal and/or State laws and regulations. Any necessary special instructions concerning the use of this form and the number of copies to be submitted, particularly with regard to local, area, or regional procedures and practices, either are shown below or will be issued by, or may be obtained from, the local Federal and/or State office.

Item 1: If the proposal is to redrill to the same reservoir at a different subsurface location or to a new reservoir, use this form with appropriate notations. Consult applicable State or Federal regulations concerning subsequent work proposals or reports on the well.

Item 4: If there are no applicable State requirements, locations on Federal or Indian land should be described in accordance with Federal requirements. Consult local State or Federal office for specific instructions.

Item 14: Needed only when location of well cannot readily be found by road from the land or lease description. A plat, or plats, separate or on this reverse side, showing the roads to, and the surveyed location of, the well, and any other required information, should be furnished when required by Federal or State agency offices.

Items 15 and 18: If well is to be, or has been directionally drilled, give distances for subsurface location of hole in any present or objective production zone.

Item 22: Consult applicable Federal or State regulations, or appropriate officials, concerning approval of the proposal before operations are started.

NEW MEXICO OIL CONSERVATION COMMISSION

WELL LOCATION AND ACERAGE DEDICATION PLAT

All distances must be from the outer boundaries of the Section

Operator SOUTHERN UNION PRODUCTION COMPANY			Lease HODGES			Well No 10		
Unit Letter D	Section 28	Township 26 NORTH	Range 8 WEST	County SAN JUAN				
Actual Footage Location of Well: 790 feet from the NORTH line and 790 feet from the WEST line								
Ground Level Elev. 6452.0		Producing Formation DAKOTA		Pool BASIN DAKOTA		Dedicated Acreage 1/2 120		Acres

1. Outline the acreage dedicated to the subject well by colored pencil or hatchure marks on the plat below.
2. If more than one lease is dedicated to the well, outline each and identify the ownership thereof (both as to working interest and royalty).
3. If more than one lease of different ownership is dedicated to the well, have the interests of all owners been consolidated by communitization, unitization, force-pooling, etc?

() Yes () No If answer is "yes," type of consolidation

If answer is "no," list the owners and tract descriptions which have actually consolidated. (Use reverse side of this form if necessary.)

No allowable will be assigned to the well until all interests have been consolidated (by communitization, unitization, forced-pooling, or otherwise) or until a non standard unit, eliminating such interests, has been approved by the Commission.

CERTIFICATION

I hereby certify that the information contained herein is true and complete to the best of my knowledge and belief.

Original signed by
GILBERT D. NOLAND, JR.
GILBERT D. NOLAND, JR.

Position
DILLING SUPERINTENDENT

Company
SOUTHERN UNION PRODUCTION COMPANY

Date
December 9, 1966

I hereby certify that the well location shown on this plat was plotted from field notes of actual surveys made by me or under my supervision, and that the same is true and correct to the best of my knowledge and belief.

Date Surveyed
December 8, 1966

Registered Professional Engineer
and/or Land Surveyor
James F. Hesse

Certificate No. **125**

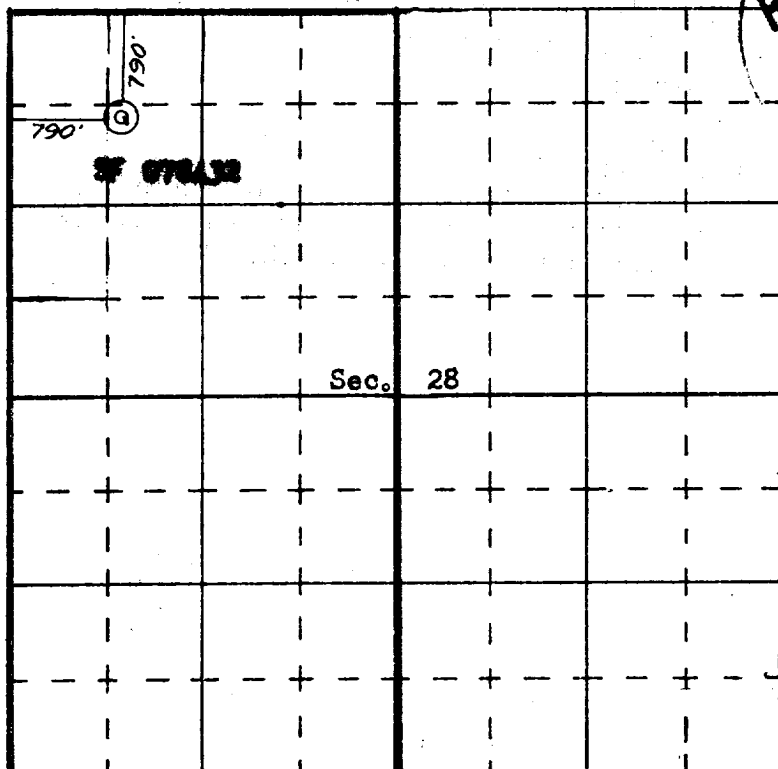

SCALE—4 INCHES EQUALS 1 MILE

SAN JUAN ENGINEERING COMPANY, FARMINGTON, N. M.