

X				

(SUBMIT IN TRIPPLICATE)

UNITED STATES
DEPARTMENT OF THE INTERIOR
GEOLOGICAL SURVEY

Budget Bureau No. 42-R388.4.
Approval expires 12-31-60.

Land Office New Mexico
Lease No. 03154
Unit N/2

SUNDRY NOTICES AND REPORTS ON WELLS

NOTICE OF INTENTION TO DRILL		SUBSEQUENT REPORT OF WATER SHUT-OFF	
NOTICE OF INTENTION TO CHANGE PLANS		SUBSEQUENT REPORT OF SHOOTING OR ACIDIZING	
NOTICE OF INTENTION TO TEST WATER SHUT-OFF		SUBSEQUENT REPORT OF ALTERING CASING	
NOTICE OF INTENTION TO RE-DRILL OR REPAIR WELL		SUBSEQUENT REPORT OF RE-DRILLING OR REPAIR	
NOTICE OF INTENTION TO SHOOT OR ACIDIZE		SUBSEQUENT REPORT OF ABANDONMENT	
NOTICE OF INTENTION TO PULL OR ALTER CASING		SUPPLEMENTARY WELL HISTORY	
NOTICE OF INTENTION TO ABANDON WELL			
Correction of Acreage Dedication <u>xxx</u>			

(INDICATE ABOVE BY CHECK MARK NATURE OF REPORT, NOTICE, OR OTHER DATA)

RECEIVED
NOV 21 1961
U. S. GEOLOGICAL SURVEY
FARMINGTON, NEW MEXICO

Well No. 13-14 is located 1,850 ft. from N line and 1,190 ft. from W line of sec. 14
November 21, 1961, 19__

NW/4 Section 14 T:26-North, Range 9-West N.M.P.M.
(1/4 Sec. and Sec. No.) (Twp.) (Range) (Meridian)
Basin Dakota San Juan County New Mexico
(Field) (County or Subdivision) (State or Territory)

The elevation of the derrick floor above sea level is 6,328 ft.

DETAILS OF WORK

(State names of and expected depths to objective sands; show sizes, weights, and lengths of proposed casings; indicate mudding jobs, cementing points, and all other important proposed work)

When notice of intention to drill this well was filed on November 6, 1961 New Mexico Form C-128 - Well Location and Acreage Dedication Plat attached incorrectly dedicated the West Half of Section 14 (320 acres) to this Dakota well.

Corrected plat is attached - properly dedicating the North Half of Section 14 (320 acres) to this well.

It is respectfully requested that records concerning this well be corrected accordingly.

I understand that this plan of work must receive approval in writing by the Geological Survey before operations may be commenced.

Company J. Glenn Turner
Address P. O. Box 728
Farmington, New Mexico

By C. Beeson Neal
Title Agent in Farmington

NEW MEXICO OIL CONSERVATION COMMISSION

Well Location and ^{Corrected} Acreage Dedication Plat

Section A.

Date November 21, 1961

Operator J. GLENN TURNER Lease BALLARD
 Well No. 13-14 Unit Letter E Section 14 Township 26 NORTH Range 9 WEST NMPM
 Located 1850 Feet From THE NORTH Line, 1190 Feet From THE WEST Line
 County SAN JUAN G. L. Elevation 6317.55 Dedicated Acreage 320 Acres
 Name of Producing Formation Dakota Pool Basin Dakota

1. Is the Operator the only owner in the dedicated acreage outlined on the plat below?
 Yes X No _____
2. If the answer to question one is "no", have the interests of all the owners been consolidated by communization agreement or otherwise? Yes _____ No _____. If answer is "yes", Type of Consolidation.
3. If the answer to question two is "no", list all the owners and their respective interests below:

Owner

Land Description

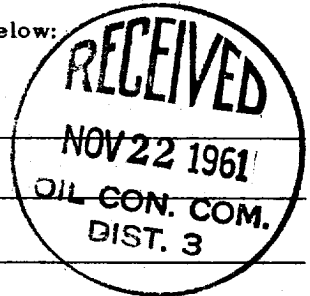

Section B.

Note: All distances must be from outer boundaries of section.

This is to certify that the information in Section A above is true and complete to the best of my knowledge and belief.

J. GLENN TURNER

Operator

G. Decker Bell, Agent in Farmington

(Address)

Box 720

Farmington, New Mexico.

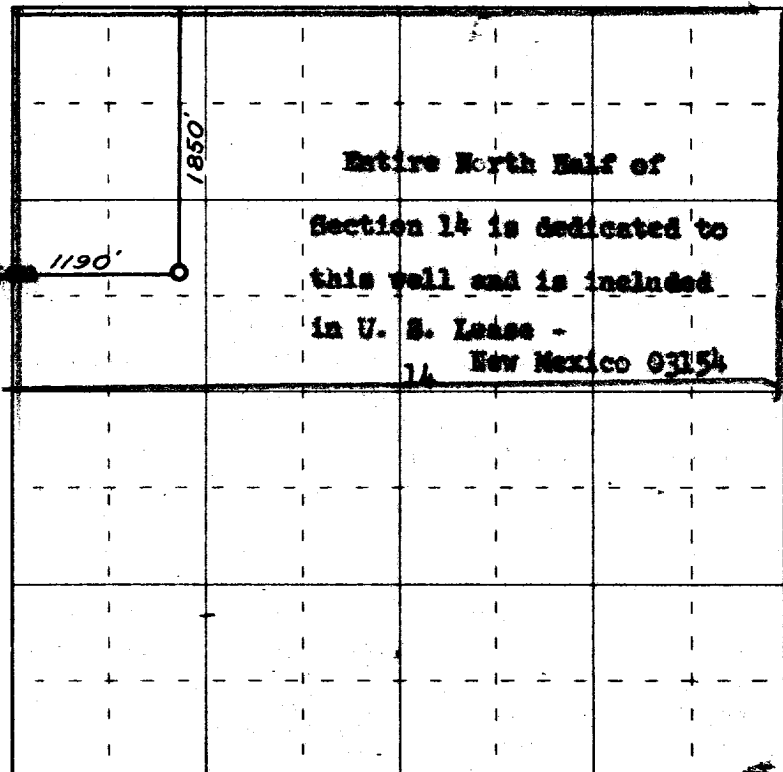

Scale 4 inches equal 1 mile

Ref. GLO Plat dated: May 10, 1949

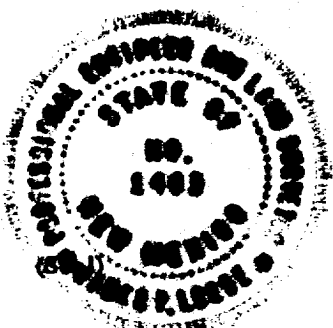

Farmington, New Mexico

This is to certify that the above plat was prepared from field notes of actual surveys made by me or under my supervision and that the same are true and correct to the best of my knowledge and belief.

Date Surveyed November 2, 1961

James P. Leese
 Registered Professional Engineer and/or Land Surveyor
 James P. Leese N. Mex. Reg. No. 1463