

Land Office **Santa Fe**  
Lease No. **078571**  
Unit

(SUBMIT IN TRIPLICATE)  
**UNITED STATES**  
**DEPARTMENT OF THE INTERIOR**  
**GEOLOGICAL SURVEY**

**SUNDRY NOTICES AND REPORTS ON WELLS**

NOTICE OF INTENTION TO DRILL	XX	SUBSEQUENT REPORT OF WATER SHUT-OFF
NOTICE OF INTENTION TO CHANGE PLANS		SUBSEQUENT REPORT OF SHOOTING OR ACIDIZING
NOTICE OF INTENTION TO TEST WATER SHUT-OFF		SUBSEQUENT REPORT OF ALTERING CASING
NOTICE OF INTENTION TO RE-DRILL OR REPAIR WELL		SUBSEQUENT REPORT OF RE-DRILLING OR REPAIR
NOTICE OF INTENTION TO FLOOD OR ACIDIZE		SUBSEQUENT REPORT OF ABANDONMENT
NOTICE OF INTENTION TO PULL OR ALTER CASING		SUPPLEMENTARY WELL HISTORY
NOTICE OF INTENTION TO ABANDON WELL		

RECEIVED  
JUL 9 1962

INDICATE ABOVE BY CHECK MARK NATURE OF REPORT, NOTICE, OR OTHER DATA:

July 6,

Day "B"

Well No. **7** is located **846** ft. from ~~XXX~~ **S** line and **1633** ft. from ~~XXX~~ **E** line of sec. **7**

**SE/4 Section 7** **27-N** **8-W** **N.M.P.M.**

**So. Blanco Pictured Cliffs** **San Juan** **New Mexico**

The elevation of the drilling floor above sea level is **6800** ft.

**DETAILS OF WORK**

List names of all species of logs, including sands, show sizes, weights, and lengths of proposed casings, indicate mud logs, cementing points, and all other important production work.

It is intended to mud drill a well with rotary tools thru the Pictured Cliffs formation. Possible producing zones will be perforated and fractured.  
Estimated T.D. 3005'.

**Casing Program:**

- 8 5/8" set at 120' with 120 sacks cement circulated to surface.
- 2 7/8" set at 3005' with 140 sacks cement to cover 100' above Fruitland.

The SE/4 Section 7 is dedicated to this well.

I understand that this plan of work must receive approval in writing by the Geological Survey before operations may be commenced.

Company **El Paso Natural Gas Company**

Address **Box 990**

**Farmington, New Mexico**

By *D W. Mahan*

Title **Petroleum Engineer**

## NEW MEXICO OIL CONSERVATION COMMISSION

## Well Location and Acreage Dedication Plat

Section A.

Date **JUNE 21, 1962**

Operator **EL PASO NATURAL GAS COMPANY** Lease **DAY "B"** SF078571  
 Well No. **7** Unit Letter **0** Section **7** Township **27-N** Range **8-W** NMPM  
 Located **846** Feet From **SOUTH** Line, **1633** Feet From **EAST** Line  
 County **SAN JUAN** G. L. Elevation **6790** Dedicated Acreage **160** Acres  
 Name of Producing Formation **PICTURED CLIFFS** Pool **SO. BLANCO P.C.**

1. Is the Operator the only owner in the dedicated acreage outlined on the plat below?  
 Yes ☒ No ☐
2. If the answer to question one is "no", have the interests of all the owners been consolidated by communitization agreement or otherwise? Yes ☐ No ☐ If answer is "yes", Type of Consolidation.
3. If the answer to question two is "no", list all the owners and their respective interests below:

Owner

**RECEIVED**  
**JUL 10 1962**  
 OIL CON. COM.  
 DIST. 3

**RECEIVED**  
**JUL 9 1962**  
 U. S. GEOLOGICAL SURVEY  
 FARMINGTON, NEW MEXICO

Section B.

Note: All distances must be from outer boundaries of section.

This is to certify that the information in Section A above is true and complete to the best of my knowledge and belief.

**El Paso Natural Gas Company**

(Operator)

Original Signed **D. W. Meehan**

(Representative)

**Box 990**

(Address)

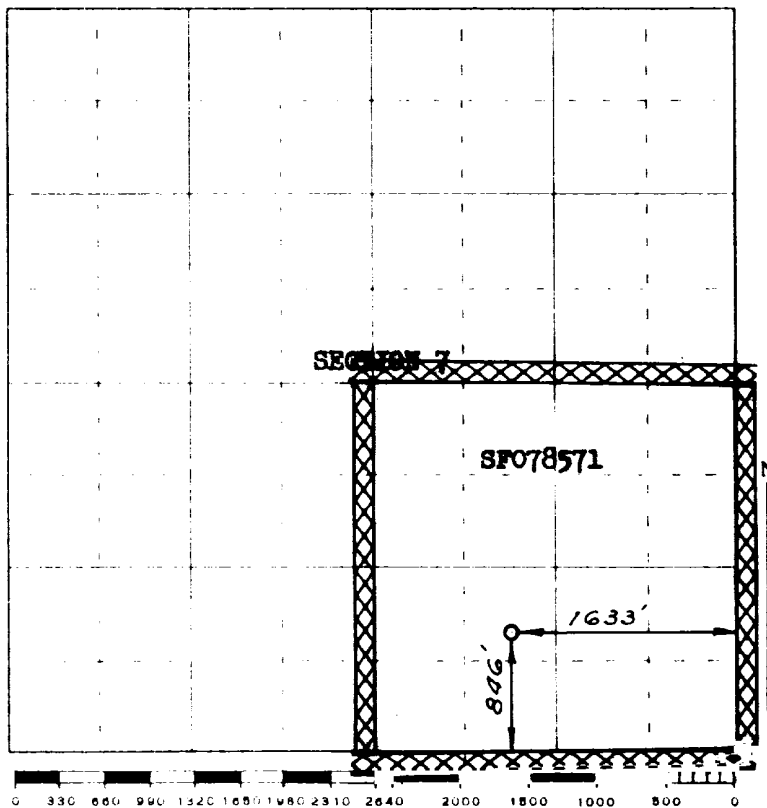
**Farmington, New Mexico**

Scale 4 inches equal 1 mile

This is to certify that the above plat was prepared from field notes of actual surveys made by me or under my supervision and that the same are true and correct to the best of my knowledge and belief.

(Seal)

Date Surveyed **JUNE 11, 1962**

*David O. Kilmer*  
 Registered Professional Engineer and/or Land Surveyor

Farmington, New Mexico