

NO. OF COPIES RECEIVED	6
DISTRIBUTION	
SANTA FE	1
FILE	1
U.S.G.S.	2
LAND OFFICE	1
OPERATOR	1

1-Canfield
1-Ahrens
1-F

NEW MEXICO OIL CONSERVATION COMMISSION

Form C-101
Revised 1-1-65 30-047-20026 045

5A. Indicate Type of Lease	
STATE <input type="checkbox"/>	FEE <input checked="" type="checkbox"/>
5. State Oil & Gas Lease No.	

APPLICATION FOR PERMIT TO DRILL, DEEPEN, OR PLUG BACK

1a. Type of Work		7. Unit Agreement Name	
b. Type of Well OIL WELL <input type="checkbox"/> GAS WELL <input checked="" type="checkbox"/> OTHER <input type="checkbox"/>		8. Farm or Lease Name Babbitt	
2. Name of Operator Beta Development Co.		9. Well No. 1	
3. Address of Operator 234 Petroleum Club Plaza, Farmington, New Mexico		10. Field and Pool, or Wildcat Basin Dakota	
4. Location of Well UNIT LETTER J LOCATED 1780 FEET FROM THE South LINE AND 1695 FEET FROM THE East LINE OF SEC. 24 TWP. 26 N RGE. 9 W NMPM		12. County San Juan	
19. Proposed Depth 6750'		19A. Formation Dakota	
20. Rotary or C.T. Rotary		21. Elevations (Show whether DF, RT, etc.) 6245' G.L.	
21A. Kind & Status Plug. Bond Bond on file		21B. Drilling Contractor Loffland Bros. Co.	
22. Approx. Date Work will start February 17, 1967			

23. PROPOSED CASING AND CEMENT PROGRAM					
SIZE OF HOLE	SIZE OF CASING	WEIGHT PER FOOT	SETTING DEPTH	SACKS OF CEMENT	EST. TOP
12 1/4"	8 5/8"	24#	300'	175 sx	
7 7/8"	4 1/2"	10.5#	6750'	See below 1200 Sx 2400 cu ft	

Propose to cement production casing in 3 stages: 1st stage - to protect the Dakota formation; 2nd stage - to protect the Mesa Verde formation; 3rd stage - to protect the Pictured Cliffs, Kirtland and Fruitland formations.

Propose to perforate and sand-water-frac the Dakota pay formation.

APPROVAL VALID
FOR 90 DAYS UNLESS
DRILLING COMMENCED,

EXPIRES May 15, 1967



IN ABOVE SPACE DESCRIBE PROPOSED PROGRAM: IF PROPOSAL IS TO DEEPEN OR PLUG BACK, GIVE DATA ON PRESENT PRODUCTIVE ZONE AND PROPOSED NEW PRODUCTIVE ZONE. GIVE BLOWOUT PREVENTER PROGRAM, IF ANY.

I hereby certify that the information above is true and complete to the best of my knowledge and belief.

Signed D. E. BAXTER Title Superintendent Date February 16, 1967

(This space for State Use)

APPROVED BY Ernest C. Amos TITLE Secy Dist 3 DATE 2-16-67
CONDITIONS OF APPROVAL, IF ANY:

**NEW MEXICO OIL CONSERVATION COMMISSION
WELL LOCATION AND ACERAGE DEDICATION PLAT**

All distances must be from the outer boundaries of the Section

Operator BETA DEVELOPMENT COMPANY			Lease BABBITT		Well No 1
Unit Letter J	Section 24	Township 26 NORTH	Range 9 WEST	County SAN JUAN	
Actual Footage Location of Well: <div style="display: flex; justify-content: space-between;"> 1780 feet from the SOUTH line and 1695 feet from the EAST line </div>					
Ground Level Elev. 6245.0	Producing Formation Dakota	Pool Basin Dakota	Dedicated Acreage: E/320 Acres		

1. Outline the acreage dedicated to the subject well by colored pencil or hachure marks on the plat below.
2. If more than one lease is dedicated to the well, outline each and identify the ownership thereof (both as to working interest and royalty),
3. If more than one lease of different ownership is dedicated to the well, have the interests of all owners been consolidated by communitization, unitization, force-pooling, etc?

() Yes () No If answer is "yes," type of consolidation

If answer is "no," list the owners and tract descriptions which have actually consolidated. (Use reverse side of this form if necessary.)

No allowable will be assigned to the well until all interests have been consolidated (by communitization, unitization, forced-pooling, or otherwise) or until a non standard unit, eliminating such interests, has been approved by the Commission.

CERTIFICATION

I hereby certify that the information contained herein is true and complete to the best of my knowledge and belief.

Original signed by:

D. E. BAXTER

Name
Doyle E. Baxter

Position
Superintendent

Company
Beta Development Co.

Date
February 16, 1967

I hereby certify that the well location shown on this plat was plotted from field notes of actual surveys made by me or under my supervision, and that the same is true and correct to the best of my knowledge and belief.

15 February 1967

Date Surveyed

James P. L...
Registered Professional Engineer
and/or Land Surveyor

1463

Certificate No.

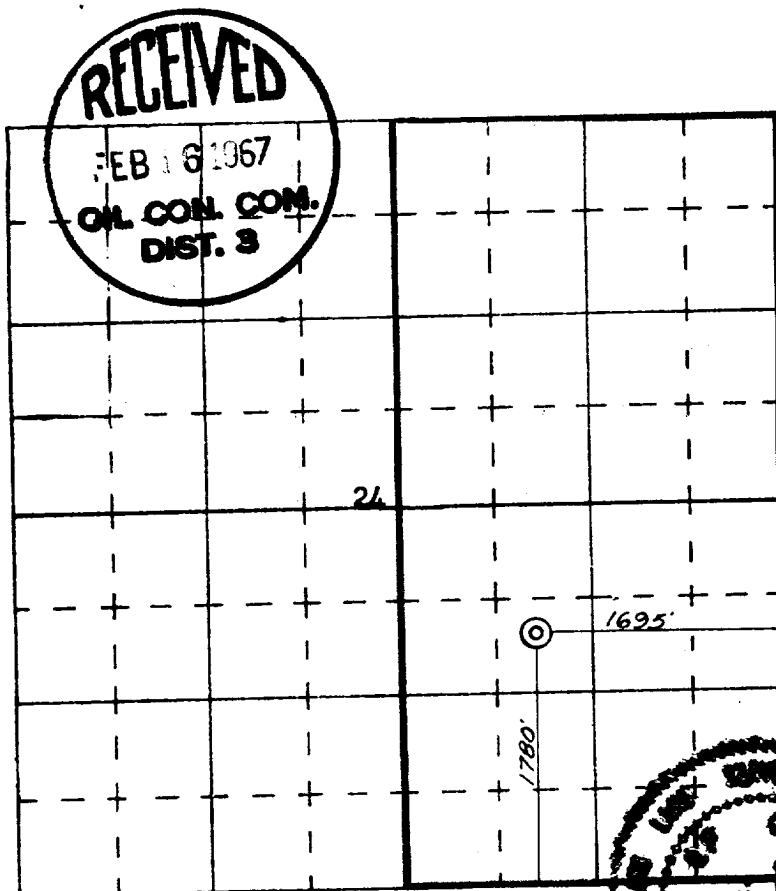

SCALE—4 INCHES EQUALS 1 MILE

SAN JUAN ENGINEERING COMPANY,

FARMING

