

NO. OF COPIES RECEIVED	5
DISTRIBUTION	
SANTA FE	1
FILE	1
U.S.G.S.	1
LAND OFFICE	1
OPERATOR	1

# NEW MEXICO OIL CONSERVATION COMMISSION

Form C-101  
Revised 1-1-65 30-045-20516

5A. Indicate Type of Lease	
STATE <input checked="" type="checkbox"/>	FEE <input type="checkbox"/>
5. State Oil & Gas Lease No.	

## APPLICATION FOR PERMIT TO DRILL, DEEPEN, OR PLUG BACK

1a. Type of Work		7. Unit Agreement Name	
b. Type of Well DRILL <input checked="" type="checkbox"/> DEEPEN <input type="checkbox"/> PLUG BACK <input type="checkbox"/> OIL WELL <input type="checkbox"/> GAS WELL <input checked="" type="checkbox"/> OTHER <input type="checkbox"/> SINGLE ZONE <input checked="" type="checkbox"/> MULTIPLE ZONE <input type="checkbox"/>		8. Farm or Lease Name <u>State 572 Com</u>	
2. Name of Operator <u>Aztec Oil and Gas</u>		9. Well No. <u>1</u>	
3. Address of Operator <u>Drawer 570, Farmington, New Mexico</u>		10. Field and Pool, or Wildcat <u>Basin Dakota</u>	
4. Location of Well UNIT LETTER <u>M</u> LOCATED <u>1170</u> FEET FROM THE <u>South</u> LINE AND <u>1120</u> FEET FROM THE <u>West</u> LINE OF SEC. <u>2</u> TWP. <u>26N</u> RGE. <u>11W</u> NMPM		12. County <u>San Juan</u>	
19. Proposed Depth <u>6550</u>		19A. Formation <u>Dakota</u>	
20. Rotary or C.T. <u>rotary</u>		21. Elevations (Show whether DT, RT, etc.) <u>6385 Gr</u>	
21A. Kind & Status Plug. Bond		21B. Drilling Contractor <u>Cactus</u>	
22. Approx. Date Work will start			

## PROPOSED CASING AND CEMENT PROGRAM

SIZE OF HOLE	SIZE OF CASING	WEIGHT PER FOOT	SETTING DEPTH	SACKS OF CEMENT	EST. TOP
12-1/4"	8-5/8"	24#	300'	150 sx	
6-3/4"	4-1/2"	10.5#	6550'	600 sx	

APPROVAL VALID  
FOR 90 DAYS UNLESS  
DRILLING COMMENCED,

EXPIRES Sept 17, 1969

Propose to:

Drill a 12-1/4" hole to 300' set 8-5/8" surface pipe cement w/150 sx  
Mud drill a 6-3/4" hole to 6550' TD, run 4 1/2" casing cement w/600 sx  
Run Induction Electric and Gamma Ray Neutron  
Perforate and frac Dakota formation  
Run 2-3/8" tubing

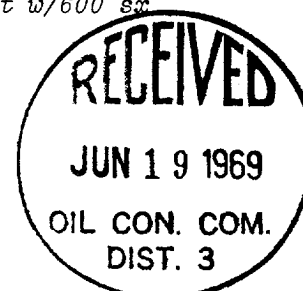

Proration unit: S/2 Sec. 2-26N-11W - 320 ac.

IN ABOVE SPACE DESCRIBE PROPOSED PROGRAM: IF PROPOSAL IS TO DEEPEN OR PLUG BACK, GIVE DATA ON PRESENT PRODUCTIVE ZONE AND PROPOSED NEW PRODUCTIVE ZONE. GIVE BLOWOUT PREVENTER PROGRAM, IF ANY.

I hereby certify that the information above is true and complete to the best of my knowledge and belief.

Signed Joe A. Simon Title District Superintendent Date 6-18-69

(This space for State Use)

APPROVED BY A.R. Kendrick TITLE PETROLEUM ENGINEER DIST. NO. 3 DATE JUN 19 1969  
CONDITIONS OF APPROVAL, IF ANY:

The Pictured Cliffs formation must be covered with cement behind the 4 1/2" casing.

NEW MEXICO OIL CONSERVATION COMMISSION  
WELL LOCATION AND ACREAGE DEDICATION PLAT

Form C-102  
Supersedes C-128  
Effective 1-1-65

All distances must be from the outer boundaries of the Section.

Operator <b>Aztec Oil &amp; Gas Company</b>			Lease <b>State 572 Com</b>		Well No. <b>1</b>
Unit Letter <b>M</b>	Section <b>2</b>	Township <b>26N</b>	Range <b>11W</b>	County <b>San Juan</b>	
Actual Footage Location of Well: <b>1170</b> feet from the <b>South</b> line and <b>1120</b> feet from the <b>West</b> line					
Ground Level Elev. <b>6385</b>	Producing Formation <b>Dakota</b>		Pool <b>Basin Dakota</b>	Dedicated Acreage: <b>320</b> Acres	

1. Outline the acreage dedicated to the subject well by colored pencil or hachure marks on the plat below.
2. If more than one lease is dedicated to the well, outline each and identify the ownership thereof (both as to working interest and royalty).
3. If more than one lease of different ownership is dedicated to the well, have the interests of all owners been consolidated by communitization, unitization, force-pooling, etc?

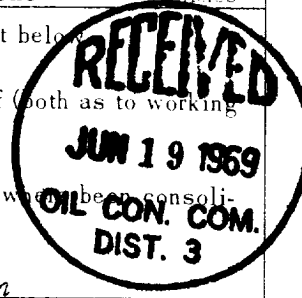

☒ Yes ☐ No If answer is "yes," type of consolidation communitization

If answer is "no," list the owners and tract descriptions which have actually been consolidated. (Use reverse side of this form if necessary.)

No allowable will be assigned to the well until all interests have been consolidated (by communitization, unitization, forced-pooling, or otherwise) or until a non-standard unit, eliminating such interests, has been approved by the Commission.

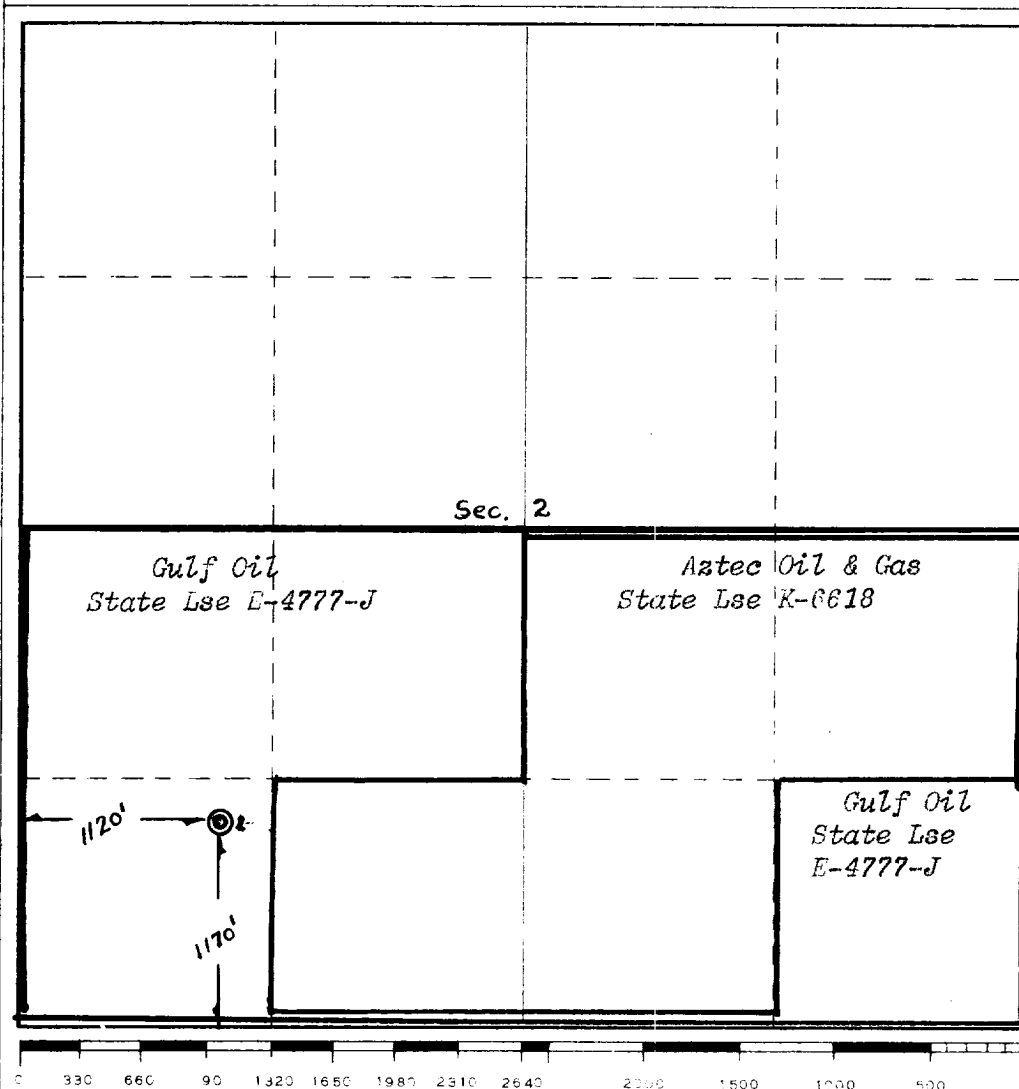

CERTIFICATION

I hereby certify that the information contained herein is true and complete to the best of my knowledge and belief.

Name  
**Joe C. Salmon**  
Position  
**District Superintendent**  
Company  
**Aztec Oil and Gas**  
Date  
**June 18, 1969**

I hereby certify that the well location shown on this plat was plotted from field notes of actual surveys made by me or under my supervision, and that the same is true and correct to the best of my knowledge and belief.

Date Surveyed  
**June 5, 1969**  
Registered Professional Engineer and/or Land Surveyor  
*John B. [Signature]*  
**3950**