

UNITED STATES
DEPARTMENT OF THE INTERIOR
GEOLOGICAL SURVEY

APPLICATION FOR PERMIT TO DRILL, DEEPEN, OR PLUG BACK

1a. TYPE OF WORK

DRILL ☒DEEPEN ☐PLUG BACK ☐

b. TYPE OF WELL

OIL
WELL ☒GAS
WELL ☐

OTHER

SINGLE
ZONE ☒MULTIPLE
ZONE ☐

2. NAME OF OPERATOR

Apache Corporation

3. ADDRESS OF OPERATOR

P. O. Box 2299, Tulsa, Oklahoma, 74101

4. LOCATION OF WELL (Report location clearly and in accordance with any State requirements.*)

At surface

330' NSL & 500' WEL being SE/4 SE/4 of Section 21

At proposed prod. zone

Same as above

14. DISTANCE IN MILES AND DIRECTION FROM NEAREST TOWN OR POST OFFICE*

70 miles SSW of Farmington, New Mexico

15. DISTANCE FROM PROPOSED*

LOCATION TO NEAREST

PROPERTY OR LEASE LINE, FT.

(Also to nearest drlg. unit line, if any)

330'

18. DISTANCE FROM PROPOSED LOCATION*

TO NEAREST WELL, DRILLING, COMPLETED,

OR APPLIED FOR, ON THIS LEASE, FT.

First Well

16. NO. OF ACRES IN LEASE

2560

19. PROPOSED DEPTH

6625'

17. NO. OF ACRES ASSIGNED
TO THIS WELL

40

20. ROTARY OR CABLE TOOLS

Rotary

21. ELEVATIONS (Show whether DF, RT, GR, etc.)

22. APPROX. DATE WORK WILL START*

23. PROPOSED CASING AND CEMENTING PROGRAM

SIZE OF HOLE	SIZE OF CASING	WEIGHT PER FOOT	SETTING DEPTH	QUANTITY OF CEMENT
17"	13-3/8"	48.00#	100'	300 sacks
* 11"	8-5/8"	24.00#	1200'	350 sacks
7-7/8"	5-1/2"	15.50#	Total Depth	300 sacks

* This string will be optional depending on drilling conditions from 400-1200'. In the event no water flow is encountered, the bore hole size will be reduced, from 11" to 7-7/8" at this point.

Apache Corporation proposes to drill a 6625' Devonian test, Density and Induction Electric Logs. The mud system will be maintained to insure proper well control at all times.

IN ABOVE SPACE DESCRIBE PROPOSED PROGRAM: If proposal is to deepen or plug back, give data on present productive zone and proposed new productive zone. If proposal is to drill or deepen directionally, give pertinent data on subsurface locations and measured and true vertical depths. Give blowout preventer program, if any.

24.

SIGNED

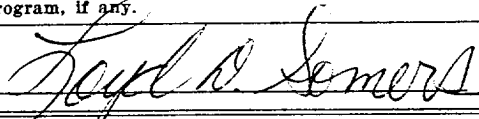

TITLE

Regional Production Manager

DATE

August 26, 1970

(This space for Federal or State office use)

PERMIT NO.

APPROVAL DATE

APPROVED BY

TITLE

DATE

CONDITIONS OF APPROVAL, IF ANY:

**NEW MEXICO OIL CONSERVATION COMMISSION
WELL LOCATION AND ACREAGE DEDICATION PLAT**

Form C-107
Superseding C-101
Effective 1-1-70

All distances must be from the outer boundaries of the Section

Operator Deleware APACHE CORPORATION			Lease Navajo Tribal Tract #52		Well No. 1-21
Unit Letter P	Section 21	Township 26 North	Range 19 West	County San Juan	
Actual Footage Location of Well:					
330	feet from the	South	line and	500	feet from the East line
Ground Level Elev: 6117	Producing Formation Devonian		Pool Wildcat		Dedicated Acreage: 40 Acres

1. Outline the acreage dedicated to the subject well by colored pencil or hatchure marks on the plat below.
2. If more than one lease is dedicated to the well, outline each and identify the ownership thereof (both as to working interest and royalty).
3. If more than one lease of different ownership is dedicated to the well, have the interests of all owners been consolidated by communitization, unitization, force-pooling, etc?

☐ Yes ☐ No If answer is "yes," type of consolidation _____

If answer is "no," list the owners and tract descriptions which have actually been consolidated. (Use reverse side of this form if necessary.) _____

No allowable will be assigned to the well until all interests have been consolidated (by communitization, unitization, forced-pooling, or otherwise) or until a non-standard unit, eliminating such interests, has been approved by the Commission.

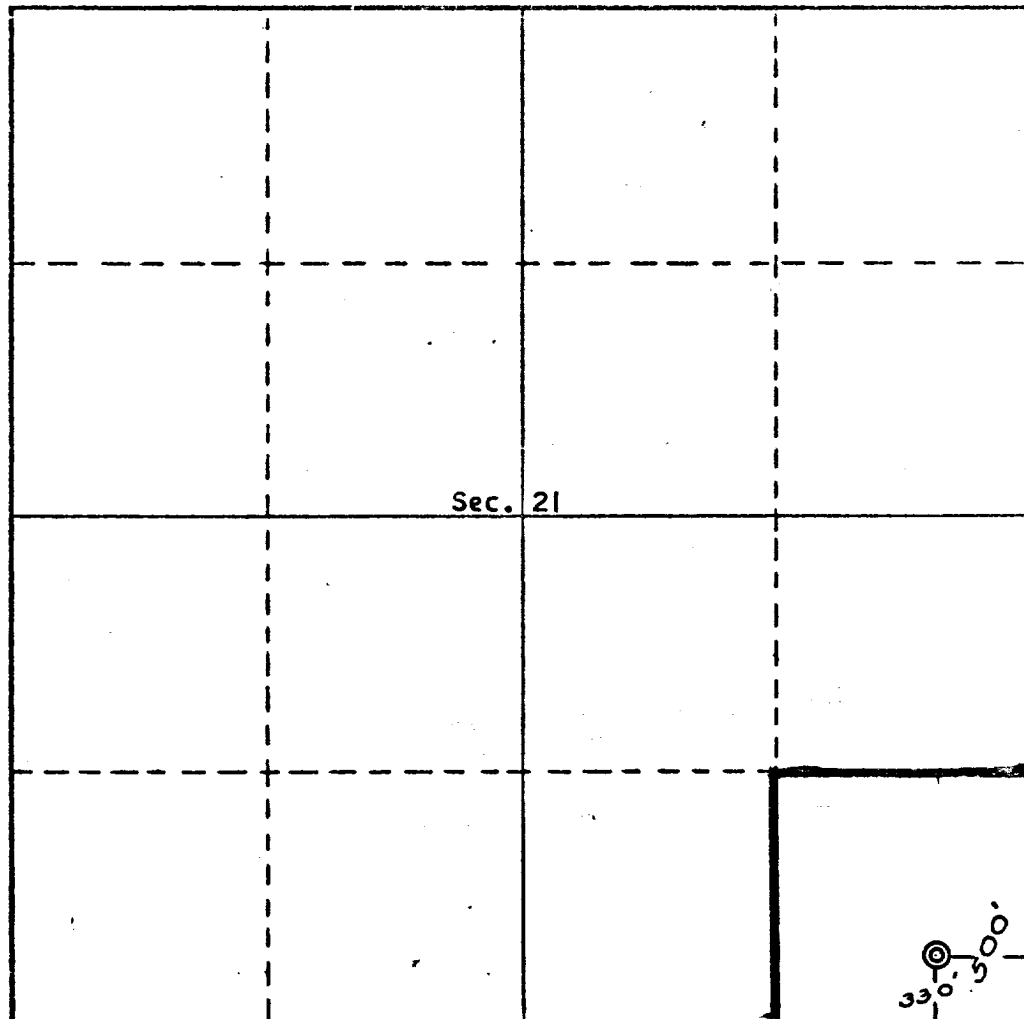

CERTIFICATION

I hereby certify that the information contained herein is true and complete to the best of my knowledge and belief.

Name: *Leopold A. Somers*
 Position: _____
 Regional Production Manager
 Company: Apache Corporation

Date: August 26, 1970

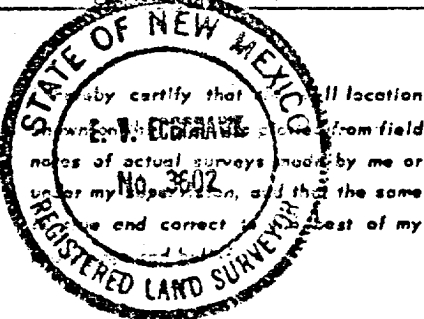

Date Surveyed: August 13, 1970

Registered Professional Engineer
and/or Land Surveyor

E. J. Eckhart
 Certificate No. **3602**

