

UNITED STATES
DEPARTMENT OF THE INTERIOR
GEOLOGICAL SURVEY

30-045-21218

APPLICATION FOR PERMIT TO DRILL, DEEPEN, OR PLUG BACK

1a. TYPE OF WORK DRILL <input checked="" type="checkbox"/> DEEPEN <input type="checkbox"/> PLUG BACK <input type="checkbox"/>		5. LEASE DESIGNATION AND SERIAL NO. SF 077980-A
b. TYPE OF WELL OIL WELL <input type="checkbox"/> GAS WELL <input checked="" type="checkbox"/> OTHER <input type="checkbox"/> SINGLE ZONE <input checked="" type="checkbox"/> MULTIPLE ZONE <input type="checkbox"/>		6. IF INDIAN, ALLOTTEE OR TRIBE NAME
2. NAME OF OPERATOR El Paso Natural Gas Company		7. UNIT AGREEMENT NAME Huerfano Unit
3. ADDRESS OF OPERATOR PO Box 990, Farmington, NM 87401		8. FARM OR LEASE NAME Huerfano Unit 7139
4. LOCATION OF WELL (Report location clearly and in accordance with any State requirements.)* At surface 1090'N, 1550'W At proposed prod. zone		9. WELL NO. 237
14. DISTANCE IN MILES AND DIRECTION FROM NEAREST TOWN OR POST OFFICE*		10. FIELD AND POOL, OR WILDCAT Angel Peak Gallup
15. DISTANCE FROM PROPOSED* LOCATION TO NEAREST PROPERTY OR LEASE LINE, FT. (Also to nearest drilg. unit line, if any)		11. SEC., T., R., M., OR R.L.K. AND SURVEY OR AREA Sec. 17, T-26-N, R-9-W NMPM
16. NO. OF ACRES IN LEASE		12. COUNTY OR PARISH 13. STATE San Juan New Mexico
17. NO. OF ACRES ASSIGNED TO THIS WELL 320.00		18. DISTANCE FROM PROPOSED LOCATION* TO NEAREST WELL, DRILLING, COMPLETED, OR APPLIED FOR, ON THIS LEASE, FT.
19. PROPOSED DEPTH 6046'		20. ROTARY OR CABLE TOOLS Rotary
21. ELEVATIONS (Show whether DF, RT, GR, etc.) 6476'GL		22. APPROX. DATE WORK WILL START*
23. PROPOSED CASING AND CEMENTING PROGRAM		

SIZE OF HOLE	SIZE OF CASING	WEIGHT PER FOOT	SETTING DEPTH	QUANTITY OF CEMENT
12 1/4"	8 5/8"	24.0#	200'	176 cu. ft. to circulate
7 7/8"	4 1/2"	10.5#	6046'	1148 cu. ft. - 2 stages

Production Casing cement:

1st stage - 796 cu. ft. to cover Mesa Verde formation.

2nd stage - 352 cu. ft. to fill to base of Ojo Alamo.

Selectively perforate and sandwater fracture the Gallup formation.

The W/2 of Section 17 is dedicated to this well.

IN ABOVE SPACE DESCRIBE PROPOSED PROGRAM: If proposal is to deepen or plug back, give pertinent data on present productive zone and proposed new productive zone. If proposal is to drill or deepen directionally, give pertinent data on surface locations and measured and true vertical depths. Give blowout preventer program, if any.

24. SIGNED [Signature] TITLE Petroleum Engineer DATE January 31, 1973

(This space for Federal or State office use)

PERMIT NO. _____ APPROVAL DATE _____

APPROVED BY [Signature] TITLE _____ DATE _____

CONDITIONS OF APPROVAL, IF ANY:

*See Instructions On Reverse Side

NEW MEXICO OIL CONSERVATION COMMISSION
WELL LOCATION AND ACREAGE DEDICATION PLAT

Form O-128
Supersedes C-128
Effective 1-1-65

All distances must be from the outer boundaries of the Section

EL PASO NATURAL GAS COMPANY			HUERFANO UNIT (SF-077980-A)		Well No. 237
Section	Range	Township	Range	County	
C	17	26-N	9-W	SAN JUAN	
Acres 1090		NORTH		1550 WEST	
6476		GALLUP		ANGEL PEAK GALLUP 320.00	

1. Outline the acreage dedicated to the subject well by colored pencil or hachure marks on the plat.
2. If more than one lease is dedicated to the well, outline each and identify the ownership thereof (both as to working interest and royalty).
3. If more than one lease of different ownership is dedicated to the well, have the interests of all owners been consolidated by communitization, unitization, force-pooling, etc?

☒ Yes ☐ No If answer is "yes" type of consolidation _____

If answer is "no," list the owners and tract descriptions which have actually been consolidated. (Use reverse side of this form if necessary.) _____

No allowable will be assigned to the well until all interests have been consolidated (by communitization, unitization, forced-pooling, or otherwise) or until a non-standard unit, eliminating such interests, has been approved by the Commission. **NOTE: THIS PLAT REISSUED TO SHOW PROPER POOL DESIGNATION. 1-30-73**

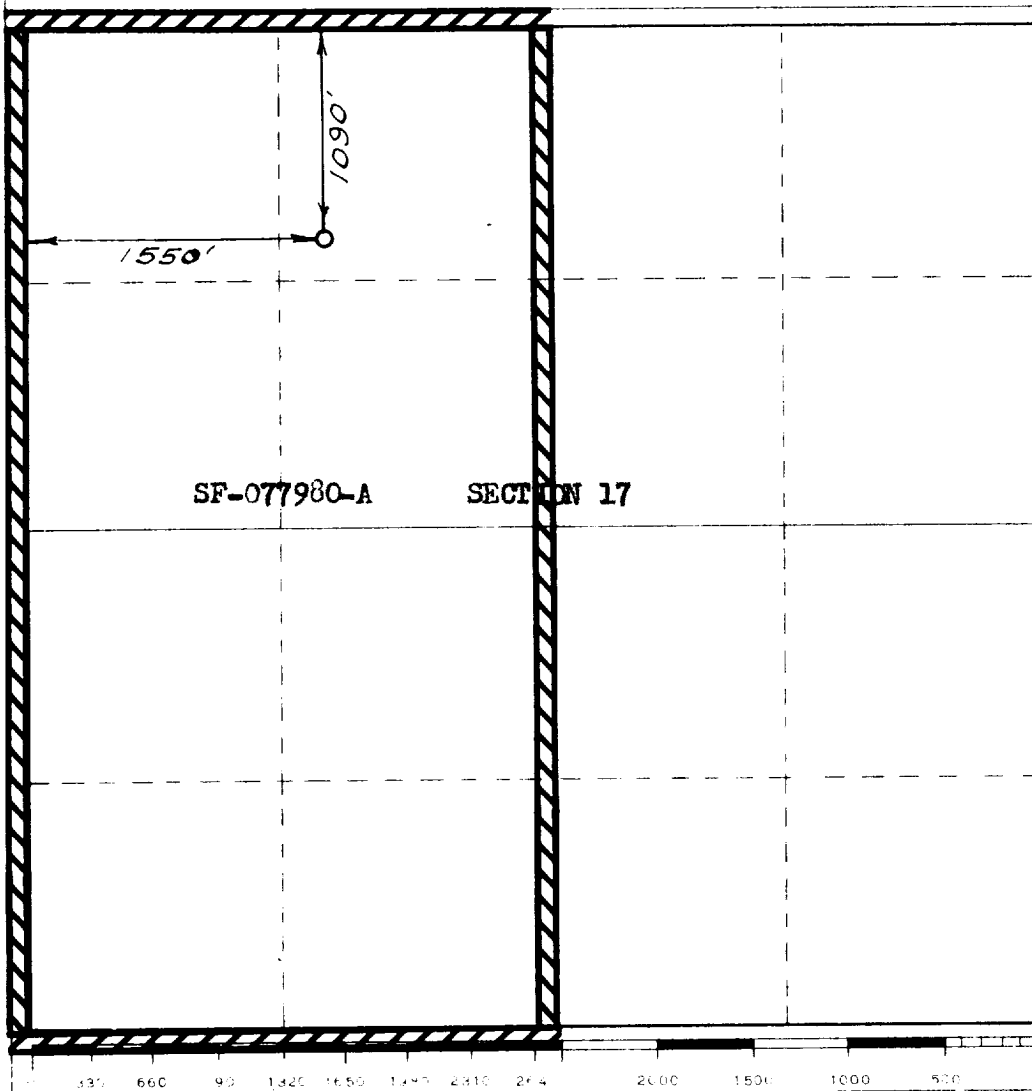
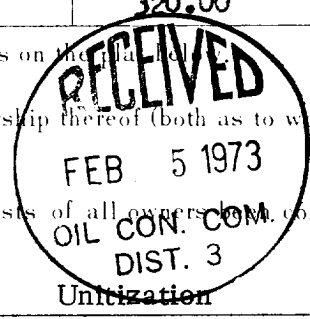

CERTIFICATION

I hereby certify that the information contained herein is true and complete to the best of my knowledge and belief.

Original Signed F. H. WOOD

Name: _____
Petroleum Engineer
Location: _____
El Paso Natural Gas Co.
Date: _____
January 31, 1973

I hereby certify that the well location shown on this plat was plotted from field notes of actual surveys made by me or under my supervision, and that the same is true and correct to the best of my knowledge and belief.

Date: _____
JANUARY 15, 1973
Location of well location on the plat: _____
Plotted by: _____
Certificate No. 1760