



STATE OF NEW MEXICO  
ENERGY, MINERALS AND NATURAL RESOURCES DEPARTMENT  
OIL CONSERVATION DIVISION

GARREY CARRUTHERS  
GOVERNOR

POST OFFICE BOX 2088  
STATE LAND OFFICE BUILDING  
SANTA FE, NEW MEXICO 87504  
(505) 827-5800

September 12, 1990

Meridian Oil, Inc.  
P.O. Box 4289  
Farmington, NM 87499-4289

Attention: Peggy Bradfield

**RECEIVED**  
SEP 18 1990  
OIL CON. DIV.  
DIST. 3

*Administrative Order NSL-2859*

Dear Ms. Bradfield:

Reference is made to your application dated August 8, 1990 for a non-standard Basin-Fruitland coal gas well location for your existing Huerfano Unit Well No. 238 which was drilled in 1973 and completed in the Angel Peak Gallup Associated Pool at a standard gas well location 1840 feet from the South line and 890 feet from the East line (Unit I) of Section 18, Township 26 North, Range 9 West, NMPM, San Juan County, New Mexico.

It is my understanding that the Gallup zone will be properly plugged back and said well will be recompleted to the Basin-Fruitland Coal Gas Pool, which pursuant to the Special Rules and Regulations for the Basin-Fruitland Coal Gas Pool as promulgated by Division Order No. R-8768, is unorthodox. Further, the E/2 of said Section 18 shall be dedicated to the well forming a standard 320-acre gas spacing and proration unit for said pool.

By the authority granted me under the provisions of Rule 8 of said Division Order No. R-8768, the above-described unorthodox coal gas well location is hereby approved.

Sincerely,

William J. LeMay  
Director

WJL/MES/ag

cc: Oil Conservation Division - Aztec  
US Bureau of Land Management - Farmington



STATE OF NEW MEXICO  
ENERGY AND MINERALS DEPARTMENT  
OIL CONSERVATION DIVISION  
AZTEC DISTRICT OFFICE

1000 RIO HUAZOS ROAD  
AZTEC, NEW MEXICO 87410  
(505) 334-6170

ARREY CARRUTHERS  
GOVERNOR

Date: 8-29-90

Oil Conservation Division  
P.O. Box 2088  
Santa Fe, NM 87504-2088

*Walter Stogner*

Re: Proposed MC \_\_\_\_\_  
Proposed DHC \_\_\_\_\_  
Proposed NSL X \_\_\_\_\_  
Proposed SWD \_\_\_\_\_  
Proposed WFX \_\_\_\_\_  
Proposed PMX \_\_\_\_\_

Gentlemen:

I have examined the application dated 8-9-90  
for the Meridian Oil Inc. Huerfano Unit #238  
Operator Lease & Well No.

I-18-26N-9W and my recommendations are as follows:  
Unit, S-T-R

*Approval - after orderly development  
of offshoots shown.*

Yours truly,

*Gene Bush*

# MERIDIAN OIL

August 8, 1990

Federal Express

Mr. William LeMay  
New Mexico Oil Conservation Division  
Post Office Box 2088  
Santa Fe, New Mexico 87503

RE: Huerfano Unit #238  
1840'FSL, 890'FEL  
Section 18, T-26-N, R-09-W  
San Juan, New Mexico

Dear Mr. LeMay:

This is a request for administrative approval for a non-standard gas well location in the Basin Fruitland Pool.

Meridian Oil intends to plugback and recomplete the Huerfano Unit #238 well from the Pictured Cliffs pool to the Basin Fruitland Coal Pool. The current location of this well is 1840'FSL, 890'FEL, Section 18, T-26-N, R-09-W, San Juan, New Mexico. The well is considered non-standard due to the NE-SW dedicated pattern established for the Basin Fruitland Coal Pool. To comply with the New Mexico Oil Conservation Division rules, Meridian is submitting the following for your approval of this non-standard location:

1. C-102 plat showing location of the well;
2. Plat showing offset owners/operators;
3. Copy of Well Completion Log for original completion.

All surrounding lands are located within the Huerfano Unit boundaries - El Paso Natural Gas Co. is the operator.

Sincerely yours,



Peggy Bradfield  
encl.

**RECEIVED**  
AUG 09 1990  
OIL CON. DIV.  
DIST. 3

UNITED STATES  
DEPARTMENT OF THE INTERIOR  
GEOLOGICAL SURVEY

SUBMIT IN DUPLICATE

(See other in-  
structions on  
reverse side)Form approved.  
Budget Bureau No. 42-R355.5.

## WELL COMPLETION OR RECOMPLETION REPORT AND LOG \*

<b>1a. TYPE OF WELL:</b> OIL WELL <input type="checkbox"/> GAS WELL <input checked="" type="checkbox"/> DRY <input type="checkbox"/> Other _____				<b>5. LEASE DESIGNATION AND SERIAL NO.</b> SF 078000-A			
<b>1. TYPE OF COMPLETION:</b> NEW WELL <input checked="" type="checkbox"/> WORK OVER <input type="checkbox"/> DEEP-EN <input type="checkbox"/> PLUG BACK <input type="checkbox"/> DIFF. RESVR. <input type="checkbox"/> Other _____				<b>6. IF INDIAN, ALLOTTEE OR TRIBE NAME</b>			
<b>2. NAME OF OPERATOR</b> El Paso Natural Gas Company				<b>7. UNIT AGREEMENT NAME</b> Huerfano Unit			
<b>3. ADDRESS OF OPERATOR</b> PO Box 990, Farmington, NM 87401				<b>8. FARM OR LEASE NAME</b> Huerfano Unit			
<b>4. LOCATION OF WELL (Report location clearly and in accordance with any State requirements)*</b> At surface 1840'S, 890'E At top prod. interval reported below At total depth				<b>9. WELL NO.</b> 238			
<b>14. PERMIT NO.</b> _____ <b>DATE ISSUED</b> _____				<b>10. FIELD AND POOL, OR WILDCAT</b> Angel Peak Gallup Ext.			
<b>15. DATE DRILLED</b> 4-5-73 <b>16. DATE T.D. REACHED</b> 4-15-73 <b>17. DATE COMPL. (Ready to prod.)</b> 6-13-73 <b>18. ELEVATIONS (DF, REB, RT, GR, ETC.)*</b> 6469'GL <b>19. ELEV. CASINGHEAD</b>				<b>11. SEC., T., R., M., OR BLOCK AND SURVEY OR AREA</b> Sec. 18, T-26-N, R-9-W NMPM			
<b>20. TOTAL DEPTH, MD &amp; TVD</b> 5995' <b>21. PLUG, BACK T.D., MD &amp; TVD</b> 5978' <b>22. IF MULTIPLE COMPL., HOW MANY*</b> _____ <b>23. INTERVALS DRILLED BY</b> _____ <b>ROTARY TOOLS</b> 0-5995' <b>CABLE TOOLS</b>				<b>12. COUNTY OR PARISH</b> San Juan <b>13. STATE</b> New Mexico			
<b>24. PRODUCING INTERVAL(S), OF THIS COMPLETION—TOP, BOTTOM, NAME (MD AND TVD)*</b> 5638-5928'(Gallup)				<b>25. WAS DIRECTIONAL SURVEY MADE</b> no			
<b>26. TYPE ELECTRIC AND OTHER LOGS RUN</b> IEL; CDL-GR; Temp. Survey				<b>27. WAS WELL CORED</b> no			
<b>28. CASING RECORD (Report all strings set in well)</b>							
CASING SIZE		WEIGHT, LB./FT.	DEPTH SET (MD)	HOLE SIZE	CEMENTING RECORD	AMOUNT PULLED	
8 5/8"		24.0#	232'	12 1/4"	182 cu. ft.		
4 1/2"		10.5#	5995'	7 7/8"	1146 cu. ft.		
<b>29. LINER RECORD</b>						<b>30. TUBING RECORD</b>	
SIZE	TOP (MD)	BOTTOM (MD)	SACKS CEMENT*	SCREEN (MD)	SIZE	DEPTH SET (MD)	PACKER SET (MD)
					2 3/8"	5936'	
<b>31. FERTIGATION RECORD (Interval, size and number)</b> 5638-50', 5702-14', 5752-64', 5816-28', 5846-54', 5920-28' with 2 shots per zone.				<b>32. ACID, SHOT, FRACTURE, CEMENT SQUEEZE, ETC.</b>			
				DEPTH INTERVAL (MD)			AMOUNT AND KIND OF MATERIAL USED
				5638-5928'			64,000#sand; 33,800 gal. water
<b>33.* PRODUCTION</b>							
DATE FIRST PRODUCTION		PRODUCTION METHOD (Flowing, gas lift, pumping—size and type of pump)				WELL STATUS (Producing or shut-in)	
		flowing				shut in	
DATE OF TEST	HOURS TESTED	CHOKE SIZE	PROD'N. FOR TEST PERIOD	OIL—BBL.	GAS—MCF.	WATER—BBL.	GAS-OIL RATIO
6-13-73	3	3/4"	→	8			
FLOW. TUBING PRESS.	CASING PRESSURE	CALCULATED 24-HOUR RATE	OIL—BBL.	GAS—MCF.	WATER—BBL.	OIL GRAVITY-API (CORR.)	
SI 726	SI 834	→		306 MCF/D-AOF		34.2°	
<b>34. DISPOSITION OF GAS (Sold, used for fuel, vented, etc.)</b>						<b>TEST WITNESSED BY</b> B. J. Broughton	
<b>35. LIST OF ATTACHMENTS</b>							
<b>36. I hereby certify that the foregoing and attached information is complete and correct as determined from all available records</b>							
SIGNED <u>A. B. Dineen</u>		TITLE <u>Drilling Clerk</u>			DATE <u>June 21, 1973</u>		

\*(See Instructions and Spaces for Additional Data on Reverse Side)

EL PASO NATURAL GAS COMPANY

Well Name Huerfano Unit #238

Footage 1840' FSL; 890' FEL

APPLICATION FOR NON-STANDARD LOCATION

County San Juan State New Mexico Section 18 Township 26N Range 9W

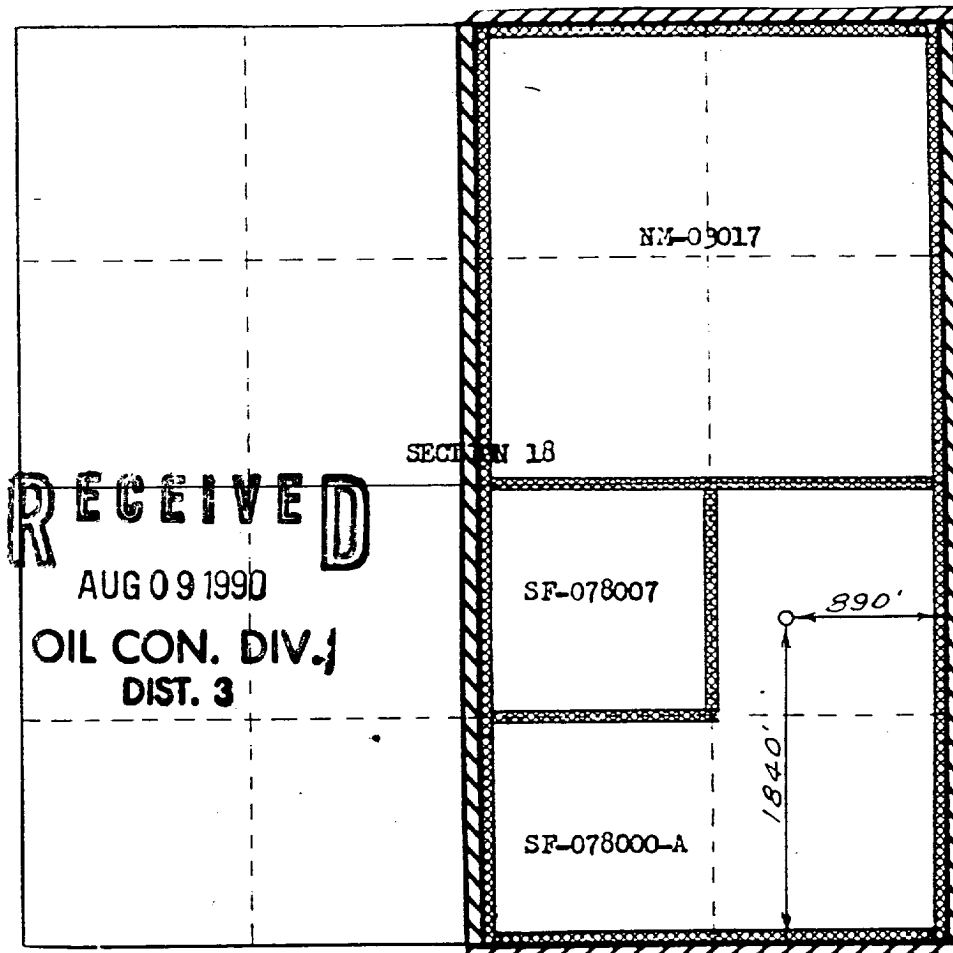

Remarks All surrounding land are located within the Huerfano Unit  
Boundries  
El Paso Natural Gas Co., Operator

NEW MEXICO OIL CONSERVATION COMMISSION  
WELL LOCATION AND ACREAGE DEDICATION PLAT

Form O-128  
Supersedes O-128  
Effective 1-1-65

All distances must be from the outer boundaries of the Section

EL PASO NATURAL GAS COMPANY			HUERFANO UNIT (SF-078000-A)		Well No. 238
I	18	26-N	9-W	SAN JUAN	
1840	SOUTH		390	EAST	
6469	Fruitland Coal		Basin	320.00 Acres	

- Outline the acreage dedicated to the subject well by colored pencil or hatchure marks on the plat below.
- If more than one lease is dedicated to the well, outline each and identify the ownership thereof (both as to working interest and royalty).
- If more than one lease of different ownership is dedicated to the well, have the interests of all owners been consolidated by communitization, unitization, force-pooling, etc?

☒ Yes    ☐ No    If answer is "yes," type of consolidation Unitization

If answer is "no," list the owners and tract descriptions which have actually been consolidated. (Use reverse side of this form if necessary.) \_\_\_\_\_

No allowable will be assigned to the well until all interests have been consolidated (by communitization, unitization, forced-pooling, or otherwise) or until a non-standard unit, eliminating such interests, has been approved by the Commission. **NOTE: THIS PLAT REISSUED TO SHOW PROPER POOL DESIGNATION. 1-30-73**

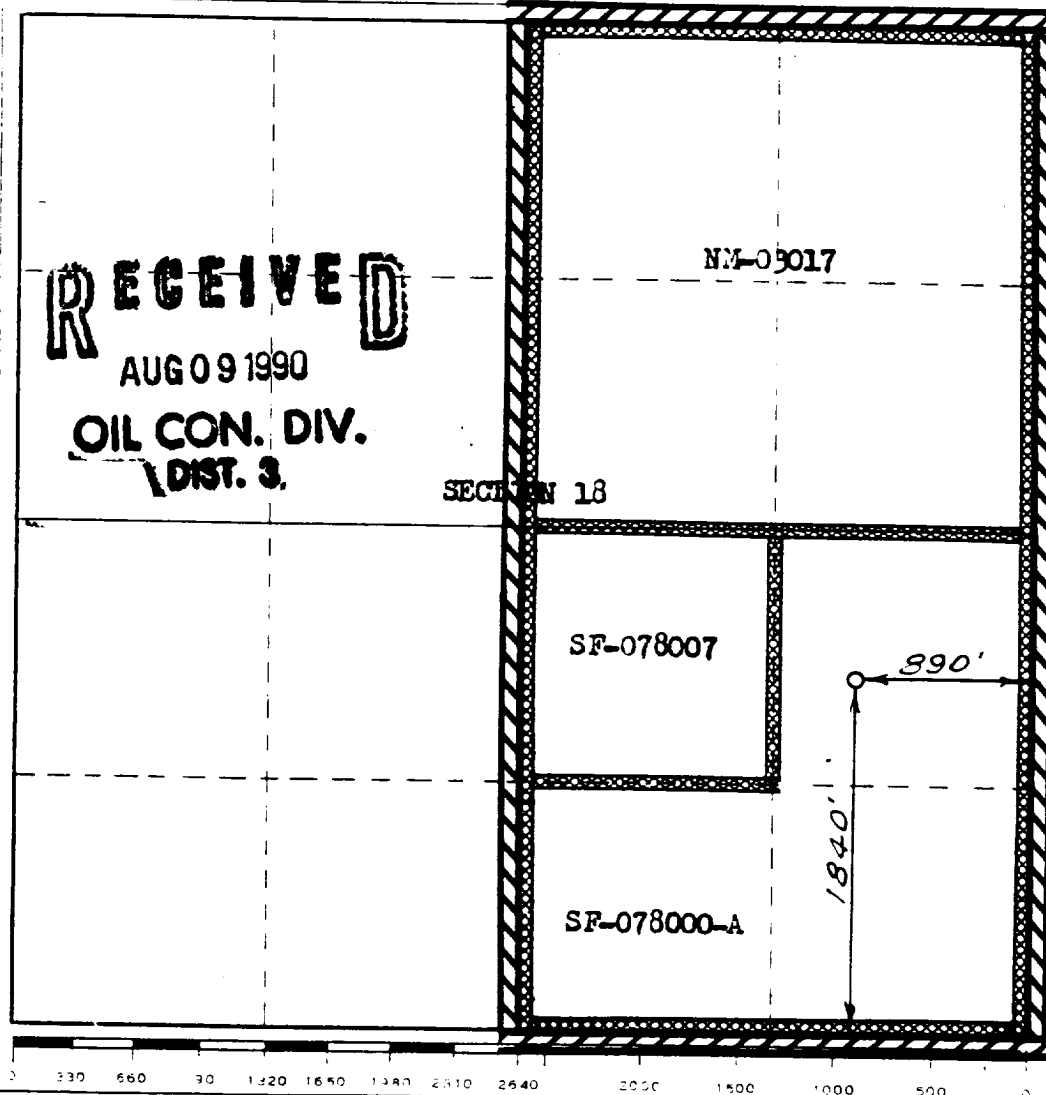

**CERTIFICATION**

I hereby certify that the information contained herein is true and complete to the best of my knowledge and belief.

Regulatory Affairs

El Paso Natural Gas Co.

I hereby certify that the well location shown on this plat was plotted from field notes of actual surveys made by me or under my supervision, and that the same is true and correct to the best of my knowledge and belief.

JANUARY 19, 1973

Surveyor

*David Wilson*  
1760