

UNITED STATES
DEPARTMENT OF THE INTERIOR
GEOLOGICAL SURVEY

APPLICATION FOR PERMIT TO DRILL, DEEPEN, OR PLUG BACK

1a. TYPE OF WORK

DRILL ☒DEEPEN ☐PLUG BACK ☐

b. TYPE OF WELL

OIL
WELL ☒GAS
WELL ☐

OTHER

SINGLE
ZONE ☐MULTIPLE
ZONE ☐

2. NAME OF OPERATOR

AMOCO PRODUCTION COMPANY

3. ADDRESS OF OPERATOR

501 Airport Drive, Farmington, New Mexico 87401

4. LOCATION OF WELL (Report location clearly and in accordance with any State requirements.)*

At surface

810' FSL & 660' FEL, Section 21, T-26-N, R-18-W

At proposed prod. zone

Same

14. DISTANCE IN MILES AND DIRECTION FROM NEAREST TOWN OR POST OFFICE*

23 miles south of Shiprock, New Mexico

15. DISTANCE FROM PROPOSED*

LOCATION TO NEAREST
PROPERTY OR LEASE LINE, FT.
(Also to nearest drlg. unit line, if any)

660'

16. NO. OF ACRES IN LEASE

2544.50

18. DISTANCE FROM PROPOSED LOCATION*

TO NEAREST WELL, DRILLING, COMPLETED,
OR APPLIED FOR, ON THIS LEASE, FT.

1300'

19. PROPOSED DEPTH

6450'

17. NO. OF ACRES ASSIGNED
TO THIS WELL

160

20. ROTARY OR CABLE TOOLS

Rotary

21. ELEVATIONS (Show whether DF, RT, GR, etc.)

5653' ungraded ground level

22. APPROX. DATE WORK WILL START*

November 1973

23.

PROPOSED CASING AND CEMENTING PROGRAM

SIZE OF HOLE	SIZE OF CASING	WEIGHT PER FOOT	SETTING DEPTH	QUANTITY OF CEMENT
17-1/4"	13-3/8"	48.2	100'	100 sx
12-1/4"	9-5/8"	32.3#	1500'	500 sx
8-3/4"	7"	20# & 23#	6450'	500 sx

Amoco Production Company proposes to drill the subject well to test the Pennsylvanian Formation. Intermediate casing will be set across the Morrison water zones. The well will then be drilled through the Pennsylvanian and completion designed from open hole logs. A copy of all logs will be furnished to your office upon completion.

A copy of the Location Plat is attached.

This well will be drilled as a "tight hole." Please hold all information confidential until released by Amoco Production Company.

CONFIDENTIAL

IN ABOVE SPACE DESCRIBE PROPOSED PROGRAM: If proposal is to deepen or plug back, give data on present productive zone and proposed new productive zone. If proposal is to drill or deepen directionally, give pertinent data on subsurface locations and measured and true vertical depths. Give blowout preventer program, if any.

24.

Original Signed by

J. ARNOLD SHULL

SIGNED

TITLE Area Engineer

DATE November 1, 1973

(This space for Federal or State office use)

PERMIT NO.

APPROVAL DATE

APPROVED BY

TITLE

CONDITIONS OF APPROVAL, IF ANY:

NOV 2 1973

*See Instructions On Reverse Side

Instructions

General: This form is designed for submitting proposals to perform certain well operations, as indicated, on all types of lands and leases for appropriate action by either a Federal or a State agency, or both, pursuant to applicable Federal and/or State laws and regulations. Any necessary special instructions concerning the use of this form and the number of copies to be submitted, particularly with regard to local, area, or regional procedures and practices, either are shown below or will be issued by, or may be obtained from, the local Federal and/or State office.

Item 1: If the proposal is to redrill to the same reservoir at a different subsurface location or to a new reservoir, use this form with appropriate notations. Consult applicable State or Federal regulations concerning subsequent work proposals or reports on the well.

Item 4: If there are no applicable State requirements, locations on Federal or Indian land should be described in accordance with Federal requirements. Consult local State or Federal office for specific instructions.

Item 14: Needed only when location of well cannot readily be found by road from the land or lease description. A plat, or plats, separate or on this reverse side, showing the roads to, and the surveyed location of, the well, and any other required information, should be furnished when required by Federal or State agency offices.

Items 15 and 18: If well is to be, or has been directionally drilled, give distances for subsurface location of hole in any present or objective production zone.

Item 22: Consult applicable Federal or State regulations, or appropriate officials, concerning approval of the proposal before operations are started.

**NEW MEXICO OIL CONSERVATION COMMISSION
WELL LOCATION AND ACERAGE DEDICATION PLAT**

All distances must be from the outer boundaries of the Section

Operator Amoco Production Company			Lease Navajo Tribal "U"		Well No. 18
Unit Letter P	Section 21	Township 26 North	Range 18 West	County San Juan	
Actual Footage Location of Well: <div style="display: flex; justify-content: space-between;"> 810 feet from the South line and 660 feet from the East line </div>					
Ground Level Elev. 5653 est.	Producing Formation Pennsylvanian "D"	Pool Tocito Dome Pennsylvanian "D"	Dedicated Acreage: 160* Acres		

1. Outline the acreage dedicated to the subject well by colored pencil or hatchure marks on the plat below. *Joint with Navajo Tribal "U"
 2. If more than one lease is dedicated to the well, outline each and identify the ownership thereof (both as to working No. interest and royalty),
 3. If more than one lease of different ownership is dedicated to the well, have the interests of all owners been consolidated by communitization, unitization, force-pooling, etc?
- () Yes () No If answer is "yes," type of consolidation

If answer is "no," list the owners and tract descriptions which have actually consolidated. (Use reverse side of this form if necessary.)

No allowable will be assigned to the well until all interests have been consolidated (by communitization, unitization, forced-pooling, or otherwise) or until a non standard unit, eliminating such interests, has been approved by the Commission.

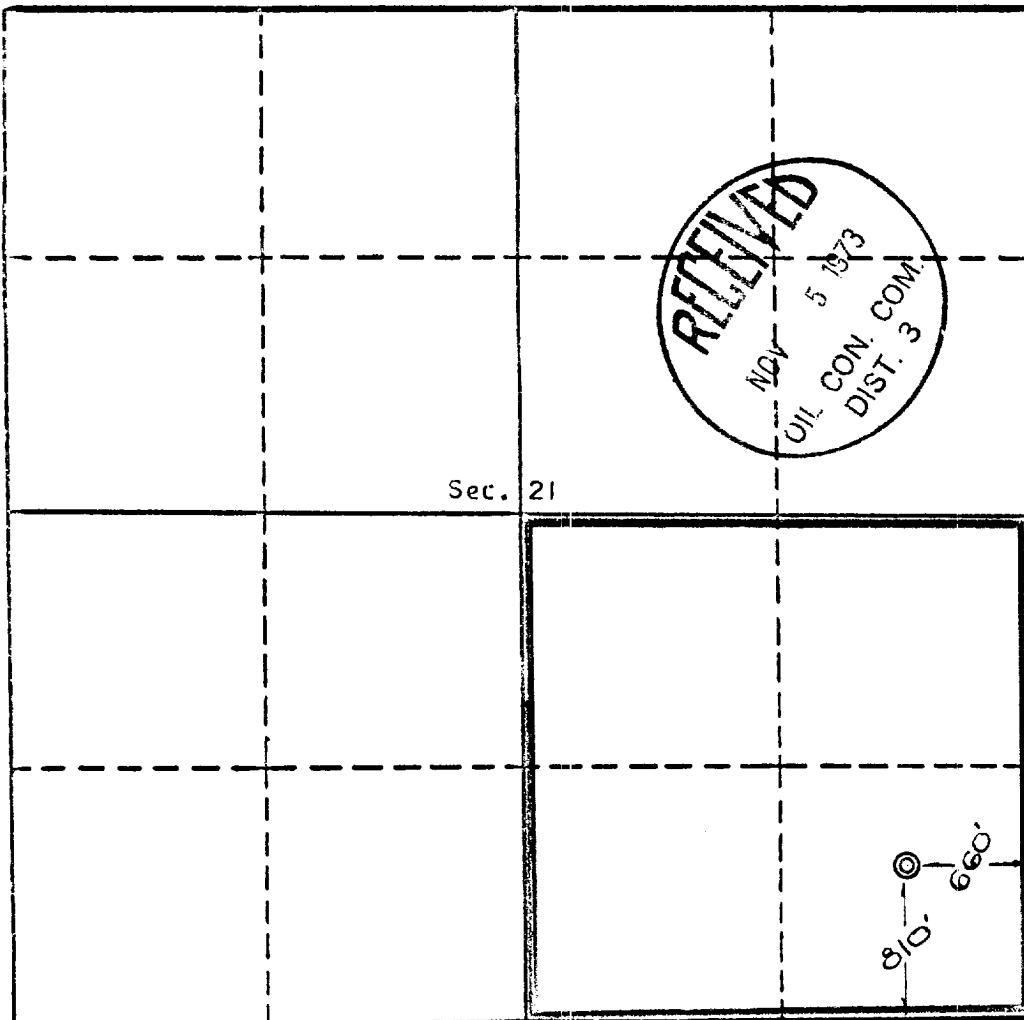

Scale, 1 inch = 1,000 feet

CERTIFICATION

I hereby certify that the information contained herein is true and complete to the best of my knowledge and belief.

J. Arnold Snell
 Name
 J. Arnold Snell
 Position
 Area Engineer
 Company
 AMOCO PRODUCTION COMPANY
 Date
 November 1, 1973

I hereby certify that the well location shown on this plat was plotted from field notes of actual surveys made by me or under my supervision, and that the same is true and correct to the best of my knowledge and belief.

Date Surveyed
 October 30, 1973
 Registered Professional Engineer
 and/or Land Surveyor

E. V. Echohawk
 Certificate No. 3602
 E. V. Echohawk LS

DEVELOPMENT PLAN FOR SURFACE USE
NAVAJO TRIBAL "U" NO. 18
SAN JUAN COUNTY, NEW MEXICO

Amoco Production Company proposes to drill the subject well with rotary tools on a graded location as shown on the attachments. The location is in accordance with NMOCC Order R-2758. Established roads exist in the area and only 1000' of new road will need to be constructed. Archeological clearance to drill this well has been obtained from the proper authorities. Clearance to perform work on this location will also be obtained from the Navajo Tribe.

No airstrips or field camps will be built and none exist nearby. There are no trees in the area and therefore no timber damage will result. Vegetation in the area is extremely sparse and consists primarily of tumbleweed. As the well is located in the middle of an active oil field, Amoco has previously completed a water source well. All water for drilling operations will come from this well. Upon completion of the subject well the location will be thoroughly cleaned and the reserve pit backfilled.



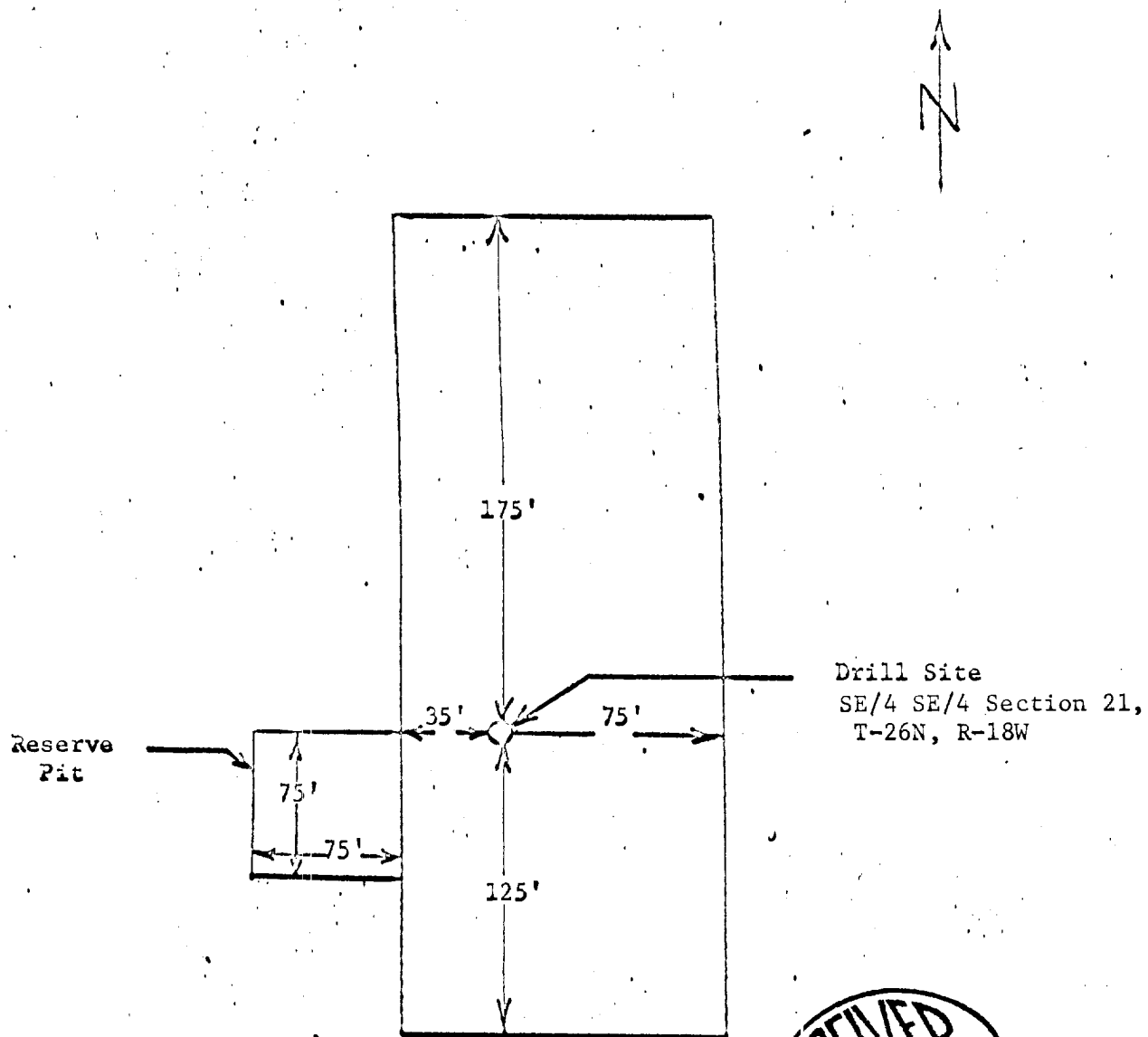

Amoco Production Company	SCALE: None
<p>DRILLING LOCATION DIAGRAM</p> <p>NAVAJO TRIBAL "U" NO. 18 - TOCITO DOME FIELD</p>	<p>DRG. 73-JWC- 1101</p> <p>NO.</p>

R 13 W

NAVAJO INDIAN
RESERVATION

Four
Corner
Pump
Sta

State Hwy
66 S

BLANCA

