

UNITED STATES  
DEPARTMENT OF THE INTERIOR  
GEOLOGICAL SURVEY

30-045-21374

APPLICATION FOR PERMIT TO DRILL, DEEPEN, OR PLUG BACK

1a. TYPE OF WORK  
 DRILL                       DEEPEN                       PLUG BACK

b. TYPE OF WELL  
 OIL WELL                       GAS WELL                       OTHER   
 SINGLE ZONE                       MULTIPLE ZONE

2. NAME OF OPERATOR  
 Lively Exploration Company

3. ADDRESS OF OPERATOR  
 P. O. Box 234, Farmington, New Mexico 87401

4. LOCATION OF WELL (Report location clearly and in accordance with any State requirements.\*)  
 At surface                      900' FNL - 1710' FWL  
  
 At proposed prod. zone

14. DISTANCE IN MILES AND DIRECTION FROM NEAREST TOWN OR POST OFFICE\*  
 23 miles southeast Blanco, New Mexico

15. DISTANCE FROM PROPOSED\* LOCATION TO NEAREST PROPERTY OR LEASE LINE, FT. (Also to nearest drlg. unit line, if any)                      900'

16. NO. OF ACRES IN LEASE  
 —

17. NO. OF ACRES ASSIGNED TO THIS WELL  
 320

18. DISTANCE FROM PROPOSED LOCATION\* TO NEAREST WELL, DRILLING, COMPLETED, OR APPLIED FOR, ON THIS LEASE, FT.                      2000' est.

19. PROPOSED DEPTH  
 6725'

20. ROTARY OR CABLE TOOLS  
 Rotary

21. ELEVATIONS (Show whether DF, RT, GR, etc.)  
 6188' GR

22. APPROX. DATE WORK WILL START\*  
 12-20-73

23. PROPOSED CASING AND CEMENTING PROGRAM

| SIZE OF HOLE | SIZE OF CASING | WEIGHT PER FOOT | SETTING DEPTH | QUANTITY OF CEMENT    |
|--------------|----------------|-----------------|---------------|-----------------------|
| 12-1/4"      | 8-5/8"         | 24#             | 250'          | 175 sx                |
| 7-7/8"       | 4-1/2"         | 10.5#           | 6725'         | 900 cu ft in 2 stages |

Drill well with mud to test Dakota formation, log well, run 4-1/2" casing, cement casing with 900 cu ft cement in two stages, selectively perforate, sand-water frac with 60,000# sand, clean out after frac, run 1-1/4" tubing and complete well.



NOV 6 1973

IN ABOVE SPACE DESCRIBE PROPOSED PROGRAM: If proposal is to deepen or plug back, give data on present productive zone and proposed new productive zone. If proposal is to drill or deepen directionally, give pertinent data on subsurface locations and measured and true vertical depths. Give blowout preventer program, if any.

24. Original signed by T. A. Dugan                      Engineer                      DATE 11-2-73  
 SIGNED Thomas A. Dugan                      TITLE                      DATE  
 (This space for Federal or State office use)

PERMIT NO.                      APPROVAL DATE

APPROVED BY *SM*                      TITLE                      DATE

CONDITIONS OF APPROVAL, IF ANY:

**NEW MEXICO OIL CONSERVATION COMMISSION  
WELL LOCATION AND ACERAGE DEDICATION PLAT**

All distances must be from the outer boundaries of the Section

|   |                                      |                             |                                     |                           |
|---|--------------------------------------|-----------------------------|-------------------------------------|---------------------------|
| Operator<br><b>Lively Exploration Company</b>   |                                      | Lease<br><b>Lively</b>      |                                     | Well No.<br><b>19</b>     |
| Unit Letter<br><b>C</b>   | Section<br><b>12</b>                 | Township<br><b>26 North</b> | Range<br><b>8 West</b>              | County<br><b>San Juan</b> |
| Actual Footage Location of Well:<br><b>900</b> feet from the <b>North</b> line and <b>1710</b> feet from the <b>West</b> line |                                      |                             |                                     |                           |
| Ground Level Elev.<br><b>6188</b>   | Producing Formation<br><b>Dakota</b> | Pool<br><b>Basin</b>        | Dedicated Acreage: <b>320</b> Acres |                           |

1. Outline the acreage dedicated to the subject well by colored pencil or hachure marks on the plat below.
2. If more than one lease is dedicated to the well, outline each and identify the ownership thereof (both as to working interest and royalty),
3. If more than one lease of different ownership is dedicated to the well, have the interests of all owners been consolidated by communitization, unitization, force-pooling, etc?

Yes  No If answer is "yes," type of consolidation .....

If answer is "no," list the owners and tract descriptions which have actually consolidated. (Use reverse side of this form if necessary.) .....

No allowable will be assigned to the well until all interests have been consolidated (by communitization, unitization, forced-pooling, or otherwise) or until a non standard unit, eliminating such interests, has been approved by the Commission.

**CERTIFICATION**

I hereby certify that the information contained herein is true and complete to the best of my knowledge and belief.

Original signed by **T. A. Dugan**

Name  
**Thomas A. Dugan**  
Position  
**Engineer**  
Company  
**Lively Exploration Company**  
Date  
**11-2-73**

I hereby certify that the well location shown on this plat was plotted from field notes of actual surveys made by me or under my supervision, and that the same is true and correct to the best of my knowledge and belief.

Date Surveyed  
**August 9, 1973**  
Registered Professional Engineer  
and/or Land Surveyor

*E. J. Echolaw*  
Certificate No. **3002**  
**E. J. Echolaw LS**

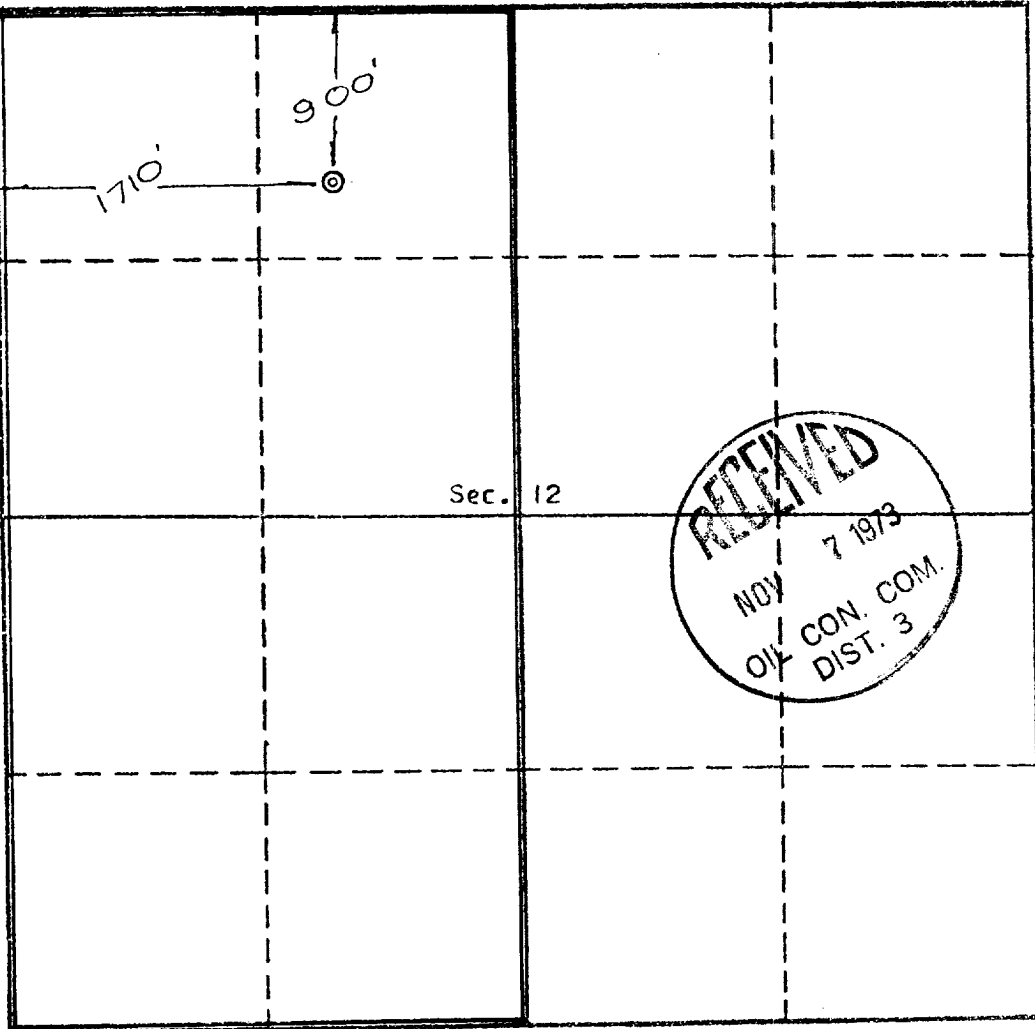
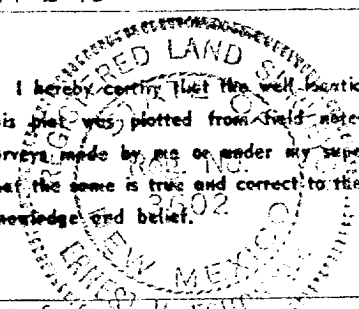
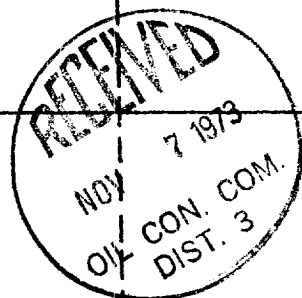

Scale, 1 inch = 1,000 feet