

**NEW MEXICO OIL CONSERVATION COMMISSION  
WELL LOCATION AND ACREAGE DEDICATION PLAT**

Form C-102  
Supersedes C-128  
Effective 1-1-65

All distances must be from the outer boundaries of the Section.

Operator <b>Texaco Inc.</b>			Lease <b>Navajo Tribe "BP"</b>		Well No. <b>4</b>
Unit Letter <b>L</b>	Section <b>35</b>	Township <b>26 North</b>	Range <b>18 West</b>	County <b>San Juan</b>	
Actual Footage Location of Well: <b>2130</b> feet from the <b>South</b> line and <b>510</b> feet from the <b>West</b> line					
Ground Level Elev. <b>5593</b>	Producing Formation <b>Pennsylvanian</b>	Pool <b>Tocito Dome Penn. "D" Ext.</b>		Dedicated Acreage: <b>160</b> Acres	

1. Outline the acreage dedicated to the subject well by colored pencil or hatchure marks on the plat below. *cc*
2. If more than one lease is dedicated to the well, outline each and identify the ownership thereof (both as to working interest and royalty).
3. If more than one lease of different ownership is dedicated to the well, have the interests of all owners been consolidated by communitization, unitization, force-pooling, etc?

☐ Yes   ☐ No   If answer is "yes," type of consolidation \_\_\_\_\_

If answer is "no," list the owners and tract descriptions which have actually been consolidated. (Use reverse side of this form if necessary.) \_\_\_\_\_

No allowable will be assigned to the well until all interests have been consolidated (by communitization, unitization, forced-pooling, or otherwise) or until a non-standard unit, eliminating such interests, has been approved by the Commission.

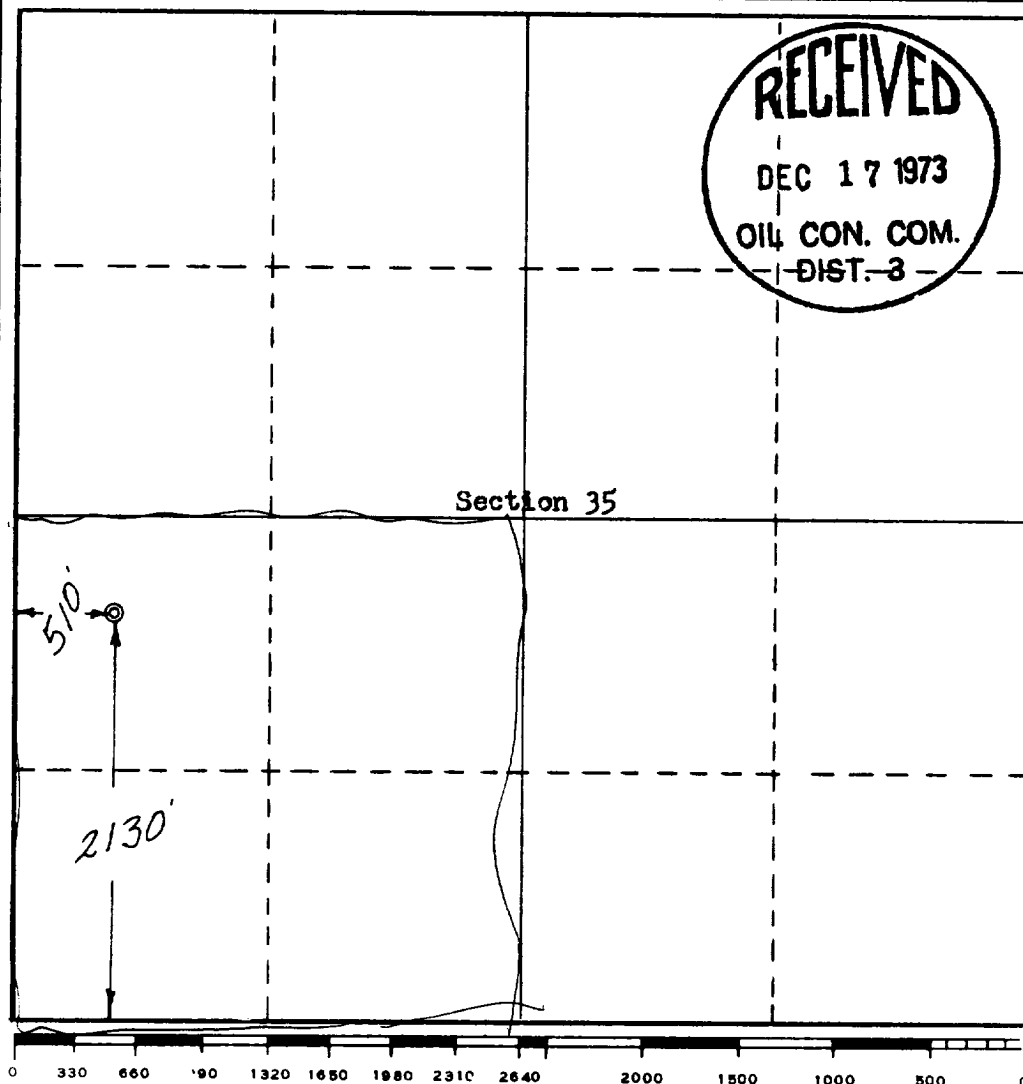

**CERTIFICATION**

I hereby certify that the information contained herein is true and complete to the best of my knowledge and belief.

*Tommie Bliss*

Name  
**Tommie Bliss**

Position  
**District Superintendent**

Company  
**Texaco Inc.**

Date  
**December 13, 1973**

I hereby certify that the well location shown on this plat was plotted from field notes of actual surveys made by me or under my supervision, and that the same is true and correct to the best of my knowledge and belief.

Date Surveyed  
**December 11, 1973**

Registered Professional Engineer and Land Surveyor  
*[Signature]*

Certificate No.  
**3084**

UNITED STATES  
DEPARTMENT OF THE INTERIOR  
GEOLOGICAL SURVEY

30-045-21388

## APPLICATION FOR PERMIT TO DRILL, DEEPEN, OR PLUG BACK

1a. TYPE OF WORK DRILL <input checked="" type="checkbox"/> DEEPEN <input type="checkbox"/> PLUG BACK <input type="checkbox"/>		5. LEASE DESIGNATION AND SERIAL NO. NOO-C-14-20-2727
b. TYPE OF WELL OIL WELL <input checked="" type="checkbox"/> GAS WELL <input type="checkbox"/> OTHER <input type="checkbox"/> SINGLE ZONE <input type="checkbox"/> MULTIPLE ZONE <input type="checkbox"/>		6. IF INDIAN, ALLOTTEE OR TRIBE NAME
2. NAME OF OPERATOR Texaco Inc. Attention: T. Bliss		7. UNIT AGREEMENT NAME
3. ADDRESS OF OPERATOR P. O. Box 2100, Denver, Colorado 80201		8. FARM OR LEASE NAME Navajo Tribe "BP"
4. LOCATION OF WELL (Report location clearly and in accordance with any State requirements.)* At surface NW 1/4 SW 1/4 Sec. 35 At proposed prod. zone 2130' FSL, 510' FWL, Sec. 35		9. WELL NO. 4
14. DISTANCE IN MILES AND DIRECTION FROM NEAREST TOWN OR POST OFFICE*		10. FIELD AND POOL, OR WILDCAT Tocito Dome <i>Perm D est</i>
15. DISTANCE FROM PROPOSED* LOCATION TO NEAREST PROPERTY OR LEASE LINE, FT. (Also to nearest drlg. unit line, if any)	510'	11. SEC., T., R., M., OR BLK. AND SURVEY OR AREA Sec. 35-T26N-R18W
18. DISTANCE FROM PROPOSED LOCATION* TO NEAREST WELL, DRILLING, COMPLETED, OR APPLIED FOR, ON THIS LEASE, FT.	2900'	12. COUNTY OR PARISH San Juan
16. NO. OF ACRES IN LEASE --	17. NO. OF ACRES ASSIGNED TO THIS WELL 160	13. STATE N. Mex.
19. PROPOSED DEPTH 6470'	20. ROTARY OR CABLE TOOLS Rotary	
21. ELEVATIONS (Show whether DF, RT, GR, etc.) 5593' Gr.	22. APPROX. DATE WORK WILL START* 12-18-73	

23. PROPOSED CASING AND CEMENTING PROGRAM				
SIZE OF HOLE	SIZE OF CASING	WEIGHT PER FOOT	SETTING DEPTH	QUANTITY OF CEMENT
17-1/2" New	13-3/8"	48# H-40	100'	Circ to surface
12-1/4" New	9-5/8"	40# K-55	1600'	Circ to surface
8-5/8" New	7"	26# K-55	6470'	Cmt to 600' above pay zone.

Propose to drill subject well to increase oil recovery from Tocito Dome Field. The proposed location is 150' north and 150' west of the center of the quarter-quarter because of unfavorable topographic conditions. Samples will be taken at 10' intervals from 3600' to TD. No cores are planned. A DST is scheduled for the Barker Creek. Logs will be run from surface casing to TD. Prospective zones will be perforated and treated as necessary. Blowout preventer equipment will be as indicated on the attached Exhibit, and will be tested at regular intervals. Necessary steps will be taken to protect the environment.

IN ABOVE SPACE DESCRIBE PROPOSED PROGRAM: If proposal is to deepen or plug back, give data on present productive zone and proposed new productive zone. If proposal is to drill or deepen directionally, give pertinent data on subsurface locations and measured and true vertical depths. Give blowout preventer program, if any.

24. SIGNED *Tommy M. [Signature]* TITLE District Superintendent DATE Dec. 13, 1973

(This space for Federal or State office use)

PERMIT NO. \_\_\_\_\_ APPROVAL DATE \_\_\_\_\_

APPROVED BY *[Signature]* TITLE \_\_\_\_\_ DATE \_\_\_\_\_  
CONDITIONS OF APPROVAL, IF ANY: \_\_\_\_\_USGS (3)  
FarmingtonOGCC (2)  
Aztec

TB ARM CGH The Navajo Tribe

\*See Instructions On Reverse Side

## Instructions

**General:** This form is designed for submitting proposals to perform certain well operations, as indicated, on all types of lands and leases for appropriate action by either a Federal or a State agency, or both, pursuant to applicable Federal and/or State laws and regulations. Any necessary special instructions concerning the use of this form and the number of copies to be submitted, particularly with regard to local, area, or regional procedures and practices, either are shown below or will be issued by, or may be obtained from, the local Federal and/or State office.

**Item 1:** If the proposal is to redrill to the same reservoir at a different subsurface location or to a new reservoir, use this form with appropriate notations. Consult applicable State or Federal regulations concerning subsequent work proposals or reports on the well.

**Item 4:** If there are no applicable State requirements, locations on Federal or Indian land should be described in accordance with Federal requirements. Consult local State or Federal office for specific instructions.

**Item 14:** Needed only when location of well cannot readily be found by road from the land or lease description. A plat, or plats, separate or on this reverse side, showing the roads to, and the surveyed location of, the well, and any other required information, should be furnished when required by Federal or State agency offices.

**Items 15 and 18:** If well is to be, or has been directionally drilled, give distances for subsurface location of hole in any present or objective production zone.

**Item 22:** Consult applicable Federal or State regulations, or appropriate officials, concerning approval of the proposal before operations are started.



PETROLEUM PRODUCTS

PRODUCING DEPARTMENT-  
UNITED STATES  
DENVER DIVISION

December 13, 1973

TEXACO INC.  
P. O. BOX 2100  
DENVER, COLORADO 80201

NAVAJO TRIBE "BP" NO. 4  
NW $\frac{1}{4}$ SW $\frac{1}{4}$  SEC. 35, T26N, R18W  
SAN JUAN COUNTY, NEW MEXICO  
6.34

Mr. P. T. McGrath (3)  
District Engineer  
U. S. Geological Survey  
P. O. Box 959  
Farmington, New Mexico 87401

Dear Mr. McGrath:

As requested by your office, the Surface Use Development Plan for Navajo Tribe "BP" No. 4, San Juan County, New Mexico, is as follows:

1. Existing roads and exit to the location are shown on the attached plat.
2. Approximately one-half of a mile of access road will be required as shown on attached plat. The road surface will be compacted soil.
3. Nearest producing well is located one half mile to the northeast in Section 35.
4. Lateral roads in the vicinity of the location are shown on the attached plat.
5. The flowline for the proposed well will run to an existing battery located 1.7 miles to the northwest of the location (see attached plat).
6. Water for drilling operations will be obtained from the bradenhead annulus of Texaco's Navajo Tribe "AL" No. 2, located 2 miles to the northwest.

7. All waste material will be contained by earthen and steel pits. Earthen pits are to be subsequently backfilled and buried.
8. No separate drill campsites are proposed.
9. There are no FAA registered airstrips in the vicinity of the location.
10. The drillsite location will be laid bare and will be approximately 250' x 300'. Proper grading will be used to control erosion on the location. A plat showing the location and rig layout is attached.
11. All surfaces not used in normal well servicing and maintenance will be cleaned and graded, where necessary.
12. The wellsite is located on flat, sandy, barren ground, with widely scattered clumps of thorn bushes and/or tumbleweeds.

Very truly yours,



Tommie Bliss  
District Superintendent

MDS:WH

Attach

cc: Board of Oil & Gas Conservation  
1000 Rio Brazos Road  
Aztec, New Mexico 87501

1. The first part of the document is a letter from the President of the United States to the Congress.

2. The second part is a report on the state of the Union, prepared by the President.

3. The third part is a report on the state of the Union, prepared by the President.

4. The fourth part is a report on the state of the Union, prepared by the President.

5. The fifth part is a report on the state of the Union, prepared by the President.

6. The sixth part is a report on the state of the Union, prepared by the President.

7. The seventh part is a report on the state of the Union, prepared by the President.

8. The eighth part is a report on the state of the Union, prepared by the President.

9. The ninth part is a report on the state of the Union, prepared by the President.

10. The tenth part is a report on the state of the Union, prepared by the President.

11. The eleventh part is a report on the state of the Union, prepared by the President.

R 18 W

SINCLAIR

T  
27  
N

T  
27  
N

T  
26  
N

T  
26  
N

T  
25  
N

R 18 W

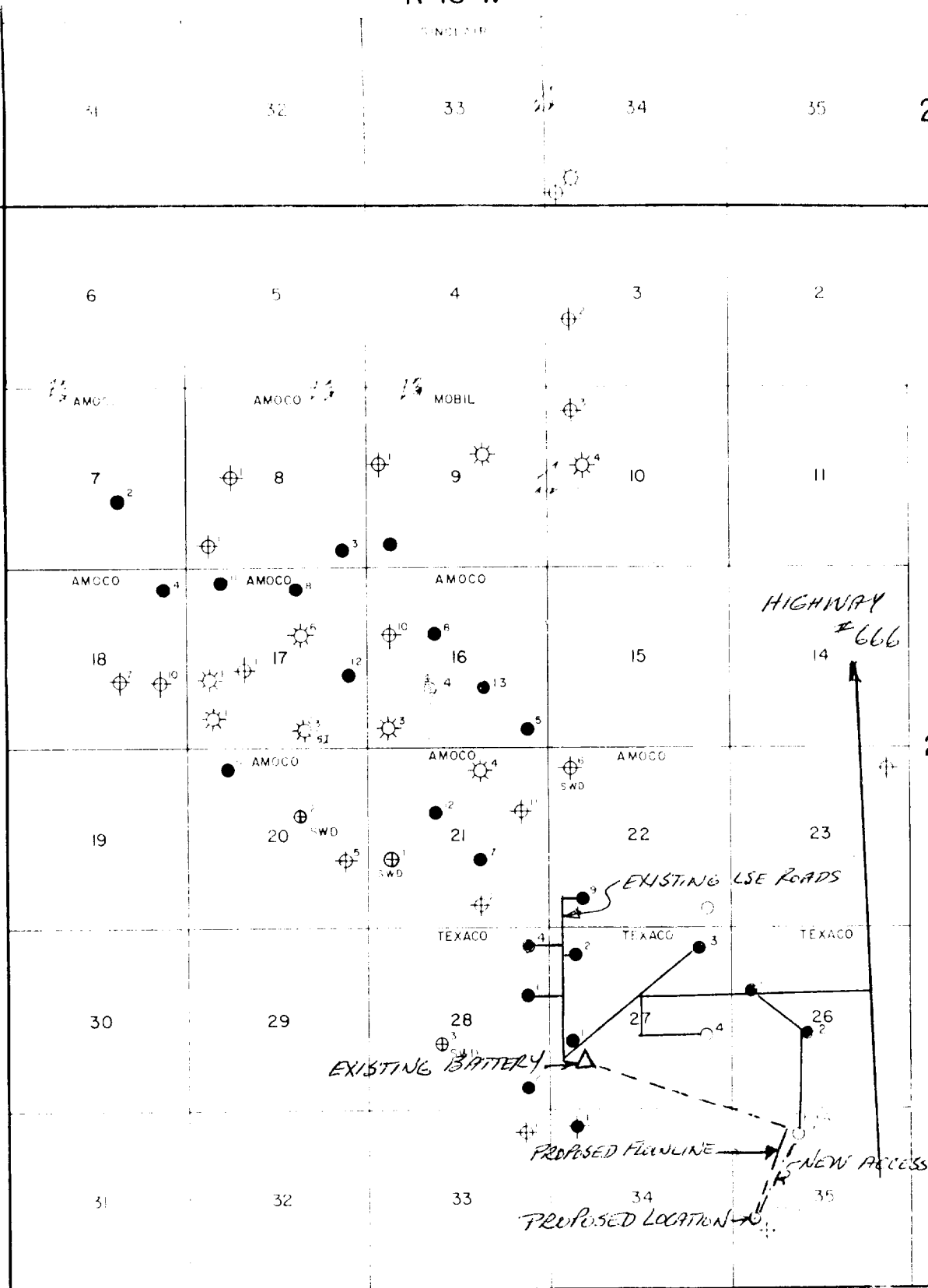

NAVAJO TRIBE "BP" #4

TEXACO INC.  
TOCITO DOME FIELD  
SAN JUAN COUNTY, NEW MEXICO

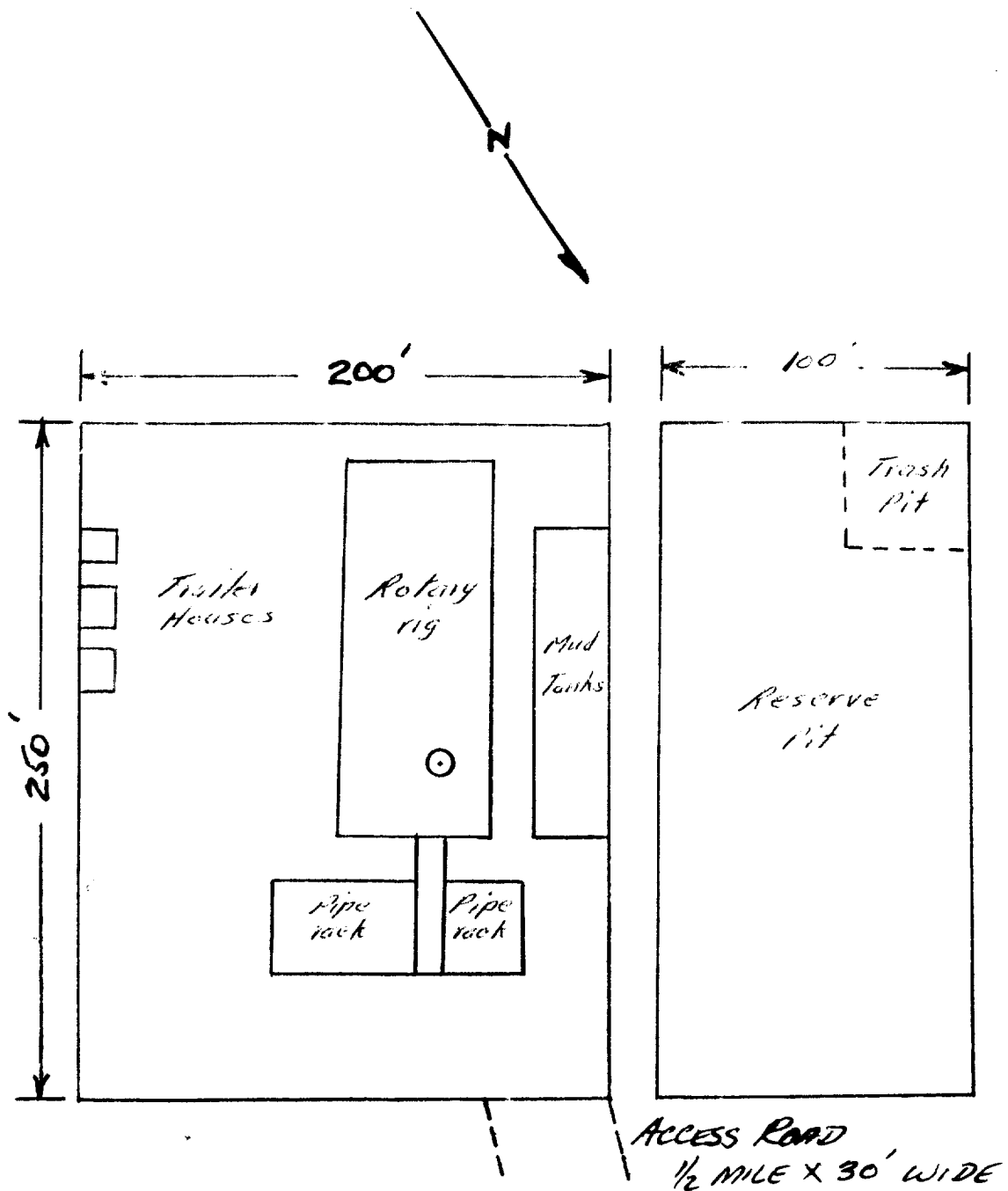

- A. Drilling pad will be compacted soil.
- B. Surface is barren sandy soil with scattered thorn bushes and tumbleweeds.

LOCATION AND RIG LAYOUT

NAVAJO TRIBE "BP" NO. 4

SAN JUAN COUNTY, NEW MEXICO