



*Handwritten initials*

STATE OF NEW MEXICO  
ENERGY, MINERALS AND NATURAL RESOURCES DEPARTMENT  
OIL CONSERVATION DIVISION

GARREY CARRUTHERS  
GOVERNOR

POST OFFICE BOX 2088  
STATE LAND OFFICE BUILDING  
SANTA FE, NEW MEXICO 87504  
(505) 827-5800

August 22, 1990

Meridian Oil, Inc.  
P.O. Box 4289  
Farmington, NM 87499-4289

Attention: Peggy Bradfield

**RECEIVED**

AUG 24 1990

**OIL CON. DIV. 1  
DIST. 3**

*Administrative Order NSL-2849*

Dear Ms. Bradfield:

Reference is made to your application dated June 20, 1990 for a non-standard Basin-Fruitland coal gas well location for your existing Huerfano Unit Well No. 252 which was drilled in 1974 and completed as a gas well in the Angel Peak Gallup Associated Pool 1755 feet from the South line and 1050 feet from the East line (Unit I) of Section 1, Township ~~26~~ North, Range ~~10~~ West, NMPM, San Juan County, New Mexico.

It is my understanding that the Gallup zone will be properly plugged back and said well will be recompleted to the Basin-Fruitland Coal Gas Pool, which pursuant to the Special Rules and Regulations for the Basin-Fruitland Coal Gas Pool as promulgated by Division Order No. R-8768, is unorthodox. Further, Lots 1 and 2, the S/2 NE/4, and SE/4 (E/2 equivalent) of said Section 1 shall be dedicated to the well forming a standard 319.87-acre gas spacing and proration unit for said pool.

By the authority granted me under the provisions of Rule 8 of said Division Order No. R-8768, the above-described unorthodox coal gas well location is hereby approved.

Sincerely,

*Handwritten signature of William J. LeMay*

William J. LeMay  
Director

WJL/MES/ag

cc: Oil Conservation Division - Aztec  
US Bureau of Land Management - Farmington



STATE OF NEW MEXICO  
ENERGY AND MINERALS DEPARTMENT  
OIL CONSERVATION DIVISION  
AZTEC DISTRICT OFFICE

SARREY CARRUTHERS  
GOVERNOR

1000 RIO BRAZOS ROAD  
AZTEC, NEW MEXICO 87410  
(505) 334-0178

Date: 8-21-90

Oil Conservation Division  
P.O. Box 2088  
Santa Fe, NM 87504-2088

ATTN: Jim Morrow

Re: Proposed MC \_\_\_\_\_  
Proposed DHC \_\_\_\_\_  
Proposed NSL X \_\_\_\_\_  
Proposed SWD \_\_\_\_\_  
Proposed WFX \_\_\_\_\_  
Proposed PMX \_\_\_\_\_

Gentlemen:

I have examined the application dated 8-20-90

for the Meridian Oil Inc. - Huerfano Unit #252  
Operator Lease & Well No.

I-1-26N-10W and my recommendations are as follows:  
Unit, S-T-R

Approved  
\_\_\_\_\_  
\_\_\_\_\_  
\_\_\_\_\_  
\_\_\_\_\_  
\_\_\_\_\_

Yours truly,

Ernie Bush

# MERIDIAN OIL

June 20, 1990

Certified Mail

Mr. William LeMay  
New Mexico Oil Conservation Division  
Post Office Box 2088  
Santa Fe, New Mexico 87503

RE: Huerfano Unit #252  
1755'FSL, 1050'FEL  
Section 01, T-26-N, R-10-W  
San Juan County, New Mexico

Dear Mr. LeMay:

This is a request for administrative approval for a non-standard gas well location in the Basin Fruitland Pool.

Meridian Oil intends to plugback and recomplete the Huerfano Unit #252 well from the Pictured Cliffs pool to the Basin Fruitland Coal Pool. The current location of this well is 1755'FSL, 1050'FEL, Section 01, T-26-N, R-10-W, San Juan County, New Mexico. The well is considered non-standard due to the NE-SW dedicated pattern established for the Basin Fruitland Coal Pool. To comply with the New Mexico Oil Conservation Division rules, Meridian is submitting the following for your approval of this non-standard location:

1. C-102 plat showing location of the well;
2. Plat showing offset owners/operators;
3. Copy of Well Completion Log for original completion.

All surrounding lands are located within the Huerfano Unit boundaries - El Paso Natural Gas Company is the operator of this unit.

Sincerely yours,

  
Peggy Bradfield  
encl.

**RECEIVED**  
AUG 20 1990  
OIL CON. DIV.  
DIST. 3

EL PASO NATURAL GAS COMPANY

Well Name Huerfano Unit #252

Footage 1755' FSL; 1050' FEL

APPLICATION FOR NON-STANDARD LOCATION

County San Juan State New Mexico Section 1 Township 26N Range 10W

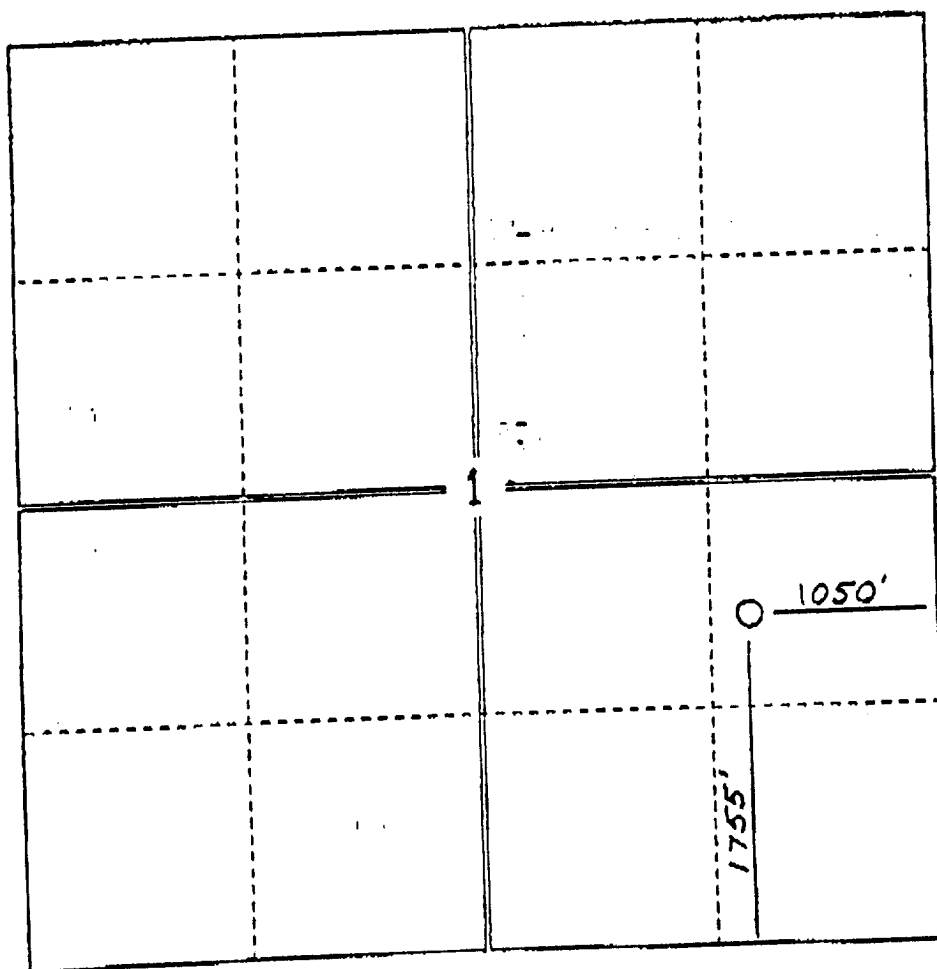

Remarks All surrounding lands are located within the Huerfano Unit boundaries - El  
Paso Natural Gas Company, Operator.

NEW MEXICO OIL CONSERVATION COMMISSION  
WELL LOCATION AND ACREAGE DEDICATION PLAT

Form C-102  
Supersedes C-128  
Effective 1-1-83

All distances must be from the outer boundaries of the Section.

|  |  |   |   |                           |
|--|--|---|---|---------------------------|
| Operator<br><b>EL PASO NATURAL GAS COMPANY</b>   |  | Lease<br><b>HUERFANO UNIT (SF-077936-A)</b> |   | Well No.<br><b>252</b>    |
| Unit Letter<br><b>I</b>  | Section<br><b>1</b>                          | Township<br><b>26-N</b>                     | Range<br><b>10-W</b>                      | County<br><b>SAN JUAN</b> |
| Actual Footage Location of Well:<br><b>1755</b> feet from the <b>SOUTH</b> line and <b>1050</b> feet from the <b>EAST</b> line |  |   |   |                           |
| Ground Level Elev.<br><b>6636</b>  | Producing Formation<br><b>Fruitland Coal</b> | Pool<br><b>Basin</b>                        | Dedicated Acreage:<br><b>319.87</b> Acres |                           |

1. Outline the acreage dedicated to the subject well by colored pencil or hatchure marks on the plat below.
2. If more than one lease is dedicated to the well, outline each and identify the ownership thereof (both as to working interest and royalty).
3. If more than one lease of different ownership is dedicated to the well, have the interests of all owners been consolidated by communitization, unitization, force-pooling, etc?

☒ Yes ☐ No If answer is "yes," type of consolidation Unitization

If answer is "no," list the owners and tract descriptions which have actually been consolidated. (Use reverse side of this form if necessary.)

No allowable will be assigned to the well until all interests have been consolidated (by communitization, unitization, forced-pooling, or otherwise) or until a non-standard unit, eliminating such interests, has been approved by the Commission.

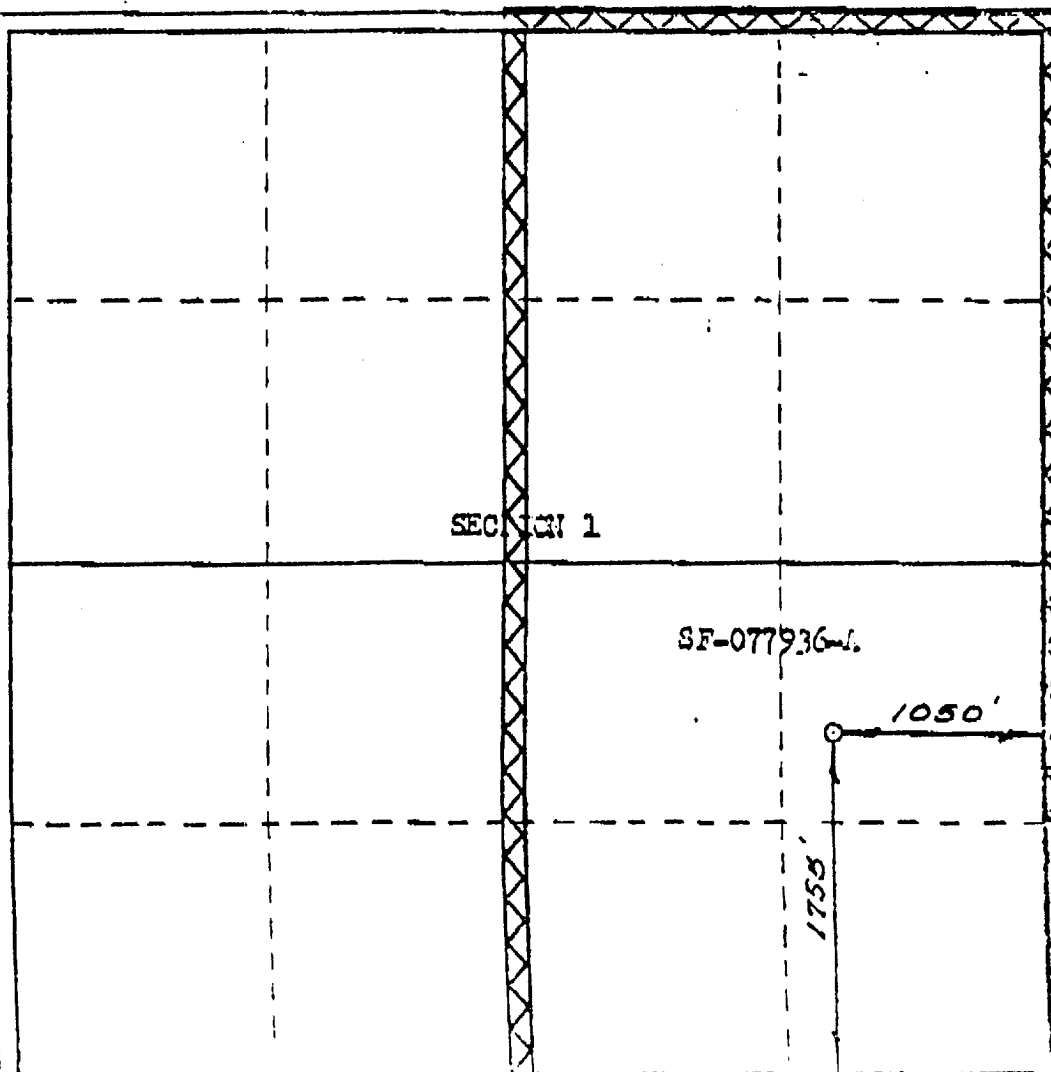

CERTIFICATION

I hereby certify that the information contained herein is true and complete to the best of my knowledge and belief.

Name  
**Peggy Bradfield**  
Position  
**Regulatory Affairs**  
Company  
**El Paso Natural Gas**  
Date

I hereby certify that the well location shown on this plat was plotted from field notes of actual surveys made by me or under my supervision, and that the same is true and correct to the best of my knowledge and belief.

Date Surveyed  
**DECEMBER 10, 1973**

Registered Professional Engineer  
under Board Surveyor

*[Signature]*  
1170

UNITED STATES  
DEPARTMENT OF THE INTERIOR  
GEOLOGICAL SURVEY

SUBMIT IN DUPLICATE\*

(See other instructions on  
reverse side)Form approved,  
Budget Bureau No. 42-R365.6.

## WELL COMPLETION OR RECOMPLETION REPORT AND LOG \*

1. TYPE OF WELL: OIL WELL ☐ GAS WELL ☒ DRY ☐ Other \_\_\_\_\_

2. TYPE OF COMPLETION:

NEW WELL ☒ WORK OVER ☐ DEEP-EN ☐ PLUG BACK ☐ DIFF. REVR. ☐ Other \_\_\_\_\_

3. NAME OF OPERATOR

El Paso Natural Gas Company

4. ADDRESS OF OPERATOR

P. O. Box 990, Ewington, NM 87401

5. LOCATION OF WELL (Report location clearly and in accordance with any State requirements)

At surface

1755'S, 1050'E

At top prod. interval reported below

At total depth

RECEIVED

DEC 11 1974

U. S. GEOLOGICAL SURVEY  
WASHINGTON, D. C.

16. PERMIT NO.

DATE ISSUED

6. LEASE DESIGNATION AND SERIAL NO.

SF077936-A

8. IF INDIAN, ALLOTTEE OR TRIBE NAME

7. UNIT AGREEMENT NAME

Huerfano Unit

9. FARM OR LEASE NAME

Huerfano Unit

9. WELL NO.

252

10. FIELD AND POOL, OR WILDCAT

Angel Peak Gallup

11. SEC., T., R., M., OR BLOCK AND SURVEY OR AREA

Sec. 1, T-26-N, R-10-W  
N.M.P.M.

12. COUNTY OR PARISH

San Juan

13. STATE

New Mexico

15. DATE SPUDDED

03-15-74

16. DATE T.D. REACHED

03-21-74

17. DATE COMPL. (Ready to prod.)

11-25-74

18. ELEVATIONS (OF, RMB, AT, OR, ETC.)\*

6636' GL

19. ELEV. CASINGHEAD

20. TOTAL DEPTH, MD &amp; TVD

6240'

21. PLUG, BACK T.D., MD &amp; TVD

6229'

22. IF MULTIPLE COMPL.,  
HOW MANY\*23. INTERVALS  
DRAILED BY

ROTARY TOOLS

0-6240

CABLE TOOLS

24. PRODUCING INTERVAL(S) OF THIS COMPLETION—TOP, BOTTOM, NAME (MD AND TVD)\*

5900-6168' (GL)

25. WAS DIRECTIONAL  
SURVEY MADE

No

26. TYPE ELECTRIC AND OTHER LOGS RUN

IEL; CDL-GR; Temp. Survey

27. WAS WELL CORED

No

28. CABING RECORD (Report all strings set in well)

| CASING SIZE | WEIGHT, LB./FT. | DEPTH SET (MD) | HOLE SIZE | CEMENTING RECORD | AMOUNT FULLED |
|-------------|-----------------|----------------|-----------|------------------|---------------|
| 8 5/8"      | 24#             | 229'           | 12 1/4"   | 182 cu. ft.      |               |
| 4 1/2"      | 10.5#           | 6240'          | 7 7/8"    | 1128 cu. ft.     |               |
|             |                 |                |           |                  |               |
|             |                 |                |           |                  |               |

29. LINER RECORD

| SIZE | TOP (MD) | BOTTOM (MD) | BACKS CEMENT* | SCREEN (MD) | SIZE   | DEPTH SET (MD) | PACKER SET (MD) |
|------|----------|-------------|---------------|-------------|--------|----------------|-----------------|
|      |          |             |               |             | 2 3/8" | 6161'          |                 |
|      |          |             |               |             |        |                |                 |
|      |          |             |               |             |        |                |                 |

31. PERFORATION RECORD (Interval, size and number)

5900', 5986', 6012', 6072', 6090', 6128',  
6164', 6168' with 1 shot per zone.

32. ACID, SHOT, FRACTURE, CEMENT SQUEEZE, ETC.

| DEPTH INTERVAL (MD) | AMOUNT AND KIND OF MATERIAL USED |
|---------------------|----------------------------------|
| 5900-6168'          | 96,000# sand, 97,272 gal wtr     |
|                     |                                  |
|                     |                                  |

33. PRODUCTION

| DATE FIRST PRODUCTION                                      |                 | PRODUCTION METHOD (Flowing, gas lift, pumping—size and type of pump) |                         |               |            | WELL STATUS (Producing or shut-in) |               |
|--|-----------------|--|-------------------------|---------------|------------|------------------------------------|---------------|
|  |                 | Flowing  |                         |               |            | Shut-In                            |               |
| DATE OF TEST   | HOURS TESTED    | CHOKED SIZE  | PROD'N. FOR TEST PERIOD | OIL—BBL.      | GAS—MCF.   | WATER—BBL.                         | GAS-OIL RATIO |
| 11-25-74   | 3 hours         | 3/4" variable  | →                       |               |            |                                    |               |
| FLOW, TUBING PRESS.  | CASING PRESSURE | CALCULATED 24-HOUR RATE  | OIL—BBL.                | GAS—MCF.      | WATER—BBL. | OIL GRAVITY-API (CORR.)            |               |
| SI 549   | SI 543          | →  |                         | 153 MCF/D-AOF |            |                                    |               |
| 84. DISPOSITION OF GAS (Sold, used for fuel, vented, etc.) |                 |  |                         |               |            |                                    |               |

34. DISPOSITION OF GAS (Sold, used for fuel, vented, etc.)

TEST WITNESSED BY

Norton and Rhames

35. LIST OF ATTACHMENTS

36. I hereby certify that the foregoing and attached information is complete and correct as determined from all available records

SIGNED

D. J. Linares

TITLE

Drilling Clerk

DATE

December 6, 1974

\*(See Instructions and Spaces for Additional Data on Reverse Side)

UNITED STATES  
DEPARTMENT OF THE INTERIOR  
BUREAU OF LAND MANAGEMENT

Sundry Notices and Reports on Wells

|   |   |
|---|---|
| 1. Type of Well<br>GAS  | 5. Lease Number<br>SF-077936A               |
| 2. Name of Operator<br><i>Meridian</i><br><del>El Paso Natural Gas Company</del>          | 6. If Indian, All.or<br>Tribe Name          |
| 3. Address & Phone No. of Operator<br>Box 4289, Farmington, NM 87499 (505) 326-9700       | 7. Unit Agreement Name<br>Huerfano Unit     |
| 4. Location of Well, Footage, Sec, T, R, M.<br>1755'S, 1050'E Sec.1, T-26-N, R-10-W, NMPM | 8. Well Name & Number<br>Huerfano Unit #252 |
|   | 9. API Well No.                             |
|   | 10. Field and Pool<br>Basin Fruitland Coal  |
|   | 11. County and State<br>San Juan County, NM |

12. CHECK APPROPRIATE BOX TO INDICATE NATURE OF NOTICE, REPORT, OTHER DATA

|   |   |
|---|---|
| Type of Submission                                    | Type of Action                                    |
| <input type="checkbox"/> Notice of Intent             | <input type="checkbox"/> Abandonment              |
| <input checked="" type="checkbox"/> Subsequent Report | <input checked="" type="checkbox"/> Recompletion  |
| <input type="checkbox"/> Final Abandonment            | <input checked="" type="checkbox"/> Plugging Back |
|   | <input type="checkbox"/> Casing Repair            |
|   | <input type="checkbox"/> Altering Casing          |
|   | <input type="checkbox"/> Other                    |
|   | <input type="checkbox"/> Change of Plans          |
|   | <input type="checkbox"/> New Construction         |
|   | <input type="checkbox"/> Non-Routine Fracturing   |
|   | <input type="checkbox"/> Water Shut Off           |
|   | <input type="checkbox"/> Conversion to Injection  |

OCT 5 1990  
OIL CON. DIV

13. Describe Proposed or Completed Operations

09-15-90 MOL&RU. Pump 55 BW down well. ND WH. NU BOP. TOOH w/199 jts 2 3/8" tbg. TIH to 6229'. TOOH. SDFN.

09-16-90 TIIH to 6229'. Pump 55 sx Class "B" cmt w/2% calcium chloride. Tbg @ 5735'. Reverse circ 84 bbl 90 mud, obtained 1 bbl. cmt to surface. TOOH w/tbg. WOC. TIH, tag cmt @ 5728'. Perf 4 squeeze holes @ 3950'. TIH w/4 1/2" cmt ret. to 3844'. PT tbg 1600#, ok. Pump 70 sx Class "B" cmt w/2% calcium chloride. Sting out w/1.5 bbl. cmt in tbg. SD for weekend.

09-18-90 Ran GR-CCL-CNL. Set 4 1/2" CIBP @ 2315'. PT csg & BP 1250#/15 min, ok. TIH w/tbg to 2295'. Circ hole w/2% KCl wtr. SDFN.

09-19-90 PT csg & BP 3000#/15 min, ok. Spot 115 gal 15% HCl acid @ 2298'. Pull tbg to 1820'. Swab down to 1500'. TOOH w/tbg. Ran NDT log. Perf 2166-82', 2202-09', 2216-18', 2247-50', 2260-66', 2271-73', 2286-94', and 2298-2303'. TIH w/4 1/2" SPIT tool. Wash perfs w/495 gal. 7.5% HCl acid. TOOH w/tool. Swabbed. SDFN

09-20-90 Swabbed. SDFN.

09-21-90 Swabbed. Ran 73 jts 2 3/8', 4.7#, J-55 8rd EUE tbg landed @ 2274'. SN @ 2241'. ND BOP. NU WH. Released rig.

14. I hereby certify that the foregoing is true and correct

Signed *[Signature]* Title Regulatory Affairs Date 9-21-90

ACCEPTED FOR RECORD

(This space for Federal or State office use)

APPROVED BY \_\_\_\_\_ TITLE \_\_\_\_\_  
CONDITION OF APPROVAL, IF ANY:

OCT 02 1990

DATE

FARMINGTON RESOURCE AREA

BY *[Signature]*