

UNITED STATES
DEPARTMENT OF THE INTERIOR
BUREAU OF LAND MANAGEMENT

APPLICATION FOR PERMIT TO DRILL, DEEPEN, OR PLUG BACK

1a. TYPE OF WORK PLUG BACK	5. LEASE NUMBER SF-077936-A
1b. TYPE OF WELL GAS	6. IF INDIAN, ALL. OR TRIBE NAME
2. OPERATOR EL PASO NATURAL GAS CO.	7. UNIT AGREEMENT NAME HUERFANO UNIT
3. ADDRESS & PHONE NO. OF OPERATOR P.O. BOX 4289 FARMINGTON, NM 87499 (505) 326-9700	8. FARM OR LEASE NAME
4. LOCATION OF WELL 1755' FSL, 1050' FEL	9. WELL NO. 252
14. DISTANCE IN MILES FROM NEAREST TOWN	10. FIELD, POOL, OR WILDCAT BASIN FRUITLAND COAL
	11. SEC. T. R. M OR BLK. SEC. 01, T26N, R10W
15. DISTANCE FROM PROPOSED LOCATION TO NEAREST PROPERTY OR LEASE LINE.	12. COUNTY SAN JUAN
16. ACRES IN LEASE	13. STATE NM
17. ACRES ASSIGNED TO WELL 319.87	
18. DISTANCE FROM PROPOSED LOCATION TO NEAREST WELL DR. COMPL., OR APPLIED FOR ON THIS LEASE.	20. ROTARY OR CABLE TOOLS
21. ELEVATIONS (DF, FT, GR, ETC.) 6636' GL	22. APPROX. DATE WORK WILL START

RECEIVED
AUG 06 1990

OIL CON. DIV

DIST. 3

23. PROPOSED CASING AND CEMENTING PROGRAM

*SEE OPERATIONS PLAN

24. AUTHORIZED BY: Deane Bradfield (SHL)
REGULATORY AFFAIRS

7-24-90
DATE

PERMIT NO. _____ APPROVAL DATE _____

APPROVED BY _____ TITLE _____ DATE _____

NOTE: THIS FORMAT IS ISSUED IN LIEU OF US BLM FORM 3160-3
(NO ADDITIONAL DIRT WORK WILL BE REQUIRED)

APPROVED

JUL 30 1990

FOR AREA MANAGER

Hold C-104 FOR NSL

RECEIVED
JAN 10 1970
U.S. AIR FORCE
HONOLULU, HAWAII

1. The first part of the report is a summary of the work done during the past year. It includes a description of the work done, the results obtained, and a discussion of the work done.

2. The second part of the report is a description of the work done during the past year. It includes a description of the work done, the results obtained, and a discussion of the work done.

NEW MEXICO OIL CONSERVATION COM SION
WELL LOCATION AND ACREAGE DEDICATION PLAT

Form C-102
Supersedes C-128
Effective 1-1-65

All distances must be from the outer boundaries of the Section.

Operator EL PASO NATURAL GAS COMPANY		Lease HUERFANO UNIT (SF-077936-A)		Well No. 252
Unit Letter I	Section 1	Township 26-N	Range 10-N	County SAN JUAN
Actual Footage Location of Well: 1755 feet from the SOUTH line and 1050 feet from the EAST line				
Ground Level Elev. 6636	Producing Formation Fruitland Coal	Pool Basin	Dedicated Acreage: 319.87 Acres	

1. Outline the acreage dedicated to the subject well by colored pencil or hachure marks on the plat below.
2. If more than one lease is dedicated to the well, outline each and identify the ownership thereof (both as to working interest and royalty).
3. If more than one lease of different ownership is dedicated to the well, have the interests of all owners been consolidated by communitization, unitization, force-pooling, etc?

☒ Yes ☐ No If answer is "yes," type of consolidation **Unitization**

If answer is "no," list the owners and tract descriptions which have actually been consolidated. (Use reverse side of this form if necessary.) _____

No allowable will be assigned to the well until all interests have been consolidated (by communitization, unitization, forced-pooling, or otherwise) or until a non-standard unit, eliminating such interests, has been approved by the Commission.

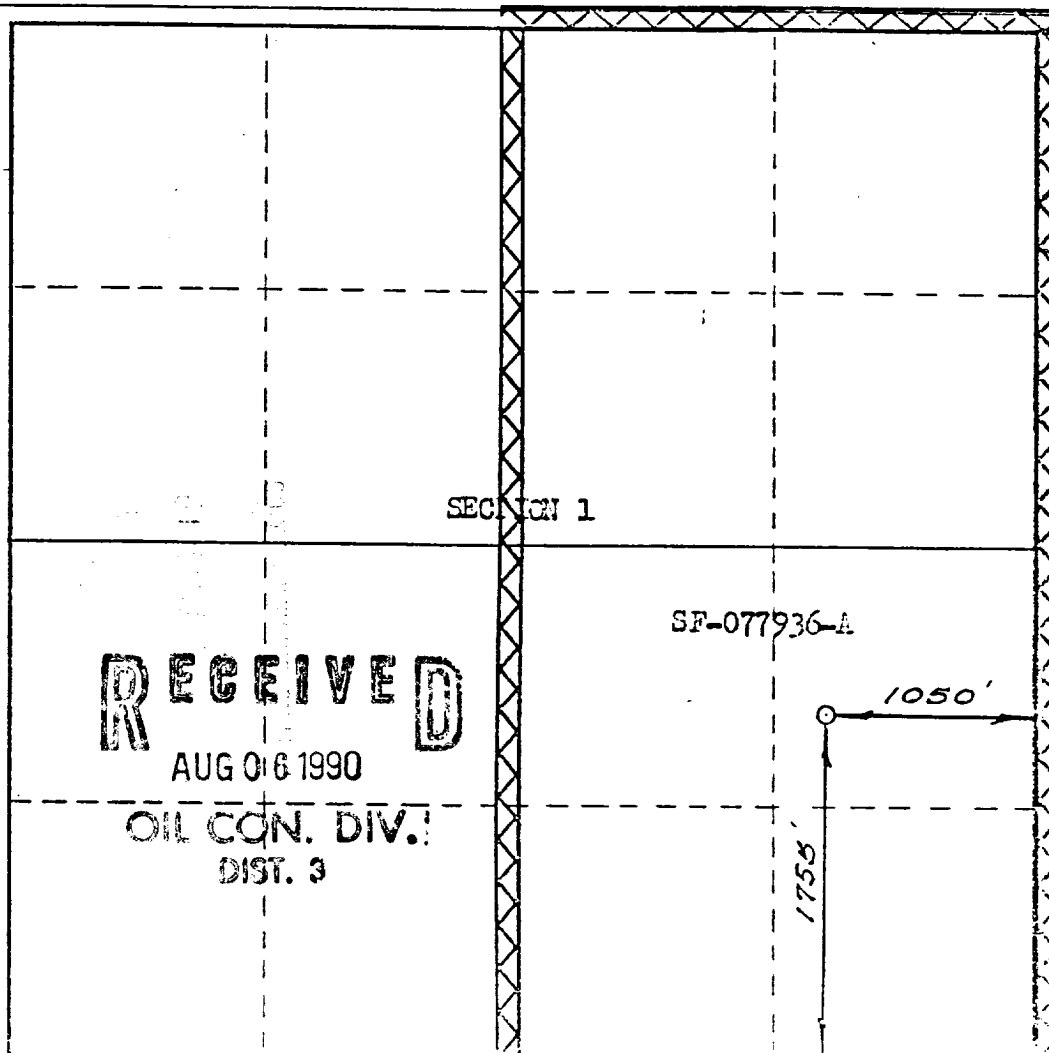

CERTIFICATION

I hereby certify that the information contained herein is true and complete to the best of my knowledge and belief.

Peggy Bradfield
Name

Peggy Bradfield

Position

Regulatory Affairs

Company

El Paso Natural Gas

Date

6-20-90

I hereby certify that the well location shown on this plat was plotted from field notes of actual surveys made by me or under my supervision, and that the same is true and correct to the best of my knowledge and belief.

Date Surveyed

DECEMBER 10, 1973

Registered Professional Engineer and/or Land Surveyor

David C. Kilmer

Certification No. 1760

RECOMPLETION PROCEDURE
GALLUP PLUG AND ABANDONMENT

NO WORK IS TO BE PERFORMED OR EQUIPMENT TO BE LOCATED OFF APPROVED WELL PAD

1. MOL and RU. ND wellhead. NU BOP. Load hole with water.
2. TOOH with 199 joints of 2 3/8" 4.7# K-55 tubing set @ 6161'
3. PU 4 1/2" casing scraper on 2 3/8" 4.7# J-55 EUE tubing and TIH to 6229'.
TOOH.
4. TIH. Establish a rate into the Gallup perforations. Spot a cement plug from 6229'-5748' with 55 sx of Class B neat cement (65 cf, 50% excess to cover 50' above the top of the Gallup). Pull up to 5748' and circulate the casing with 92 bbls of 9.0 PPG mud with a minimum viscosity of 50 sec/qt. TOOH. Tag cement top with wireline after 4 hours.
5. Perforate 4 squeeze holes at 3950'. Establish a rate into the perforations with water. Set a 4 1/2" cement retainer at 3850'. TIH with 2 3/8" tubing and sting into test position in cement retainer. Pressure test tubing to 1000 psi. Establish rate into perforations with water. Squeeze cement with 50 sx of Class B neat cement (59 cf, 100% excess to cover 50' above the top of the Cliff House). Sting out of cement retainer and spot 6 sx Class B neat cement on top of cement retainer (7cf, 81' in 4 1/2" casing). TOOH.
6. TIH with 4 1/2" CIBP and set at 2307' to isolate the Pictured Cliffs. TOOH.
7. Proceed with Fruitland recompletion.

RECOMPLETION PROCEDURE
HUERFANO UNIT #252

NO WORK IS TO BE PERFORMED OR EQUIPMENT TO BE LOCATED OFF APPROVED WELL PAD

1. Complete Gallup plugback procedure. Load hole with water.
2. NU low pressure packoff.
3. Run GR-CCL-CNL. Pick perforations from log.
4. Pressure test casing.
5. Perforate casing across coal interval and breakdown perforations. Projected zones to be selected from CNL log run.
6. TIH with tubing and swab wellbore dry. Check well for gas flow. Evaluate well overnight. Check well for buildup pressure and gas flow.
7. TIH with tubing and clean out to CIBP.
8. Land tubing 10 feet above bottom perforation. Swab well in. Record final 30, 45, and 60 minute gauges on morning report. ND BOP. NU tree. RD and release rig.
9. Evaluate well's performance for possible fracture stimulation.

WORKOVER / RECOMPLETION B. O. P. SCHEMATIC

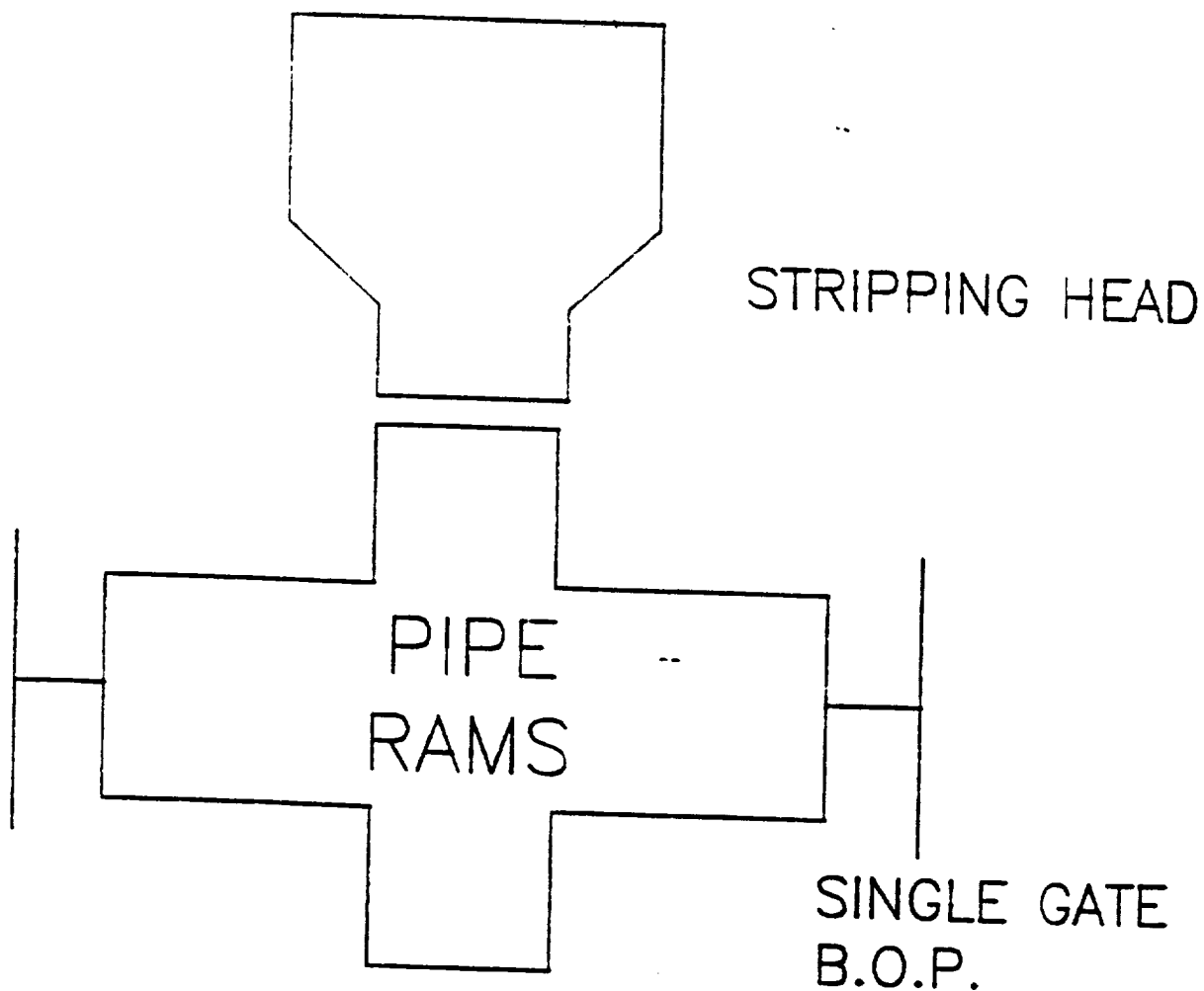

MINIMUM: 2 7/8" 1500 PSI SINGLE GATE B.O.P.

MAXIMUM ANTICIPATED SHUT-IN WELLHEAD
PRESSURE IS LESS THAN 1500 PSI

HUERFANO UNIT #252 WELLBORE DIAGRAMS

BEFORE R/C

AFTER R/C

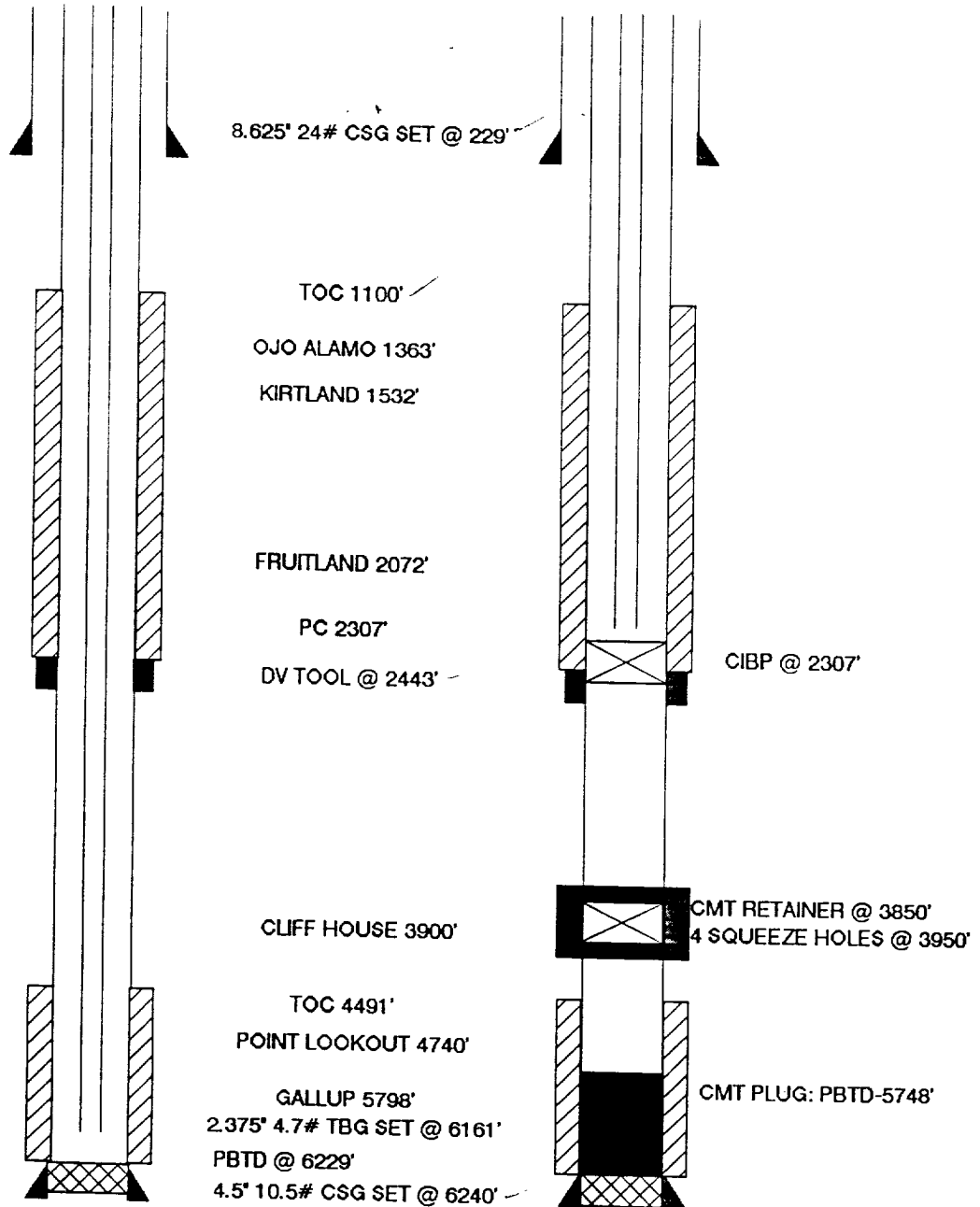



STATE OF NEW MEXICO
ENERGY AND MINERALS DEPARTMENT
OIL CONSERVATION DIVISION
AZTEC DISTRICT OFFICE

GARREY CARRUTHERS
GOVERNOR

1000 RIO BRAZOS ROAD
AZTEC, NEW MEXICO 87410
(505) 334-6178

Date: 6-29-90

Oil Conservation Division
P.O. Box 2088
Santa Fe, NM 87504-2088

Re: Proposed MC _____
Proposed DHC _____
Proposed NSL X _____
Proposed SWD _____
Proposed WFX _____
Proposed PMX _____

Gentlemen:

I have examined the application dated 6-21-90
for the Meridian Oil Inc. Huerfano Unit #252
Operator Lease & Well No.

7-7 I-1-26N-106 and my recommendations are as follows:
Unit, S-T-R

Approved

Yours truly,

Ernie Bush

MERIDIAN OIL

June 20, 1990

Certified Mail

Mr. William LeMay
New Mexico Oil Conservation Division
Post Office Box 2088
Santa Fe, New Mexico 87503

RECEIVED
JUN 21 1990
OIL CON. DIV.
DIST. 3

RE: Huerfano Unit #252
1755'FSL, 1050'FEL
Section 01, T-26-N, R-10-W
San Juan County, New Mexico

Dear Mr. LeMay:

This is a request for administrative approval for a non-standard gas well location in the Basin Fruitland Pool.

Meridian Oil intends to plugback and recomplete the Huerfano Unit #252 well from the Pictured Cliffs pool to the Basin Fruitland Coal Pool. The current location of this well is 1755'FSL, 1050'FEL, Section 01, T-26-N, R-10-W, San Juan County, New Mexico. The well is considered non-standard due to the NE-SW dedicated pattern established for the Basin Fruitland Coal Pool. To comply with the New Mexico Oil Conservation Division rules, Meridian is submitting the following for your approval of this non-standard location:

1. C-102 plat showing location of the well;
2. Plat showing offset owners/operators;
3. Copy of Well Completion Log for original completion.

All surrounding lands are located within the Huerfano Unit boundaries - El Paso Natural Gas Company is the operator of this unit.

Sincerely yours,

Peggy Bradfield
encl.

EL PASO NATURAL GAS COMPANY

Well Name Huerfano Unit #252

Footage 1755' FSL; 1050' FEL

APPLICATION FOR NON-STANDARD LOCATION

County San Juan State New Mexico Section 1 Township 26N Range 10W

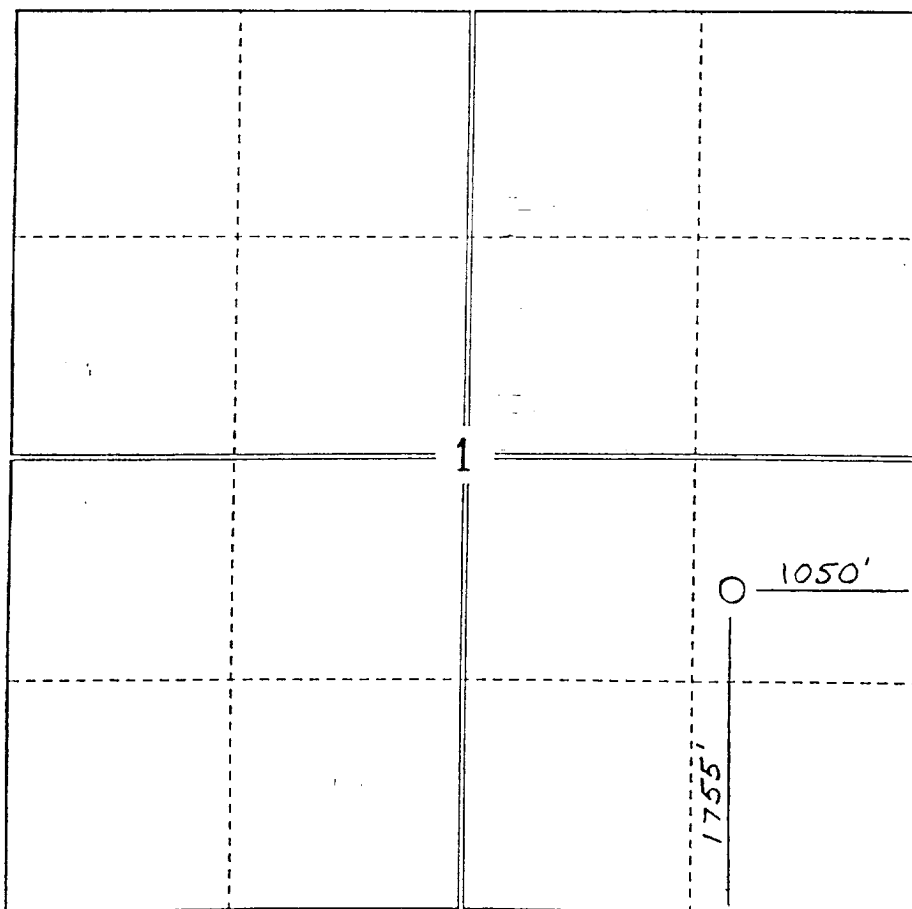

Remarks All surrounding lands are located within the Huerfano Unit boundaries - El
Paso Natural Gas Company, Operator.

NEW MEXICO OIL CONSERVATION COMMISSION
WELL LOCATION AND ACREAGE DEDICATION PLAT

Form C-102
Supersedes C-128
Effective 1-1-65

All distances must be from the outer boundaries of the Section.

Operator EL PASO NATURAL GAS COMPANY		Lease HUERFANO UNIT (SF-077936-A)		Well No. 252
Unit Letter I	Section 1	Township 26-N	Range 10-W	County SAN JUAN
Actual Footage Location of Well: 1755 feet from the SOUTH line and 1050 feet from the EAST line				
Ground Level Elev. 6636	Producing Formation Fruitland Coal	Pool Basin	Dedicated Acreage: 319.87 Acres	

1. Outline the acreage dedicated to the subject well by colored pencil or hatchure marks on the plat below.
2. If more than one lease is dedicated to the well, outline each and identify the ownership thereof (both as to working interest and royalty).
3. If more than one lease of different ownership is dedicated to the well, have the interests of all owners been consolidated by communitization, unitization, force-pooling, etc?

☒ Yes ☐ No If answer is "yes," type of consolidation **Unitization**

If answer is "no," list the owners and tract descriptions which have actually been consolidated. (Use reverse side of this form if necessary.)

No allowable will be assigned to the well until all interests have been consolidated (by communitization, unitization, forced-pooling, or otherwise) or until a non-standard unit, eliminating such interests, has been approved by the Commission.

<div data-bbox="160 1136 526 1247" data-label="Text"> <p>RECEIVED</p> </div> <div data-bbox="233 1238 428 1276" data-label="Text"> <p>JUN 21 1990</p> </div> <div data-bbox="181 1293 470 1383" data-label="Text"> <p>OIL CON. DIV DIST. 3</p> </div> <div data-bbox="498 1459 654 1493" data-label="Text"> <p>SECTION 1</p> </div> <div data-bbox="721 1572 912 1608" data-label="Text"> <p>SF-077936-A</p> </div> <div data-bbox="932 1647 1045 1678" data-label="Text"> <p>1050'</p> </div> <div data-bbox="842 1796 867 1902" data-label="Text"> <p>1755'</p> </div>	<div data-bbox="1253 1008 1443 1032" data-label="Section-Header"> <p>CERTIFICATION</p> </div> <div data-bbox="1140 1078 1562 1174" data-label="Text"> <p>I hereby certify that the information contained herein is true and complete to the best of my knowledge and belief.</p> </div> <div data-bbox="1118 1234 1516 1455" data-label="Text"> <p>Name Peggy Bradfield</p> <p>Position Regulatory Affairs</p> <p>Company El Paso Natural Gas</p> <p>Date</p> </div> <div data-bbox="1140 1568 1562 1759" data-label="Text"> <p>I hereby certify that the well location shown on this plat was plotted from field notes of actual surveys made by me or under my supervision, and that the same is true and correct to the best of my knowledge and belief.</p> </div> <div data-bbox="1118 1838 1459 1957" data-label="Text"> <p>Date Surveyed DECEMBER 10, 1973</p> <p>Registered Professional Engineer under Land Surveyor</p> </div>
---	---

1760

UNITED STATES
DEPARTMENT OF THE INTERIOR
GEOLOGICAL SURVEYSUBMIT IN DUPLICATE*
(See other instructions on reverse side)Form approved.
Budget Bureau No. 42-R355.5.

WELL COMPLETION OR RECOMPLETION REPORT AND LOG *

5. LEASE DESIGNATION AND SERIAL NO.

SF077936-A

6. IF INDIAN, ALLOTTEE OR TRIBE NAME

7. UNIT AGREEMENT NAME

Huerfano Unit

8. FARM OR LEASE NAME

Huerfano Unit

9. WELL NO.

252

10. FIELD AND POOL, OR WILDCAT

Angel Peak Gallup

11. SEC., T., R., M., OR BLOCK AND SURVEY OR AREA

Sec. 1, T-26-N, R-10-W
N.M.P.M.

12. COUNTY OR PARISH

San Juan

13. STATE

New Mexico

19. ELEV. CASINGHEAD

6636' GL

23. INTERVALS DRILLED BY

0-6240

CABLE TOOLS

25. WAS DIRECTIONAL SURVEY MADE

No

27. WAS WELL CORED

No

1a. TYPE OF WELL:

OIL WELL ☐GAS WELL ☒DRY ☐

Other

b. TYPE OF COMPLETION:

NEW WELL ☒WORK OVER ☐DEEP-EN ☐PLUG BACK ☐DIFF. RESVR. ☐

Other

2. NAME OF OPERATOR

El Paso Natural Gas Company

3. ADDRESS OF OPERATOR

P. O. Box 990, Farmington, NM 87401

4. LOCATION OF WELL (Report location clearly and in accordance with any State requirements)*

At surface

1755'S, 1050'E

At top prod. interval reported below

At total depth

14. PERMIT NO.

DATE ISSUED

U. S. GEOLOGICAL SURVEY

15. DATE SPURRED

03-15-74

16. DATE T.D. REACHED

03-24-74

17. DATE COMPL. (Ready to prod.)

11-25-74

18. ELEVATIONS (DF, RKB, RT, GR, ETC.)*

6636' GL

20. TOTAL DEPTH, MD & TVD

6240'

21. PLUG, BACK T.D., MD & TVD

6229'

22. IF MULTIPLE COMPL., HOW MANY*

24. PRODUCING INTERVAL(S), OF THIS COMPLETION—TOP, BOTTOM, NAME (MD AND TVD)*

5900-6168' (GL)

25. WAS DIRECTIONAL SURVEY MADE

No

26. TYPE ELECTRIC AND OTHER LOGS RUN

IEL; CDL-GR; Temp. Survey

28. CASING RECORD (Report all strings set in well)

CASING SIZE	WEIGHT, LB./FT.	DEPTH SET (MD)	HOLE SIZE	CEMENTING RECORD	AMOUNT PULLED
8 5/8"	24#	229'	12 1/4"	182 cu. ft.	
4 1/2"	10.5#	6240'	7 7/8"	1128 cu. ft.	

29. LINER RECORD

SIZE	TOP (MD)	BOTTOM (MD)	SACKS CEMENT*	SCREEN (MD)	SIZE	DEPTH SET (MD)	PACKER SET (MD)
					2 3/8"	6161'	

31. PERFORATION RECORD (Interval, size and number)

5900', 5986', 6012', 6072', 6090', 6128',
6164', 6168' with 1 shot per zone.

32. ACID, SHOT, FRACTURE, CEMENT SQUEEZE, ETC.

DEPTH INTERVAL (MD)	AMOUNT AND KIND OF MATERIAL USED
5900-6168'	96,000# sand, 97,272 gal wtr

33.*

PRODUCTION

DATE FIRST PRODUCTION		PRODUCTION METHOD (Flowing, gas lift, pumping—size and type of pump)				WELL STATUS (Producing or shut-in)	
		Flowing				Shut-In	
DATE OF TEST	HOURS TESTED	CHOKE SIZE	PROD'N. FOR TEST PERIOD	OIL—BBL.	GAS—MCF.	WATER—BBL.	GAS-OIL RATIO
11-25-74	3 hours	3/4" variable	→				
FLOW. TUBING PRESS.	CASING PRESSURE	CALCULATED 24-HOUR RATE	OIL—BBL.	GAS—MCF.	WATER—BBL.	OIL GRAVITY-API (CORR.)	
SI 549	SI 543	→		153 MCF/D	4 AOF		

34. DISPOSITION OF GAS (Sold, used for fuel, vented, etc.)

TEST WITNESSED BY

Norton and Rhames

35. LIST OF ATTACHMENTS

36. I hereby certify that the foregoing and attached information is complete and correct as determined from all available records

SIGNED

D. J. Buice

TITLE

Drilling Clerk

DATE

December 6, 1974

*(See Instructions and Spaces for Additional Data on Reverse Side)