

NEW MEXICO OIL CONSERVATION COMMISSION
WELL LOCATION AND ACREAGE DEDICATION PLAT

Form C-102
Supersedes C-128
Effective 1-1-65

All distances must be from the outer boundaries of the Section.

Operator EL PASO NATURAL GAS COMPANY		Lease HUERFANITO UNIT (HNL-03491)		Well No. 107
Unit Letter L	Section 4	Township 26-N	Range 9-W	County SAN JUAN
Actual Footage Location of Well: 1800 feet from the SOUTH line and 890 feet from the WEST line				
Ground Level Elev. 6419	Producing Formation GALLUP	Pool ANGEL PEAK GALLUP	Dedicated Acreage: 321.44 Acres	

1. Outline the acreage dedicated to the subject well by colored pencil or hatchure marks on the plat below.
2. If more than one lease is dedicated to the well, outline each and identify the ownership the well has to working interest and royalty).
3. If more than one lease of different ownership is dedicated to the well, have the interests of all owners been consolidated by communitization, unitization, force-pooling, etc?

☐ Yes ☐ No If answer is "yes," type of consolidation Unitization CON. COM.

If answer is "no," list the owners and tract descriptions which have actually been consolidated. (Use reverse side of this form if necessary.)

No allowable will be assigned to the well until all interests have been consolidated (by communitization, unitization, forced-pooling, or otherwise) or until a non-standard unit, eliminating such interests, has been approved by the Commission.

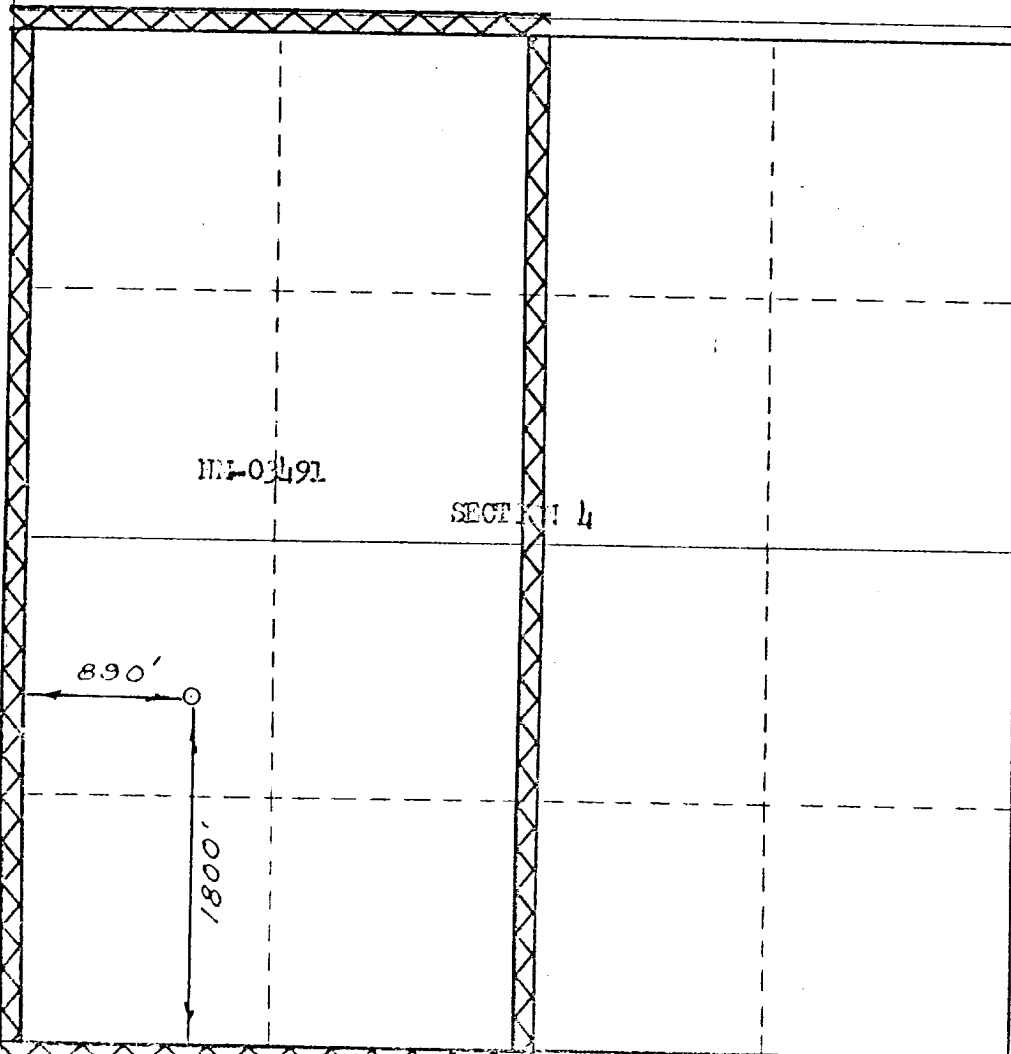

CERTIFICATION

I hereby certify that the information contained herein is true and complete to the best of my knowledge and belief.

Original Signed by

Name D. G. Brown
Position Drilling Clerk
Company El Paso Natural Gas Company
Date January 14, 1974

I hereby certify that the well location shown on this plat was plotted from field notes of actual surveys made by me or under my supervision, and that the same is true and correct to the best of my knowledge and belief.

Signature DECEMBER 10, 1973

Registered Professional Engineer and/or Land Surveyor

[Signature]
1760

300 100 50 1320 1050 1450 2310 2640 2000 1500 1000 500