

UNITED STATES  
DEPARTMENT OF THE INTERIOR  
GEOLOGICAL SURVEY

## APPLICATION FOR PERMIT TO DRILL, DEEPEN, OR PLUG BACK

## 1a. TYPE OF WORK

DRILL ☒DEEPEN ☐PLUG BACK ☐

## b. TYPE OF WELL

OIL  
WELL ☒GAS  
WELL ☐

OTHER

SINGLE  
ZONE ☐MULTIPLE  
ZONE ☐

## 2. NAME OF OPERATOR

Tenneco Inc.

Attention: T. Bliss

## 3. ADDRESS OF OPERATOR

P. O. Box 2100, Denver, Colorado 80201

## 4. LOCATION OF WELL (Report location clearly and in accordance with any State requirements.\*)

At surface

SW 1/4 Sec. 26

At proposed prod. zone

660' FEL &amp; 2130' FEL, Sec. 26

## 14. DISTANCE IN MILES AND DIRECTION FROM NEAREST TOWN OR POST OFFICE\*

- -

## 15. DISTANCE FROM PROPOSED\*

LOCATION TO NEAREST  
PROPERTY OR LEASE LINE, FT.  
(Also to nearest drlg. unit line, if any)

2130'

18. DISTANCE FROM PROPOSED LOCATION\*  
TO NEAREST WELL, DRILLING, COMPLETED,  
OR APPLIED FOR, ON THIS LEASE, FT.

1950'

## 16. NO. OF ACRES IN LEASE

- -

## 19. PROPOSED DEPTH

6575'

17. NO. OF ACRES ASSIGNED  
TO THIS WELL

160

## 20. ROTARY OR CABLE TOOLS

Rotary

## 21. ELEVATIONS (Show whether DF, RT, GR, etc.)

5594' GR

## 22. APPROX. DATE WORK WILL START\*

May 15, 1974

## 23.

## PROPOSED CASING AND CEMENTING PROGRAM

SIZE OF HOLE	SIZE OF CASING	WEIGHT PER FOOT	SETTING DEPTH	QUANTITY OF CEMENT
17-1/2"	13-3/8"	48#	100'	Circ to surface
12-1/4"	9-5/8"	40#	1600'	Circ to surface
8-5/8"	7"	26#	6575'	Cnt 600' above pay zone

Propose to drill subject well to increase oil recovery from Tecito Dome Field. Samples will be taken at 10' intervals from 3600' to TD. No cores are planned. A DST is scheduled for the Barber Creek. Logs will be run from surface casing to TD. Prospective zones will be perforated and treated as necessary. Blowout preventer equipment will be as indicated in the attached exhibit and will be tested at regular intervals. Necessary steps will be taken to protect the environment.

CONFIDENTIAL

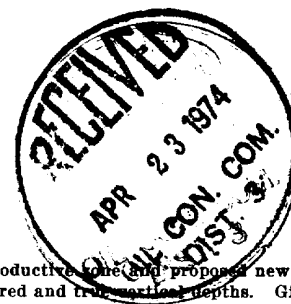

IN ABOVE SPACE DESCRIBE PROPOSED PROGRAM: If proposal is to deepen or plug back, give data on present productive zone and proposed new productive zone. If proposal is to drill or deepen directionally, give pertinent data on subsurface locations and measured and true section depths. Give blowout preventer program, if any.

## 24.

SIGNED Signed: Torrie Bliss TITLE District Superintendent DATE April 19, 1974

(This space for Federal or State office use)

PERMIT NO. \_\_\_\_\_ APPROVAL DATE \_\_\_\_\_

APPROVED BY [Signature] TITLE \_\_\_\_\_ DATE \_\_\_\_\_

CONDITIONS OF APPROVAL, IF ANY  
0008(3) 0000(2) TB AM CON The Navajo Tribe  
Farmington Aztec

\*See Instructions On Reverse Side

## Instructions

**General:** This form is designed for submitting proposals to perform certain well operations, as indicated, on all types of lands and leases for appropriate action by either a Federal or a State agency, or both, pursuant to applicable Federal and/or State laws and regulations. Any necessary special instructions concerning the use of this form and the number of copies to be submitted, particularly with regard to local, area, or regional procedures and practices, either are shown below or will be issued by, or may be obtained from, the local Federal and/or State office.

**Item 1:** If the proposal is to redrill to the same reservoir at a different subsurface location or to a new reservoir, use this form with appropriate notations. Consult applicable State or Federal regulations concerning subsequent work proposals or reports on the well.

**Item 4:** If there are no applicable State requirements, locations on Federal or Indian land should be described in accordance with Federal requirements. Consult local State or Federal office for specific instructions.

**Item 14:** Needed only when location of well cannot readily be found by road from the land or lease description. A plat, or plats, separate or on this reverse side, showing the roads to, and the surveyed location of, the well, and any other required information, should be furnished when required by Federal or State agency offices.

**Items 15 and 18:** If well is to be, or has been directionally drilled, give distances for subsurface location of hole in any present or objective production zone.

**Item 22:** Consult applicable Federal or State regulations, or appropriate officials, concerning approval of the proposal before operations are started.

**NEW MEXICO OIL CONSERVATION COMMISSION  
WELL LOCATION AND ACREAGE DEDICATION PLAT**

Form C-102  
Supersedes C-128  
Effective 1-1-65

All distances must be from the outer boundaries of the Section.

Operator <b>Texaco Inc.</b>			Lease <b>Navajo Tribe "BP"</b>		Well No. <b>6</b>
Unit Letter <b>0</b>	Section <b>26</b>	Township <b>26 North</b>	Range <b>18 West</b>	County <b>San Juan</b>	
Actual Footage Location of Well: <b>660</b> feet from the <b>South</b> line and <b>2130</b> feet from the <b>East</b> line					
Ground Level Elev. <b>5594</b>	Producing Formation <b>Pennsylvanian</b>		Pool <b>Tocito Dome Penn. "D" Ext.</b>	Dedicated Acreage: <b>160</b> Acres	

1. Outline the acreage dedicated to the subject well by colored pencil or hachure marks on the plat below.
2. If more than one lease is dedicated to the well, outline each and identify the ownership thereof (both as to working interest and royalty).
3. If more than one lease of different ownership is dedicated to the well, have the interests of all owners been consolidated by communitization, unitization, force-pooling, etc?

☐ Yes   ☐ No   If answer is "yes," type of consolidation \_\_\_\_\_

If answer is "no," list the owners and tract descriptions which have actually been consolidated. (Use reverse side of this form if necessary.) \_\_\_\_\_

No allowable will be assigned to the well until all interests have been consolidated (by communitization, unitization, forced-pooling, or otherwise) or until a non-standard unit, eliminating such interests, has been approved by the Commission.

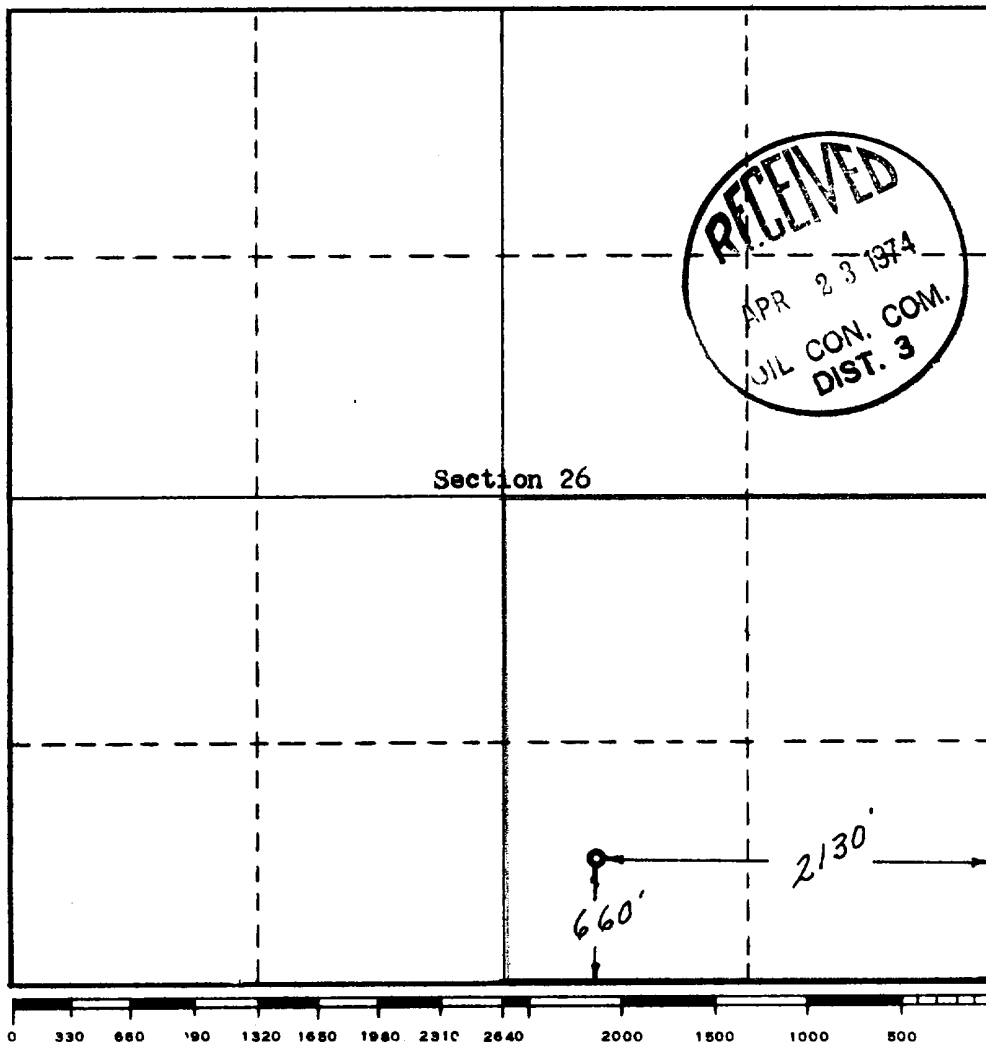

**CERTIFICATION**

*I hereby certify that the information contained herein is true and complete to the best of my knowledge and belief.*

Signed: **Tommie Bliss**

Name  
**Tommie Bliss**

Position  
**District Superintendent**

Company  
**Texaco Inc.**

Date  
**April 19, 1974**

*I hereby certify that the well location shown on this plat was plotted from field notes of actual surveys made by me or under my supervision, and that the same is true and correct to the best of my knowledge and belief.*

Date Surveyed  
**April 15, 1974**

Registered Professional Engineer and Land Surveyor  
*[Signature]*

Certificate No. **3081**

**Minimum equipment requirements are:**

1. Blowout preventers must be capable of being operated both mechanically and hydraulically. Controls must be located so that the blowout preventer can be operated outside the drilling rig substructure. All steel tubing and connections must be used between the hydraulic controls and the blowout preventer.

2. Pressure rating of the blowout preventer and associated connections must be proportional to depth and pressure expectations. Use Figure 1 as a guide in unknown areas. 10" SERIES 680

3. Distance "A" must be sufficient to accommodate a Hydril preventer if required.

4. Chokes, valves, manifold piping and kill line must be flanged and designed equal to or above the pressure rating of the blowout preventer.

5. Kelly cock must be used at all times and should be checked daily.

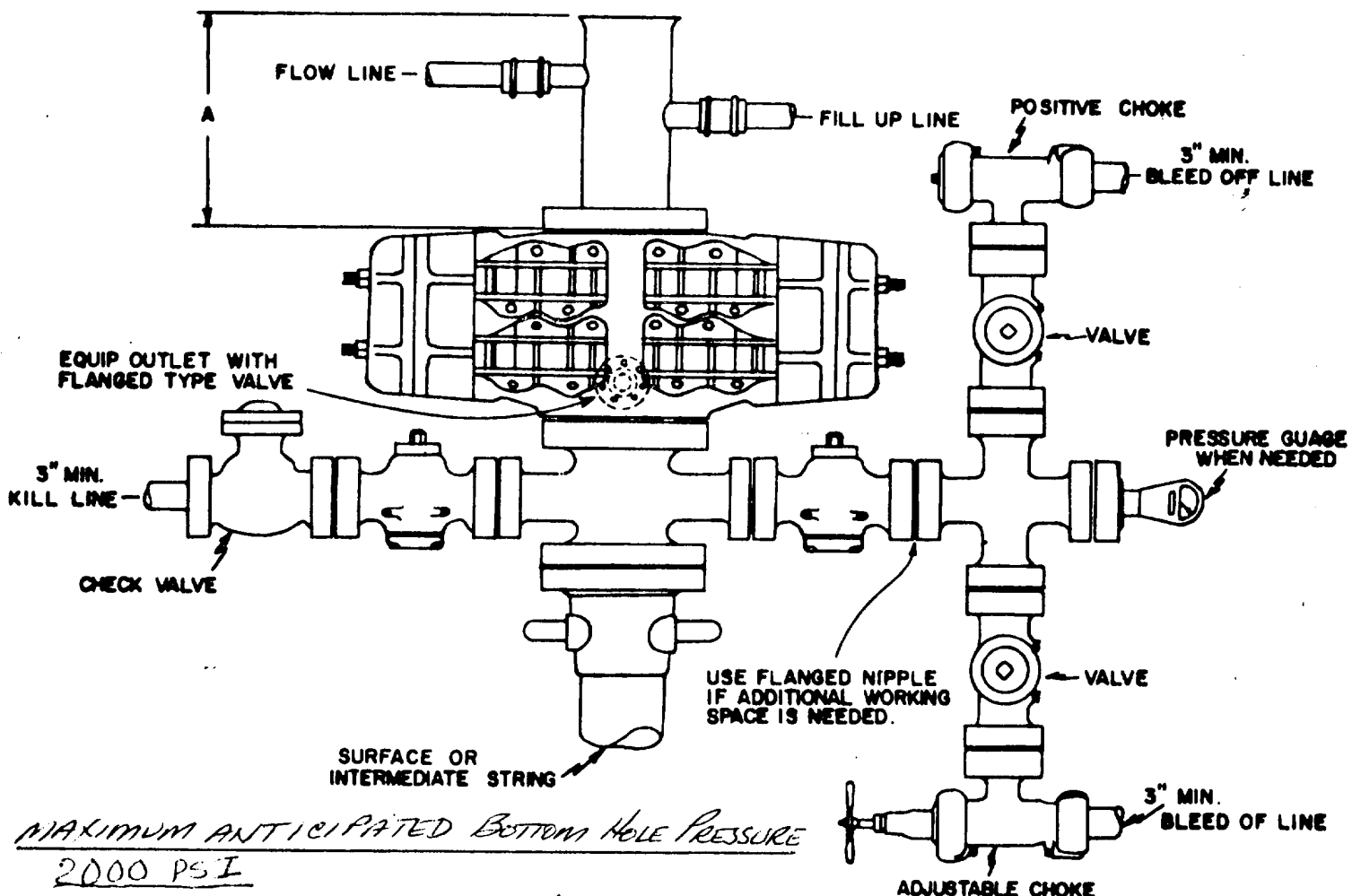

MAXIMUM ANTICIPATED BOTTOM HOLE PRESSURE

2000 PSI

DRILLING FLUID WATER & WATER BASE MUD

NOTE: BLOWOUT PREVENTER MUST HAVE DOUBLE RAMS, ONE BLIND & ONE PIPE RAM OR THE EQUIPMENT MUST CONSIST OF TWO BLOWOUT PREVENTERS, ONE EQUIPPED WITH BLIND RAMS & THE OTHER WITH PIPE RAMS. ALWAYS PLACE THE BLIND RAMS IN THE TOP PREVENTER.

NAVAJO TRIBE "BP" WELL No. 6  
SAN JUAN COUNTY, NEW MEXICO

APPROVED  
*[Signature]*

TEXACO INC DENVER, COLORADO	
BLOWOUT PREVENTER ASSEMBLY STANDARD NO. 2	
DRAWN BY M.S.D.	CHKD BY J.E.E.
DATE 11-8-81	FILE 444000
REVISED	SERIAL 1-100-8



PETROLEUM PRODUCTS

PRODUCING DEPARTMENT  
ROCKY MOUNTAINS-U. S.  
DENVER DIVISION

April 19, 1974

TEXACO INC.  
P. O. BOX 2100  
DENVER, COLORADO 80201

NAVAJO TRIBE "BP" NO. 6  
SW $\frac{1}{4}$  SE $\frac{1}{4}$  SEC. 26 T26N-R18W  
SAN JUAN COUNTY, NEW MEXICO  
6.34

Mr. P. T. McGrath (3)  
District Engineer  
U. S. Geological Survey  
P. O. Box 959  
Farmington, New Mexico 87401

Dear Mr. McGrath:

As requested by your office, the Surface Use Development Plan for Navajo Tribe "BP" No. 6, San Juan County, New Mexico, is as follows:

1. Existing roads and exit to the location are shown on the attached plat.
2. Approximately three-eighths of a mile of access road will be required as shown on attached plat. The road surface will be compacted soil.
3. Nearest producing well is located three-eighths of a mile to the northwest in Section 26.
4. Lateral roads in the vicinity of the location are shown on the attached plat.
5. The flowline for the proposed well will run to an existing battery located 1-1/2 miles to the northwest of the location (see attached plat).
6. Water for drilling operations will be obtained from the bradenhead annulus of Texaco's Navajo Tribe "AL" No. 4, located 2 miles to the west.
7. All waste material will be contained by earthen and steel pits. Earthen pits are to be subsequently backfilled and buried.

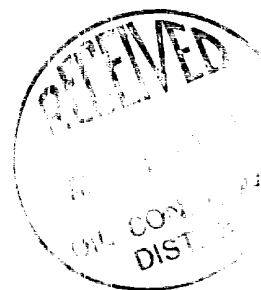

Mr. P. T. McGrath

- 2 -

April 19, 1974

8. No separate drill campsites are proposed.
9. There are no FAA registered airstrips in the vicinity of the location.
10. The drillsite location will be laid bare and will be approximately 250' x 300'. Proper grading will be used to control erosion on the location. A plat showing the location and rig layout is attached.
11. All surfaces not used in normal well servicing and maintenance will be cleaned and graded, where necessary.
12. The wellsite is located on gentle sloping, sandy, barren ground, with widely scattered clumps of sage brush and/or tumbleweeds.

Very truly yours,

Signed: Tommie Bliss

Tommie Bliss  
District Superintendent

DRD:rb

Attach.

cc; Board of Oil & Gas Conservation  
1000 Rio Brazos Road  
Aztec, New Mexico 87501

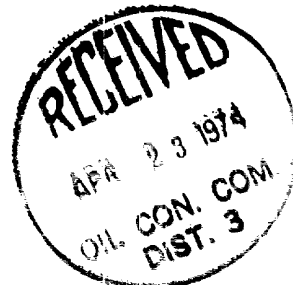

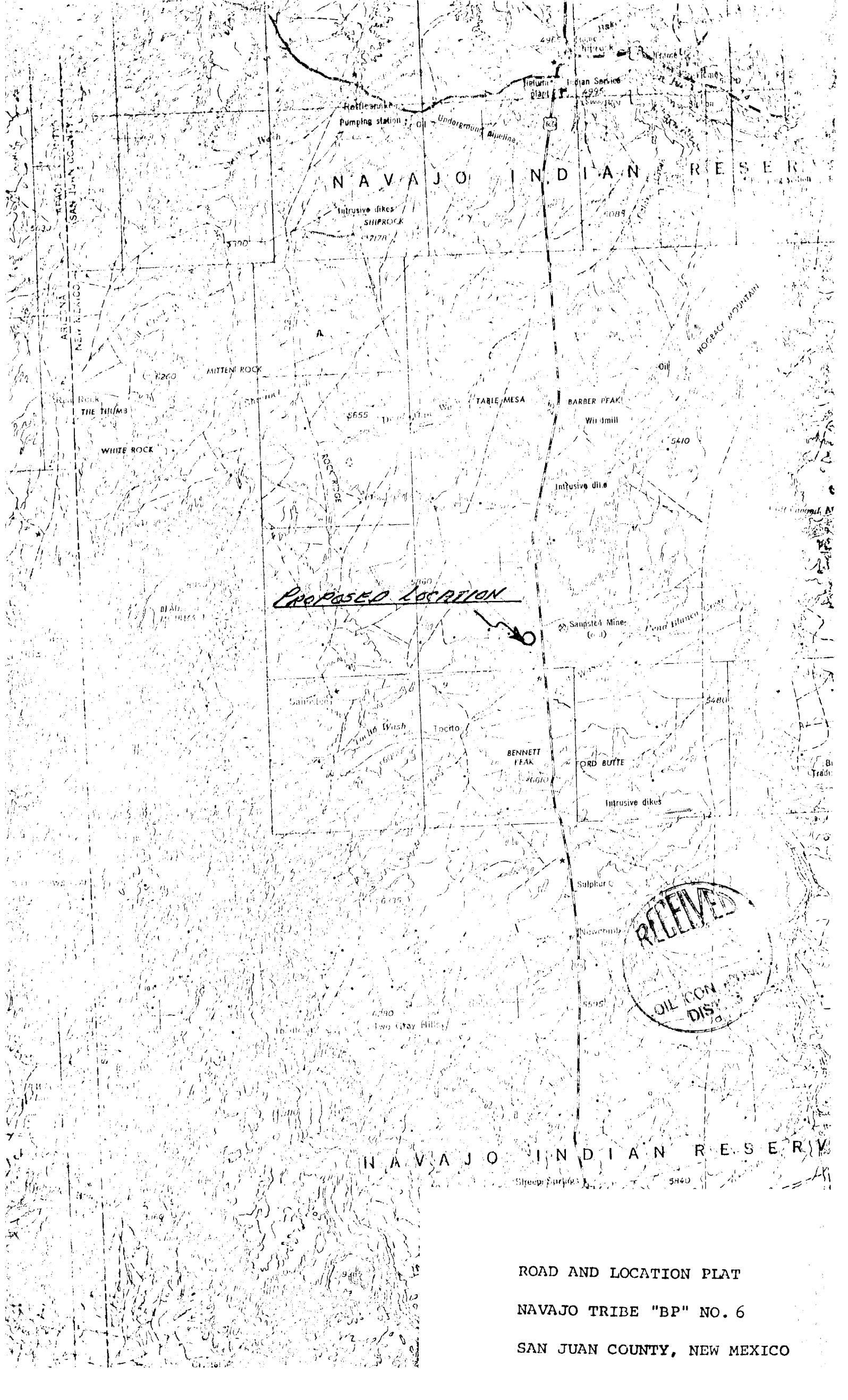

ROAD AND LOCATION PLAT  
NAVAJO TRIBE "BP" NO. 6  
SAN JUAN COUNTY, NEW MEXICO

R 18 W

T  
27  
N

T  
27  
N

T  
26  
N

T  
26  
N

T  
25  
N

R 18 W

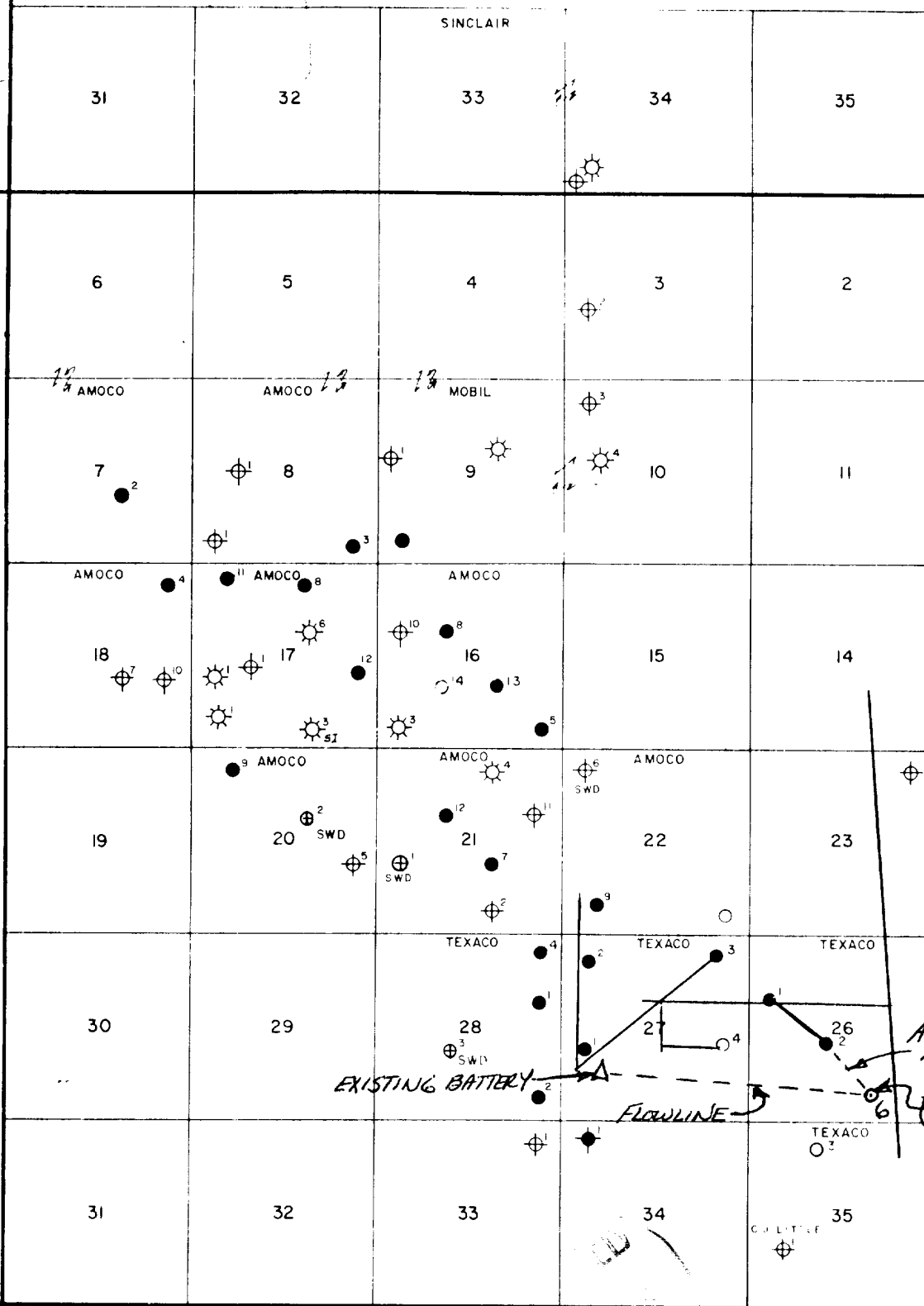

NAVAJO TRIBE "BP" No. 6

TEXACO INC.  
TOCITO DOME FIELD  
SAN JUAN COUNTY, NEW MEXICO

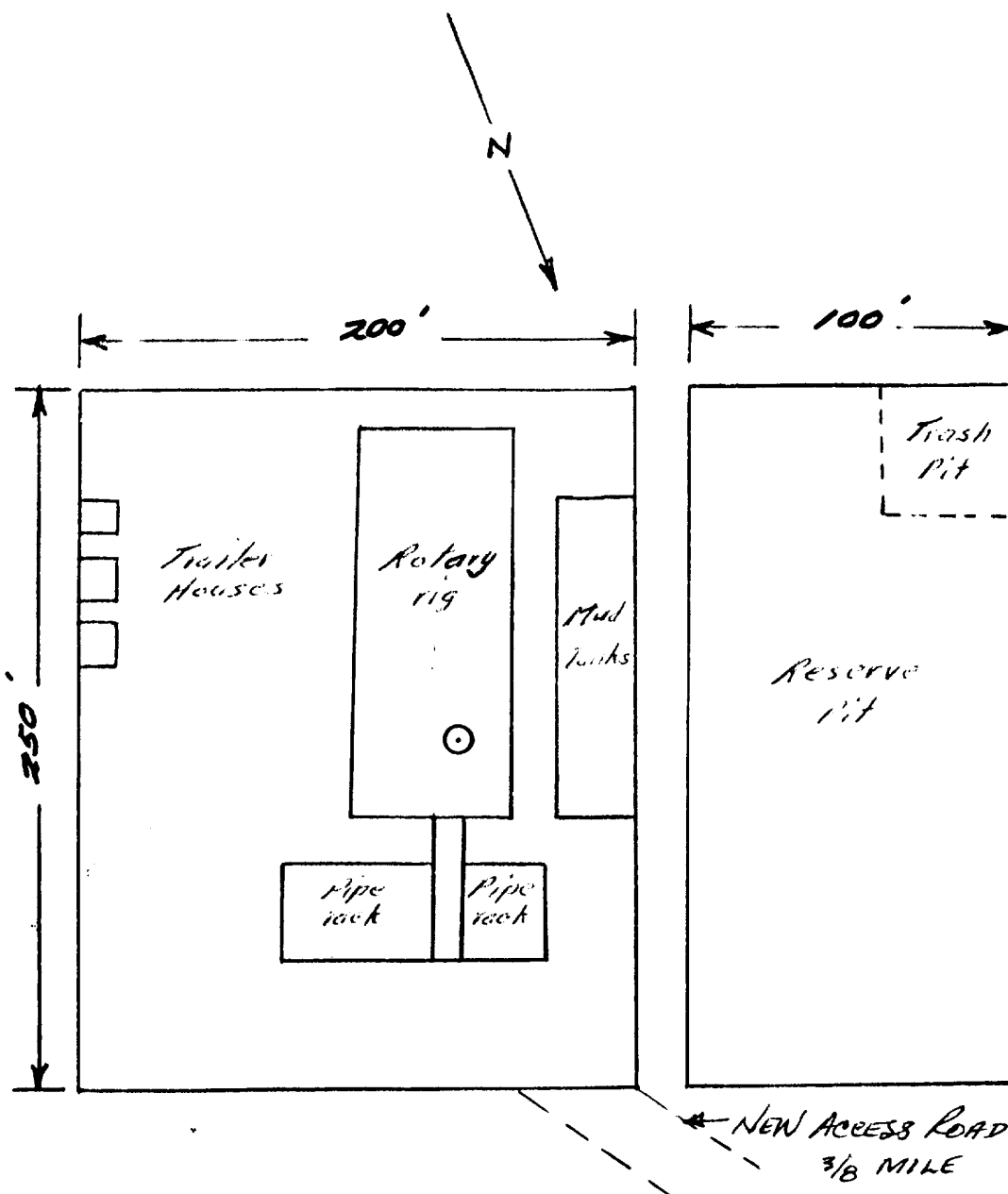

- A. Drilling pad will be compacted soil.
- B. Surface is barren, sandy soil, with scattered thorn bushes and tumbleweeds.

LOCATION & RIG LAYOUT  
 NAVAJO TRIBE "BP" NO. 6  
 SAN JUAN COUNTY, NEW MEXICO